

PLAN VIEW

SECTION C-C

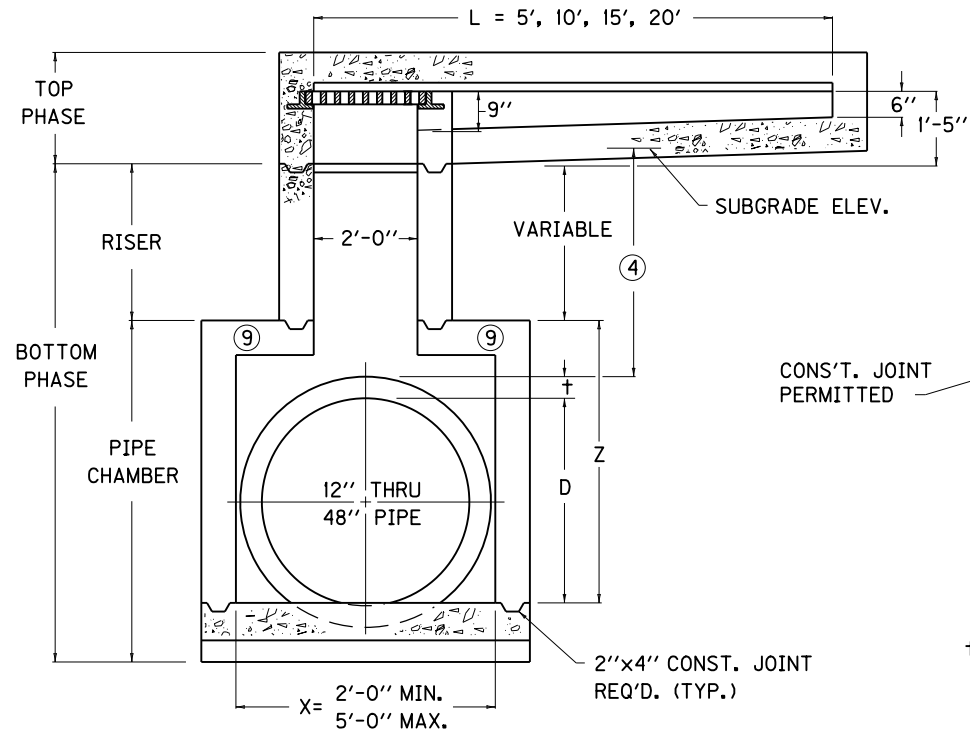

SECTION A-A

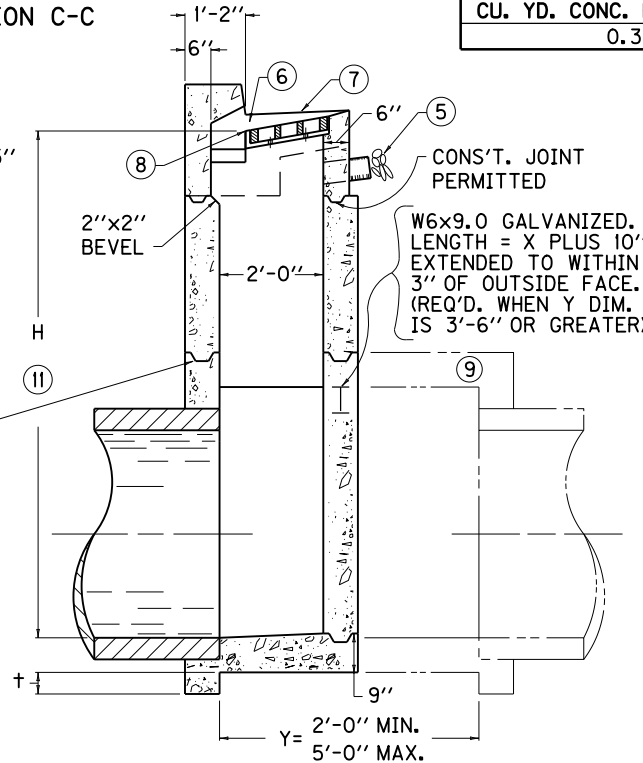

SECTION B-B

NOTES

- INLET SHALL BE CONSTRUCTED IN TWO PHASES (BOTTOM AND TOP)
 BID ITEM: CURB BOX INLET TYPE B (Δ)
 Δ (B) = BOTTOM PHASE ONLY
 Δ (T) = TOP PHASE ONLY
 NO SUFFIX INDICATES COMPLETE INLET.
- SEE CUR. STD. DWGS. RDB-281, RDB-282, RDB-283, RDB-400, RDB-410, AND RDB-420 FOR STEEL PATTERN, DIMENSIONS AND QUANTITIES.
- ALL WALLS, SLABS AND GUTTERS ARE 8" THICK UNLESS OTHERWISE INDICATED.
- 24" DESIRED COVER, 12" MINIMUM COVER.
- SPALLS OR CRUSHED STONE AROUND END OF A 4" OR 6" PIPE FOR SUBGRADE DRAINAGE.
- 4" MINIMUM DRAWDOWN.
- GUTTER CROSS SLOPE.
- FLOW LINE (4" BELOW NORMAL GUTTERLINE ELEVATION).
- LID MAY BE RAISED OR LOWERED IF APPROVED BY THE ENGINEER.
- NOTE: "+" IS CONCRETE PIPE WALL THICKNESS OR METAL PIPE CORRUGATION DEPTH.
- MINIMUM HEIGHT
 $H = Z + 1'-4"$ FOR ALL CURB TYPES
- SEE CUR. STD. DWG. RDB-282 FOR FRAME AND GRATE DETAIL.

RISER	
CU. YD. CONC. PER FT. HT.	
0.3	

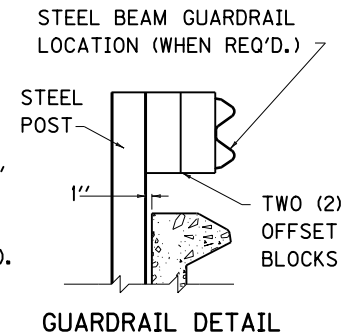

USE WITH CUR. STD. DWGS.:
 RDB-281, RDB-282, RDB-283,
 RDB-400, RDB-410, RDB-420.

KENTUCKY DEPARTMENT OF HIGHWAYS	
CURB BOX INLET TYPE B (DETAIL DRAWING)	
STANDARD DRAWING NO. RDB-280-05	
SUBMITTED: <i>David Kott</i>	11-21-07 DATE
DIRECTOR DIVISION OF DESIGN	
APPROVED: <i>Matthew Mathews</i>	11-21-07 DATE
STATE HIGHWAY ENGINEER	