



CALL NO. 301

CONTRACT ID. 171257

BULLITT COUNTY

FED/STATE PROJECT NUMBER FD04 015 0061 001-003

DESCRIPTION PRESTON HIGHWAY (KY 61)

WORK TYPE JPC PAVEMENT

PRIMARY COMPLETION DATE 5/1/2018

LETTING DATE: December 08,2017

Sealed Bids will be received electronically through the Bid Express bidding service until 10:00 AM EASTERN STANDARD TIME December 08,2017. Bids will be publicly announced at 10:00 AM EASTERN STANDARD TIME.

NO PLANS ASSOCIATED WITH THIS PROJECT.

REQUIRED BID PROPOSAL GUARANTY: Not less than 5% of the total bid.

TABLE OF CONTENTS

PART I	SCOPE OF WORK
	<ul style="list-style-type: none">• PROJECT(S), COMPLETION DATE(S), & LIQUIDATED DAMAGES• CONTRACT NOTES• STATE CONTRACT NOTES• DGA BASE• DGA BASE FOR SHOULDERS• SPECIAL NOTE(S) APPLICABLE TO PROJECT• RIGHT OF WAY NOTES• UTILITY IMPACT & RAIL CERTIFICATION NOTES• KPDES STORM WATER PERMIT, BMP AND APPROVAL LETTER
PART II	SPECIFICATIONS AND STANDARD DRAWINGS
	<ul style="list-style-type: none">• SPECIFICATIONS REFERENCE• SUPPLEMENTAL SPECIFICATION
PART III	EMPLOYMENT, WAGE AND RECORD REQUIREMENTS
	<ul style="list-style-type: none">• LABOR AND WAGE REQUIREMENTS• EXECUTIVE BRANCH CODE OF ETHICS• KENTUCKY EQUAL EMPLOYMENT OPPORTUNITY ACT OF 1978 LOCALITY / STATE• PROJECT WAGE RATES / STATE
PART IV	INSURANCE
PART V	BID ITEMS

PART I
SCOPE OF WORK

ADMINISTRATIVE DISTRICT - 05

CONTRACT ID - 171257

FD04 015 0061 001-003

COUNTY - BULLITT

PCN - DE01500611757

FD04 015 0061 001-003

PRESTON HIGHWAY (KY 61) (MP 1.900) CONSTRUCT A LEFT TURN LANE ON SOUTHBOUND KY 61 AT PLAZA PARK BOULEVARD AT MP 2.0 AND EXTEND EXISTING LEFT TURN LANE FOR NORTHBOUND APPROACH (MP 2.020), A DISTANCE OF 0.13 MILES. JPC PAVEMENT SYP NO. 05-08901.00.

GEOGRAPHIC COORDINATES LATITUDE 37:49:42.00 LONGITUDE 85:43:28.00

COMPLETION DATE(S):

COMPLETED BY 05/01/2018

APPLIES TO ENTIRE CONTRACT

CONTRACT NOTES

PROPOSAL ADDENDA

All addenda to this proposal must be applied when calculating bid and certified in the bid packet submitted to the Kentucky Department of Highways. Failure to use the correct and most recent addenda may result in the bid being rejected.

BID SUBMITTAL

Bidder must use the Department's Expedite Bidding Program available on the Internet web site of the Department of Highways, Division of Construction Procurement. (www.transportation.ky.gov/construction-procurement)

The Bidder must download the bid file located on the Bid Express website (www.bidx.com) to prepare a bid packet for submission to the Department. The bidder must submit electronically using Bid Express.

JOINT VENTURE BIDDING

Joint venture bidding is permissible. All companies in the joint venture must be prequalified in one of the work types in the Qualifications for Bidders for the project. The bidders must get a vendor ID for the joint venture from the Division of Construction Procurement and register the joint venture as a bidder on the project. Also, the joint venture must obtain a digital ID from Bid Express to submit a bid. A joint bid bond of 5% may be submitted for both companies or each company may submit a separate bond of 5%.

UNDERGROUND FACILITY DAMAGE PROTECTION

The contractor shall make every effort to protect underground facilities from damage as prescribed in the Underground Facility Damage Protection Act of 1994, Kentucky Revised Statute KRS 367.4901 to 367.4917. It is the contractor's responsibility to determine and take steps necessary to be in compliance with federal and state damage prevention directives. When prescribed in said directives, the contractor shall submit Excavation Locate Requests to the Kentucky Contact Center (KY811) via web ticket entry. The submission of this request does not relieve the contractor from the responsibility of contacting non-member facility owners, whom shall be contacted through their individual Protection Notification Center. Non-compliance with these directives can result in the enforcement of penalties.

SPECIAL NOTE FOR COMPOSITE OFFSET BLOCKS

Contrary to the Standard Drawings (2016 edition) the Cabinet will allow 6" composite offset blocks in lieu of wooden offset blocks, except as specified on proprietary end treatments and crash cushions. The composite blocks shall be selected from the Cabinet's List of Approved Materials.

REGISTRATION WITH THE SECRETARY OF STATE BY A FOREIGN ENTITY

Pursuant to KRS 176.085(1)(b), an agency, department, office, or political subdivision of the Commonwealth of Kentucky shall not award a state contract to a person that is a foreign entity required by [KRS 14A.9-010](#) to obtain a certificate of authority to transact business in the Commonwealth (“certificate”) from the Secretary of State under [KRS 14A.9-030](#) unless the person produces the certificate within fourteen (14) days of the bid or proposal opening. If the foreign entity is not required to obtain a certificate as provided in [KRS 14A.9-010](#), the foreign entity should identify the applicable exception. Foreign entity is defined within [KRS 14A.1-070](#).

For all foreign entities required to obtain a certificate of authority to transact business in the Commonwealth, if a copy of the certificate is not received by the contracting agency within the time frame identified above, the foreign entity’s solicitation response shall be deemed non-responsive or the awarded contract shall be cancelled.

Businesses can register with the Secretary of State at <https://secure.kentucky.gov/sos/ftbr/welcome.aspx>.

SPECIAL NOTE FOR PROJECT QUESTIONS DURING ADVERTISEMENT

Questions about projects during the advertisement should be submitted in writing to the Division of Construction Procurement. This may be done by fax (502) 564-7299 or email to kytc.projectquestions@ky.gov. The Department will attempt to answer all submitted questions. The Department reserves the right not to answer if the question is not pertinent or does not aid in clarifying the project intent.

The deadline for posting answers will be 3:00 pm Eastern Daylight Time, the day preceding the Letting. Questions may be submitted until this deadline with the understanding that the later a question is submitted, the less likely an answer will be able to be provided.

The questions and answers will be posted for each Letting under the heading “Questions & Answers” on the Construction Procurement website (www.transportation.ky.gov/contract). The answers provided shall be considered part of this Special Note and, in case of a discrepancy, will govern over all other bidding documents.

HARDWOOD REMOVAL RESTRICTIONS

The US Department of Agriculture has imposed a quarantine in Kentucky and several surrounding states, to prevent the spread of an invasive insect, the emerald ash borer. Hardwood cut in conjunction with the project may not be removed from the state. Chipping or burning on site is the preferred method of disposal.

INSTRUCTIONS FOR EXCESS MATERIAL SITES AND BORROW SITES

Identification of excess material sites and borrow sites shall be the responsibility of the Contractor. The Contractor shall be responsible for compliance with all applicable state and federal laws and may wish to consult with the US Fish and Wildlife Service to seek protection under Section 10 of the Endangered Species Act for these activities.

ACCESS TO RECORDS

The contractor, as defined in KRS 45A.030 (9) agrees that the contracting agency, the Finance and Administration Cabinet, the Auditor of Public Accounts, and the Legislative Research Commission, or their duly authorized representatives, shall have access to any books, documents, papers, records, or other evidence, which are directly pertinent to this contract for the purpose of financial audit or program review. Records and other prequalification information confidentially disclosed as part of the bid process shall not be deemed as directly pertinent to the contract and shall be exempt from disclosure as provided in KRS 61.878(1)(c). The contractor also recognizes that any books, documents, papers, records, or other evidence, received during a financial audit or program review shall be subject to the Kentucky Open Records Act, KRS 61.870 to 61.884.

In the event of a dispute between the contractor and the contracting agency, Attorney General, or the Auditor of Public Accounts over documents that are eligible for production and review, the Finance and Administration Cabinet shall review the dispute and issue a determination, in accordance with Secretary's Order 11-004.

06/01/16

SPECIAL NOTE FOR RECIPROCAL PREFERENCE

Reciprocal preference to be given by public agencies to resident bidders

By reference, KRS 45A.490 to 45A.494 are incorporated herein and in compliance regarding the bidders residency. Bidders who want to claim resident bidder status should complete the Affidavit for Claiming Resident Bidder Status along with their bid in the Expedite Bidding Program. Submittal of the Affidavit should be done along with the bid in Bid Express.

03/01/2011

DGA BASE

Unless otherwise noted, the Department estimates the rate of application for DGA Base to be 115 lbs/sy per inch of depth.

DGA BASE FOR SHOULDERS

Unless otherwise noted, the Department estimates the rate of application for DGA Base for Shoulders to be 115 lbs/sy per inch of depth. The Department will not measure necessary grading and/or shaping of existing shoulders prior to placing of DGA Base, but shall be incidental to the Contract unit price per ton for DGA Base.

Accept payment at the Contract unit price per ton as full compensation for all labor, materials, equipment, and incidentals for grading and/or shaping of existing shoulders and furnishing, placing, and compacting the DGA Base.

BULLITT COUNTY PRESTON HIGHWAY (KY 61) 5-8901.00

TABLE OF CONTENTS

DESCRIPTION	PAGE NO.
Project Location Map	2
Project Description	3
General Notes	4
Standard Drawings	4
Traffic Control Plan	5-7
Special Notes	8-16
Typical Sections	17
Summary of Quantities	18
Plan & Profile	19
Detail Sheet	20
Cross Sections	21-27

RECOMMENDED BY:	PROPOSAL BY	PROPOSED TURN LANE		
<u> KYTC D5 </u> <u>10/13/17</u> PROJECT MANAGER DATE	KENTUCKY TRANSPORTATION CABINET	<u>ROUTE NAME:</u> KY 61	<u>LENGTH OF PROJECT:</u> 665.56 ft.	
PLAN APPROVED BY:		<u>COUNTY OF:</u> BULLITT	<u>STATE OF:</u> KENTUCKY	
<u> </u> STATE HWY ENGINEER DATE	DEPARTMENT OF HIGHWAYS	<u>MILE POINT:</u> 1.90 – 2.02	<u>ITEM NO.:</u> 5-8901.00	<u>SHEET NO.:</u> 1 of 27

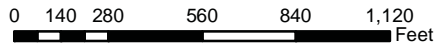
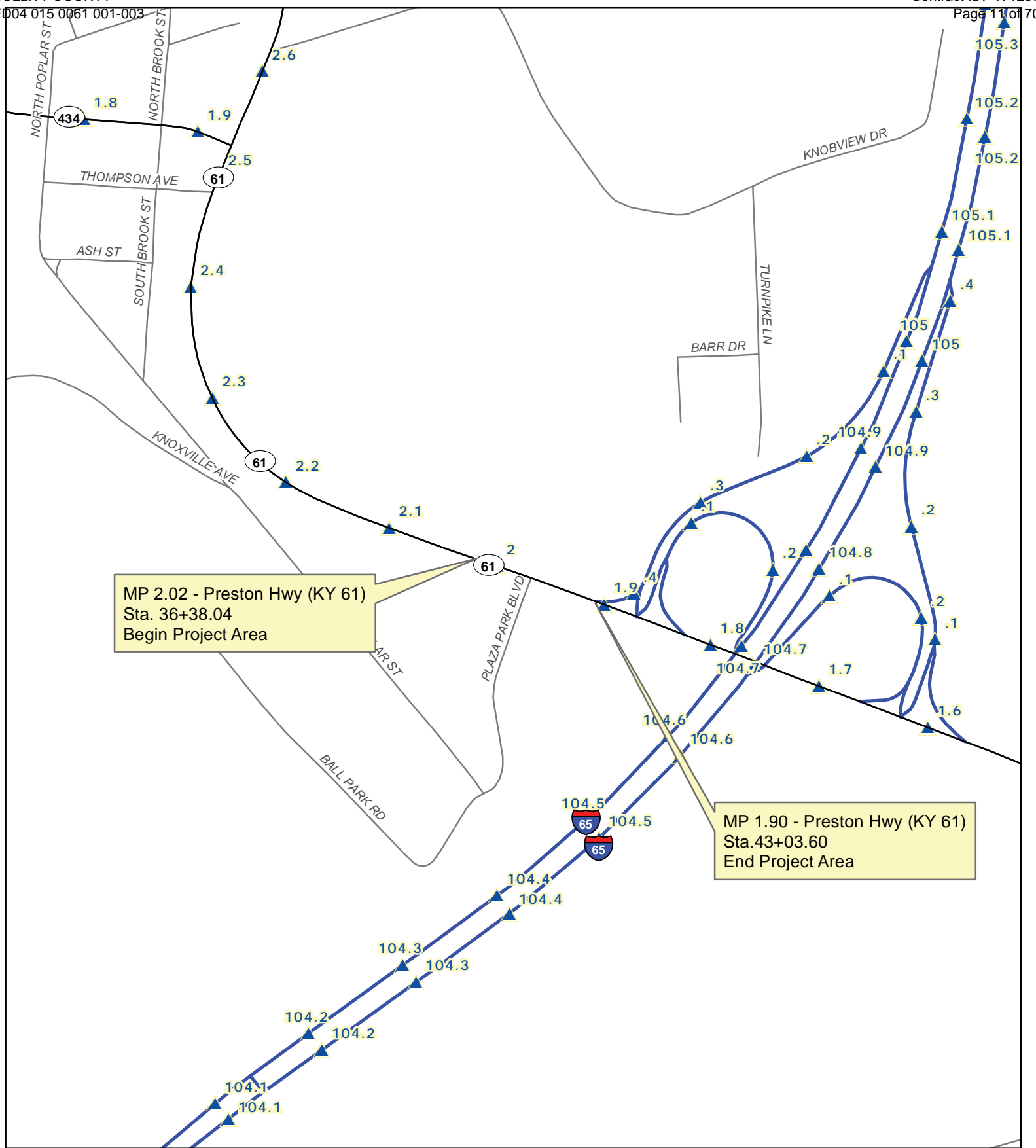

BULLITT COUNTY
ITEM NO. 5-8901.00
TURN LANE CONSTRUCTION
(PRESTON HWY) IN LEBANON JUNCTION



PROJECT DESCRIPTION

Bullitt County

Construct a left turn on southbound KY 61 at Plaza Park Blvd. at MP 2.0 and extend existing left turn lane for northbound approach.

EMARS#

Item No.

5-8901.00

SECTION ONE:

The purpose of this project is to construct a left turn lane on southbound KY 61 at Plaza Park Blvd and extend the existing left turn lane for the northbound approach. The existing left turn lane into Plaza Park Blvd on KY 61 northbound will be reconstructed to provide positive offset from the proposed left turn lane on the southbound side. The project will begin approximately 1,200 ft. west of the I-65 overpass and will extend southeast for approximately 665.56 ft. The road is currently a two lane divided highway (raised median) with ten foot paved shoulders.

In addition, the following will also be required:

- Removal and replacement of various concrete slab locations (Specified on Plans)

GENERAL NOTES

PROJECT COORDINATES:

The coordinates for the center of the project are:

Northing: 3,825,283.21

Easting: 4,928,612.46

TRAFFIC VOLUME

The ADT for this project was obtained from Count Year 2016, and is as follows:

- 2016 ADT – 3,547

SURFACING AREAS

Left turn lane full depth construction is estimated to vary from 0-16 ft wide.

Total JPC area is estimated to be 602 square yards.

STANDARD DRAWINGS

RPM-010-06	STANDARD BARRIER MEDIAN
RPM-011-06	MOUNTABLE MEDIAN
RPM-100-10	CURB AND GUTTER, CURBS AND VALLEY GUTTER
TTC-115-03	LANE CLOSURE MULTI-LANE HIGHWAY CASE I
RPN-015-05	JOINTED PLAIN CONCRETE PAVEMENT
RPS-010-11	CONCRETE PAVEMENT JOINT DETAILS
RPS-020-14	EXPANSION AND CONTRACTION JOINT LOAD TRANSFER ASSEMBLIES
RPS-031-06	CONCRETE PAVEMENT JOINTS TYPES AND SPACING
RPS-032-06	CONCRETE PAVEMENT JOINTS TYPES AND SPACING
RPS-033-07	CONCRETE PAVEMENT JOINTS TYPES AND SPACING
RPX-010-05	PREFORMED COMPRESSION JOINT SEAL FOR CONCRETE PAVEMENT
RPX-015-04	HOT-POURED ELASTIC JOINT SEALS FOR CONCRETE PAVEMENT
RPX-020-06	SILICONE RUBBER SEALS FOR CONCRETE PAVEMENT

TRAFFIC CONTROL PLAN

One lane of traffic will remain open on KY 61 in both directions at all times. A lane closure is anticipated on KY 61 southbound during construction of the southbound left turn lane. The contractor is to utilize the existing 10' paved shoulder during this work. No lane closures are allowed between the hours of 6AM-9AM and 2PM-6PM Monday-Friday unless permission is otherwise granted by the engineer. All lane closures shall be in conformance with the current MUTCD & KYTC Standard Drawings.

In addition, lane closures will not be allowed during the following days:

March 30th-April 1st, 2018 – Easter Weekend
April 21st, 2018 – Thunder Over Louisville

At the discretion of the Engineer, additional days and hours may be added when lane closures will not be allowed.

Night work is allowed on this project.

TRAFFIC CONTROL GENERAL:

Except as provided herein, maintain and control traffic in accordance with the current Standard Specifications and Standard Drawings, current editions. Except for the roadway and traffic control bid items listed, all items of work necessary to maintain and control traffic will be paid at the lump sum bid price to “Maintain and Control Traffic.”

Contrary to Section 106.01, traffic control devices used on this project may be new or used in like-new condition, at the beginning of work and maintained in like new condition until completion of the work.

The speed limit in the work area may be reduced by 10 MPH from the posted speed. The extent of these areas within the project limits will be restricted to the proximity of actual work areas as determined by the engineer.

Traffic control devices should follow the MUTCD and the standard drawings and must be approved by the engineer before placement. Lane closures will include signing present in MUTCD TA-15, TA-23 & TA-30 as applicable. Signing is not limited to these guidelines and should be placed only with the approval from the engineer so as not to block sight distance. All lane closures shall be in conformance with the current MUTCD & KYTC Standard Drawings. The minimum clear lane width shall be **10 ft** (this may include a portion of the adjacent shoulder). If traffic should be stopped due to construction operations and a school bus or emergency vehicle on an official run arrives on the scene, make provisions for the passage of the bus as quickly as possible.

At the discretion of the engineer, additional days and hours may be specified when lane closures will not be allowed.

Once work begins at a site, promptly complete all work at that site. Maintain at least one access point to each parcel at all times. Keep the traveled way clear of mud and debris at all times during construction. Do not allow non-construction equipment, vehicles, or office trailers at work sites. Leave the right of way clear of all equipment, materials, and vehicles during non-working hours.

Take these restrictions into account when preparing bid. The Department will not consider any claims or allow additional payment for any delays to the Contractor as a result of these restrictions.

PROJECT PHASING AND CONSTRUCTION PROCEDURES:

Phase 1

Northbound Work

- Close northbound left turn lane on KY 61 at Plaza Park Blvd
- Sawcut existing pavement. Remove existing std. integral curb and excavate for relocated northbound left turn lane
- Construct DGA, JPC pavement, std. barrier median and std. integral curb
- Install thermo chevrons and striping for turn lane
- Reopen northbound left turn lane to traffic

Southbound Work

- Relocate KY 61 southbound traffic onto adjacent shoulder maintaining a min 10' lane
- Sawcut existing pavement. Remove existing lip curb/raised median and excavate for southbound left turn lane
- Construct DGA, JPC pavement and mountable median
- Install thermo chevrons and striping for turn lane
- Reopen southbound driving lane and newly constructed turn lane to traffic

No lane closures will be allowed between the hours of **6AM – 9AM** and **2PM – 6PM (Monday through Friday)**. The specified completion date for this project is **May 1st, 2018**.

PROJECT DISCRETION:

Refer to Section 108.09 of the current edition of the KENTUCKY STANDARD SPECIFICATIONS FOR ROAD CONSTRUCTION for the schedule of agreed liquidated damages should construction continue beyond the specified completion date.

In addition, Contrary to Section 108.09, Liquidated Damages shall be assessed for the following:

The contractor shall work in a continuous manner once temporary traffic control is in place. If the contractor stops work in an area for more than two calendar days, without the engineers approval, the liquidated damages will be assessed at the contract rate for every day until work resumes.

LANE CLOSURES:

Do not leave lane closures in place during non-working hours.

SIGNS:

The engineer may require additional traffic control signs in addition to normal lane closure signing detailed on the Standard Drawings.

Contrary to section 112.04.02, signs will not be measured for payment but shall be incidental to Maintain and Control Traffic. Replacements for damaged signs directed by the engineer to be replaced due to poor condition or reflectivity will not be measured for payment.

BARRICADES:

Barricades used in lieu of barrels and cones for channelization or delineation shall be incidental to Maintain and Control Traffic according to Section 112.04.01. Barricades used to protect pavement removal areas will be paid as each according to Section 112.04.04.

VARIABLE MESSAGE SIGNS:

If deemed necessary by the engineer, variable message signs will be installed, operated and maintained by the Department.

TRAFFIC COORDINATOR:

Designate an employee to be traffic coordinator during any work period when shoulder and/or lane closure is in place, the traffic coordinator shall arrange for personnel to be present on the project at all times to inspect the traffic control (at least once every two hours during active operations and at any time a lane closure is in effect) and to maintain the signing and devices. The personnel shall have access to on the project to a radio or telephone to be used in case of emergencies or accidents. The traffic coordinator shall report all incidents throughout the work zone to the engineer. Furnish the engineer with the name and telephone number where the traffic coordinator can be contacted at all times.

ARROW PANEL

Use of arrow panels as shown on the Standard Drawings, current addition, or as directed by the Engineer. The Department will measure payment for arrow panels as incidental to the maintain and control traffic bid item. Replacements for damaged arrow panels as directed by the engineer will not be measured for payment.

PAVEMENT EDGE DROP-OFFS:

Pavement edge drop offs must be designated with channelizing devices (warning light optional) every 15' or eliminated with a DGA taper at the end of each work period.

11J

SPECIAL NOTE FOR FULL DEPTH CONCRETE PAVEMENT REPAIR

This Special Note applies to full depth repairs of concrete pavement. Section references herein are to the Department's 2012 Standard Specifications for Road and Bridge Construction.

1.0 DESCRIPTION. Remove and replace concrete pavement. Comply with the applicable Standard Drawings and the Standard Specifications except as specifically superseded herein.

2.0 MATERIALS AND EQUIPMENT.

2.1 JPC Pavement. Test concrete materials according to section 601.03.03. Conform to 501, 502, and 601 except that the concrete must achieve 3000 psi in accordance with Section 4.4 of this note. The Engineer may allow pavement to be opened to traffic at less than 3,000 psi subject to the deductions described in Section 4.4 of this note.

2.2 Dowel Bars and Sleeves. Conform to 811.

2.3 Tie Bars. Conform to Section 811. Use epoxy coated tie bars in longitudinal and transverse joints.

2.4 Joint Sealants. Conform to Subsection 807.03.01 or 807.03.05.

2.5 Grout Adhesives and Epoxy Resin Systems. Conform to Section 826.

2.6 Dense Graded Aggregate (DGA) and Crushed Stone Base (CSB). Conform to Section 805.

2.7 Geotextile Fabric. Conform to Section 843.

2.8 Drills. Drill holes using a gang drill, capable of drilling a minimum of four simultaneously. Misalignment of holes shall not exceed 1/4 inch in the vertical or oblique plane.

2.9 Hammers. Only use chisel point hammers weighing less than 40 pounds to remove deteriorated concrete.

3.0 CONSTRUCTION.

3.1 Removal of Existing Pavement. Remove existing pavement to the extent the Contract specifies or as the Engineer directs. The minimum length of patches measured along centerline is 3 feet on each side of an existing joint.

When working with pavements with non-skewed transverse joints, if it is necessary to remove existing pavement closer than 6 feet to a transverse joint, remove the pavement 3 feet beyond that joint .

When working with pavements with skewed transverse joints, if it is necessary to remove existing pavement closer than 3 feet to a transverse joint, remove the pavement 3 feet beyond that joint.

Details of configurations of pavement and joints for various situations are depicted in the drawings herein.

11J

When small areas of removal and replacement are performed at bridge ends, maintain or reconstruct existing expansion joints at their existing location. When the Engineer determines extensive full width removal and replacement is required, construct new expansion joints at the locations shown on Standard Drawing No. RPN-010.

In the removal operation, make a full depth saw cut longitudinally along the centerline joint and shoulder joint and transversely along the area marked for removal. To prevent damage to the subbase, do not allow the saw to penetrate more than ½" into the subbase. The Engineer may direct or approve additional cuts within the removal area for ease of removal of the damaged slab and to prevent damage to adjacent pavement to remain in place. Do not overcut beyond the limits of the removal area. Prevent saw slurry from entering existing joints and cracks. To avoid pumping and erosion beneath the slab, do not allow traffic on sawed pavement for more than 48 hours before beginning removal procedures, unless directed by the Engineer.

Lift out the deteriorated concrete vertically with lift pins. If approved by the Engineer, use other methods that do not damage the base, shoulder, or sides of pavement that is to be left in place. If any damage does occur, repair as the Engineer directs and use an acceptable alternative method for the removal process. Do not damage the pavement base during these operations.

3.2 Pavement Replacement. Do not damage the pavement base during these operations.

3.2.1 Preparation of Base. Compact the new and existing aggregate base to the Engineer's satisfaction. The Engineer will accept compaction by either visual inspection or by nuclear gauge. When the Engineer deems it necessary to stabilize the existing base or replace unsuitable materials, excluding bridge ends, use 12 inches of geotextile fabric wrapped No. 2 aggregate topped with 4 inches of DGA or CSB. Use either Type III or Type IV geotextile fabric. Flowable fill and cement stabilization may be used as an alternative to stabilize the existing base or to replace unsuitable materials when a plan for such is presented to and approved by the Engineer. The Engineer may also direct using only DGA or CSB to correct base deficiencies. At bridge ends, treat existing base and subgrade as the Contract specifies. During compaction, wet the base as the Engineer directs. Compact areas not accessible to compaction equipment by hand tamping.

3.2.2 Underdrains. Construct, or repair damage to, pavement edge drains according to Section 704. If underdrains are placed omitting areas to be patched, construct additional lateral drains as necessary to provide outlets for the installed underdrain until performing the pavement replacement and completing the underdrain system. Provide drainage for any undercut or base repair areas.

3.2.3 Pavement Replacement. Using load transfer assemblies for dowel joints drill into the existing slab according to the details shown herein and on the Standard Drawings.

Use plain epoxy coated dowels of the size specified on the standard drawings based on the pavement thickness for contraction and expansion joints.

Drill holes for dowel bars and tie bars into the face of the existing slab, at a diameter as specified in the following. Drill the dowel bar holes and tie bar

11J

holes to a depth equal to 1/2 the length of the bars. Anchor tie bars into the existing pavement using an epoxy resin. Anchor dowel bars into the existing pavement using either an epoxy resin or an adhesive grout. For tie bars and dowel bars where an epoxy resin is to be used drill the holes 1/8 inch larger than the bar diameter. For dowel bars where an adhesive grout product is to be used, drill holes 1/4 inch larger than the bar diameter. Use a clear or opaque grout retention disk in both grout and epoxy applications. Operate the equipment to prevent damage to the pavement being drilled. Obtain the Engineer's approval of the drilling procedure. Install load transfer assemblies according to the Standard Drawings and Standard Specifications.

When indicated herein or in the Standard Drawings, use 1 inch deformed tie bars, 18 inches long on 30-inch centers and starting and ending 20 inches inside the edges of the repair area in the longitudinal joint. Use 1 inch deformed tie bars, or plain epoxy coated dowel bars sized in accordance with the Standard Drawings, 18 inches long beginning 12 inches inside of each edge and on 12-inch centers in transverse construction joints.

Install the dowels and tie bars according to Section 511 unless contradicted here. Ensure the holes are dry and free of dust and debris. Use a nozzle to insert the grout or epoxy starting at the back of the drilled hole to allow for full coating of the dowel or tie bar. After placement, use a bond breaker on the section of the dowel bar that is protruding from the hole.

Mix, place, finish, and cure concrete according to Section 501 with the exception that the Department will allow truck mixing, 2-bag mixers, and hand finishing.

When required, use a form on the side of the slab at longitudinal joints. When the adjacent traffic lane is not closed to traffic or the drop-off is not protected, temporarily fill the space between the form and the adjacent pavement with DGA. After placing the slab, remove the DGA and form. Fill the hole with concrete and thoroughly consolidate by rodding, spading, and sufficient vibration to form a dense homogeneous mass. Use a form on the side of the slab adjacent to shoulders. Excavate and backfill as shown on Section F'-F'.

For patches less than 25 feet in length, use a bond breaker and do not install tie bars at the longitudinal joint. Bond breakers should not exceed 1/8 inch in thickness, e.g. tar paper.

When resurfacing is required, a float finish is satisfactory. Otherwise, broom finish or, when the adjacent surface has a grooved finish, texture the surface according to Subsection 501.03.13 H). Finish the surface, including joints, to meet a surface tolerance of 1/8 inch in 10 feet that will be verified by straightedge. Cure the pavement and apply curing membranes according to 501.03.15.

Keep all pavement surfaces adjacent to this operation reasonably clean of excess grout and other materials at all times. Maintain all original longitudinal joints. Place transverse joints according to the details shown herein and on the Standard Drawings.

3.3 Joint Sealing. Seal all new or partially new joints with silicone rubber sealant or hot-poured elastic joint sealant according to Subsection 501.03.18.

4.0 MEASUREMENT.

4.1 Remove JPC Pavement. The Department will measure the quantity in square yards of surface area. The Department will not measure removal of

11J

underlying base material for payment and will consider it incidental to Remove JPC Pavement.

4.2 DGA or CSB. The Department will measure the quantity used to stabilize the existing base or to replace unsuitable material in tons. The Department will not measure removal of existing base material or underlying material for payment and will consider incidental to DGA or CSB. The quantity of DGA used for the drop-off protection shall be incidental to this work and will not be measured for payment.

4.3 JPC Pavement Non-Reinforced. The Department will measure according to 501.04.01. The Department will not measure dowels, tie bars, or joint sealing for payment and will consider it incidental to Non-Reinforced JPC Pavement.

JPC Pavement will be paid according to section 5.0 below and according to the following payment schedule based on the compressive strength. The cylinders for payment will be tested two hours prior the scheduled opening of traffic.

3000 psi and up	100% payment
2750 to 3000 psi	75% payment and approval from the Engineer to open to traffic*
2500 to 2750 psi	50% payment and approval from the Engineer to open to traffic*
2250 to 2500 psi	25% payment and approval from the Engineer to open to traffic*
Below 2250 psi	10% payment and no potential to open to traffic. Maintain traffic closure until concrete reaches a minimum of 2250 psi.

*If the Engineer approves opening to traffic, the Engineer will evaluate the concrete at 28 days (or sooner) to determine if the removal and replacement of the concrete is necessary due to pavement distress induced by the early opening (i.e. noticeable cracking). If required by the Engineer, remove and replace those slabs showing distress at no cost to the Department.

4.4 Underdrains. The Department will measure the quantity according to Subsection 704.04. The Department will not measure lateral drains for payment and will consider them incidental to the Underdrains.

5.0 PAYMENT. The Department will make payment for the completed and accepted quantities under the following:

<u>Code</u>	<u>Pay Item</u>	<u>Pay Unit</u>
----	Remove JPC Pavement	Square Yard
00001	DGA Base	Ton
00003	Crushed Stone Base	Ton
02069-02071, 02073, 02075, 02084, 02086, 02088	JPC Pavement Non-Reinforced, thickness	See Subsection 501.05
01000	Perforated Pipe, 4-inch	Linear Foot
02598, 02599	Fabric-Geotextile, Type	Square Yard

The Department will consider payment as full compensation for all work required in this provision.

June 15, 2012

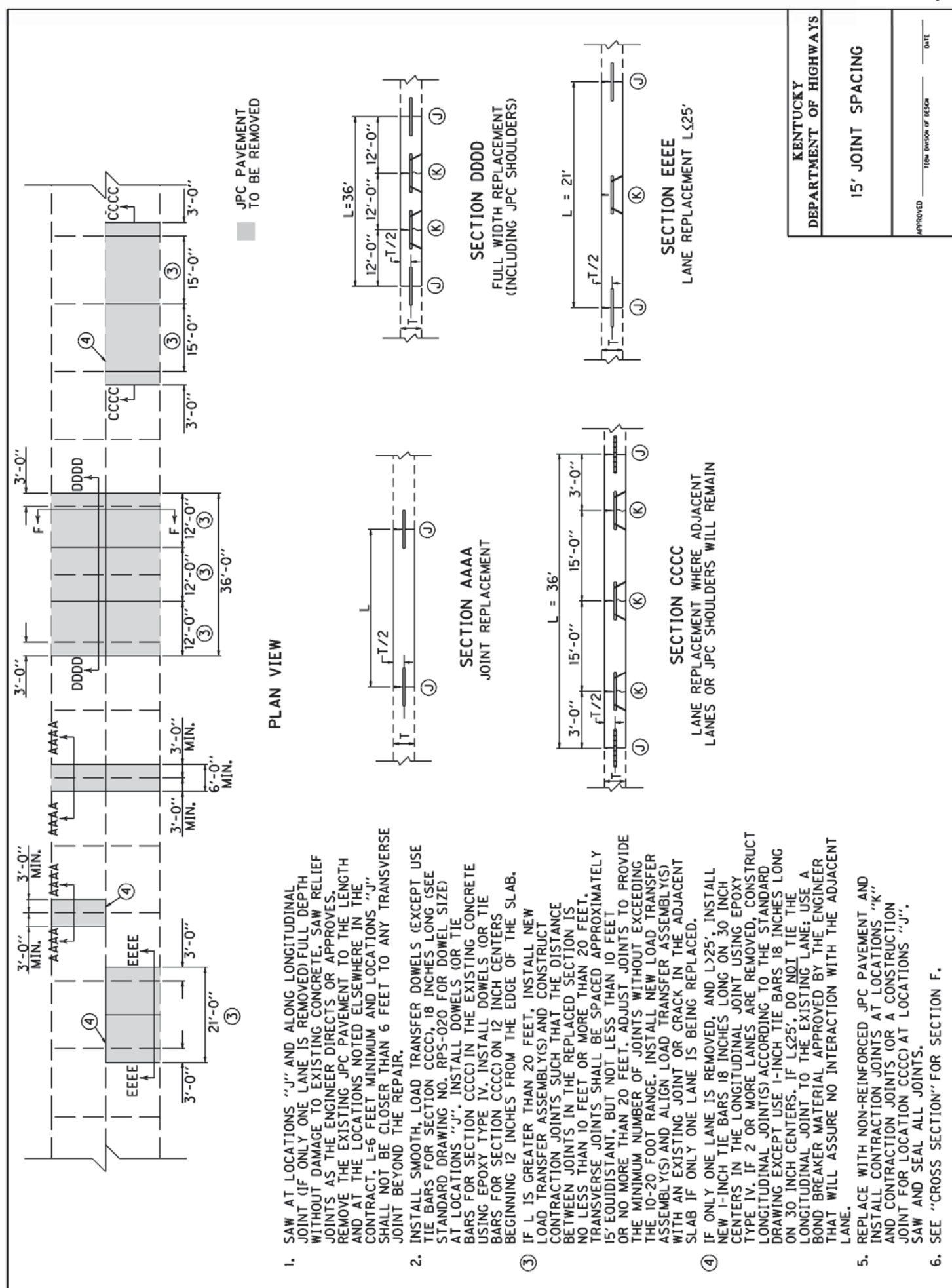

KENTUCKY DEPARTMENT OF HIGHWAYS
15' JOINT SPACING
APPROVED _____ DATE _____ TECH. DIVISION OF DESIGN

1. SAW AT LOCATIONS "J" AND ALONG LONGITUDINAL JOINT (IF ONLY ONE LANE IS REMOVED) FULL DEPTH WITHOUT DAMAGE TO EXISTING CONCRETE; SAW RELIEF JOINTS AS THE ENGINEER DIRECTS OR APPROVES. REMOVE THE EXISTING JPC PAVEMENT TO THE LENGTH AND AT THE LOCATIONS NOTED ELSEWHERE IN THE CONTRACT. L=6 FEET MINIMUM AND LOCATIONS "J" SHALL NOT BE CLOSER THAN 6 FEET TO ANY TRANSVERSE JOINT BEYOND THE REPAIR.
2. INSTALL SMOOTH, LOAD TRANSFER DOWELS (EXCEPT USE TIE BARS FOR SECTION CCCC); 18 INCHES LONG (SEE STANDARD DRAWING NO. RPS-020 FOR DOWEL SIZE) AT LOCATIONS "J". INSTALL DOWELS (OR TIE BARS FOR SECTION CCCC) IN THE EXISTING CONCRETE USING EPOXY TYPE IV. INSTALL DOWELS (OR TIE BARS FOR SECTION CCCC) ON 12 INCH CENTERS BEGINNING 12 INCHES FROM THE EDGE OF THE SLAB.
3. IF L IS GREATER THAN 20 FEET, INSTALL NEW LOAD TRANSFER ASSEMBLY(S) AND CONSTRUCT CONTRACTION JOINTS SUCH THAT THE DISTANCE BETWEEN JOINTS IN THE REPLACED SECTION IS NO LESS THAN 10 FEET OR MORE THAN 20 FEET. TRANSVERSE JOINTS SHALL BE SPACED APPROXIMATELY 15' EQUIDISTANT, BUT NOT LESS THAN 10 FEET OR NO MORE THAN 20 FEET. ADJUST JOINTS TO PROVIDE THE MINIMUM NUMBER OF JOINTS WITHOUT EXCEEDING THE 10-20 FOOT RANGE. INSTALL NEW LOAD TRANSFER ASSEMBLY(S) AND ALIGN LOAD TRANSFER ASSEMBLY(S) WITH AN EXISTING JOINT OR CRACK IN THE ADJACENT SLAB IF ONLY ONE LANE IS BEING REPLACED.
4. IF ONLY ONE LANE IS REMOVED, AND L>25', INSTALL NEW 1-INCH TIE BARS 18 INCHES LONG ON 30 INCH CENTERS IN THE LONGITUDINAL JOINT USING EPOXY TYPE IV. IF 2 OR MORE LANES ARE REMOVED, CONSTRUCT LONGITUDINAL JOINT(S) ACCORDING TO THE STANDARD DRAWING EXCEPT USE 1-INCH TIE BARS 18 INCHES LONG ON 30 INCH CENTERS. IF L<25', DO NOT TIE THE LONGITUDINAL JOINT TO THE EXISTING LANE; USE A BOND BREAKER MATERIAL APPROVED BY THE ENGINEER THAT WILL ASSURE NO INTERACTION WITH THE ADJACENT LANE.
5. REPLACE WITH NON-REINFORCED JPC PAVEMENT AND INSTALL CONTRACTION JOINTS AT LOCATIONS "K" AND CONTRACTION JOINTS (OR A CONTRACTION JOINT FOR LOCATION CCCC) AT LOCATIONS "J". SAW AND SEAL ALL JOINTS.
6. SEE "CROSS SECTION" FOR SECTION F.

1. SAW AT LOCATIONS "J" AND ALONG LONGITUDINAL JOINT (IF ONLY ONE LANE IS REMOVED) FULL DEPTH WITHOUT DAMAGE TO EXISTING CONCRETE. SAW RELIEF JOINTS AS THE ENGINEER DIRECTS OR APPROVES. REMOVE THE EXISTING JPC PAVEMENT TO THE LENGTH AND AT THE LOCATIONS NOTED ELSEWHERE IN THE CONTRACT. L=6 FEET MINIMUM AND LOCATIONS "J" SHALL NOT BE CLOSER THAN 6 FEET TO ANY TRANSVERSE JOINT BEYOND THE REPAIR.
2. INSTALL SMOOTH, LOAD TRANSFER DOWELS (EXCEPT USE TIE BARS FOR SECTION C), 18 INCHES LONG (SEE STANDARD DRAWING NO. RPS-020 FOR DOWEL SIZE) AT LOCATIONS "J". INSTALL DOWELS (OR TIE BARS FOR SECTION C) IN THE EXISTING CONCRETE USING EPOXY TYPE IV. INSTALL DOWELS (OR TIE BARS FOR SECTION C) ON 12 INCH CENTERS BEGINNING 12 INCHES FROM THE EDGE OF THE SLAB. IF L IS GREATER THAN 20 FEET, INSTALL NEW LOAD TRANSFER ASSEMBLY(S) AND CONSTRUCT CONTRACTION JOINTS SUCH THAT THE DISTANCE BETWEEN JOINTS IN THE REPLACED SECTION IS NO LESS THAN 10 FEET OR MORE THAN 20 FEET. TRANSVERSE JOINTS SHALL BE SPACED APPROXIMATELY 15' EQUIDISTANT, BUT NOT LESS THAN 10 FEET OR NO MORE THAN 20 FEET. ADJUST JOINTS TO PROVIDE THE MINIMUM NUMBER OF JOINTS WITHOUT EXCEEDING THE 10-20 FOOT RANGE. INSTALL NEW LOAD TRANSFER ASSEMBLY(S) AND ALIGN LOAD TRANSFER ASSEMBLY(S) WITH AN EXISTING JOINT OR CRACK IN THE ADJACENT SLAB IF ONLY ONE LANE IS BEING REPLACED.
3. IF ONLY ONE LANE IS REMOVED, AND L > 25', INSTALL NEW 1-INCH TIE BARS 18 INCHES LONG ON 30 INCH CENTERS IN THE LONGITUDINAL JOINT USING EPOXY TYPE IV. IF 2 OR MORE LANES ARE REMOVED, CONSTRUCT LONGITUDINAL JOINT(S) ACCORDING TO THE STANDARD DRAWING EXCEPT USE 1-INCH TIE BARS 18 INCHES LONG ON 30 INCH CENTERS. IF L > 25', DO NOT TIE THE LONGITUDINAL JOINT TO THE EXISTING LANE; USE A BOND BREAKER MATERIAL APPROVED BY THE ENGINEER THAT WILL ASSURE NO INTERACTION WITH THE ADJACENT LANE.
4. REPLACE WITH NON-REINFORCED JPC PAVEMENT AND INSTALL CONTRACTION JOINTS AT LOCATIONS "K" AND CONTRACTION JOINTS (OR A CONSTRUCTION JOINT FOR LOCATION C) AT LOCATIONS "J". SAW AND SEAL ALL JOINTS.
6. SEE "CROSS SECTION" FOR SECTION F.

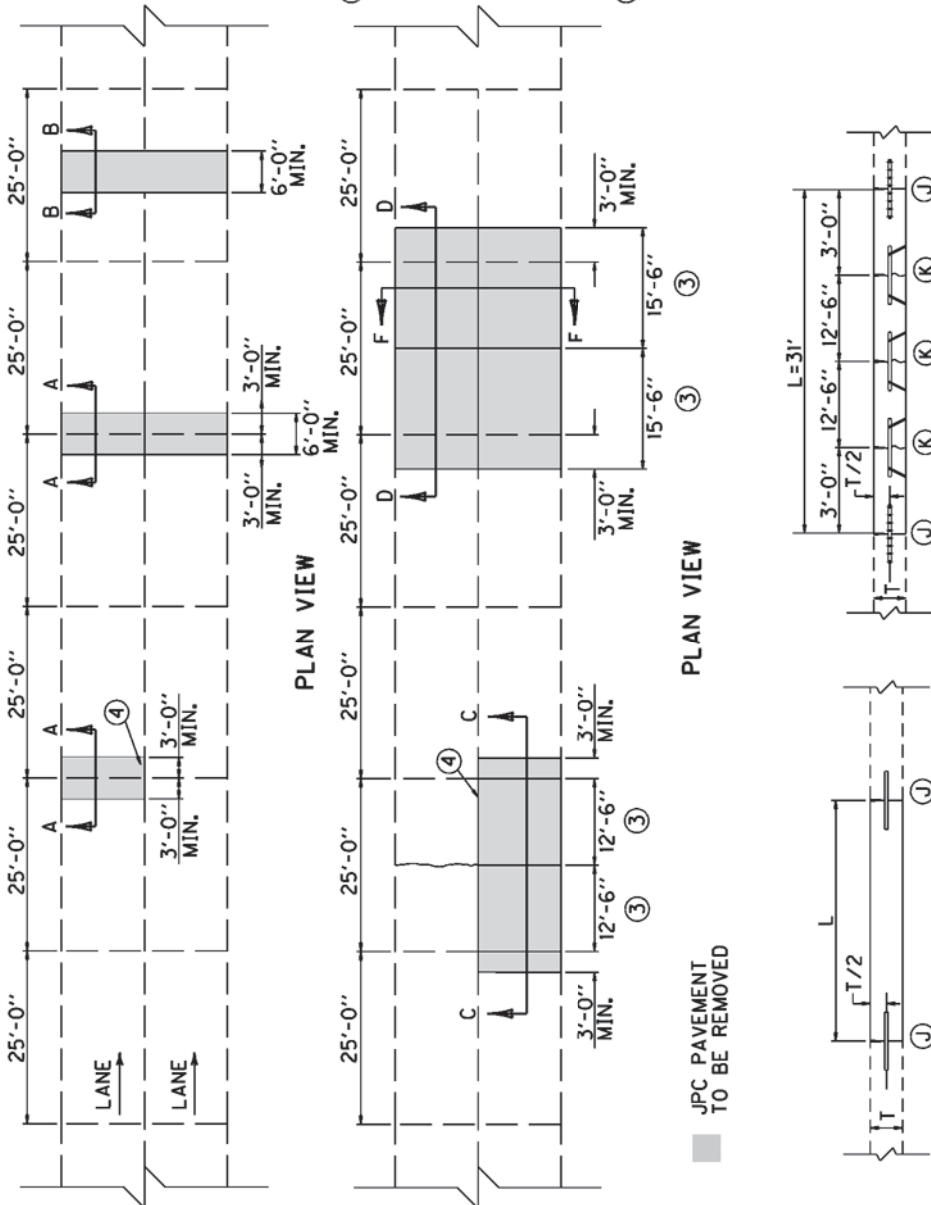

SECTION A
JOINT REPLACEMENT

SECTION B
MID-SLAB REPLACEMENT

SECTION C
LANE REPLACEMENT WHERE ADJACENT LANES OR JPC SHOULDERS WILL REMAIN

SECTION D
FULL WIDTH REPLACEMENT (INCLUDING JPC SHOULDERS)

KENTUCKY DEPARTMENT OF HIGHWAYS
25' JOINT SPACING
APPROVED _____ DATE _____ TECHNICAL DIVISION OF DESIGN

1. SAW AT LOCATIONS "J" AND ALONG LONGITUDINAL JOINT (IF ONLY ONE LANE IS REMOVED) FULL DEPTH WITHOUT DAMAGE TO EXISTING CONCRETE. SAW RELIEF JOINTS AS THE ENGINEER DIRECTS OR APPROVES. REMOVE THE EXISTING JPC PAVEMENT TO THE LENGTH AND AT THE LOCATIONS NOTED ELSEWHERE IN THE CONTRACT. L=6 FEET MINIMUM AND LOCATIONS "J" SHALL NOT BE CLOSER THAN 6 FEET TO ANY TRANSVERSE JOINT BEYOND THE REPAIR.
2. INSTALL SMOOTH, LOAD TRANSFER DOWELS (EXCEPT USE TIE BARS FOR SECTION CC), 18 INCHES LONG (SEE STANDARD DRAWING NO. RPS-020 FOR DOWEL SIZE) AT LOCATIONS "J". INSTALL DOWELS OR TIE BARS FOR SECTION CC IN THE EXISTING CONCRETE USING EPOXY TYPE IV. INSTALL DOWELS OR TIE BARS FOR SECTION CC ON 12 INCH CENTERS BEGINNING 12 INCHES FROM THE EDGE OF THE SLAB.
3. IF L IS GREATER THAN 20 FEET, INSTALL NEW LOAD TRANSFER ASSEMBLY(S) AND CONSTRUCT CONTRACTION JOINTS SUCH THAT THE DISTANCE BETWEEN JOINTS IN THE REPLACED SECTION IS NO LESS THAN 10 FEET OR MORE THAN 20 FEET. TRANSVERSE JOINTS SHALL BE SPACED APPROXIMATELY 15' EQUIDISTANT, BUT NOT LESS THAN 10 FEET OR NO MORE THAN 20 FEET. ADJUST JOINTS TO PROVIDE THE MINIMUM NUMBER OF JOINTS WITHOUT EXCEEDING THE 10-20 FOOT RANGE. INSTALL NEW LOAD TRANSFER ASSEMBLY(S) AND ALIGN LOAD TRANSFER ASSEMBLY(S) WITH AN EXISTING JOINT OR CRACK IN THE ADJACENT SLAB IF ONLY ONE LANE IS BEING REPLACED.
4. IF ONLY ONE LANE IS REMOVED, AND L>25', INSTALL NEW 1-INCH TIE BARS 18 INCHES LONG ON 30 INCH CENTERS IN THE LONGITUDINAL JOINT USING EPOXY TYPE IV. IF 2 OR MORE LANES ARE REMOVED, CONSTRUCT LONGITUDINAL JOINT(S) ACCORDING TO THE STANDARD DRAWING EXCEPT USE 1-INCH TIE BARS 18 INCHES LONG ON 30 INCH CENTERS. IF L<25', DO NOT TIE THE LONGITUDINAL JOINT TO THE EXISTING LANE; USE A BOND BREAKER MATERIAL APPROVED BY THE ENGINEER THAT WILL ASSURE NO INTERACTION WITH THE ADJACENT LANE.
5. REPLACE WITH NON-REINFORCED JPC PAVEMENT AND INSTALL CONTRACTION JOINTS AT LOCATIONS "K" AND CONTRACTION JOINTS FOR A CONSTRUCTION JOINT FOR LOCATION CC AT LOCATIONS "J". SAW AND SEAL ALL JOINTS.
6. SEE "CROSS SECTION" FOR SECTION F.

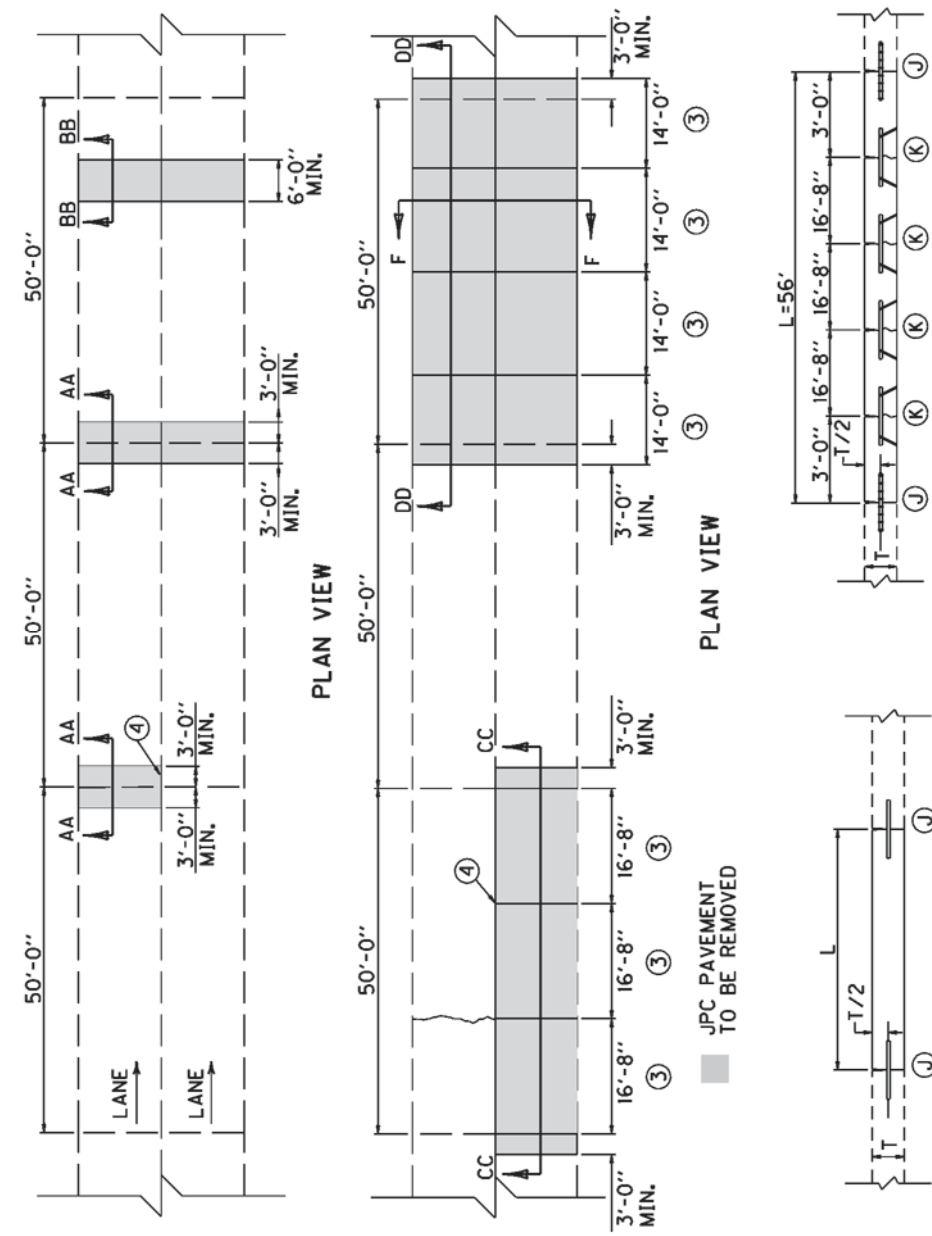

SECTION CC
LANE REPLACEMENT WHERE ADJACENT LANES OR JPC SHOULDERS WILL REMAIN

SECTION AA
JOINT REPLACEMENT

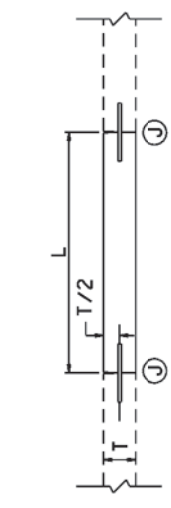
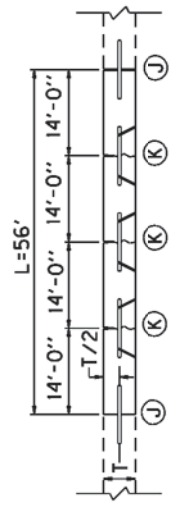

SECTION DD
FULL WIDTH REPLACEMENT
(INCLUDING JPC SHOULDERS)

SECTION BB
MID-SLAB REPLACEMENT

KENTUCKY
DEPARTMENT OF HIGHWAYS
50' JOINT SPACING
SUBMITTED: _____ TEAM OFFICE OF DESIGN _____ DATE _____

1. SAW AT LOCATIONS "J" AND ALONG LONGITUDINAL JOINT (IF ONLY ONE LANE IS REMOVED) FULL DEPTH WITHOUT DAMAGE TO EXISTING CONCRETE. SAW RELIEF JOINTS AS THE ENGINEER DIRECTS OR APPROVES. REMOVE THE EXISTING JPC PAVEMENT TO THE LENGTH AND AT THE LOCATIONS NOTED ELSEWHERE IN THE CONTRACT. L=6 FEET MINIMUM AND LOCATIONS "J" SHALL NOT BE CLOSER THAN 6 FEET TO ANY TRANSVERSE JOINT BEYOND THE REPAIR.
2. INSTALL SMOOTH, LOAD TRANSFER DOWELS (EXCEPT USE TIE BARS FOR SECTION DDD), 18 INCHES LONG. (SEE STANDARD DRAWING NO. RPS-020 FOR DOWEL SIZE) AT LOCATIONS "J". INSTALL DOWELS (OR TIE BARS FOR SECTION DDD) IN THE EXISTING CONCRETE USING EPOXY TYPE IV. INSTALL DOWELS (OR TIE BARS FOR SECTION DDD) ON 12 INCH CENTERS BEGINNING 12 INCHES FROM THE EDGE OF THE SLAB. IF L IS GREATER THAN 20 FEET, INSTALL NEW LOAD TRANSFER ASSEMBLY(S) AND MATCH EXISTING JOINTS. INSTALL NEW LOAD TRANSFER ASSEMBLY(S) AND ALIGN LOAD TRANSFER ASSEMBLY(S) WITH EXISTING JOINTS IN ADJACENT SLABS.
- ④ IF ONLY ONE LANE IS REMOVED, AND $L > 25'$, INSTALL NEW 1-INCH TIE BARS 18 INCHES LONG ON 30 INCH CENTERS IN THE LONGITUDINAL JOINT USING EPOXY TYPE IV. IF 2 OR MORE LANES ARE REMOVED, CONSTRUCT LONGITUDINAL JOINT(S) ACCORDING TO THE STANDARD DRAWING EXCEPT USE 1-INCH TIE BARS 18 INCHES LONG ON 30 INCH CENTERS. IF $L > 25'$, DO NOT TIE THE LONGITUDINAL JOINT TO THE EXISTING LANE; USE A BOND BREAKER MATERIAL APPROVED BY THE ENGINEER THAT WILL ASSURE NO INTERACTION WITH THE ADJACENT LANE.
5. REPLACE WITH NON-REINFORCED JPC PAVEMENT AND INSTALL CONTRACTION JOINTS AT LOCATIONS "K". AND CONTRACTION JOINTS (OR A CONSTRUCTION JOINT FOR LOCATION DDD) AT LOCATIONS "J". SAW AND SEAL ALL JOINTS.
6. SEE "CROSS SECTION" FOR SECTION F.

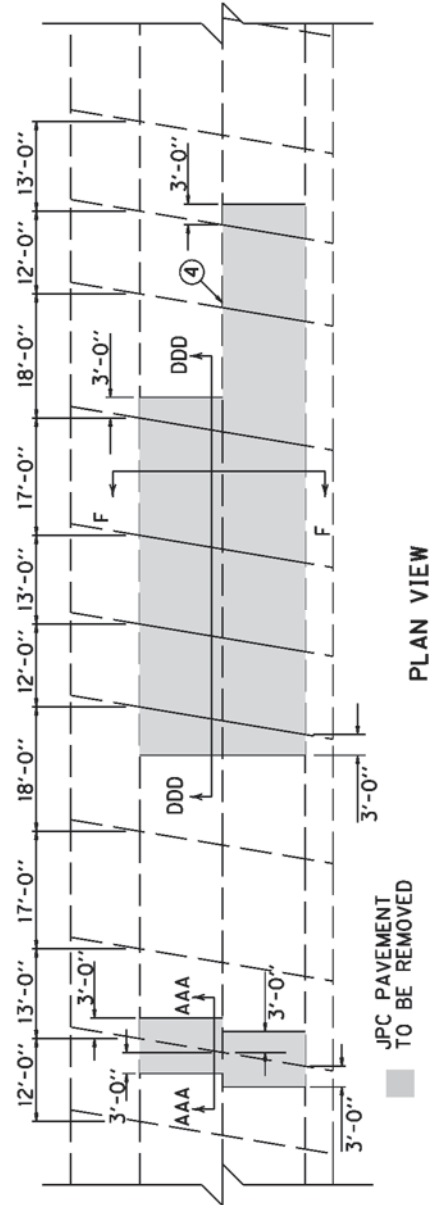

PLAN VIEW

JPC PAVEMENT TO BE REMOVED



SECTION AAA
JOINT REPLACEMENT

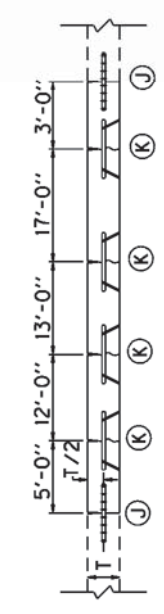

SECTION DDD
LANE REPLACEMENT
(ALWAYS MATCH EXISTING JOINTS)

KENTUCKY DEPARTMENT OF HIGHWAYS
RANDOM SKEWED
APPROVED _____ DATE _____ TECHNICAL ENGINEER

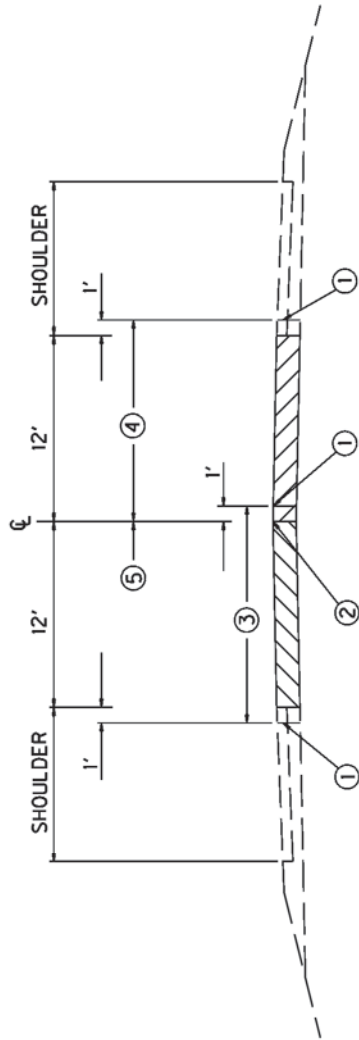

SECTION F

- ① SAW-CUT LINE. THIS ONE FOOT IS TO ALLOW FOR A FORM AND THE REMOVAL AND REPLACEMENT SHALL BE INCIDENTAL TO THE WORK, EXCEPT NEW ASPHALT MIXTURE SHALL BE PAID DIRECT ON A TONNAGE BASIS, AND NEW JPC PAVEMENT WILL BE PAID BY THE SQUARE YARD. COMPACT THE DGA BASE BY MECHANICAL TAMPERS TO THE ENGINEER'S SATISFACTION.
- ② EXISTING LONGITUDINAL JOINT.
- ③ FIRST SLAB REMOVAL LIMITS AND REPLACE 12-FOOT LANE.
- ④ SECOND SLAB REMOVAL LIMITS AND REPLACE 12-FOOT LANE.
- ⑤ THIS ONE FOOT IS TO ALLOW FOR A FORM ON THE FIRST POUR, AND A TEMPORARY PAVEMENT IS REQUIRED. THE DEPARTMENT WILL NOT REQUIRE REMOVAL OF THIS ONE FOOT IF THE GRADE OF THE EXISTING PAVEMENT IS ADEQUATE TO ENSURE THE NEW CONCRETE CAN BE PLACED AND FINISHED TO THE SATISFACTION OF THE ENGINEER. ANY TEMPORARY PAVEMENT IS INCIDENTAL TO JPC PAVEMENT.
6. THE ABOVE DRAWING DEPICTS THE ORDER OF SLAB REMOVAL WHEN BOTH ARE TO BE REMOVED AT THE SAME LOCATION. WHEN ONLY ONE SLAB OR LANE IS TO BE REMOVED, REMOVE AND REPLACE ACCORDING TO SECTION C, CC, OR CCCC. TRAFFIC CONTROL WILL SPECIFY WHICH LANE TO REMOVE FIRST.

KENTUCKY DEPARTMENT OF HIGHWAYS
CROSS SECTION
APPROVED _____ DATE _____ <small>TEAM DIVISION OF NELSON</small>

COUNTY OF	ITEM NO.	SHEET NO.
BULLITT	5-9900.00	26

TYPICAL SECTION LEFT TURN LANES

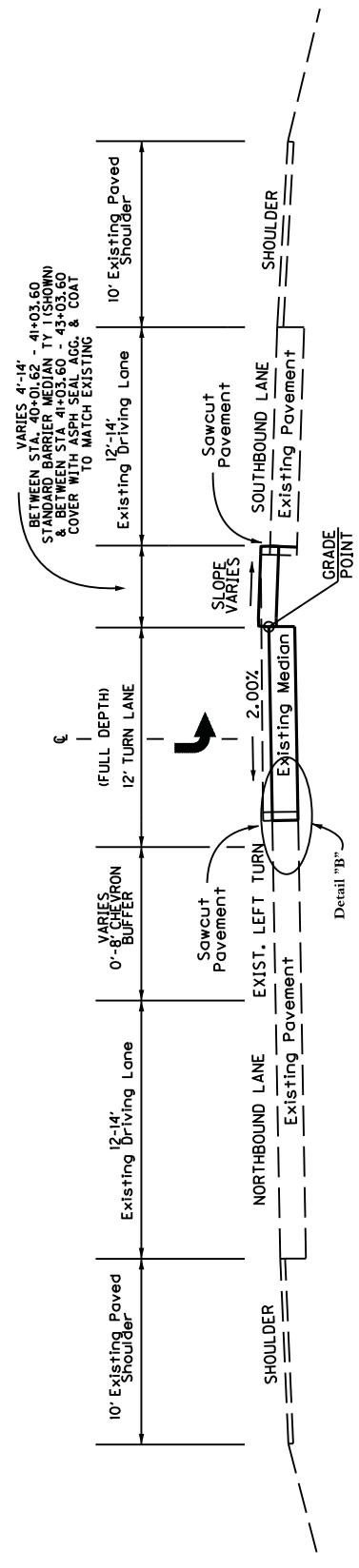

Preston Hwy (KY 61)
(Sta. 40+01.62 to Sta. 43+03.60)

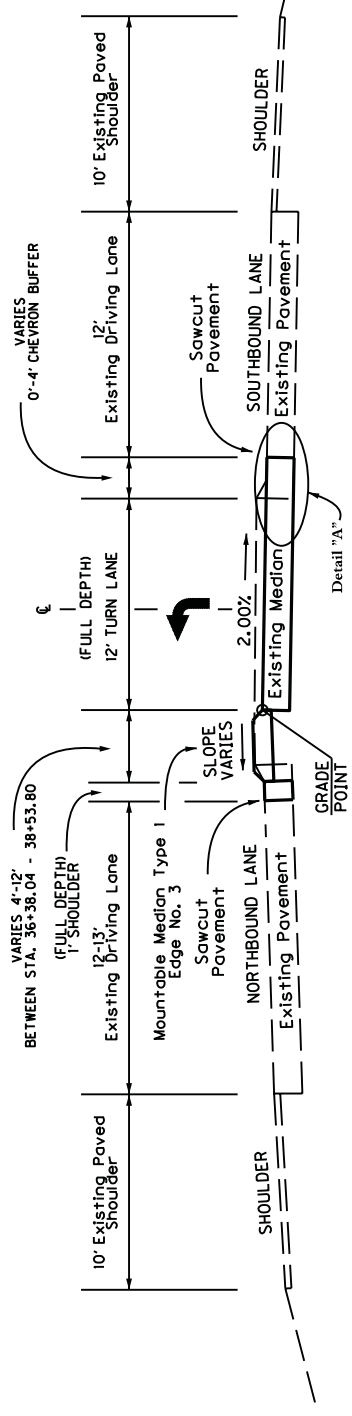

Preston Hwy (KY 61)
(Sta. 36+38.04 to Sta. 38+53.80)

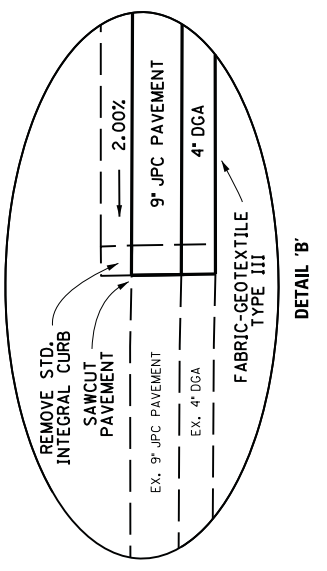

DETAIL 'B'

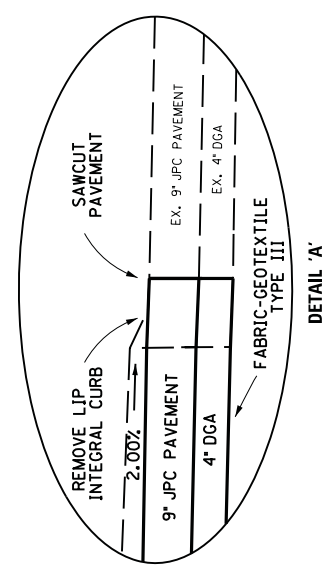

DETAIL 'A'

PAVEMENT DESIGN

LEFT TURN LANE ADDITION
JPC PAVEMENT
DGA

9\"/>

NO SCALE

KY 61 (PRESTON HWY)
LEFT TURN LANES
TYPICAL SECTION

PREPARED BY	DATE
CHECKED BY	DATE
APPROVED BY	DATE

USER: *****
DATE: ****AT****
FILE NAME: ****designfiles****
E-SHEET NAME: *****

COUNTY OF BULLITT
ITEM NO. 5-090.00
SHEET 10

PAVING SUMMARY

ITEM CODE	ITEM	UNIT	QTY	PROJECT TOTAL
00001	DGA BASE	TON	240	240
00100	ASPHALT SEAL AGGREGATE	TON	3.1	3.1
00103	ASPHALT SEAL COAT	TON	0.38	0.38
02073	JPC PAVEMENT - 9 IN	SY	602	602

PAVING AREAS

ITEM	QTY	PROJECT TOTAL
DGA BASE	240	240
ASPHALT SEAL AGGREGATE	3.1	3.1
ASPHALT SEAL COAT	0.38	0.38
JPC PAVEMENT - 9 IN	602	602

PAVING SUMMARY NOTES
ALL ASPHALT MIXTURES SHALL BE ESTIMATED AT 110 LBS. PER SQ. YD. PER INCH OF DEPTH, UNLESS NOTED OTHERWISE.
① ESTIMATED AT 115 LBS. PER SQ. YD. PER INCH OF DEPTH.
② ESTIMATED AT 100 LBS. PER SQ. YD. PER INCH OF DEPTH.
③ ESTIMATED AT 95 LBS. PER SQ. YD. PER INCH OF DEPTH.
④ ESTIMATED AT 20 LBS. PER SQ. YD. (TWO APPLICATIONS REQ.)
⑤ ESTIMATED AT 2.4 LBS. PER SQ. YD. (TWO APPLICATIONS REQ.)

GENERAL SUMMARY

ITEM	DESCRIPTION	UNIT	QTY	PROJECT TOTAL
01830	STANDARD INTEGRAL CURB	LF	201	201
01904	REMOVE CURB	LF	829	829
01915	STANDARD BARRIER MEDIAN TYPE 1	SV	53	53
01936	MOUNTABLE MEDIAN TYPE 1	SV	144	144
02009	REMOVE ASPHALT MEDIAN	SV	313	313
02074	BARRICADE TYPE III	EA	4	4
02058	REMOVE PCC PAVEMENT	SY	76	76
02200	ROADWAY EXCAVATION	CY	344	344
02562	TEMPORARY SIGNS	SF	152	152
02569	DEMOLITION	LS	1	1
02588	FABRIC-GEOTEXTILE TYPE III	SY	900	900
02650	MAINTAIN & CONTROL TRAFFIC	LS	1	1
02726	STAKING	LS	1	1
08514	PAVE STRIPING-PERM PAINT-4 IN	LF	2,000	2,000
20550ND	SAWCUT PAVEMENT	LF	836	836
24679ED	PAVE MARK THERMO CHEVRON	SF	140	140

GENERAL SUMMARY NOTES:

- ① REMOVAL AND HAUL OFF OF EXISTING PAVEMENT, ROCK OR SOIL INCIDENTAL TO ROADWAY EXCAVATION.
- ② PROPOSED EDGE NO. 3 SHOWN ON PLANS & CROSS SECTIONS STA. 36+38.04 - STA. 38+53.80
- ③ REMOVE & REPLACE EXISTING CONCRETE SLAB LOCATIONS AS SHOWN ON THE PLANS
- ④ CONCRETE SURFACE SHALL BE PREPARED ACCORDING TO STANDARD SPECS PRIOR TO THERMO APPLICATION ON CONCRETE
- ⑤ FOR PROTECTION OF PAVEMENT REMOVAL AREAS

PREPARED BY _____ DATE _____
CHECKED BY _____ DATE _____
APPROVED BY _____ DATE _____

USER: \$\$\$SER\$\$\$
DATE: \$\$\$DATE\$\$\$
FILE NAME: \$\$\$DESIGNFILES\$\$\$SPECIFICATIONS\$\$\$
E-SHEET NAME: _____

GENERAL SUMMARY

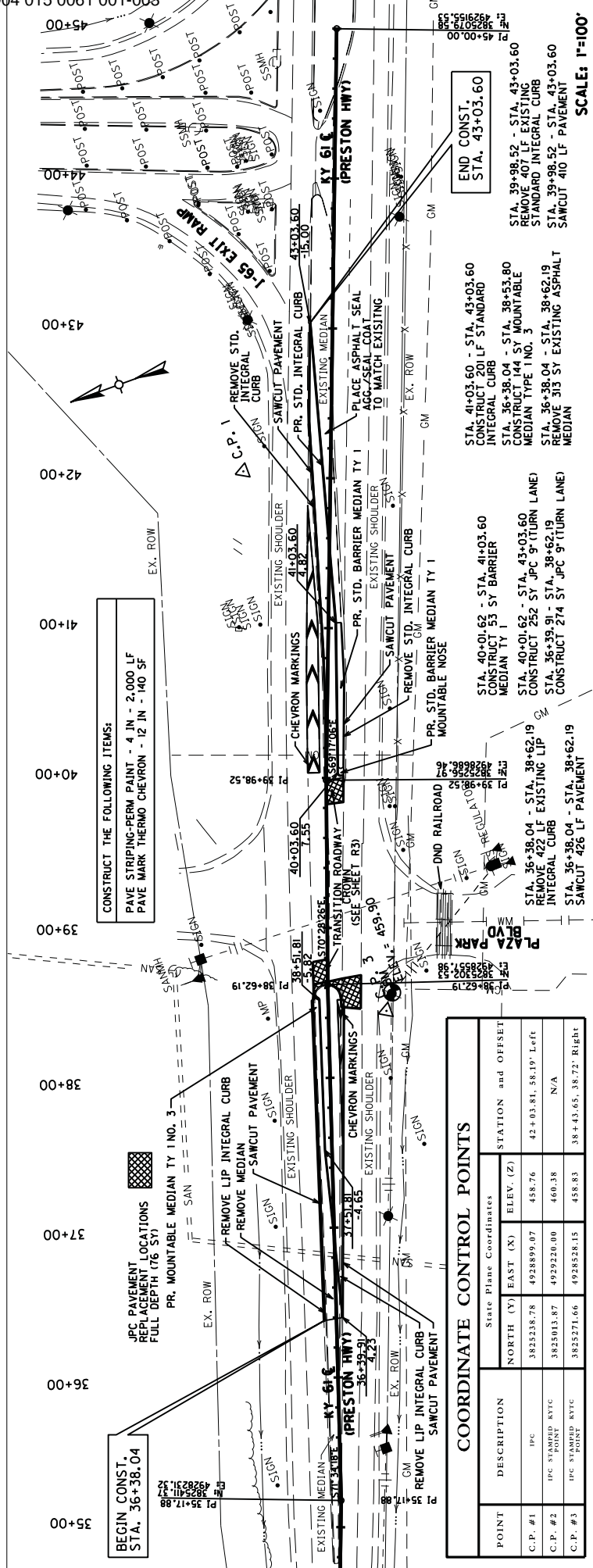

COORDINATE CONTROL POINTS

POINT	DESCRIPTION	State Plane Coordinates		STATION and OFFSET
		NORTH (Y)	EAST (X)	
C.P. #1	IPC	3825238.78	4928899.07	458.76
C.P. #2	IPC MARKED NYC POINT	3825015.87	4929220.00	N/A
C.P. #3	IPC MARKED NYC POINT	3825271.66	4928228.15	458.83

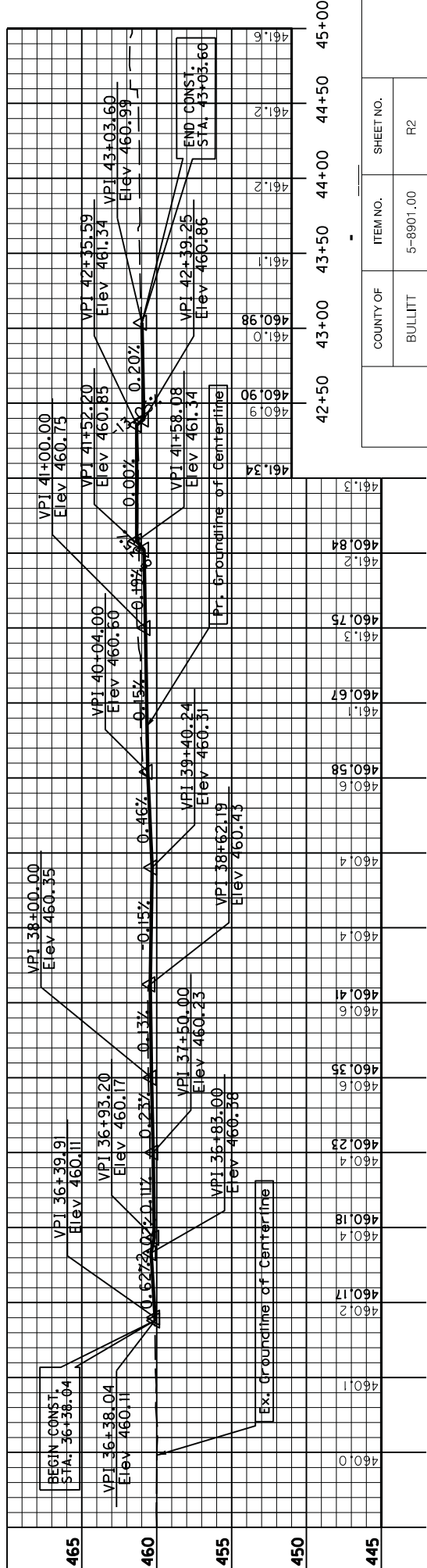

COUNTY OF	ITEM NO.	SHEET NO.
BULLITT	5-8901.00	R2

**KY 61C (PRESTON HWY)
PLAN & PROFILE
STA. 36+38.04 - 43+03.60**

SCALE: 1" = 100' HORIZONTAL
1" = 10' VERTICAL

Project Coordinates
Horizontal coordinates on control point 1 was obtained from an OPUS solution and is based on NAVD83 vertical datum. These coordinates are State Plane Coordinates (NAD83) Kentucky North Zone and in US Survey Feet. The Grid North used was GEOID20A.

BEFORE YOU DIG
THE CONTRACTOR SHALL VERIFY THE LOCATION OF ALL UTILITIES AND SHALL BE RESPONSIBLE FOR OBTAINING ALL NECESSARY PERMITS FROM THE LOCAL GOVERNMENT AND UTILITIES. THE CALL IS TO BE PLACED AT LEAST 48 HOURS PRIOR TO EXCAVATION. THE CONTRACTOR SHALL BE WAIVED THAT THE CONTRACTOR SHALL BE RESPONSIBLE FOR OBTAINING ALL NECESSARY PERMITS FROM THE LOCAL GOVERNMENT AND UTILITIES. IT MAY BE NECESSARY FOR THE CONTRACTOR TO CONTACT THE COUNTY ENGINEER TO OBTAIN THE LOCATION OF UTILITIES AND TO OBTAIN THE NECESSARY PERMITS FROM THE LOCAL GOVERNMENT AND UTILITIES.

COUNTY OF	ITEM NO.	SHEET NO.
BULLITT	5-9900.00	83

SOUTHBOUND LEFT TURN LANE

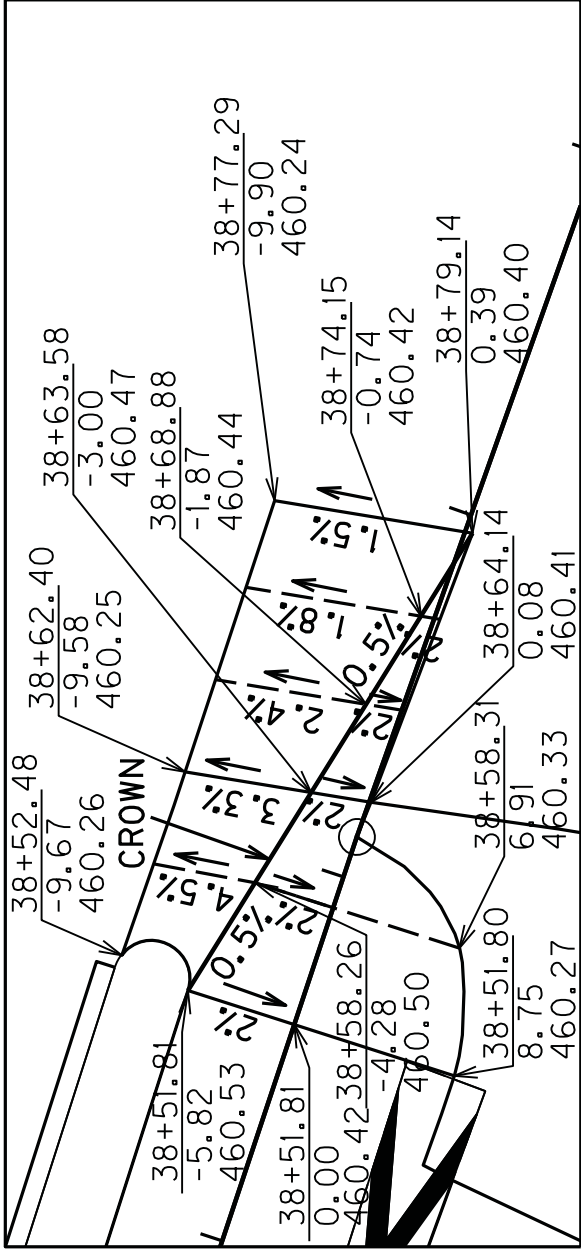

NORTHBOUND LEFT TURN LANE

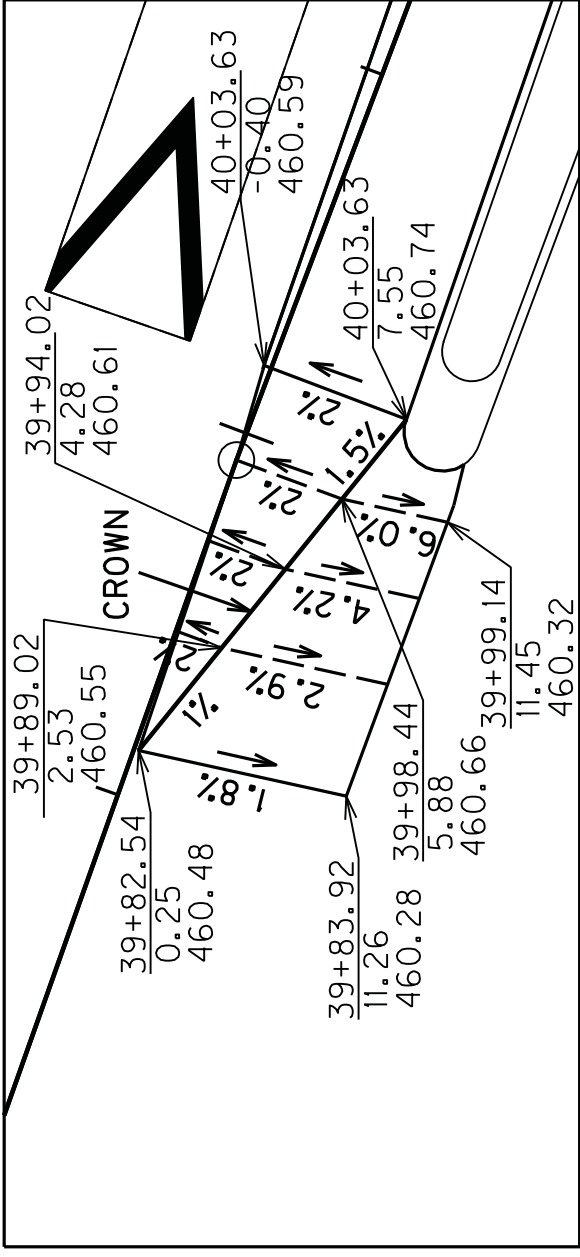

PREPARED BY	DATE
CHECKED BY	DATE
APPROVED BY	DATE

USER: \$\$\$USER\$\$\$
 DATE: \$\$\$DATE\$\$\$
 FILE NAME: \$\$\$designfiles\$\$\$
 E-SHEET NAME: \$\$\$E-SHEET NAME\$\$\$

SCALE: 1"=10'

KY 61 (PRESTON HWY)
 LEFT TURN LANES
 INTERSECTION DETAIL

COUNTY OF	ITEM NO.	SHEET NO.
BULLITT	5-8900.00	31
470		
460		460
450		450
	COM 12.94 \$0 FT EMB 0.01 \$0 FT	90
		80
		70
		60
		50
		40
		30
		20
		10
		0
		-10
		-20
		-30
		-40
		-50
		-60
		-70
		-80
		-90
470		470
460		460
450		450
	COM 11.88 \$0 FT EMB 0.01 \$0 FT	90
		80
		70
		60
		50
		40
		30
		20
		10
		0
		-10
		-20
		-30
		-40
		-50
		-60
		-70
		-80
		-90
470		470
460		460
450		450
	COM 15.38 \$0 FT EMB 0.02 \$0 FT	90
		80
		70
		60
		50
		40
		30
		20
		10
		0
		-10
		-20
		-30
		-40
		-50
		-60
		-70
		-80
		-90
470		470
460		460
450		450
	COM 0.00 \$0 FT EMB 0.00 \$0 FT	90
		80
		70
		60
		50
		40
		30
		20
		10
		0
		-10
		-20
		-30
		-40
		-50
		-60
		-70
		-80
		-90

USER: _____
DATE: _____
FILE NAME: _____
E-SHEET NAME: _____

SCALE: H = 20' HORIZONTAL
V = 20' VERTICAL

COM 0.00 CU YDS
EMB 0.00 CU YDS

COM 0.00 CU YDS
EMB 0.00 CU YDS

COM 0.00 CU YDS
EMB 0.00 CU YDS

COM 0.00 CU YDS
EMB 0.00 CU YDS

COM 0.00 CU YDS
EMB 0.00 CU YDS

COM 0.00 CU YDS
EMB 0.00 CU YDS

QUANTITIES ARE PROVIDED FOR
INFORMATION ONLY AND ARE
THE CONTRACTOR'S RESPONSIBILITY

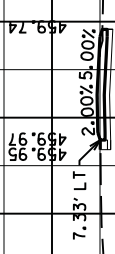
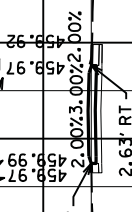
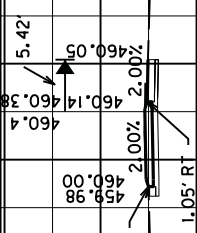

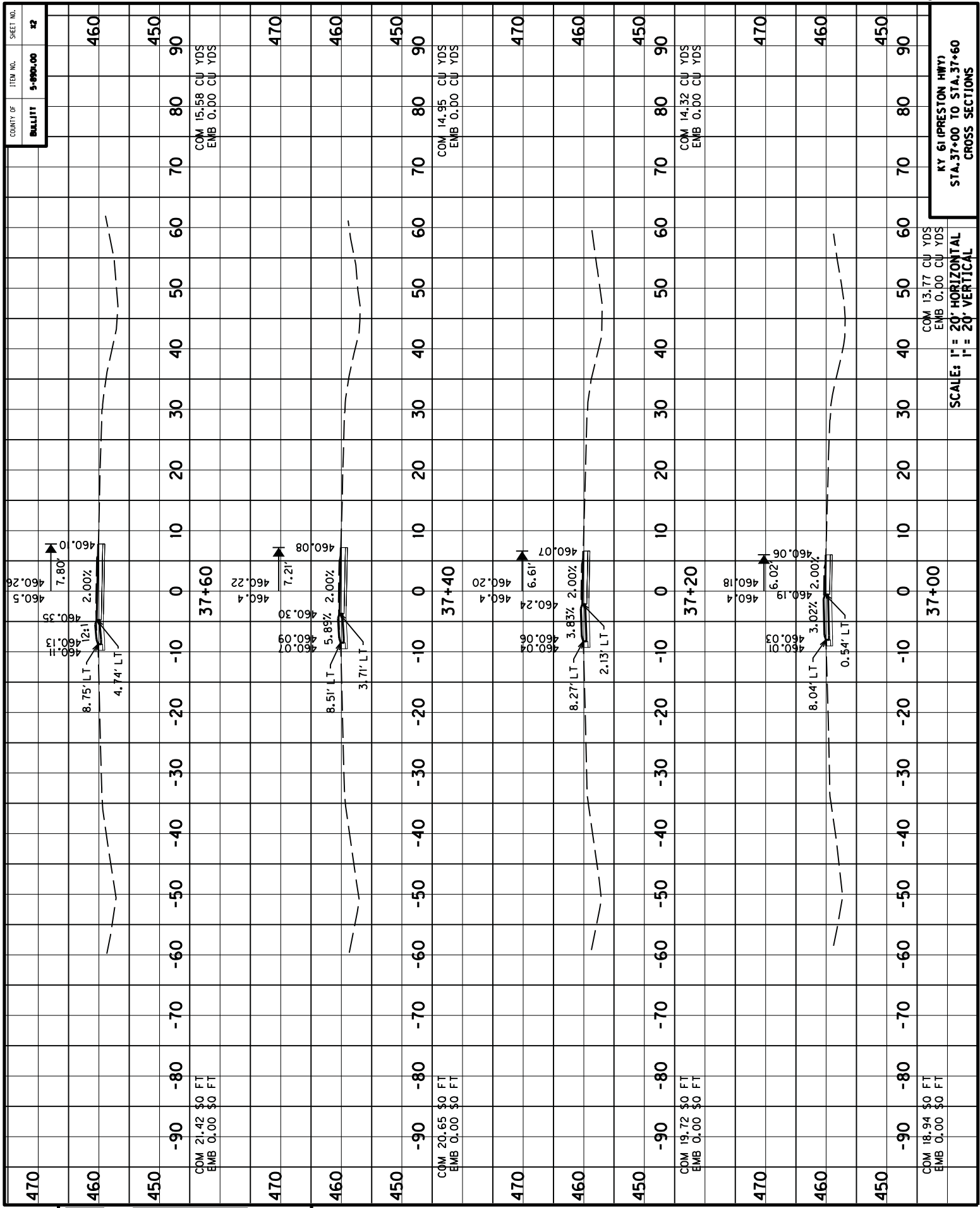

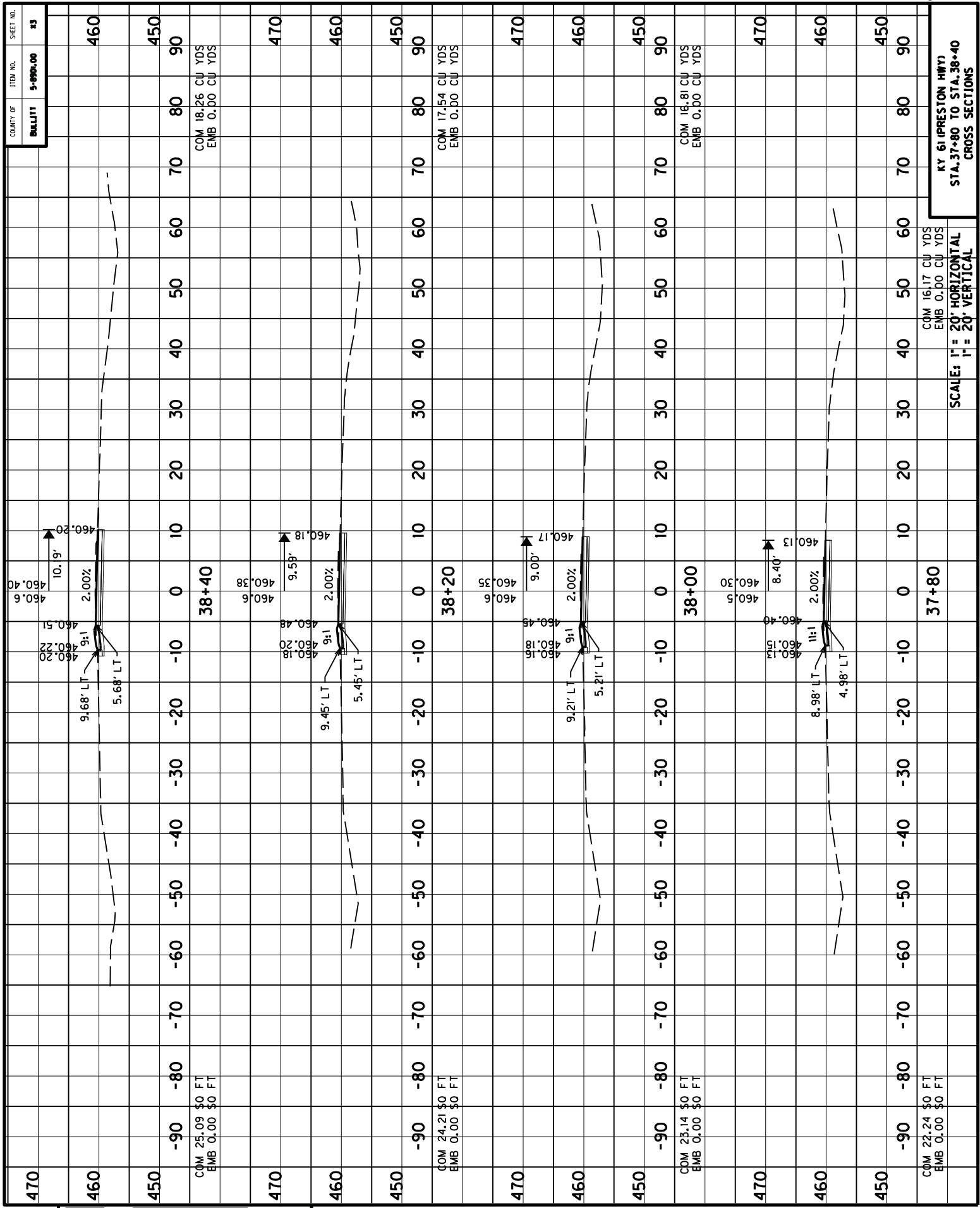

FILE NAME:
DATE:
USER:

SCALE: H = 20' HORIZONTAL
V = 20' VERTICAL

COM 16.17 CU YDS
EMB 0.00 CU YDS

COM 16.81 CU YDS
EMB 0.00 CU YDS

COM 17.54 CU YDS
EMB 0.00 CU YDS

COM 18.26 CU YDS
EMB 0.00 CU YDS

COM 16.17 CU YDS
EMB 0.00 CU YDS

COM 16.81 CU YDS
EMB 0.00 CU YDS

COM 17.54 CU YDS
EMB 0.00 CU YDS

COM 18.26 CU YDS
EMB 0.00 CU YDS

COM 16.17 CU YDS
EMB 0.00 CU YDS

COM 16.81 CU YDS
EMB 0.00 CU YDS

COM 17.54 CU YDS
EMB 0.00 CU YDS

COM 18.26 CU YDS
EMB 0.00 CU YDS

COM 16.17 CU YDS
EMB 0.00 CU YDS

COM 16.81 CU YDS
EMB 0.00 CU YDS

COM 17.54 CU YDS
EMB 0.00 CU YDS

COM 18.26 CU YDS
EMB 0.00 CU YDS

COM 16.17 CU YDS
EMB 0.00 CU YDS

COM 16.81 CU YDS
EMB 0.00 CU YDS

COM 17.54 CU YDS
EMB 0.00 CU YDS

COM 18.26 CU YDS
EMB 0.00 CU YDS

COM 16.17 CU YDS
EMB 0.00 CU YDS

COM 16.81 CU YDS
EMB 0.00 CU YDS

COM 17.54 CU YDS
EMB 0.00 CU YDS

COM 18.26 CU YDS
EMB 0.00 CU YDS

COM 16.17 CU YDS
EMB 0.00 CU YDS

COM 16.81 CU YDS
EMB 0.00 CU YDS

COM 17.54 CU YDS
EMB 0.00 CU YDS

COM 18.26 CU YDS
EMB 0.00 CU YDS

COM 16.17 CU YDS
EMB 0.00 CU YDS

COM 16.81 CU YDS
EMB 0.00 CU YDS

COM 17.54 CU YDS
EMB 0.00 CU YDS

COM 18.26 CU YDS
EMB 0.00 CU YDS

COM 16.17 CU YDS
EMB 0.00 CU YDS

COM 16.81 CU YDS
EMB 0.00 CU YDS

COM 17.54 CU YDS
EMB 0.00 CU YDS

COM 18.26 CU YDS
EMB 0.00 CU YDS

COM 16.17 CU YDS
EMB 0.00 CU YDS

COM 16.81 CU YDS
EMB 0.00 CU YDS

COM 17.54 CU YDS
EMB 0.00 CU YDS

COM 18.26 CU YDS
EMB 0.00 CU YDS

COM 16.17 CU YDS
EMB 0.00 CU YDS

COM 16.81 CU YDS
EMB 0.00 CU YDS

COM 17.54 CU YDS
EMB 0.00 CU YDS

COM 18.26 CU YDS
EMB 0.00 CU YDS

COM 16.17 CU YDS
EMB 0.00 CU YDS

COM 16.81 CU YDS
EMB 0.00 CU YDS

COM 17.54 CU YDS
EMB 0.00 CU YDS

COM 18.26 CU YDS
EMB 0.00 CU YDS

COM 16.17 CU YDS
EMB 0.00 CU YDS

COM 16.81 CU YDS
EMB 0.00 CU YDS

COM 17.54 CU YDS
EMB 0.00 CU YDS

COM 18.26 CU YDS
EMB 0.00 CU YDS

COM 16.17 CU YDS
EMB 0.00 CU YDS

COM 16.81 CU YDS
EMB 0.00 CU YDS

COM 17.54 CU YDS
EMB 0.00 CU YDS

COM 18.26 CU YDS
EMB 0.00 CU YDS

COM 16.17 CU YDS
EMB 0.00 CU YDS

COM 16.81 CU YDS
EMB 0.00 CU YDS

COM 17.54 CU YDS
EMB 0.00 CU YDS

COM 18.26 CU YDS
EMB 0.00 CU YDS

COM 16.17 CU YDS
EMB 0.00 CU YDS

COM 16.81 CU YDS
EMB 0.00 CU YDS

COM 17.54 CU YDS
EMB 0.00 CU YDS

COUNTY OF	ITEM NO.	SHEET NO.
BULLITT	5-0900.00	34

Station	Grade	Vertical Curve Data	Horizontal Curve Data	Notes
470	460	COM 14.07 \$0 FT EMB 0.43 \$0 FT	11:1 5.46' RT	
450	450	COM 14.07 \$0 FT EMB 0.43 \$0 FT	10:1 6.00' RT	
470	470	COM 13.69 \$0 FT EMB 0.51 \$0 FT	8:1 6.55' RT	
460	460	COM 12.62 \$0 FT EMB 0.60 \$0 FT	7:1 7.10' RT	
450	450	COM 11.87 \$0 FT EMB 0.66 \$0 FT	6:1 7.70' RT	

Station	Grade	Vertical Curve Data	Horizontal Curve Data	Notes
470	460	COM 19.08 \$0 FT EMB 0.49 \$0 FT	11:1 5.46' RT	
450	450	COM 18.90 \$0 FT EMB 0.67 \$0 FT	10:1 6.00' RT	
470	470	COM 18.90 \$0 FT EMB 0.67 \$0 FT	8:1 6.55' RT	
460	460	COM 18.06 \$0 FT EMB 0.69 \$0 FT	7:1 7.10' RT	
450	450	COM 16.03 \$0 FT EMB 0.93 \$0 FT	6:1 7.70' RT	

SCALE: H = 20' HORIZONTAL
V = 20' VERTICAL

KY 61 (PRESTON HWY)
STA. 40+20 TO STA. 40+80
CROSS SECTIONS

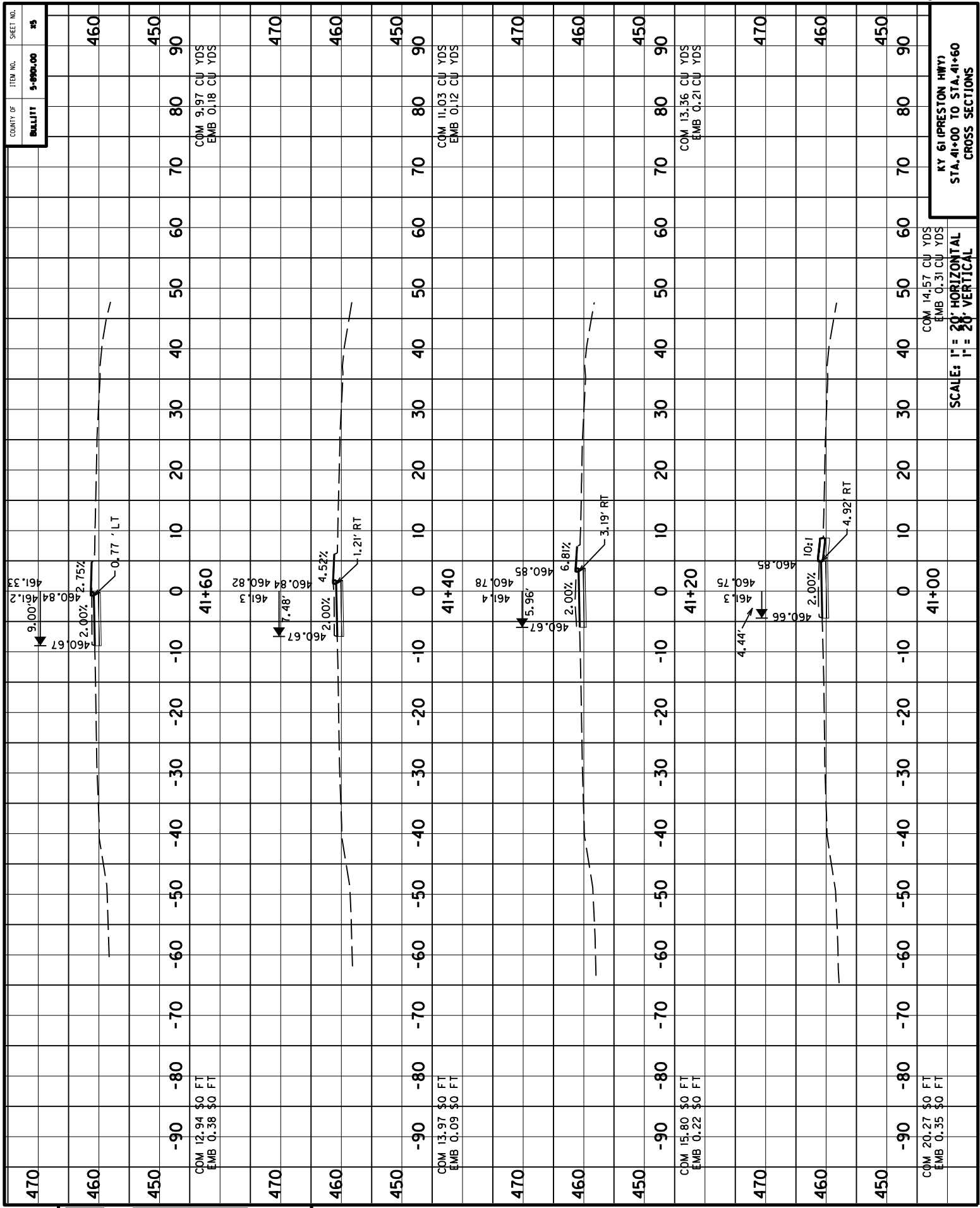

KEY: G1 (PRESTON HWY)
STA. 41+00 TO STA. 41+60
CROSS SECTIONS

SCALE: H = 20' HORIZONTAL
V = 20' VERTICAL

41+00

41+10

41+20

41+30

41+40

41+50

41+60

41+70

41+80

41+90

41+00

41+10

41+20

41+30

41+40

41+50

41+60

41+70

41+80

41+90

USER:
DATE:
FILE NAME:
E-SHEET NAME:

COUNTY OF		ITEM NO.	SHEET NO.	CROSS SECTIONS	
BULLITT		5-0900.00	35		
470					
460					460
450					450
					90
					COM 7.65 CU YDS EMB 0.42 CU YDS
470					470
460					460
450					450
					90
					COM 8.45 CU YDS EMB 0.30 CU YDS
470					470
460					460
450					450
					90
					COM 9.20 CU YDS EMB 0.09 CU YDS
470					470
460					460
450					450
					90
					COM 12.82 \$0 FT EMB 0.09 \$0 FT

KY 61 (PRESTON HWY)
 STA. 41+80 TO STA. 42+40
 SCALE: HORIZONTAL
 VERTICAL

USER: _____ DATE: _____
 FILE NAME: _____
 E-SHEET NAME: _____

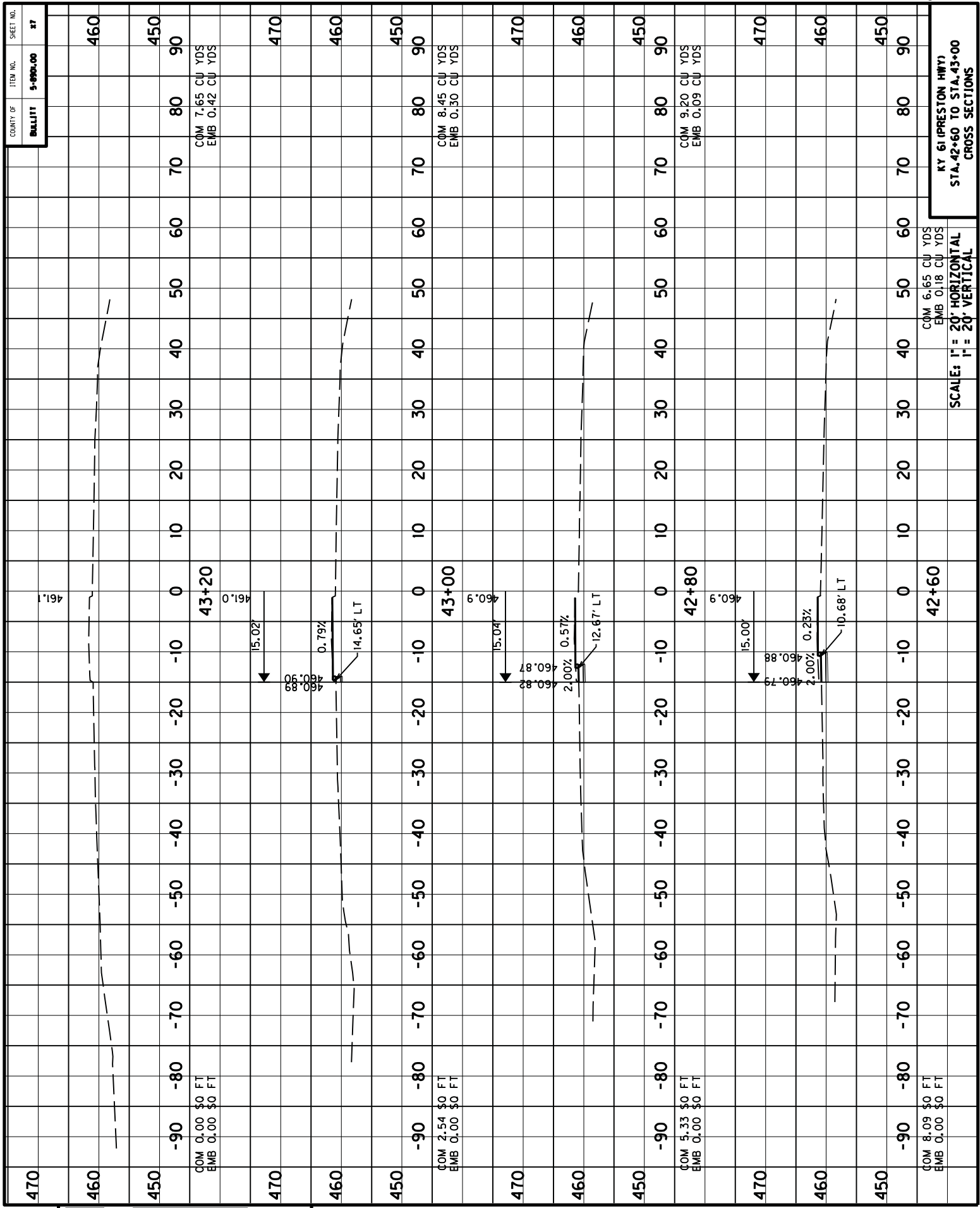

470

460

450

470

460

450

470

460

450

470

460

450

461.1

43+20

461.0

15.02'

0.79%

14.65' LT

43+00

460.9

15.04'

2.00%

0.57%

12.67' LT

42+80

460.9

15.00'

0.25%

10.68' LT

42+60

470

460

450

470

460

450

470

460

450

470

460

450

COM 6.65 CU YDS
EMB 0.18 CU YDS

COM 2.54 \$0 FT
EMB 0.00 \$0 FT

COM 5.33 \$0 FT
EMB 0.00 \$0 FT

COM 8.09 \$0 FT
EMB 0.00 \$0 FT

FILE NAME:
DATE:
USER:

	KENTUCKY TRANSPORTATION CABINET Department of Highways DIVISION OF RIGHT OF WAY & UTILITIES	TC 62-226 Rev. 01/2016 Page 1 of 1
RIGHT OF WAY CERTIFICATION		

<input checked="" type="checkbox"/> Original	<input type="checkbox"/> Re-Certification	RIGHT OF WAY CERTIFICATION	
ITEM #	COUNTY	PROJECT # (STATE)	PROJECT # (FEDERAL)
5-8901.00	Bullitt	1100 FD04 015 926950	

PROJECT DESCRIPTION

Construct a Left Turn Lane in SB KY 61 at Plaza Park Blvd

No Additional Right of Way Required

Construction will be within the limits of the existing right of way. The right of way was acquired in accordance to FHWA regulations under the Uniform Relocation Assistance and Real Property Acquisitions Policy Act of 1970, as amended. No additional right of way or relocation assistance were required for this project.

Condition # 1 (Additional Right of Way Required and Cleared)

All necessary right of way, including control of access rights when applicable, have been acquired including legal and physical possession. Trial or appeal of cases may be pending in court but legal possession has been obtained. There may be some improvements remaining on the right-of-way, but all occupants have vacated the lands and improvements, and KYTC has physical possession and the rights to remove, salvage, or demolish all improvements and enter on all land. Just Compensation has been paid or deposited with the court. All relocations have been relocated to decent, safe, and sanitary housing or that KYTC has made available to displaced persons adequate replacement housing in accordance with the provisions of the current FHWA directive.

Condition # 2 (Additional Right of Way Required with Exception)

The right of way has not been fully acquired, the right to occupy and to use all rights-of-way required for the proper execution of the project has been acquired. Some parcels may be pending in court and on other parcels full legal possession has not been obtained, but right of entry has been obtained, the occupants of all lands and improvements have vacated, and KYTC has physical possession and right to remove, salvage, or demolish all improvements. Just Compensation has been paid or deposited with the court for most parcels. Just Compensation for all pending parcels will be paid or deposited with the court prior to AWARD of construction contract

Condition # 3 (Additional Right of Way Required with Exception)

The acquisition or right of occupancy and use of a few remaining parcels are not complete and/or some parcels still have occupants. All remaining occupants have had replacement housing made available to them in accordance with 49 CFR 24.204. KYTC is hereby requesting authorization to advertise this project for bids and to proceed with bid letting even though the necessary right of way will not be fully acquired, and/or some occupants will not be relocated, and/or the just compensation will not be paid or deposited with the court for some parcels until after bid letting. KYTC will fully meet all the requirements outlined in 23 CFR 635.309(c)(3) and 49 CFR 24.102(j) and will expedite completion of all acquisitions, relocations, and full payments after bid letting and prior to AWARD of the construction contract or force account construction.

Total Number of Parcels on Project	EXCEPTION (S) Parcel #	ANTICIPATED DATE OF POSSESSION WITH EXPLANATION
Number of Parcels That Have Been Acquired		
Signed Deed		
Condemnation		
Signed ROE		

Notes/ Comments (Use Additional Sheet if necessary)

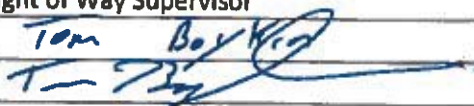
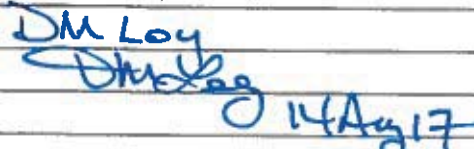
LPA RW Project Manager		Right of Way Supervisor	
Printed Name		Printed Name	Tom Boykin
Signature		Signature	
Date		Date	8-14-17
Right of Way Director		FHWA	
Printed Name	DM Loy	Printed Name	
Signature		Signature	
Date	14 Aug 17	Date	

UTILITIES AND RAIL CERTIFICATION NOTE

**BULLITT COUNTY
FD04 015 92695 01D
KY 61 – CONSTRUCT A LEFT TURN LANE ON SOUTHBOUND 61 AT
PLAZA PARK BOULEVARD
ITEM NO. 5-8901.00**

GENERAL PROJECT NOTE ON UTILITY PROTECTION

Utility coordination efforts determined that no significant utility relocation work is required to complete the project. Any work pertaining to these utility facilities is defined in the bid package and is to be carried out as instructed by the Kentucky Transportation Cabinet. The contractor will be responsible for any coordination or adjustments that are discussed or quantified in the proposal.

NOTE: DO NOT DISTURB THE FOLLOWING UTILITIES LOCATED WITHIN THE PROJECT DISTURB LIMITS

Lebanon Junction Sanitary Sewer, LG&E (Gas), LG&E (Electric) and Windstream are present and are not to be disturbed during construction activities.

Lebanon Junction Sanitary Sewer – has an existing 8” PVC line in a 16” steel casing that crosses under KY 61 at approximately Station 36+40. **These facilities are not to be disturbed and will remain in place.**

LG&E (Gas) – has an existing service line that crosses under KY 61 to a farm tap at Speedway at approximately Station 40+00. **These facilities are not to be disturbed and will remain in place.**

LG&E (Electric) – has an existing aerial route that runs parallel to KY 61 on the south side that crosses KY 61 at approximately Station 39+00. **These facilities are not to be disturbed and will remain in place.**

Windstream – has an existing aerial route that runs parallel to KY 61 on the south side that crosses KY 61 at approximately Station 39+00. **These facilities are not to be disturbed and will remain in place.**

The Contractor is fully responsible for protection of all utilities

THE FOLLOWING COMPANIES ARE RELOCATING/ADJUSTING THEIR UTILITIES WITHIN THE PROJECT LIMITS AND WILL BE COMPLETE PRIOR TO CONSTRUCTION

N/A

THE FOLLOWING COMPANIES HAVE FACILITIES TO BE RELOCATED/ADJUSTED BY THE COMPANY OR THE COMPANY’S SUBCONTRACTOR AND IS TO BE COORDINATED WITH THE ROAD CONTRACT

N/A

THE FOLLOWING COMPANIES HAVE FACILITIES TO BE RELOCATED/ADJUSTED BY THE ROAD CONTRACTOR AS INCLUDED IN THIS CONTRACT

N/A

THE FOLLOWING RAIL COMPANIES HAVE FACILITIES IN CONJUNCTION WITH THIS PROJECT AS NOTED

- No Rail Involved** **Minimal Rail Involved (See Below)** **Rail Involved (See Below)**

UTILITIES AND RAIL CERTIFICATION NOTE

**BULLITT COUNTY
FD04 015 92695 01D
KY 61 – CONSTRUCT A LEFT TURN LANE ON SOUTHBOUND 61 AT
PLAZA PARK BOULEVARD
ITEM NO. 5-8901.00**

UNDERGROUND FACILITY DAMAGE PROTECTION – BEFORE YOU DIG

The contractor shall make every effort to protect underground facilities from damage as prescribed in the Underground Facility Damage Protection Act of 1994, Kentucky Revised Statute KRS 367.4901 to 367.4917. It is the contractor's responsibility to determine and take steps necessary to be in compliance with federal and state damage prevention directives. The contractor is instructed to contact KY 811 for the location of existing underground utilities. Contact shall be made a minimum of two (2) and no more than ten (10) business days prior to excavation.

The contractor shall submit Excavation Locate Requests to the Kentucky Contact Center (KY 811) via web ticket entry. The submission of this request does not relieve the contractor from the responsibility of contacting non-member facility owners, whom are to be contacted through their individual Protection Notification Center. It may be necessary for the contractor to contact the County Court Clerk to determine what utility companies have facilities in the area. Non-compliance with these directives can result in the enforcement of penalties.

SPECIAL CAUTION NOTE – PROTECTION OF UTILITIES

The contractor will be responsible for contacting all utility facility owners on the subject project to coordinate his activities. The contractor will coordinate his activities to minimize and, where possible, avoid conflicts with utility facilities. Due to the nature of the work proposed, it is unlikely to conflict with the existing utilities beyond minor facility adjustments. Where conflicts with utility facilities are unavoidable, the contractor will coordinate any necessary relocation work with the facility owner and Resident Engineer. The Kentucky Transportation Cabinet maintains the right to remove or alter portions of this contract if a utility conflict occurs.

The utility facilities as noted in the previous section(s) have been determined using data garnered by varied means and with varying degrees of accuracy: from the facility owners, a result of S.U.E., field inspections, and/or reviews of record drawings. The facilities defined may not be inclusive of all utilities in the project scope and are not Level A quality, unless specified as such. It is the contractor's responsibility to verify all utilities and their respective locations before excavating.

Please Note: The information presented in this Utility Note is informational in nature and the information contained herein is not guaranteed.

UTILITIES AND RAIL CERTIFICATION NOTE

**BULLITT COUNTY
FD04 015 92695 01D
KY 61 – CONSTRUCT A LEFT TURN LANE ON SOUTHBOUND 61 AT
PLAZA PARK BOULEVARD
ITEM NO. 5-8901.00**

Utility Owners and Contact Persons Bullitt Co, KY

- | | | |
|--|----|---|
| 1. LG&E KU (Electric)
820 West Broadway
Louisville, KY 40202
LG&E Emergency Number (502) 589-1444
LG&E and KU Emergency Number 1-800-331-7370 | | Greg Geiser
work: (502) 627-3708
Greg.Geiser@LGE-KU.com |
| 2. LG&E (Gas)
820 West Broadway
Louisville, KY 40202
Gas Emergency Number (502) 589-5511
LG&E and KU Emergency Number 1-800-331-7370 | | Greg Geiser
work: (502) 627-3708
Greg.Geiser@LGE-KU.com |
| 3. Louisville Water Company
550 South Third Street
Louisville, KY 40202 | | Daniel Tegene, PE
(502) 569-3649
DTegene@LWcky.com |
| 4. Windstream Kentucky, Inc.
229 Lees Valley Road
Shepherdsville, KY 40165
502-957-7127
OR
111 S. Main St.
Elizabethtown, KY 42071 | | Roger Redford
cell – (502) 264-2053
Roger.Redford@Windstream.com

Barry Roberts
(270) 723-7358
Barry.Roberts@Windstream.com |
| 5. Salt River Rural Electric Coop. Corp.
111 W. Brashear Ave.
Bardstown, KY 40004
Telephone in Bullitt County | | Daniel Carrico
Dcarrico@SRElectric.com
(502) 350-1606
Wesley Collins
wcollins@SRElectric.com |
| 6. East Kentucky Power Coop
4775 Lexington Road
Winchester, KY 40391

P O Box 707
Winchester, KY 40391 | Or | Garry Harvey
(859)745-9601
Garry.Harvey@EKPC.coop
Barry Warner
Barry.Warner@EKPC.coop
(859) 745-9304 |

UTILITIES AND RAIL CERTIFICATION NOTE

BULLITT COUNTY
FD04 015 92695 01D
KY 61 – CONSTRUCT A LEFT TURN LANE ON SOUTHBOUND 61 AT
PLAZA PARK BOULEVARD
ITEM NO. 5-8901.00

- | | |
|--|--|
| <p>7. City of Shepherdsville Sewer
634 Conestoga Parkway
P O Box 400
Shepherdsville, KY 40165
City of Shepherdsville Sewer (cont)</p> | <p>Engineer: Rob Campbell QK4
ph: (502) 585-2222 (QK4)
RCampbell@qk4.com
ph: (502) 955-7803 (City Shep)
Scott Flemming
Cell: (502) 664-6254
sfleming@shepcity.com</p> |
| <p>8. Charter Communications
10168 Linn Station Road
Suite 120
Louisville, KY 40223</p> | <p>Deno Barbour
(502) 664-7395 – Cell
(502) 357-4376 – Office
Dwight.Barbour@charter.com
Kevin Mercer
(502) 817-5055 – Cell
(502) 357-4724 - Office
kevin.mercer@charter.com
Richard Bast
(502) 817-0734 – Cell
(502) 357-4118 - Office
richard.bast@charter.com</p> |
| <p>9. Lebanon Junction Water Works
City Hall - Main Street
P O Box 69
Lebanon Junction, KY 40150</p> | <p>Charles Sullivan
Cell (502) 817-0352 (not use 502)
LJWW16@yahoo.com
City Hall 502-833-4311</p> |
| <p>10. Mt. Washington Sewer & Water Commission
208 Snapp Street
Mt. Washington, KY 40047
(502) 538-4216 or 538-4781 or 955-6784</p> | <p>Elizabeth Hall, City Administrator
DHall@mtwKY.org
Derrick Engineering – Consultant
derrickinc@bellsouth.net
Ronnie Fick, Public Works Director
RFick@mtwKY.org
(502)538-3771</p> |
| <p>11. Marathon Pipeline, LLC
539 South Main Street, Room X-05-018
Findlay, OH 45840
OR
20-C Industrial Drive
Lexington, OH 44904</p> | <p>Ed May
Office – (419) 421-3704
edmay@marathonpetroleum.com
Greg Newman
gnewman@marathonpetroleum.com
Office - (419) 884-0800x236
Cell – (419) 564-8826</p> |

UTILITIES AND RAIL CERTIFICATION NOTE

BULLITT COUNTY
FD04 015 92695 01D
KY 61 – CONSTRUCT A LEFT TURN LANE ON SOUTHBOUND 61 AT
PLAZA PARK BOULEVARD
ITEM NO. 5-8901.00

- | | |
|---|---|
| 12. Mid - Valley Pipeline Company
4910 Limaburg Road
Burlington, KY 41005
FAX (866) 699-1185 | Richard (Todd) Calfee
(859) 371-4469x14
Cell: 859-630-8271
RTCalfee@SunocoLogistics.com |
| 13. AT&T Legacy
7555 E. Pleasant Valley Rd. – Suite 140
Independence, OH 44131 | Mike Diederich
MD4145@att.com
Phone - (216) 750-0135
Cell - (216) 212-8556
Don Garr
DRGarr@Hughes.net
Cell - (502) 741-8374 |
| 14. City of Taylorsville Sewer & Water
70 Taylorsville Rd., P O Box 279
Taylorsville, KY 40071
Consultant: Kevin Sisler
220 Reynolds Rd
Lexington, KY 40517 | Harold Compton
HCompton@TaylorsvilleWater.org
(502) 477-3235
Fax: (502) 477-1310
Kevin.@SislerMaggard.com
(859) 271-2978 (859) 509-3799
Steve Biven-City Clerk
SBiven@taylorsvillewater.org
(502) 477-3235 ext. 106 |
| 15. AT&T KY
1340 E. John Rowan Blvd
Bardstown, KY 40004 | Scott Roche
sr8832@att.com
Office - (502) 348-4528
Cell – (502) 827-4703 |
| 16. Bullitt County Schools
1040 Highway 44 East
Shepherdsville, KY 40165
(also managed by LG Fiber)
LG Fiber
P. O. Box 1702
Mt. Vernon, KY 40456 | Jim Jackson
Jim.Jackson@Bullitt.kyschools.us
(502) 869-8040
Larry Gregory
LGFiber@gmail.com
(606)521-2649 |
| 17. Bullitt Co. Sanitation District
P O Box 818
Hillview, KY 40129 | Jerry Kennedy
Office – (502) 957-6140
Cell - (502) 643-3165
BullittSanitation@Windstream.net |

UTILITIES AND RAIL CERTIFICATION NOTE

**BULLITT COUNTY
FD04 015 92695 01D
KY 61 – CONSTRUCT A LEFT TURN LANE ON SOUTHBOUND 61 AT
PLAZA PARK BOULEVARD
ITEM NO. 5-8901.00**

- | | |
|---|--|
| 18. Inside Connect Cable LLC
4890 Knobb Creek Road
Brooks, KY 40109 | TJ Scott
tscott@insideconnect.net
Tony Manley
Tony@InsideConnect.net
or Tony@ICcable.com
Office: (502)955-4882
Cell: (502)593-5357 |
| 19. Pioneer Village Sewer Plant
4846 Brownsboro Center Arcade
Louisville, KY 40242
502-895-4273 | Joe Sanders
(502) 609-2114 - cell
NO EMAIL
Owner: Jim Walser |
| 20. Kentucky Data Link (KDL now Windstream)
111 S. Main St.
Elizabethtown, KY 42071 | James Galvin
Office: 270-765-1818
Mobile: 270-748-9249
James.Galvin@windstream.com
Mark Ware
Mark.Ware@windstream.com
Send to both contacts
Timothy Gibson
Timothy.Gibson@Windstream.com
Emergency contact ONLY |
| 21. Verizon Business (MCI)
400 International Parkway
Richardson, TX 75081 | Dean Boyers (Investigations Dept)
Dean.Boyers@Verizon.com
Office (469) 886-4238 |
| 22. Nolin Rural Electric Cooperative Corp.
411 Ring Road
Elizabethtown, KY 42701 | Donnie Probst
(270) 765-6153 |
| 23. CenturyLink
260 Winn Ave
Winchester, KY 40391 | Jim Trapnell
jim.trapnell@centurylink.com
Cell (859) 806-5833 |
| CenturyLink National Network Construction
3625 Brookside Parkway Suite 400
Alpharetta, GA 30022 | Chad Kirkland
Chadrick.kirkland@centurylink.com
Cell (770) 328-2449 |

UTILITIES AND RAIL CERTIFICATION NOTE

**BULLITT COUNTY
FD04 015 92695 01D
KY 61 – CONSTRUCT A LEFT TURN LANE ON SOUTHBOUND 61 AT
PLAZA PARK BOULEVARD
ITEM NO. 5-8901.00**

- 24.** Level 3 Communications (Transmission)
848 S. 8th St.
Louisville, KY 40203
- Kevin Webster
Kevin.Webster@Level3.com
Office (502) 777-8622
Cell (502) 777-8622
Fax (502) 561-6950
- Level 3 Communications (Distribution)
11857 Commonwealth Drive
Louisville, KY 40299
- Mark Sewell
Mark.Sewell@Level3.com
Office (502) 389-4811
Cell (502) 295-0939
- Harold Waters
Harold.Waters@Level3.com
Office (502) 719-2393
Cell (502) 435-0956
- 3770 Lucius Rd.
Columbia, SC 29201
- Russ Wheat, Relocation Project Manager
russ.wheat@level3.com
Office (803) 239-1116
Cell (803) 206-9563
- 25.** Crown Castle Network Operations
10300 Ormsby Park Place
Suite 501
Louisville, KY 40223
- Rebecca Gray
rebecca.gray@CrownCastle.com
(502)318-1313
Chris Gladstone
Chris.Gladstone@CrownCastle.com
(502) 689-2162
- 26.** MCI/Verizon(Owns WUTEL)
MCI/Verizon
730 West Henry Street
Indianapolis, IN 46225
- David Dickerson
david.b.dickerson@xo.com
Office: (615) 777-7855
Cell: (615) 507-5287
- Dave Wiley (Field)
(502) 439-8783
dave.wiley@verizon.com

KyTC BMP Plan for Project PCN 5–8901.00



Kentucky Transportation Cabinet

Highway District 5

And

_____ **(2), Construction**

Kentucky Pollutant Discharge Elimination System

Permit KYR10

Best Management Practices (BMP) plan

Groundwater protection plan

For Highway Construction Activities

For

Turn Lane Construction

KY 61 (Preston Hwy)

Project: PCN 5–8901.00

KyTC BMP Plan for Project PCN 5–8901.00

Project information

Note – (1) = Design (2) = Construction (3) = Contractor

1. Owner – Kentucky Transportation Cabinet, District 5
2. Resident Engineer: (2)
3. Contractor name: (2)
Address: (2)

Phone number: (2)
Contact: (2)
Contractors agent responsible for compliance with the KPDES permit requirements (3):
4. Project Control Number (2)
5. Route (Address): Preston Hwy, Lebanon Junction, KY 40150
6. Latitude/Longitude (project mid-point): 37/49/43, 85/43/28
7. County (project mid-point): Bullitt
8. Project start date (date work will begin): (2)
9. Projected completion date: (2)

KyTC BMP Plan for Project PCN 5–8901.00

A. Site description:

1. Nature of Construction Activity (from letting project description): Turn Lane Construction
2. Order of major soil disturbing activities (2) and (3)
3. Projected volume of material to be moved: 344 CY
4. Estimate of total project area (acres): 1.05 Ac
5. Estimate of area to be disturbed (acres): 0.238 Ac
6. Post construction runoff coefficient will be included in the project drainage folder. Persons needing information pertaining to the runoff coefficient will contact the resident engineer to request this information.
7. Data describing existing soil condition: None & (2)
8. Data describing existing discharge water quality (if any): None & (2)
9. Receiving water name: Tributary to Rolling Fork
10. TMDLs and Pollutants of Concern in Receiving Waters: None listed (DEA)
11. Site map – Project layout sheet plus the erosion control sheets in the project plans that depict Disturbed Drainage Areas (DDAs) and related information. These sheets depict the existing project conditions with areas delineated by DDA (drainage area bounded by watershed breaks and right of way limits), the storm water discharge locations (either as a point discharge or as overland flow) and the areas that drain to each discharge point. These plans define the limits of areas to be disturbed and the location of control measures. Controls will be either site specific as designated by the designer or will be annotated by the contractor and resident engineer before disturbance commences. The project layout sheet shows the surface waters and wetlands.

12. Potential sources of pollutants:

The primary source of pollutants is solids that are mobilized during storm events. Other sources of pollutants include oil/fuel/grease from servicing and operating construction equipment, concrete washout water, sanitary wastes and trash/debris. (3)

KyTC BMP Plan for Project PCN 5–8901.00

B. Sediment and Erosion Control Measures:

1. Plans for highway construction projects will include erosion control sheets that depict Disturbed Drainage Areas (DDAs) and related information. These plan sheets will show the existing project conditions with areas delineated by DDA within the right of way limits, the discharge points and the areas that drain to each discharge point. Project managers and designers will analyze the DDAs and identify Best Management Practices (BMPs) that are site specific. The balance of the BMPs for the project will be listed in the bid documents for selection and use by the contractor on the project with approval by the resident engineer.

Projects that do not have DDAs annotated on the erosion control sheets will employ the same concepts for development and managing BMP plans.

2. Following award of the contract, the contractor and resident engineer will annotate the erosion control sheets showing location and type of BMPs for each of the DDAs that will be disturbed at the outset of the project. This annotation will be accompanied by an order of work that reflects the order or sequence of major soil moving activities. The remaining DDAs are to be designated as “Do Not Disturb” until the contractor and resident engineer prepare the plan for BMPs to be employed. The initial BMP’s shall be for the first phase (generally Clearing and Grubbing) and shall be modified as needed as the project changes phases. The BMP Plan will be modified to reflect disturbance in additional DDA’s as the work progresses. All DDA’s will have adequate BMP’s in place before being disturbed.
3. As DDAs are prepared for construction, the following will be addressed for the project as a whole or for each DDA as appropriate:
 - Construction Access – This is the first land-disturbing activity. As soon as construction begins, bare areas will be stabilized with gravel and temporary mulch and/or vegetation.
 - At the beginning of the project, all DDAs for the project will be inspected for areas that are a source of storm water pollutants. Areas that are a source of pollutants will receive appropriate cover or BMPs to arrest the introduction of pollutants into storm water. Areas that have not been opened by the contractor will be inspected periodically (once per month) to determine if there is a need to employ BMPs to keep pollutants from entering storm water.

KyTC BMP Plan for Project PCN 5–8901.00

- Clearing and Grubbing – The following BMP’s will be considered and used where appropriate.
 - Leaving areas undisturbed when possible.
 - Silt basins to provide silt volume for large areas.
 - Silt Traps Type A for small areas.
 - Silt Traps Type C in front of existing and drop inlets which are to be saved
 - Diversion ditches to catch sheet runoff and carry it to basins or traps or to divert it around areas to be disturbed.
 - Brush and/or other barriers to slow and/or divert runoff.
 - Silt fences to catch sheet runoff on short slopes. For longer slopes, multiple rows of silt fence may be considered.
 - Temporary Mulch for areas which are not feasible for the fore mentioned types of protections.
 - Non-standard or innovative methods.
- Cut & Fill and placement of drainage structures - The BMP Plan will be modified to show additional BMP’s such as:
 - Silt Traps Type B in ditches and/or drainways as they are completed
 - Silt Traps Type C in front of pipes after they are placed
 - Channel Lining
 - Erosion Control Blanket
 - Temporary mulch and/or seeding for areas where construction activities will be ceased for 21 days or more.
 - Non-standard or innovative methods
- Profile and X-Section in place – The BMP Plan will be modified to show elimination of BMP’s which had to be removed and the addition of new BMP’s as the roadway was shaped. Probably changes include:
 - Silt Trap Type A, Brush and/or other barriers, Temporary Mulch, and any other BMP which had to be removed for final grading to take place.
 - Additional Silt Traps Type B and Type C to be placed as final drainage patterns are put in place.
 - Additional Channel Lining and/or Erosion Control Blanket.
 - Temporary Mulch for areas where Permanent Seeding and Protection cannot be done within 21 days.
 - Special BMP’s such as Karst Policy
- Finish Work (Paving, Seeding, Protect, etc.) – A final BMP Plan will result from modifications during this phase of construction. Probably changes include:
 - Removal of Silt Traps Type B from ditches and drainways if they are protected with other BMP’s which are sufficient to control erosion, i.e. Erosion Control Blanket or Permanent Seeding and Protection on moderate grades.

KyTC BMP Plan for Project PCN 5–8901.00

- Permanent Seeding and Protection
 - Placing Sod
 - Planting trees and/or shrubs where they are included in the project
- BMP's including Storm Water Management Devices such as velocity dissipation devices and Karst policy BMP's to be installed during construction to control the pollutants in storm water discharges that will occur after construction has been completed are: *This project does not include storm water BMPs or flow controls for post-construction use.*

C. Other Control Measures

1. No solid materials, including building materials, shall be discharged to waters of the commonwealth, except as authorized by a Section 404 permit.
2. Waste Materials

All waste materials that may leach pollutants (paint and paint containers, caulk tubes, oil/grease containers, liquids of any kind, soluble materials, etc.) will be collected and stored in appropriate covered waste containers. Waste containers shall be removed from the project site on a sufficiently frequent basis as to not allow wastes to become a source of pollution. All personnel will be instructed regarding the correct procedure for waste disposal. Wastes will be disposed in accordance with appropriate regulations. Notices stating these practices will be posted in the office.

3. Hazardous Waste

All hazardous waste materials will be managed and disposed of in the manner specified by local or state regulation. The contractor shall notify the Resident Engineer if there any hazardous wastes being generated at the project site and how these wastes are being managed. Site personnel will be instructed with regard to proper storage and handling of hazardous wastes when required. The Transportation Cabinet will file for generator, registration when appropriate, with the Division of Waste Management and advise the contractor regarding waste management requirements.

4. Spill Prevention

The following material management practices will be used to reduce the risk of spills or other exposure of materials and substances to the weather and/or runoff.

- **Good Housekeeping:**

KyTC BMP Plan for Project PCN 5–8901.00

The following good housekeeping practices will be followed onsite during the construction project.

- An effort will be made to store only enough product required to do the job
- All materials stored onsite will be stored in a neat, orderly manner in their appropriate containers and, if possible, under a roof or other enclosure
- Products will be kept in their original containers with the original manufacturer's label
- Substances will not be mixed with one another unless recommended by the manufacturer
- Whenever possible, all of the product will be used up before disposing of the container
- Manufacturers' recommendations for proper use and disposal will be followed
- The site contractor will inspect daily to ensure proper use and disposal of materials onsite

➤ **Hazardous Products:**

These practices will be used to reduce the risks associated with any and all hazardous materials.

- Products will be kept in original containers unless they are not resealable
- Original labels and material safety data sheets (MSDS) will be reviewed and retained
- Contractor will follow procedures recommended by the manufacturer when handling hazardous materials
- If surplus product must be disposed of, manufacturers' or state/local recommended methods for proper disposal will be followed

The following product-specific practices will be followed onsite:

➤ **Petroleum Products:**

Vehicles and equipment that are fueled and maintained on site will be monitored for leaks, and receive regular preventative maintenance to reduce the chance of leakage. Petroleum products onsite will be stored in tightly sealed containers, which are clearly labeled and will be protected from exposure to weather.

The contractor shall prepare an Oil Pollution Spill Prevention Control and Countermeasure plan when the project that involves the storage of petroleum products in 55 gallon or larger containers with a total combined storage capacity of 1,320 gallons. This is a requirement of 40 CFR 112.

KyTC BMP Plan for Project PCN 5–8901.00

This project (will / will not) (3) have over 1,320 gallons of petroleum products with a total capacity, sum of all containers 55 gallon capacity and larger.

➤ **Fertilizers:**

Fertilizers will be applied at rates prescribed by the contract, standard specifications or as directed by the resident engineer. Once applied, fertilizer will be covered with mulch or blankets or worked into the soil to limit exposure to storm water. Storage will be in a covered shed. The contents of any partially used bags of fertilizer will be transferred to a sealable plastic bin to avoid spills.

➤ **Paints:**

All containers will be tightly sealed and stored indoors or under roof when not being used. Excess paint or paint wash water will not be discharged to the drainage or storm sewer system but will be properly disposed of according to manufacturers' instructions or state and local regulations.

➤ **Concrete Truck Washout:**

Concrete truck mixers and chutes will not be washed on pavement, near storm drain inlets, or within 75 feet of any ditch, stream, wetland, lake, or sinkhole. Where possible, excess concrete and wash water will be discharged to areas prepared for pouring new concrete, flat areas to be paved that are away from ditches or drainage system features, or other locations that will not drain off site. Where this approach is not possible, a shallow earthen wash basin will be excavated away from ditches to receive the wash water

➤ **Spill Control Practices**

In addition to the good housekeeping and material management practices discussed in the previous sections of this plan, the following practices will be followed for spill prevention and cleanup:

- Manufacturers' recommended methods for spill cleanup will be clearly posted. All personnel will be made aware of procedures and the location of the information and cleanup supplies.
- Materials and equipment necessary for spill cleanup will be kept in the material storage area. Equipment and materials will include as appropriate, brooms, dust pans, mops, rags, gloves, oil absorbents, sand, sawdust, and plastic and metal trash containers.
- All spills will be cleaned up immediately after discovery.
- The spill area will be kept well ventilated and personnel will wear appropriate protective clothing to prevent injury from contact with a hazardous substance.

KyTC BMP Plan for Project PCN 5–8901.00

- Spills of toxic or hazardous material will be reported to the appropriate state/local agency as required by KRS 224 and applicable federal law.
- The spill prevention plan will be adjusted as needed to prevent spills from reoccurring and improve spill response and cleanup.
- Spills of products will be cleaned up promptly. Wastes from spill clean up will be disposed in accordance with appropriate regulations.

D. Other State and Local Plans

This BMP plan shall include any requirements specified in sediment and erosion control plans, storm water management plans or permits that have been approved by other state or local officials. Upon submittal of the NOI, other requirements for surface water protection are incorporated by reference into and are enforceable under this permit (even if they are not specifically included in this BMP plan). This provision does not apply to master or comprehensive plans, non-enforceable guidelines or technical guidance documents that are not identified in a specific plan or permit issued for the construction site by state or local officials. *There are other local (MS4) requirements that are being added to this project.*

E. Maintenance

1. The BMP plan shall include a clear description of the maintenance procedures necessary to keep the control measures in good and effective operating condition.
- Maintenance of BMPs during construction shall be a result of weekly and post rain event inspections with action being taken by the contractor to correct deficiencies.
 - Post Construction maintenance will be a function of normal highway maintenance operations. Following final project acceptance by the cabinet, district highway crews will be responsible for identification and correction of deficiencies regarding ground cover and cleaning of storm water BMPs. The project manager shall identify any BMPs that will be for the purpose of post construction storm water management with specific guidance for any non-routine maintenance. *There are no such BMP's.*

F. Inspections

Inspection and maintenance practices that will be used to maintain erosion and sediment controls:

KyTC BMP Plan for Project PCN 5–8901.00

- All erosion prevention and sediment control measures will be inspected at least once each week and following any rain of one-half inch or more.
- Inspections will be conducted by individuals that have successfully completed the KEPSC-RI course as required by Section 213.02.02 of the Standard Specifications for Road and Bridge Construction, current edition.
- Inspection reports will be written, signed, dated, and kept on file.
- Areas at final grade will be seeded and mulched within 14 days.
- Areas that are not at final grade where construction has ceased for a period of 21 days or longer and soil stock piles shall receive temporary mulch no later than 14 days from the last construction activity in that area.
- All measures will be maintained in good working order; if a repair is necessary, it will be initiated within 24 hours of being reported.
- Built-up sediment will be removed from behind the silt fence before it has reached halfway up the height of the fence.
- Silt fences will be inspected for bypassing, overtopping, undercutting, depth of sediment, tears, and to ensure attachment to secure posts.
- Sediment basins will be inspected for depth of sediment, and built-up sediment will be removed when it reaches 70 percent of the design capacity and at the end of the job.
- Diversion dikes and berms will be inspected and any breaches promptly repaired. Areas that are eroding or scouring will be repaired and re-seeded / mulched as needed.
- Temporary and permanent seeding and mulching will be inspected for bare spots, washouts, and healthy growth. Bare or eroded areas will be repaired as needed.
- All material storage and equipment servicing areas that involve the management of bulk liquids, fuels, and bulk solids will be inspected weekly for conditions that represent a release or possible release of pollutants to the environment.

G. Non – Storm Water discharges

It is expected that non-storm water discharges may occur from the site during the construction period. Examples of non-storm water discharges include:

- Water from water line flushings.
- Water from cleaning concrete trucks and equipment.

KyTC BMP Plan for Project PCN 5–8901.00

- Pavement wash waters (where no spills or leaks of toxic or hazardous materials have occurred).
- Uncontaminated groundwater and rain water (from dewatering during excavation).

All non-storm water discharges will be directed to the sediment basin or to a filter fence enclosure in a flat vegetated infiltration area or be filtered via another approved commercial product.

H. Groundwater Protection Plan (3)

This plan serves as the groundwater protection plan as required by 401 KAR 5:037.

- Contractors statement: (3)

The following activities, as enumerated by 401 KAR 5:037 Section 2 that require the preparation and implementation of a groundwater protection plan, will or may be may be conducted as part of this construction project:

_____ 2. (e) land treatment or land disposal of a pollutant;

_____ 2. (f) Storing, ..., or related handling of hazardous waste, solid waste or special waste, ..., in tanks, drums, or other containers, or in piles, (This does not include wastes managed in a container placed for collection and removal of municipal solid waste for disposal off site);

_____ 2. (g) Handling of materials in bulk quantities (equal or greater than 55 gallons or 100 pounds net dry weight transported held in an individual container) that, if released to the environment, would be a pollutant;

_____ 2. (j) Storing or related handling of road oils, dust suppressants,, at a central location;

_____ 2. (k) Application or related handling of road oils, dust suppressants or deicing materials, (does not include use of chloride-based deicing materials applied to roads or parking lots);

_____ 2. (m) Installation, construction, operation, or abandonment of wells, bore holes, or core holes, (this does not include bore holes for the purpose of explosive demolition);

Or, check the following only if there are no qualifying activities

KyTC BMP Plan for Project PCN 5-8901.00

_____ There are no activities for this project as listed in 401 KAR 5:037 Section 2 that require the preparation and implementation of a groundwater protection plan.

The contractor is responsible for the preparation of a plan that addresses the

401 KAR 5:037 Section 3. (3) Elements of site specific groundwater protection plan:

- (a) General information about this project is covered in the Project information;
- (b) Activities that require a groundwater protection plan have been identified above;
- (c) Practices that will protect groundwater from pollution are addressed in section C. Other control measures.
- (d) Implementation schedule – all practices required to prevent pollution of groundwater are to be in place prior to conducting the activity;
- (e) Training is required as a part of the ground water protection plan. All employees of the contractor, sub-contractor and resident engineer personnel will be trained to understand the nature and requirements of this plan as they pertain to their job function(s). Training will be accomplished within one week of employment and annually thereafter. A record of training will be maintained by the contractor with a copy provide to the resident engineer.
- (f) Areas of the project and groundwater plan activities will be inspected as part of the weekly sediment and erosion control inspections
- (g) Certification (see signature page.)

KyTC BMP Plan for Project PCN 5–8901.00

Contractor and Resident Engineer Plan certification

The contractor that is responsible for implementing this BMP plan is identified in the Project Information section of this plan.

The following certification applies to all parties that are signatory to this BMP plan:

I certify under penalty of law that this document and all attachments were prepared under my direction or supervision in accordance with a system designed to assure that qualified personnel properly gathered and evaluated the information submitted. Based on my inquiry of the person or persons who manage the system, or those persons directly responsible for gathering the information, the information submitted is, to the best of my knowledge and belief, true, accurate, and complete. I am aware that there are significant penalties for submitting false information, including the possibility of fine and imprisonment for knowing violations. Further, this plan complies with the requirements of 401 KAR 5:037. By this certification, the undersigned state that the individuals signing the plan have reviewed the terms of the plan and will implement its provisions as they pertain to ground water protection.

Resident Engineer and Contractor Certification:

(2) Resident Engineer signature

Signed _____ title _____, _____
Typed or printed name² signature

(3) Signed _____ title _____, _____
Typed or printed name¹ signature

1. Contractors Note: to be signed by a person who is the owner, a responsible corporate officer, a general partner or the proprietor or a person designated to have the authority to sign reports by such a person in accordance with 401 KAR 5:060 Section 9. This delegation shall be in writing to: Manager, KPDES Branch, Division of Water, 14 Reilly Road, Frankfort Kentucky 40601. Reference the Project Control Number (PCN) and KPDES number when one has been issued.

2. KyTC note: to be signed by the Chief District Engineer or a person designated to have the authority to sign reports by such a person (usually the resident engineer) in accordance with 401 KAR 5:060 Section 9. This delegation shall be in writing to: Manager, KPDES Branch, Division of Water, 14 Reilly Road, Frankfort Kentucky 40601 Reference the Project Control Number (PCN) and KPDES number when one has been issued.

KyTC BMP Plan for Project PCN 5-8901.00

Sub-Contractor Certification

The following sub-contractor shall be made aware of the BMP plan and responsible for implementation of BMPs identified in this plan as follows:

Subcontractor

Name:
Address:
Address:

Phone:

The part of BMP plan this subcontractor is responsible to implement is:

I certify under penalty of law that I understand the terms and conditions of the general Kentucky Pollutant Discharge Elimination System permit that authorizes the storm water discharges, the BMP plan that has been developed to manage the quality of water to be discharged as a result of storm events associated with the construction site activity and management of non-storm water pollutant sources identified as part of this certification.

Signed _____ title _____, _____
Typed or printed name¹ signature

1. Sub Contractor Note: to be signed by a person who is the owner, a responsible corporate officer, a general partner or the proprietor or a person designated to have the authority to sign reports by such a person in accordance with 401 KAR 5:060 Section 9. This delegation shall be in writing to: Manager, KPDES Branch, Division of Water, 14 Reilly Road, Frankfort Kentucky 40601. Reference the Project Control Number (PCN) and KPDES number when one has been issued.

PART II
SPECIFICATIONS AND STANDARD DRAWINGS

SPECIFICATIONS REFERENCE

Any reference in the plans or proposal to previous editions of the *Standard Specifications for Road and Bridge Construction* and *Standard Drawings* are superseded by *Standard Specifications for Road and Bridge Construction, Edition of 2012* and *Standard Drawings, Edition of 2016*.

SUPPLEMENTAL SPECIFICATIONS

The contractor shall use the Supplemental Specifications that are effective at the time of letting.
The Supplemental Specifications can be found at the following link:

<http://transportation.ky.gov/Construction/Pages/Kentucky-Standard-Specifications.aspx>

PART III

EMPLOYMENT, WAGE AND RECORD REQUIREMENTS

**TRANSPORTATION CABINET
DEPARTMENT OF HIGHWAYS**

**LABOR AND WAGE REQUIREMENTS
APPLICABLE TO OTHER THAN FEDERAL-AID SYSTEM PROJECTS**

- I. Application
- II. Nondiscrimination of Employees (KRS 344)

I. APPLICATION

1. These contract provisions shall apply to all work performed on the contract by the contractor with his own organization and with the assistance of workmen under his immediate superintendence and to all work performed on the contract by piecework, station work or by subcontract. The contractor's organization shall be construed to include only workmen employed and paid directly by the contractor and equipment owned or rented by him, with or without operators.

2. The contractor shall insert in each of his subcontracts all of the stipulations contained in these Required Provisions and such other stipulations as may be required.

3. A breach of any of the stipulations contained in these Required Provisions may be grounds for termination of the contract.

3. If the contractor is in control of apprenticeship or other training or retraining, including on-the-job training programs, he shall not discriminate against an individual because of his race, color, religion, national origin, sex, disability or age forty (40) and over, in admission to, or employment in any program established to provide apprenticeship or other training.

4. The contractor will send to each labor union or representative of workers with which he has a collective bargaining agreement or other contract or understanding, a notice to be provided advising the said labor union or workers' representative of the contractor's commitments under this section, and shall post copies of the notice in conspicuous places available to employees and applicants for employment. The contractor will take such action with respect to any subcontract or purchase order as the administrating agency may direct as a means of enforcing such provisions, including sanctions for non-compliance.

Revised: January 25, 2017

II. NONDISCRIMINATION OF EMPLOYEES

**AN ACT OF THE KENTUCKY
GENERAL ASSEMBLY TO PREVENT
DISCRIMINATION IN EMPLOYMENT
KRS CHAPTER 344
EFFECTIVE JUNE 16, 1972**

The contract on this project, in accordance with KRS Chapter 344, provides that during the performance of this contract, the contractor agrees as follows:

1. The contractor shall not fail or refuse to hire, or shall not discharge any individual, or otherwise discriminate against an individual with respect to his compensation, terms, conditions, or privileges of employment, because of such individual's race, color, religion, national origin, sex, disability or age (forty and above); or limit, segregate, or classify his employees in any way which would deprive or tend to deprive an individual of employment opportunities or otherwise adversely affect his status as an employee, because of such individual's race, color, religion, national origin, sex, disability or age forty (40) and over. The contractor agrees to post in conspicuous places, available to employees and applicants for employment, notices to be provided setting forth the provisions of this nondiscrimination clause.

2. The contractor shall not print or publish or cause to be printed or published a notice or advertisement relating to employment by such an employer or membership in or any classification or referral for employment by the employment agency, indicating any preference, limitation, specification, or discrimination, based on race, color, religion, national origin, sex, or age forty (40) and over, or because the person is a qualified individual with a disability, except that such a notice or advertisement may indicate a preference, limitation, or specification based on religion, national origin, sex, or age forty (40) and over, or because the person is a qualified individual with a disability, when religion, national origin, sex, or age forty (40) and over, or because the person is a qualified individual with a disability, is a bona fide occupational qualification for employment.

EXECUTIVE BRANCH CODE OF ETHICS

In the 1992 regular legislative session, the General Assembly passed and Governor Brereton Jones signed Senate Bill 63 (codified as KRS 11A), the Executive Branch Code of Ethics, which states, in part:

KRS 11A.040 (7) provides:

No present or former public servant shall, within six (6) months following termination of his office or employment, accept employment, compensation, or other economic benefit from any person or business that contracts or does business with, or is regulated by, the state in matters in which he was directly involved during the last thirty-six (36) months of his tenure. This provision shall not prohibit an individual from returning to the same business, firm, occupation, or profession in which he was involved prior to taking office or beginning his term of employment, or for which he received, prior to his state employment, a professional degree or license, provided that, for a period of six (6) months, he personally refrains from working on any matter in which he was directly involved during the last thirty-six (36) months of his tenure in state government. This subsection shall not prohibit the performance of ministerial functions, including but not limited to filing tax returns, filing applications for permits or licenses, or filing incorporation papers, nor shall it prohibit the former officer or public servant from receiving public funds disbursed through entitlement programs.

KRS 11A.040 (9) states:

A former public servant shall not represent a person or business before a state agency in a matter in which the former public servant was directly involved during the last thirty-six (36) months of his tenure, for a period of one (1) year after the latter of:

- a) The date of leaving office or termination of employment; or
- b) The date the term of office expires to which the public servant was elected.

This law is intended to promote public confidence in the integrity of state government and to declare as public policy the idea that state employees should view their work as a public trust and not as a way to obtain private benefits.

If you have worked for the executive branch of state government within the past six months, you may be subject to the law's prohibitions. The law's applicability may be different if you hold elected office or are contemplating representation of another before a state agency.

Also, if you are affiliated with a firm which does business with the state and which employs former state executive-branch employees, you should be aware that the law may apply to them.

In case of doubt, the law permits you to request an advisory opinion from the Executive Branch Ethics Commission, 3 Fountain Place, Frankfort, Kentucky 40601; telephone (502) 564-7954.

Revised: January 27, 2017

Kentucky Equal Employment Opportunity Act of 1978

The requirements of the Kentucky Equal Employment Opportunity Act of 1978 (KRS 45.560-45.640) shall apply to this Contract. The apparent low Bidder will be required to submit EEO forms to the Division of Construction Procurement, which will then forward to the Finance and Administration Cabinet for review and approval. No award will become effective until all forms are submitted and EEO/CC has certified compliance. The required EEO forms are as follows:

- EEO-1: Employer Information Report
- Affidavit of Intent to Comply
- Employee Data Sheet
- Subcontractor Report

These forms are available on the Finance and Administration's web page under ***Vendor Information, Standard Attachments and General Terms*** at the following address:
<https://www.eProcurement.ky.gov>.

Bidders currently certified as being in compliance by the Finance and Administration Cabinet may submit a copy of their approval letter in lieu of the referenced EEO forms.

For questions or assistance please contact the Finance and Administration Cabinet by email at **finance.contractcompliance@ky.gov** or by phone at 502-564-2874.

EMPLOYEE RIGHTS UNDER THE FAIR LABOR STANDARDS ACT

THE UNITED STATES DEPARTMENT OF LABOR WAGE AND HOUR DIVISION

FEDERAL MINIMUM WAGE

\$7.25

 PER HOUR

BEGINNING JULY 24, 2009

OVERTIME PAY

At least 1½ times your regular rate of pay for all hours worked over 40 in a workweek.

CHILD LABOR

An employee must be at least **16** years old to work in most non-farm jobs and at least **18** to work in non-farm jobs declared hazardous by the Secretary of Labor.

Youths **14** and **15** years old may work outside school hours in various non-manufacturing, non-mining, non-hazardous jobs under the following conditions:

No more than

- **3** hours on a school day or **18** hours in a school week;
- **8** hours on a non-school day or **40** hours in a non-school week.

Also, work may not begin before **7 a.m.** or end after **7 p.m.**, except from June 1 through Labor Day, when evening hours are extended to **9 p.m.** Different rules apply in agricultural employment.

Contract ID: 171257
Page 66 of 70

TIP CREDIT

Employers of “tipped employees” must pay a cash wage of at least \$2.13 per hour if they claim a tip credit against their minimum wage obligation. If an employee's tips combined with the employer's cash wage of at least \$2.13 per hour do not equal the minimum hourly wage, the employer must make up the difference. Certain other conditions must also be met.

ENFORCEMENT

The Department of Labor may recover back wages either administratively or through court action, for the employees that have been underpaid in violation of the law. Violations may result in civil or criminal action.

Employers may be assessed civil money penalties of up to \$1,100 for each willful or repeated violation of the minimum wage or overtime pay provisions of the law and up to \$11,000 for each employee who is the subject of a violation of the Act's child labor provisions. In addition, a civil money penalty of up to \$50,000 may be assessed for each child labor violation that causes the death or serious injury of any minor employee, and such assessments may be doubled, up to \$100,000, when the violations are determined to be willful or repeated. The law also prohibits discriminating against or discharging workers who file a complaint or participate in any proceeding under the Act.

ADDITIONAL INFORMATION

- Certain occupations and establishments are exempt from the minimum wage and/or overtime pay provisions.
- Special provisions apply to workers in American Samoa and the Commonwealth of the Northern Mariana Islands.
- Some state laws provide greater employee protections; employers must comply with both.
- The law requires employers to display this poster where employees can readily see it.
- Employees under 20 years of age may be paid \$4.25 per hour during their first 90 consecutive calendar days of employment with an employer.
- Certain full-time students, student learners, apprentices, and workers with disabilities may be paid less than the minimum wage under special certificates issued by the Department of Labor.

For additional information:



1-866-4-USWAGE

(1-866-487-9243)

TTY: 1-877-889-5627



WWW.WAGEHOUR.DOL.GOV

U.S. Department of Labor | Wage and Hour Division

PART IV
INSURANCE

INSURANCE

The Contractor shall procure and maintain the following insurance in addition to the insurance required by law:

- 1) Commercial General Liability-Occurrence form – not less than \$2,000,000 General aggregate, \$2,000,000 Products & Completed Aggregate, \$1,000,000 Personal & Advertising, \$1,000,000 each occurrence.
- 2) Automobile Liability- \$1,000,000 per accident
- 3) Employers Liability:
 - a) \$100,000 Each Accident Bodily Injury
 - b) \$500,000 Policy limit Bodily Injury by Disease
 - c) \$100,000 Each Employee Bodily Injury by Disease
- 4) The insurance required above must be evidenced by a Certificate of Insurance and this Certificate of Insurance must contain one of the following statements:
 - a) "policy contains no deductible clauses."
 - b) "policy contains _____ (amount) deductible property damage clause but company will pay claim and collect the deductible from the insured."
- 5) **KENTUCKY WORKMEN'S COMPENSATION INSURANCE.** The contractor shall furnish evidence of coverage of all his employees or give evidence of self-insurance by submitting a copy of a certificate issued by the Workmen's Compensation Board.

The cost of insurance is incidental to all contract items. All subcontractors must meet the same minimum insurance requirements.

PART V
BID ITEMS

PROPOSAL BID ITEMS

171257

Page 1 of 1

Report Date 11/13/17

Section: 0001 - PAVING

LINE	BID CODE	ALT	DESCRIPTION	QUANTITY	UNIT	UNIT PRIC	FP	AMOUNT
0010	00001		DGA BASE	240.00	TON		\$	
0020	00100		ASPHALT SEAL AGGREGATE	3.10	TON		\$	
0030	00103		ASPHALT SEAL COAT	.38	TON		\$	
0040	02073		JPC PAVEMENT-9 IN	602.00	SQYD		\$	

Section: 0002 - ROADWAY

LINE	BID CODE	ALT	DESCRIPTION	QUANTITY	UNIT	UNIT PRIC	FP	AMOUNT
0050	01830		STANDARD INTEGRAL CURB	201.00	LF		\$	
0060	01904		REMOVE CURB	829.00	LF		\$	
0070	01915		STANDARD BARRIER MEDIAN TYPE 1	53.00	SQYD		\$	
0080	01935		MOUNTABLE MEDIAN TYPE 1	144.00	SQYD		\$	
0090	02009		REMOVE ASPHALT MEDIAN	313.00	SQYD		\$	
0100	02014		BARRICADE-TYPE III	4.00	EACH		\$	
0110	02058		REMOVE PCC PAVEMENT	76.00	SQYD		\$	
0120	02200		ROADWAY EXCAVATION	344.00	CUYD		\$	
0130	02562		TEMPORARY SIGNS	152.00	SQFT		\$	
0140	02598		FABRIC-GEOTEXTILE TYPE III	900.00	SQYD		\$	
0150	02650		MAINTAIN & CONTROL TRAFFIC	1.00	LS		\$	
0160	02726		STAKING	1.00	LS		\$	
0170	06514		PAVE STRIPING-PERM PAINT-4 IN	2,000.00	LF		\$	
0180	20550ND		SAWCUT PAVEMENT	836.00	LF		\$	
0190	24679ED		PAVE MARK THERMO CHEVRON	140.00	SQFT		\$	

Section: 0003 - DEMOBILIZATION &/OR MOBILIZATION

LINE	BID CODE	ALT	DESCRIPTION	QUANTITY	UNIT	UNIT PRIC	FP	AMOUNT
0200	02569		DEMOBILIZATION	1.00	LS		\$	