

SAFERoad SOLUTIONS

EFFECTIVE ROAD DESIGNS EXPLAINED



Jughandles



A jughandle is a road design that eliminates left turns at a main intersection by redirecting vehicles to a connecting road and secondary intersection.



BENEFITS

- **Efficiency** – Redirecting left turns away from the main intersection means there are fewer traffic signal phases, which reduces wait times and improves efficiency.
- **Safety** – Eliminating left turns reduces the number of times vehicles cross paths, which reduces the risk of crashes.

SAFERoad SOLUTIONS

EFFECTIVE ROAD DESIGNS EXPLAINED



Jughandles

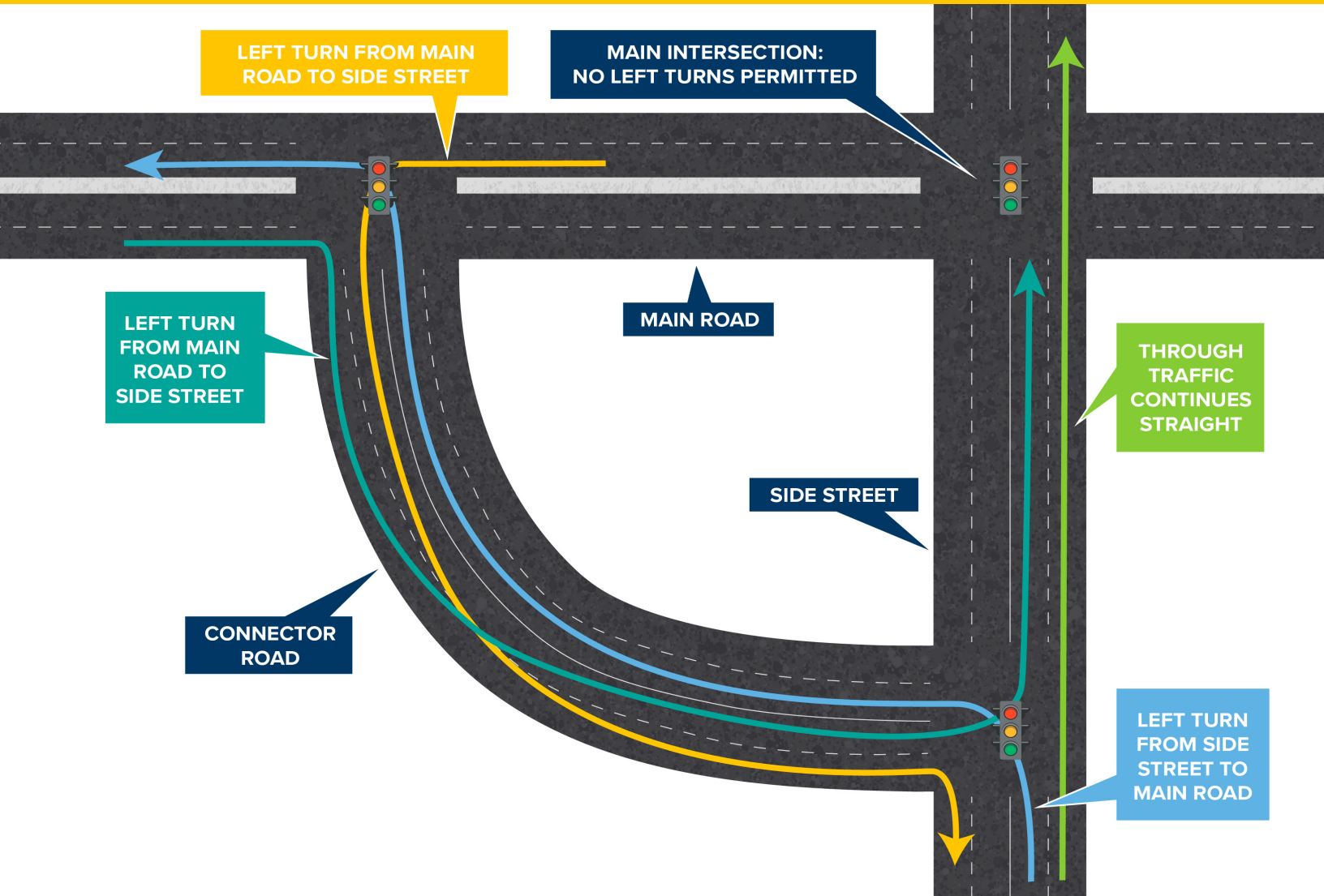

WHAT TO KNOW ABOUT JUGHANDLES

- A jughandle helps ease congestion because eliminating left turns allows vehicles to continuously flow through the main intersection.
- It also decreases the number of times vehicles cross paths in the main intersection, which reduces the risk of crashes.

WHEN TO USE A JUGHANDLE

A jughandle is an effective design for:

- Major intersections with low- to medium-left-turning traffic volumes.
- Connecting a high speed, highly traveled roadway to a lower speed, less traveled roadway.