

TYPICAL BARRIER SECTION

① Mandatory roughened construction joint with "V-Groove Rustication". Concrete above this joint is to be placed after slab has been properly cured and included in the bid for Rail System, Type 4.

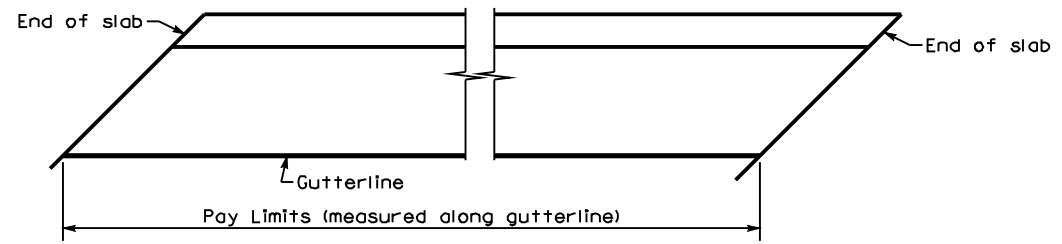

PLAN OF BARRIER

General Notes

MEASUREMENT: The linear foot bid for the barrier is measured along the roadway gutterline. Include all reinforcement shown and all concrete above the top of slab in the bid item.

REINFORCEMENT: All reinforcement shown on this sheet is to be Size #5 and epoxy coated. Use stirrup bend diameters for all bent bars. Straight reinforcement is to be lapped 2'-2" when necessary.

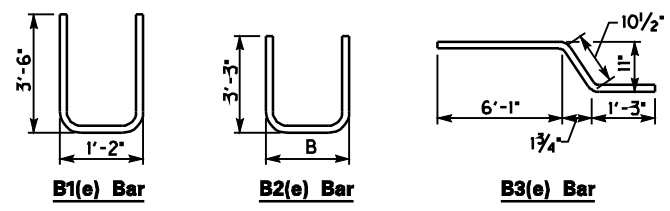

SHEET LOCATION: DATE: \$\$\$DATE\$\$\$ USERNAME: \$\$\$plottedby\$\$\$ FILE NAME: \$\$\$designdetailspecifications\$\$\$

REVISION		DATE
DATE:	CHECKED BY:	
DESIGNED BY:	DETAILED BY:	
Commonwealth of Kentucky DEPARTMENT OF HIGHWAYS COUNTY		
ROUTE	CROSSING	
RAIL SYSTEM TYPE 4 DETAILS		
ITEM NUMBER	PREPARED BY Division of Structural Design	SHEET NO.
		DRAWING NO.