

A REQUEST FOR PROPOSAL FOR PERSONAL SERVICES CONTRACT

Department of Highways
Professional Services Procurement Bulletin 2013-12
Pike / KY 1441 / 12-1115.00
Knott / CR 1008 / 12-1116.00

This document constitutes a Request for Proposals for Personal Service Contract from qualified individuals and organizations to furnish those services as described herein for the Commonwealth of Kentucky, Department of Highways.

I. PROJECT DESCRIPTION

Counties – Pike and Knott
Route – (A) KY 1441
(B) CR 1008
Item No. – (A) 12-1115.00
(B) 12-1116.00

Project Description –

(A) Replace bridge on Fishtrap Road (KY 1441) over Raccoon Creek at intersection with Coon Creek (CR 1371) – 098B00093N

(B) Replace bridge on Rocklick Branch (CR 1008) Over Right Fork of Beaver Creek at JCT with South Highway 7 (KY 7) – 060C00006N

II. PROJECT INFORMATION

Project Manager – Chris James, P.E.

User Division – Highway Design

Approximate Fee – (A) \$200,000
(B) \$200,000

Project Funding – (A) Federal Funds (BRO)
(B) Federal Funds (BRZ)

Project Length – (A) 0.04 mile
(B) 0.04 mile

III. PURPOSE AND NEED

(A.) Replace a two-lane bridge that has a Sufficiency Rating of 40.1 and is structurally deficient. Make improvements to address structural deficiencies of the bridge and correct geometric deficiencies in the roadway alignment.

(B.) Replace a one-lane bridge that has a Sufficiency Rating of 26.7 and is structurally deficient. Improvements will be made through replacement that will address the safety concerns associated with the project.

IV. DBE REQUIREMENT

None

V. SCOPE OF WORK

The selected consultant will be required to provide engineering services to perform Preliminary Engineering and Final Roadway Design, including drainage design, right-of-way plans, construction plans, traffic control plans, cost estimates, structure plans, and an anticipated construction schedule.

VI. SPECIAL INSTRUCTIONS

One (1) consultant will be required to provide services for projects A and B. Consultants shall complete their *Project Approach* section on both projects.

One public meeting for each project will also be held after Preliminary Line & Grade Inspection.

The Department reserves the right to retain any of the services advertised here to be performed by in-house state forces.

Instructions for Response to Announcement can be found at:

<http://transportation.ky.gov/Professional-Services/Pages/Respond-to-an-Announcement.aspx>

VII. AVAILABLE STUDIES

[DNA Study for Pike County – Fishtrap Road, Item No. 12-1115](#)

[DNA Study for Knott County – Rocklick Branch, Item No. 12-1116](#)

[Bridge Reports for 12-1115 and 12-1116](#)

VIII. METHOD OF DESIGN

The Selected Consultant shall utilize the current CADD Standards for Highway Plans policy in the development of the Highway Plans.

IX. PHOTOGRAMMETRIC SERVICES

Field Surveying will be provided by the Department.

X. STRUCTURE DESIGN

The Selected Consultant shall do the necessary engineering service to submit to the KYTC an Advanced Situation Folder(s) for the appropriate applicable structure(s). The Structure Design will be performed by the Consultant. Structure Design services may be added to the Contract by Contract Modification. Prequalification in the area of Structure Design is required to be identified in the Consultant's Response to Announcement.

XI. ENVIRONMENTAL

The Department will provide all necessary Environmental Services required for these projects. CE Level 1 documents are anticipated.

XII. GEOTECHNICAL SERVICES

The Department will provide any necessary Geotechnical Services required for these projects.

XIII. TRAFFIC

The Department will provide all necessary existing traffic counts and forecasting for these projects.

XIV. PREQUALIFICATION REQUIREMENTS

To respond to this project, the project team must be prequalified in the following areas by the date of this advertisement.

ROADWAY DESIGN

- Rural Roadway Design
- Surveying

STRUCTURE DESIGN

- Spans under 500 feet

XV. PROCUREMENT SCHEDULE

Dates other than Response Date are tentative and provided for information only.

RESPONSE DATE • Wednesday, July 10, 2013 4:30 p.m. E.S.T. (Frankfort time)

FIRST SELECTION COMMITTEE • July 16, 2013

FINAL SELECTION COMMITTEE • July 30, 2013

PRE-DESIGN MEETING • August 5, 2013

TENTATIVE DEADLINE FOR CONSULTANT FEE PROPOSAL • August 14, 2013

CONTRACT NEGOTIATIONS • August 26, 2013

NOTICE TO PROCEED • October 1, 2013

XVI. PROJECT SCHEDULE

Project schedule may be adjusted during the pre-design conference or contract negotiations.

PRELIMINARY LINE AND GRADE • April 2014

RIGHT-OF-WAY UTILITY PLANS • June 2014

JOINT INSPECTION • October 2014

FINAL PLANS • April 2015

XVII. EVALUATION FACTORS

1. Relative experience of Consultant personnel assigned to project team with highway projects for KYTC and/or for federal, local, or other state governmental agencies. (10 points)
2. Capacity to comply with project schedule. (10 points)
3. Past record of performance on project of similar type and complexity. (10 points)
4. Project approach and proposed procedures to accomplish the services for the project. (10 points)
5. Consultant's offices where work is to be performed. (2 points)

For state-funded projects, if a Selection Committee vote results in a tie between two (2) firms, one (1) of which will perform more of the work tasks in Kentucky than the other, then the former firm shall be ranked one (1) place ahead of the latter.

XVIII. SELECTION COMMITTEE MEMBERS

1. Mark Westfall, P.E., User Division
2. Kevin Martin, P.E., User Division
3. Sam Hale, P.E., Secretary's Pool
4. Carl Van Zee, P.E., Secretary's Pool
5. David Eaton, Governor's Pool

PROJECT MAP
PIKE COUNTY
ITEM NO. 12-1115.00
 REPLACE BRIDGE ON FISHTRAP RD (KY 1441) OVER
 RACCOON CREEK AT INTERSECTION WITH COON CREEK
 (CR 1371) BRIDGE ID# 098B00093N SR=40.1
 Date: 5/31/2013

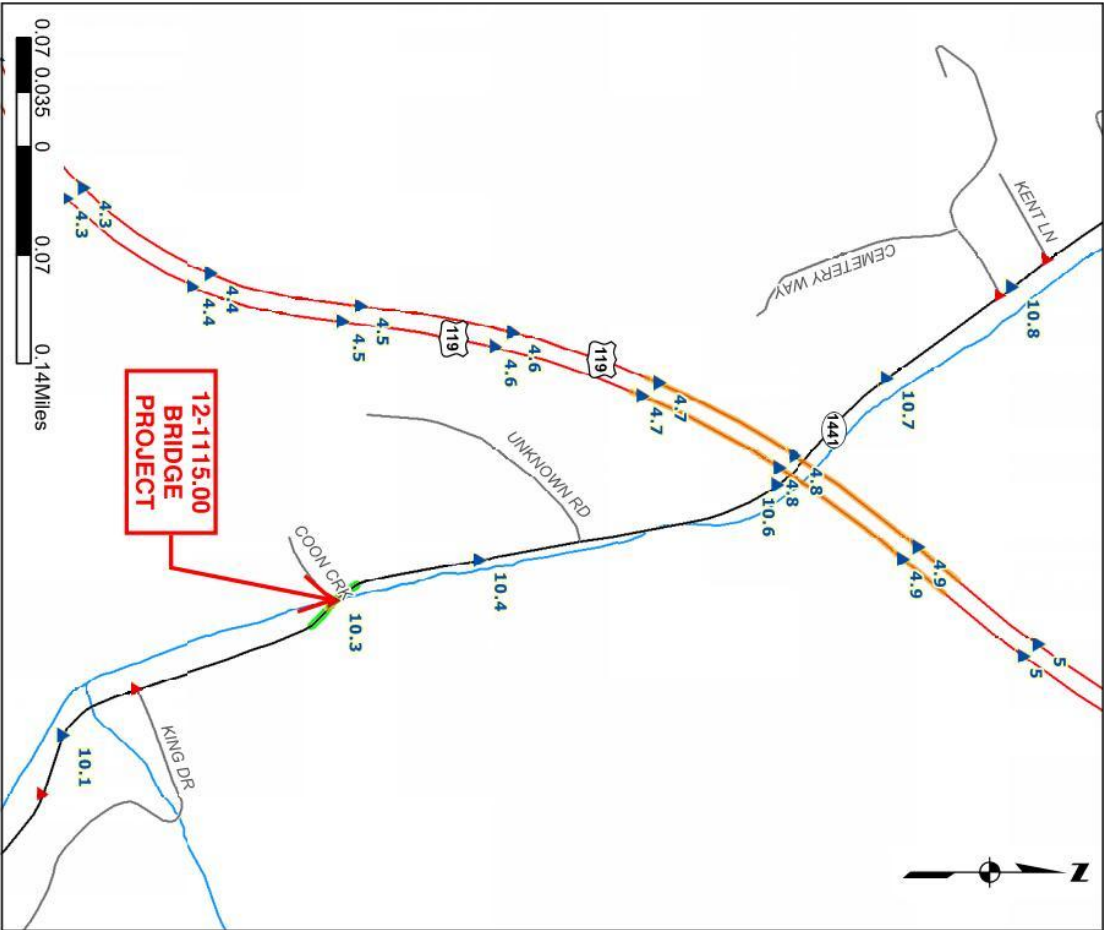
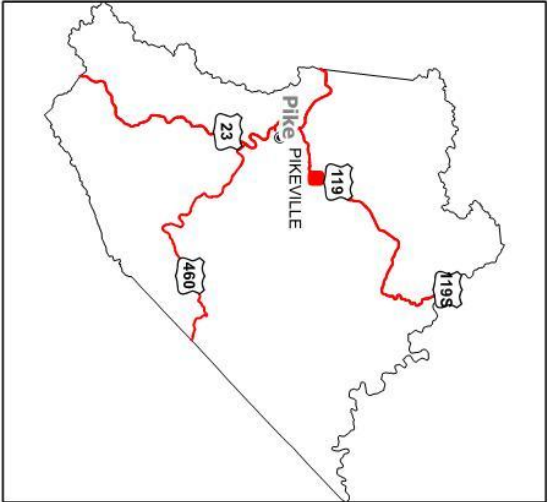

PROJECT MAP
KNOTT COUNTY
ITEM NO. 12-1116.00

REPLACE BRIDGE ON ROCKLICK BRANCH (CR 1008) OVER RIGHT FORK BEAVER CREEK AT JUNCTION WITH SOUTH HIGHWAY 7 (KY 7) BRIDGE ID# 060C00006N SR=26.7

Date: 5/31/2013

