

# A REQUEST FOR PROPOSAL FOR PERSONAL SERVICES CONTRACT

Department of Highways  
Professional Services Procurement Bulletin 2013-04  
Allen County/KY 2160/3-1080  
Logan County/CR 1249/3-1083  
Shelby/ KY 53/5-1060.00  
Shelby/KY 55/5-1063.00  
Shelby/CR1036/5-1069.00

This document constitutes a Request for Proposals for Personal Service Contract from qualified individuals and organizations to furnish those services as described herein for the Commonwealth of Kentucky, Department of Highways.

## **I. PROJECT DESCRIPTION**

County – A. Allen / Logan  
B. Shelby / Shelby / Shelby

Route – A. KY 2160 / CR 1249  
B. KY 53 / KY 55 / CR1036

Item No – A. 3-1080.00 / 3-1083.00  
B. 5-1060.00 / 5-1063.00 / 5-1069.00

Project Description –  
Group A.

3-1080.00 - Allen County, KY 2160, 3-1080.00 - Replace Bridge and approaches over Florida Creek,(MP 0.646) 0.01 mi. south of intersection with Hunt Lane, SR=42.  
ID-002B00048N

3-1083.00 - Logan County, CR 1249, 3-1083.00 - Replace Bridge over Red River, (MP 0.806) 0.78 mi. southeast of junction of Orndorff Mill Road, SR=25.3, ID-071C00023N

Group B.

5-1060.00 - Shelby County, KY 53, 5-1060 – Replace bridge and approaches on KY 53 (@ mp 11.366) over Fox Run Creek; 3.0 miles north of JCT US-60W; (structurally deficient, SR=40.1. ID-106B00031N).

5-1063.00 - Shelby County, KY 55, 5-1063 – Replace bridge and approaches on KY 55 (@ mp 3.859) over Bullskin Creek; 0.18 miles north of Heritage Lane (PR-1212) (structurally deficient, SR=36.2, ID-106B00020N).

5-1069.00 - Shelby County, CR 1036, 5-1069, Replace bridge and approaches on (CR 1036) Scrabble Road (@mp 0.482) over Backbone Creek; 0.47 mile east of Cedarmore Road (KY 1922) (functionally obsolete), SR=44.2, ID – 106C00055N).

## **II. PROJECT INFORMATION**

Project Manager – A. Andrew Stewart, P.E.  
B. Keith Downs

User Division – Highway Design

Approximate Fee –

A.

3-1080.00 - \$100,000 (Lump Sum Fee)

3-1083.00 - \$100,000 (Lump Sum Fee)

B.

5-1060.00 - \$225,000 (Lump Sum Fee)

5-1063.00 - \$300,000 (Lump Sum Fee)

5-1069.00 - \$150,000 (Lump Sum Fee)

Project Funding –

A.

3-1080.00 - Federal Funds (BRO)

3-1083.00 - Federal Funds (BRZ)

B.

5-1060.00 - Federal Funds (BRO)

5-1063.00 - Federal Funds (BRO)

5-1069.00 - Federal Funds (BRZ)

Project Length –

A.

3-1080.00 - approximately 0.2 miles

3-1083.00 - approximately 0.2 miles

B.

5-1060.00 - 0.10 miles

5-1063.00 - 0.04 miles

5-1069.00 - 0.04 miles

## **III. PURPOSE AND NEED**

3-1080.00 - The existing structure is a double 12'X6' box culvert, (MP 0.646) ID-002B00048N built in 1950 and classified as structurally deficient and functionally obsolete. The sufficiency rating is currently shown as 42. The purpose of the project is to replace the structure to provide a safe, reliable roadway for motorists using Old Hartsville Road (KY 2160).

3-1083.00 The existing structure is a 95' single span steel pin-connected thru truss bridge (MP 0.806) ID-071C00023N built in 1925 and classified as structurally deficient and functionally obsolete. The sufficiency rating is currently shown as 25.3. The purpose of the project is to replace the structure to provide a safe, reliable roadway for motorists using Logan Mill Road.

5-1060.00 - The purpose of this project is to replace the bridge (106B00031N – 85 year old, 3-span T-Beam Bridge, 129' in length) and its approaches on KY 53 between MP 11-3.16 and MP 11.416 over Fox Run Creek. The project is necessary to replace the two-lane bridge, which is

dilapidated and structurally deficient, to improve safety and substandard condition of the bridge. With severe spalling, deterioration, exposed reinforcement steel and section loss, the two-lane bridge has been assessed a sufficiency rating of 40.1. KY 53 is a Rural Minor Arterial with ADT's: Current (2011): 4,070, Future (2031): 8,140.

5-1063.00 - The purpose of this project is to replace the bridge (106B00020N) – 77 year old, 5-span T-Beam Bridge, 215' in length) and its approaches on KY 55 between MP 3.839 and MP 3.879 over Bullskin Creek. The project is necessary to replace the two-lane bridge, which is dilapidated and structurally deficient, to improve safety and substandard condition of the bridge. With severe spalling, deterioration, exposed reinforcement steel and section loss, the two-lane bridge has been assessed a sufficiency rating of 36.2. KY 55 is a Rural Minor Arterial with ADT's: Current (2011): 5,780, Future (2031): 10,960.

5-1069.00 - The purpose of this project is to replace the bridge (106C00055N – 25 year old, single span steel mesh military bridge, 41' in length) and its approaches on CR 1036 Scrabble Road between MP 0.462 and MP 0.502 over Backbone Creek. The project is necessary to replace the single-lane bridge, which is structurally deficient and functionally obsolete, to improve safety and substandard condition of the bridge. With settlement of the abutments and wings, spalling, deterioration, exposed reinforcement steel, the single lane bridge has been assessed a sufficiency rating of 44.2 CR-1036 is a County Road with ADT's: Current (2006); 137, Future (2026): 188.

#### **IV. DBE REQUIREMENT**

The Consultant team shall include a DBE Participation Plan with their response to announcement. An additional page will be allowed with the project approach in the Response to Announcement to convey this plan. A maximum of 4 points will be considered in the evaluation factors for the DBE Participation Plan.

#### **V. SCOPE OF WORK**

- A. The Selected consultant will be required to provide engineering services preliminary and final roadway design including the preparation of any design studies, drainage design, right-of-way plans, construction plans including storm water construction and post construction Best Management Practices (BMP), signing and pavement marking plans, traffic control plans, cost estimates, and an anticipated construction schedule.

It is in intent of District to utilize the following on both projects:

- Latest edition of AASHTO Guidelines for Geometric Design of Very Low-Volume Local Roads (ADT<400) due to low volumes and low speeds.
- A two-lane bridge and improved roadway approach geometry.

- B. The selected consultant will be responsible for Preliminary Engineering and Final Roadway Design, including the preparation of preliminary line and grade and grade plans, drainage design, right-of-way plans, construction plans, traffic control plans, cost estimates, and advanced situation folders for structural design.

#### **VI. SPECIAL INSTRUCTIONS**

The Department may retain any of the services advertised here to be performed by in-house

state forces. Two (2) consultants will be selected with each receiving a contract. One (1) consultant will be selected for Group A, and one (1) consultant will be selected for Group B.

Consultants shall focus their *Project Approach* section on one project from each group. The following projects are to be used for the Project Approach Section write up:

Group A – 3-1083.00

Group B – 5-1063.00

Instructions for Response to Announcement can be found at:

<http://transportation.ky.gov/Professional-Services/Pages/Respond-to-an-Announcement.aspx>

## **VII. AVAILABLE STUDIES**

[District 3 - 2012 DNA Scoping Studies](#)

[District 3 Bridge Inspection Reports 3-1080.00 and 3-1083.00](#)

[District 5 – 2012 DNA Scoping Studies](#)

[District 5 Bridge Inspection Reports 5-1063.00, 5-1063.00, 5-1069.00](#)

## **VIII. METHOD OF DESIGN**

The selected consultant shall utilize the most recent CADD Standards for Highway Plans Policy in the development of the highway plans.

## **IX. ENVIRONMENTAL**

The Department will provide any necessary Environmental Services. The anticipated environmental document will require a Categorical Exclusion for both groups.

## **X. PHOTOGRAMMETRIC SERVICES**

Photogrammetry is not required; the consultant will be responsible for all surveying via conventional survey methods for both groups.

## **XI. STRUCTURE DESIGN**

The selected consultant shall do the necessary Engineering Services to submit to the KYTC Advance Situation Folders for the applicable structure(s). The Structure Design will be performed by the Department for both groups.

## **XII. GEOTECHNICAL SERVICES**

The Department will provide all Geotechnical Services required for the project for both groups.

## **XIII. PREQUALIFICATION REQUIREMENTS**

To respond to this project, the consultant project team must be prequalified in the following

areas by the date of this advertisement.

#### ROADWAY DESIGN

- Rural Roadway Design <\$250,000
- Surveying
- 

#### **XIV. PROCUREMENT SCHEDULE**

Dates other than Response Date are tentative and provided for information only.

RESPONSE DATE • October 31, 2012 4:30 p.m. E.S.T. (Frankfort time)

FIRST SELECTION COMMITTEE • November 5, 2012

SECOND SELECTION COMMITTEE • November 19, 2012

PRE-DESIGN CONFERENCE • November 26, 2012

TENTATIVE DEADLINE FOR CONSULTANT FEE PROPOSAL • January 7, 2013

CONTRACT NEGOTIATIONS • January 13, 2013

NOTICE TO PROCEED • March 7, 2013

#### **XV. PROJECT SCHEDULE**

PRELIMINARY LINE AND GRADE MEETING • July 30, 2013

JOINT INSPECTION • December 4, 2013

RIGHT-OF-WAY UTILITY PLANS • January 8, 2014

FINAL PLANS • August 28, 2015

#### **XVI. EVALUATION FACTORS**

Consultants will be evaluated by the selection committee based on the following, weighted factors:

1. Relative experience of consultant personnel assigned to project team with highway project for KYTC and/or federal, local or other state governmental agencies. (10 Points)
2. Capacity to comply with project schedule. (10 Points)
3. Past record of performance on projects similar in type and complexity. (10 Points)
4. Project approach and proposed procedures to accomplish the services for the project. (10 Points)
5. Consultant's offices where work is to be performed. (2 Points)

For state-funded projects, if a Selection Committee vote results in a tie between two (2) firms, one (1) of which will perform more of the work tasks in Kentucky than the other, then the former firm shall be ranked one (1) place ahead of the latter.

**XVII. SELECTION COMMITTEE MEMBERS**

1. Andrew Stewart, P.E., User Division
2. Tala Quino, P.E., User Division
3. Diana Radcliffe, P.E., Secretary's Pool
4. Tim Pyles, P.E., Secretary's Pool
5. Brad Rister, PE, Governor's Pool

**Project Description**  
 Allen County, KY 2160, 3-1080.00 -  
 Replace Bridge and approaches over  
 Florida Creek, (MP 0.646) 0.01 mi.  
 south of intersection with Hunt Lane,  
 SR=42.  
 ID-002B00048N

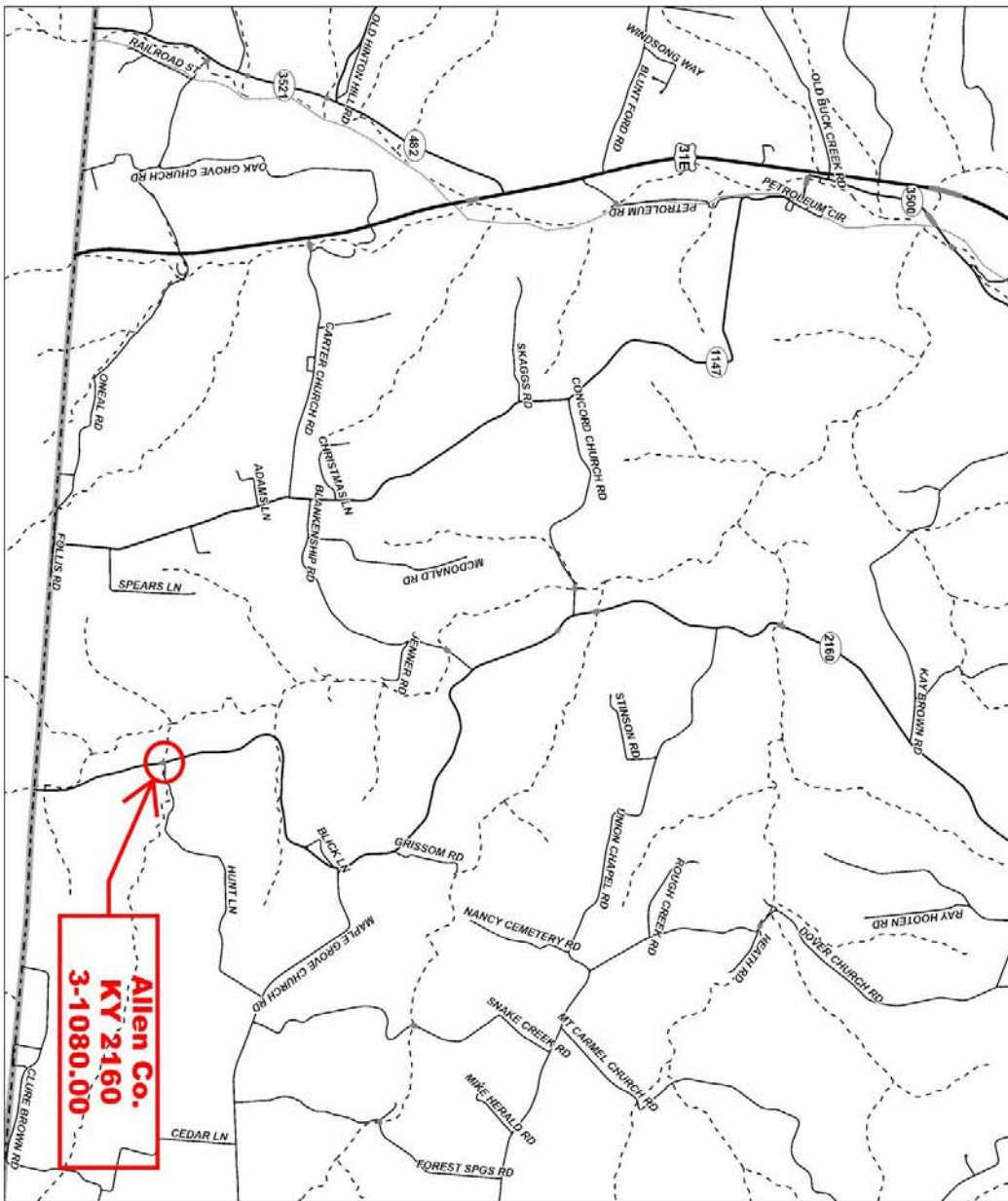
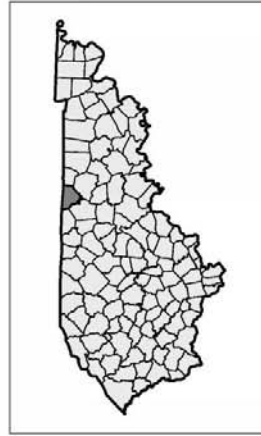
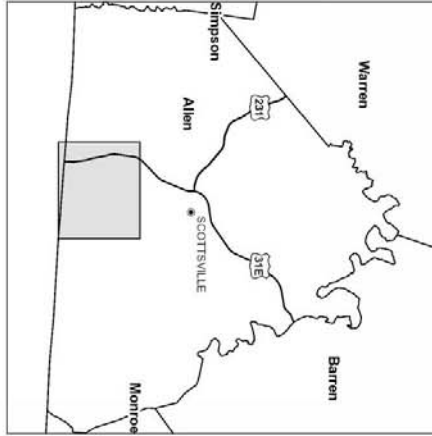

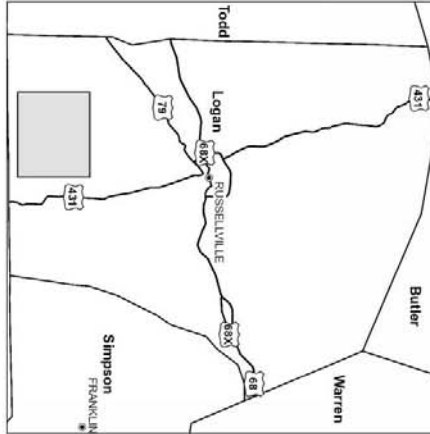
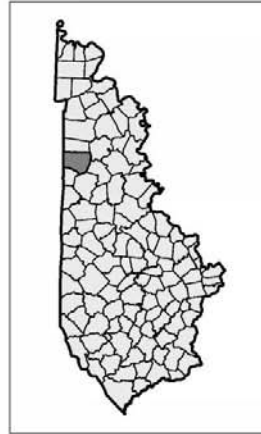

**Project Description**  
 Logan County, CR 1249, 3-1083.00 -  
 Replace Bridge over Red River,  
 (MP 0.806) 0.78 mi. southeast of  
 junction of Orndorff Mill Road,  
 SR=25.3, ID-071C00023N

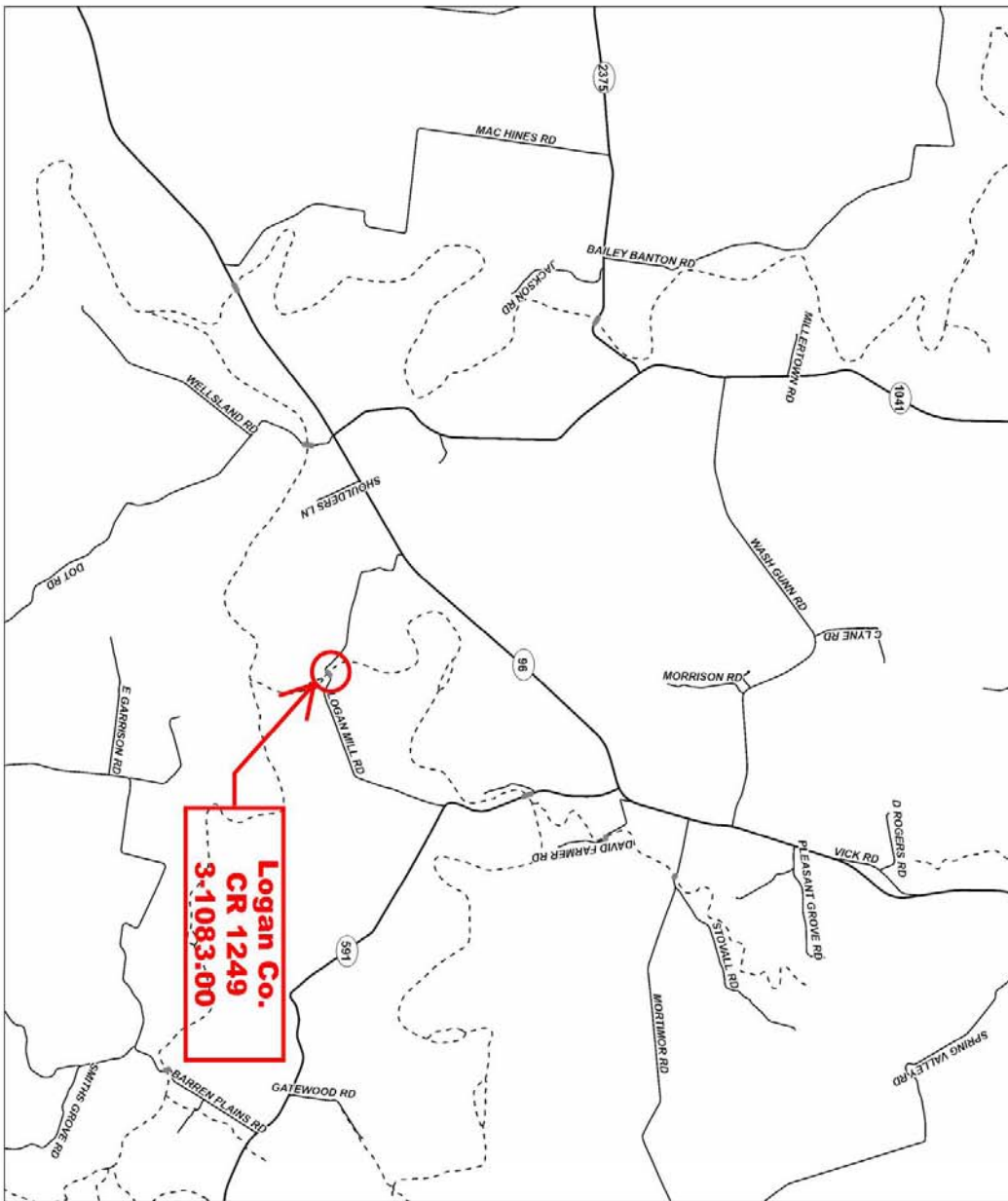



Project Description –  
 A. Shelby County, KY 53, 5-1060 –  
 Replace bridge and approaches on  
 KY 53 (@ mp 11.366) over Fox Run  
 Creek; 3.0 miles north of JCT  
 US-60W

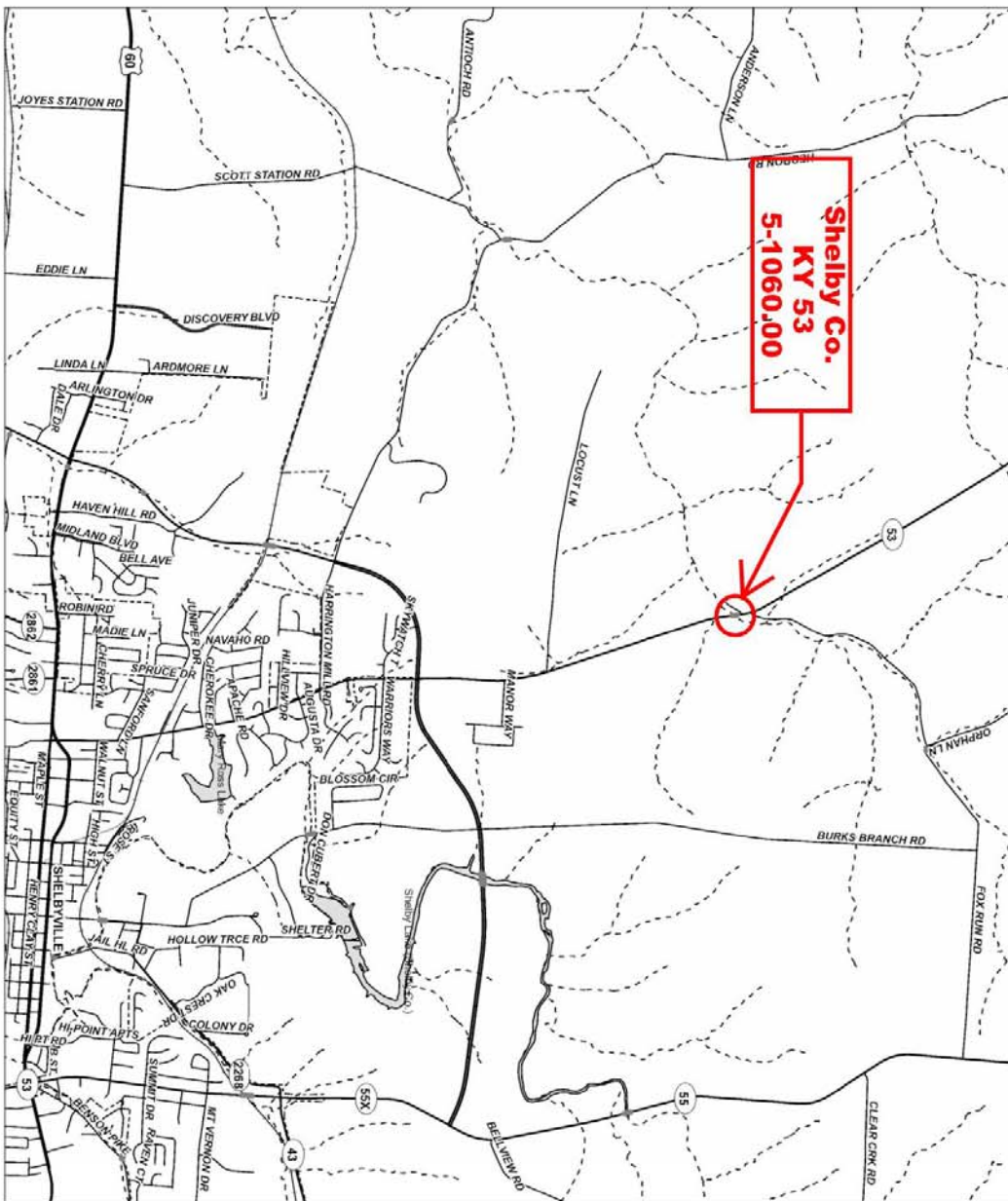
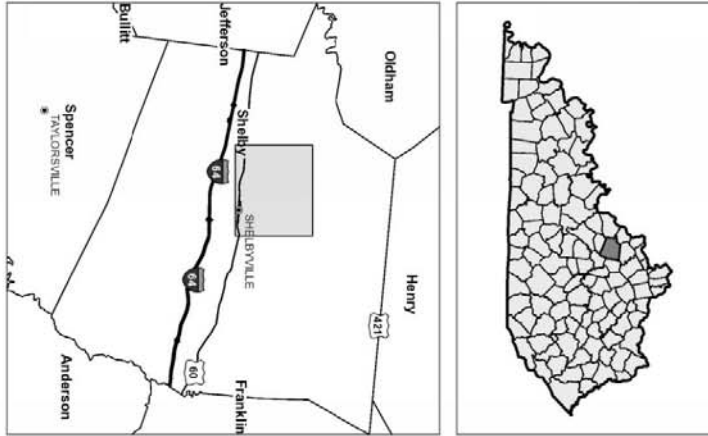

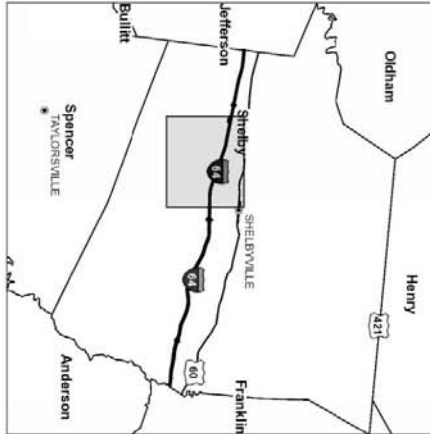
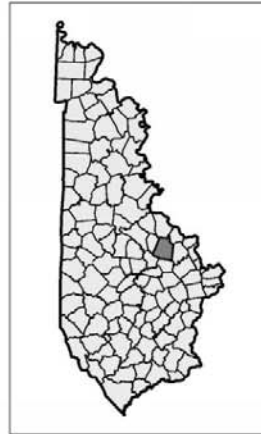

**Project Description –**  
 B. Shelby County, KY 55, 5-1063 –  
 Replace bridge and approaches on  
 KY 55 (@mp 3.859) over Bull Skin  
 Creek; 0.18 miles north of Heritage  
 Lane (PR-1212) (structurally  
 deficient, SR=36.2, ID-106B00020N)

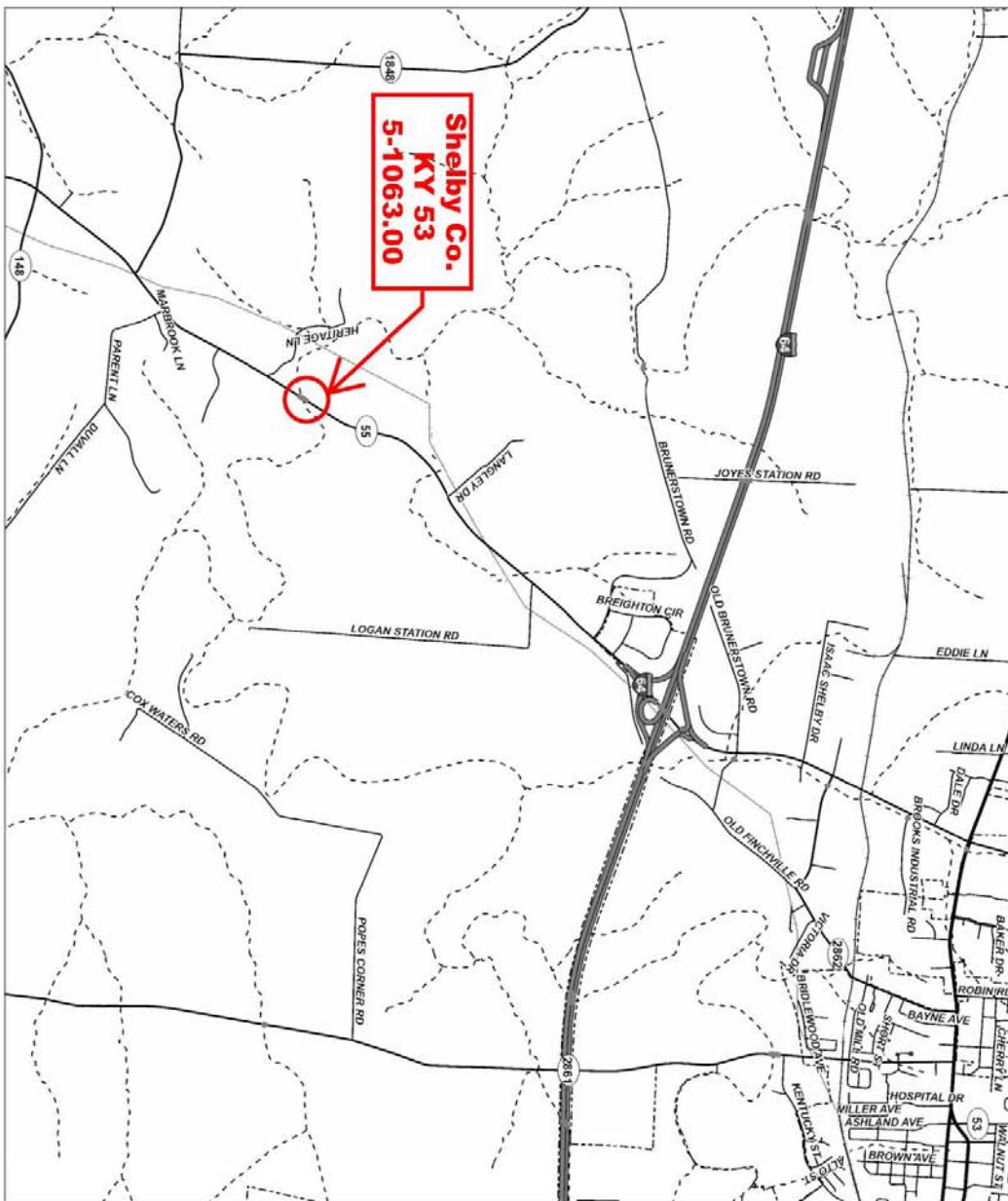

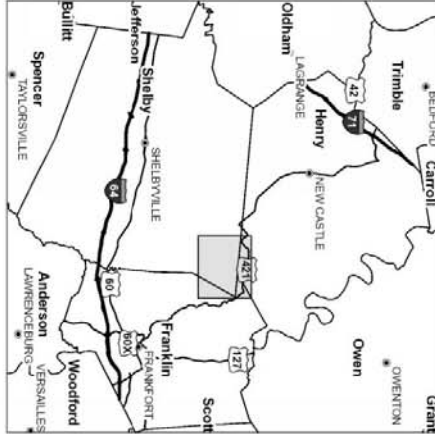
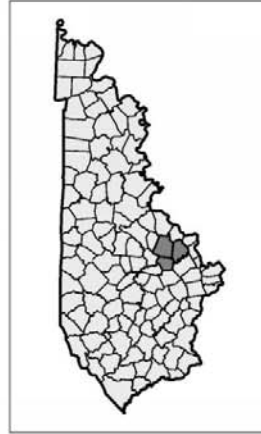

**Project Description -**  
 C. Shelby County, CR 1036, 5-1069,  
 Replace bridge and approaches on  
 (CR 1036) Scrabble Road  
 (@mp 0.482) over Backbone Creek;  
 0.47 mile east of Cedarnore Road  
 (KY 1922) (functionally obsolete),  
 SR=44.2, ID - 106C00055N)

