

**QUADRANT IV**

NO.	ROAD NAME	LGTH.
1300	ROWLETT LANE	1.20
1301	JOYCE MILLS	2.30
1302	LEEPORT	2.85
1303	RODGERS	2.12
1304	LUCKETT LANE	1.30
1305	GOSSOM LANE	1.00
1306	WEBSTER LANE	0.80
1307	BUCHANAN LANE	0.60
1308	POWELL HILL	0.65
1309	CAMPBELL HILL	0.45
1310	WATSON - TANDY	0.85
1311	COOPERS BOTTOM	5.50
1312	BOB GREEN	0.85
1313	WHEELER	0.05
1314	RACE TRACK	1.25
1315	DETMER LANE	0.55
1316	DETMER LANE SPUR	0.05
1317	MOFFETT	0.35
1318	STREETS IN ENLARGEMENT NO. 4	
A	WOODLAW	0.15
B	LAKEVIEW	0.15
C	LAKEVIEW SPUR	0.10
D	GREENBRIAR	0.15
E	TILLEY LANE	0.75
1319	MCCORD LANE	2.00
1320	WHITAKER	0.50
1321	JOYCE RIDGE	2.23
1322	BURKHARDT BOTTOM	2.00
1323	SMITHA	0.60
1324	CRAIG	0.55
1325	CHARLIE P.	0.25
1326	NUBBIN RIDGE	1.30
1327	QUEEN LANE	0.20
1328	KRUSE LANE	0.30
1329	BERNIE GINN	0.45
1330	BARTH HILL	0.60
1331	ALEXANDER	0.40
1332	HUBBARD LANE	0.15
1333	NEW HOPE	0.65
1334	NICHOLS	0.38
1335	RICHWOOD	0.10
1336	SMITHA SPUR	0.05
1337	RICHWOOD SPUR	0.05
1338	HANDLON	0.20
1339	WEBSTER LANE SPUR	0.20
1340	TOLLGATE	0.40

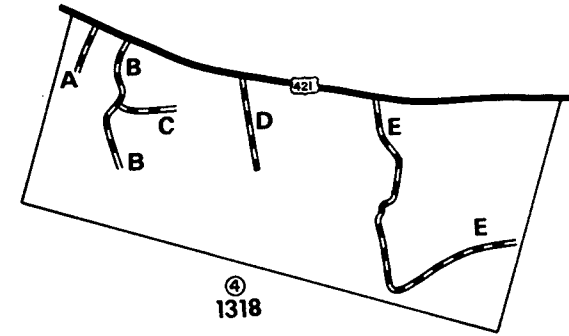

**IV**

**QUADRANT II**

NO.	ROAD NAME	LGTH.
1100	MULLIKEN LANE	0.85
1101	GATEWOOD	0.85
1102	LEHU	0.20
1103	CUTSHAW LANE	1.45
1104	HARDY CREEK	2.75
1105	DRY FORK	0.35
1106	BURTON HILL	0.40
1107	GEORGES CREEK SPUR	0.10
1108	WILSON	0.75
1109	LANDY HILL	0.30
1110	QUIRE - JOSLIN LANE	1.40
1111	RICHMOND HILL	1.65
1112	BUCK CREEK	2.80
1113	GEORGES CREEK	2.10
1114	GRIBBINS	0.45
1115	MARTINI LANE SPUR	0.40
1116	LOUDEN	2.50
1117	LOCUST DRIVE	0.30
1118	JONES LANE	1.25
1119	DAUGHERTY CREEK	0.95
1120	CARMON CREEK	2.10
1121	WEBB LANE	2.15
1122	STREETS IN ENLARGEMENT NO. 2	
A	FAIRVIEW CIRCLE	0.35
B	FAIRVIEW CIRCLE SPUR	0.36
1123	LOGAN LANE	1.75
1124	MARTINI LANE	2.90
1125	WILLARD WILSON	0.55
1126	SMITH LANE	1.50
1127	TANDYWOOD FARM	1.10
1128	NORVELLE	1.65
1129	PERSELL DRIVE	0.10
1130	STARKS LANE	1.45
1131	STREETS IN ENLARGEMENT NO. 3	
A	HUGHES DRIVE	0.30
B	RANDELL COURT	0.20
1132	FAIRGROUNDS	0.75
1133	COLBERT LANE	0.95
1134	THORNHILL	1.40
1135	BUTTON RIDGE	1.60
1136	STREETS IN ENLARGEMENT NO. 5	
A	HAVEN'S AVENUE	0.20
B	OLD HILL	0.05
C	SUNNYSIDE DRIVE	0.30
D	SUNNYSIDE SPUR	0.10
1137	UPPER MIDDLE CREEK	1.05
1138	DOE RIDGE	0.40
1139	ANDERSON LANE	0.35
1140	WILLEY	0.30
1141	CLARK	0.30
1142	SUTHERLAND LANE	0.30
1143	ROBERTS	0.30
1144	STREETS IN ENLARGEMENT NO. 6	
A	TOWN BRANCH	0.10
B	PENDLETON AVENUE	0.10
C	OLD SLED	0.03
D	STONE STREET	0.03
E	SPRING VALLEY	0.04
1145		0.00
1146	LOGAN LANE SPUR	0.20
1147	TANDYWOOD FARM SPUR	0.05
1148	MYERS	0.20
1149	EWINGSFORD	0.85
1150	HOSKINS LANE	0.55
1151	SPRING STREET	0.07

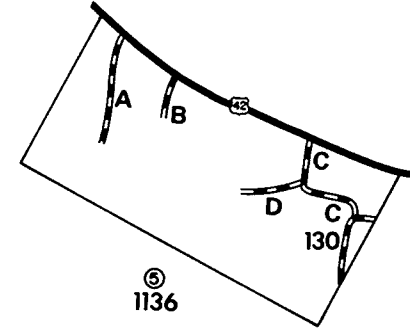

**III**

**QUADRANT I**

NO.	ROAD NAME	LGTH.
1001	WATSON LANE	0.90
1002	BEDFORD PIKE SPUR	0.10
1003	MILTON - BEDFORD PIKE	4.30
1004	SOUTH SPILLMAN LANE	1.40
1005	RICHMOND	1.25
1006	NORTH SPILLMAN LANE	1.40
1007	MITCHELL	0.45
1008	COGHILL	0.55
1009	MOSSER	0.75
1010	PURVIS LANE	0.05
1011	ABBOT LANE	2.15
1012	R. D. KENDEL	0.95
1013	MILLERS BRANCH	0.70
1014	ABBOT LANE CIRCLE	0.25
1015	LAKEWOOD LANE	0.25
1016	TROUT RIDGE	1.70
1017	EAST MCKINNEY	0.35
1018	MILES	0.55
1019	STREETS IN ENLARGEMENT NO. 1	
A	NORTH RIDGE DRIVE	0.33
B	NORTH GATE DRIVE	0.20
C	CENTER COURT	0.20
D	HILLCREST DRIVE	0.05
E	VALLEY VIEW DRIVE	0.15
F	TWIN RIDGE DRIVE	0.12
1020	GARRIOTT	0.80
1021	CEDARWOOD	0.40
1022	CULLS RIDGE	1.70
1023	RIDGETOP	0.30
1024	BUCKS RUN	0.35
1025	MCKINNEY LANE	0.05
1026	MCKINNEY FARMS	0.25
1027	MILLERS BRANCH SPUR	0.20
1028	CARLEY LANE	0.65

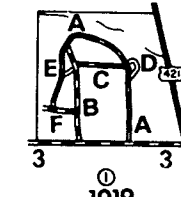

**I**

**QUADRANT III**

NO.	ROAD NAME	LGTH.
1200	FRYORS FORK	1.83
1201	BELL	0.55
1202	CONNORS RIDGE	0.60
1203	WATSON LANDING	0.35
1204	WENTWORTH	0.20
1205	OGDEN RIDGE	2.15
1206	SOUTH CAMPBELL	0.70
1207	HACKNEY LANE	1.66
1208	MCDOWELL	0.65
1209	HENSLEY	0.25
1210	PERKINSON LANE	1.35
1211	HARLEY LANE	0.95
1212	GILLS RIDGE	3.36
1213	BRAY RIDGE	3.44
1214	LOWER MIDDLE CREEK	1.20
1215	WISES LANDING	4.40
1216	MOUTH OF PATTONS CREEK	2.20
1217	KIDWELL PIKE	2.60
1218	PATTONS CREEK	3.30
1219	CORLEY	0.50
1220	CLAUDIE JONES	0.40
1221	RALSTON	0.20
1222	TOOMBS	0.35
1223	WISES LANDING SPUR	0.15
1224	DEANS	0.20
1225	HOWARD LEACH	0.25
1226	LITTREL	0.25

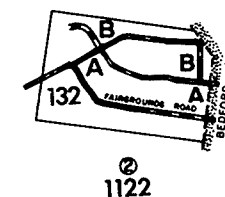

**II**



1131

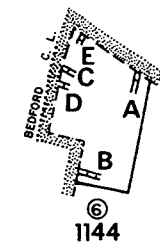

1144

DATE APPROVED BY FISCAL COURT 2-18-92

**1992  
COUNTY ROAD SERIES MAP  
TRIMBLE COUNTY  
KENTUCKY**

