

**KENTUCKY PUBLIC RIVERPORT CONSTRUCTION AND MAINTENANCE (KPRCM) APPLICATION**

**INSTRUCTIONS:** A guidance document is provided to assist in completing the application packet and may be accessed at <https://transportation.ky.gov/MultimodalFreight/Pages/KPRCM.aspx>  
See the guidance document for required attachments and acceptable methods of submittal.

**SECTION 1: APPLICANT INFORMATION**

<b>PUBLIC RIVERPORT NAME</b>		<b>TOTAL PROJECT COST</b>	<b>KPRCM FUND REQUEST</b>
Owensboro Riverport Authority		\$76,993.75	\$76,993.75
<b>STREET ADDRESS</b>	<b>CITY</b>	<b>STATE</b>	<b>ZIP</b>
1771 River Road	Owensboro	KY	42301
<b>CONTACT NAME &amp; TITLE</b>	<b>PHONE</b>	<b>EMAIL</b>	
Brian Wright, President/CEO	270-663-4034	bwright@owensbororiverport.com	

**SECTION 2: PROJECT DESCRIPTION**

<b>PROJECT TITLE</b>	<b>DURATION</b>
7-ton C-Hook/Rotator	6 months weeks

**FACILITIES AFFECTED BY THE PROPOSED PROJECT**

☒ Owned by Riverport Authority ☐ Leased to:

**Briefly describe how the project will improve public riverport facilities and infrastructure, to capture the economic and trade potential offered by water transportation.:** (Text limited for accurate printing. Attach additional pages as needed.)

As our business continues to grow we are experiencing an increased demand for operational efficiency. the 7-ton triple c-hook/rotator will be primarily used for handling rolled rod coils with our 875 material handler. This device is designed to handle (3) coils of steel rod with a material handler crane without the aid of workers inside the barge or on the dock. Currently, (2) workers are utilized inside the barge to attach a nylon sling to each coil and crane hook, once the coil is lifted onto the dock (1) worker must un-hook the nylon sling. With the Rotator, our material handler crane operator can position the C-Hook unit inside the barge to connect with (3) coils and place them directly on a haul truck without the aid of additional workers. The unloading and handling operation will be less dependent on hands-on labor.

**Select ONE:** ☐ Applicant plans to use their own manpower, equipment, or materials on the project (Force Account).  
☐ Applicant plans to competitively bid out all work related to the project.

TRAFFIC	CURRENT	AFTER PROJECT
Trucks per day	200-225	200-225
Train cars per week	50-60	50-60
Barges per week	11-12	11-12

**FOR KYTC USE ONLY**

<b>Date Received:</b> <b>Application Complete?</b> <input type="checkbox"/> Yes <input type="checkbox"/> No <b>Eligible Applicant?</b> <input type="checkbox"/> Yes <input type="checkbox"/> No <b>Permits Needed?</b> <input type="checkbox"/> Yes <input type="checkbox"/> No	<b>WTAB Approval</b> <input type="checkbox"/> Yes <input type="checkbox"/> No <b>Sec. Approval</b> <input type="checkbox"/> Yes <input type="checkbox"/> No <b>Award Amount:</b> _____ <b>Award Date:</b> _____	<b>Notification of Award:</b> _____ <b>MOA #:</b> _____ <b>Notice to Proceed:</b> _____
--	--	---

**KENTUCKY PUBLIC RIVERPORT CONSTRUCTION AND MAINTENANCE (KPRCM) APPLICATION****SECTION 3: PERMITS AND APPROVALS**

	YES	NO
Has the applicant consulted with state and federal agencies (US Army Corps of Engineers, US Coast Guard, US Fish & Wildlife Service, KY Division of Water, KY Heritage Council, etc.)?	<input type="checkbox"/>	<input type="checkbox"/>
Has state and federal agency consultation determined permits are needed?	<input type="checkbox"/>	<input type="checkbox"/>
Have all required permits (environmental, encroachment, etc.) been obtained?	<input type="checkbox"/>	<input type="checkbox"/>

**SECTION 4: SUBMISSION CHECKLIST** *(See guidance document for details.)*

- ☐ Kentucky Public Riverport Construction and Maintenance Application
- ☐ Statement of Work
- ☐ Scope of Work
- ☐ Purchase quote or cost estimate for the project
- ☐ Project Schedule/Timeline
- ☐ Maps, aerial photos, drawings, and photographs, as needed
- ☐ Engineering plans, schematics, details, drawings of the proposed project, as needed
- ☐ Copies of all correspondence or evidence of consultation that has occurred with state and federal agencies, if applicable
- ☐ Required Affidavit for Bidders, Offerors and Contractors from applicant

**SECTION 5: CERTIFICATION**

I have read the Kentucky Public Riverport Construction and Maintenance Project Guidance Document and understand and agree to abide by what is stated therein. I agree that incomplete applications, applications missing any of the above required supporting documents, or applications received after the deadline, will be deemed ineligible by Division staff without consideration for KPRCM funds and returned to applicant. I also hereby certify, subject to the provision of KRS 523.100 (unsworn falsification to authorities), that the above information is true and correct to the best of my knowledge.

PRINTED NAME & TITLE	SIGNATURE	DATE
Brian Wright President		2-6-25

Completed applications and all required attachments must be submitted electronically in PDF format. Paper copies will not be accepted. Emailed applications must be received by the Division by date indicated in call for projects. PDF copies shall be sent via email to: [KYTC.ModalPrograms@ky.gov](mailto:KYTC.ModalPrograms@ky.gov)



## KPRCM Application

Applicant Name: Owensboro Riverport Authority

Project Title: 7-ton C-Hook/Rotator

Date Submitted: February 14, 2025

*Experience. Performance. Excellence.*

1771 River Road ♦ P.O. Box 21955 ♦ Owensboro, KY ♦ 42304-1955

1 877 599-7929 ♦ (270) 926-4238 ♦ FAX (270) 683-3711

[www.OwensboroRiverport.com](http://www.OwensboroRiverport.com)



February 14, 2025

RE: 7-ton C-Hook/Rotator

Dear Sir or Madam:

As our business continues to grow, we are experiencing an increased demand for operational efficiency. To meet this demand Owensboro Riverport is seeking financial support to purchase a 7-ton C-Hook/Rotator to improve safety, efficiency and productivity. This equipment will significantly enhance our ability to handle rolled rod coils.

The 7-ton C-Hook/Rotator will reduce the time required to safely handle material. It will enable more precise and controlled movement of materials. ORA is applying for financial assistance from the Kentucky Public Riverport Construction and Maintenance Fund established in July 2024.

Your consideration of this project is critical to improving the port to meet current and future transportation needs.

Sincerely,

Brian Wright  
President/CEO

*Experience. Performance. Excellence.*

1771 River Road ♦ P.O. Box 21955 ♦ Owensboro, KY ♦ 42304-1955

1 877 599-7929 ♦ (270) 926-4238 ♦ FAX (270) 683-3711

[www.OwensboroRiverport.com](http://www.OwensboroRiverport.com)



## Statement of Work

The Owensboro Riverport Authority is seeking KPRCM funds for a purchase of 7-ton c-hook/rotator for Terminal operations.

This device is designed to handle (3) coils of steel rod with a material handler crane without the aid of workers inside the barge or on the dock. Currently, (2) workers are utilized inside the barge to attach a nylon sling to each coil and crane hook, once the coil is lifted onto the dock (1) worker must un-hook the nylon sling. With the Rotator, our material handler crane operator can position the C-Hook unit inside the barge to connect with (3) coils and place them directly on a haul truck without the aid of additional workers. The unloading and handling operation will be less dependent on hands-on labor.

## Scope of Work

ORA will put out for bid the 7-ton c-hook/rotator and once bids are received and reviewed ORA will proceed with project.

*Experience. Performance. Excellence.*

1771 River Road ♦ P.O. Box 21955 ♦ Owensboro, KY ♦ 42304-1955

1 877 599-7929 ♦ (270) 926-4238 ♦ FAX (270) 683-3711

[www.OwensboroRiverport.com](http://www.OwensboroRiverport.com)



## Project Schedule and Timeline

### 7-ton C-Hook/Rotator

April - May 2025– Issue RFP

July – Award Bid

November 2025 – Receive 7-ton c-hook/rotator

*Experience. Performance. Excellence.*

1771 River Road ♦ P.O. Box 21955 ♦ Owensboro, KY ♦ 42304-1955

1 877 599-7929 ♦ (270) 926-4238 ♦ FAX (270) 683-3711

[www.OwensboroRiverport.com](http://www.OwensboroRiverport.com)



## Budget Summary

### 7-ton C-Hook/Rotator

7-ton C-Hook/Rotator - \$76,993.75

*Experience. Performance. Excellence.*

1771 River Road ♦ P.O. Box 21955 ♦ Owensboro, KY ♦ 42304-1955

1 877 599-7929 ♦ (270) 926-4238 ♦ FAX (270) 683-3711

[www.OwensboroRiverport.com](http://www.OwensboroRiverport.com)



Copies of correspondence or consultation with state and federal agencies:

Not Applicable

*Experience. Performance. Excellence.*

1771 River Road ♦ P.O. Box 21955 ♦ Owensboro, KY ♦ 42304-1955

1 877 599-7929 ♦ (270) 926-4238 ♦ FAX (270) 683-3711

[www.OwensboroRiverport.com](http://www.OwensboroRiverport.com)





Brandeis Machinery & Supply Company  
17000 Highway 41 N  
Evansville IN 47725  
Phone 270-210-2397  
www.brandeismachinery.com

Construction, Mining, & Forestry Equipment Sales, Parts, Service and **Certified Rental®**

---

1/27/2025

Quote #: mbryan-1545

OWENSBORO RIVERPORT AUTHORITY  
1771 RIVER ROAD  
OWENSBORO, KY 42303

Dear David Hicks,

Brandeis Machinery & Supply Company appreciates the opportunity to submit the following quotation for your review. As an established supplier of construction, mining, forestry and material handling equipment, we take this opportunity very seriously. We believe we can accomplish our mutual objectives of bringing economics and cost reduction to your organization. Every effort has been made to include the specifications needed for your application, however, we encourage a close review and dialogue to assure you are satisfied this machine meets your needs.

### **Winkle - 7 Ton Capacity Rotating Triple C-Hook w/ Quick Coupler Yoke**

7 Ton Triple C-Hook

DR200 Rotator with 360 Continuous Rotation

300 Series Quick Coupler Yoke and Pin for Sennebogen 875

**Sale Price FOB: Owensboro, KY**

**\$76,993.75**

**Net Selling Price:** (plus any applicable taxes, UCC1 & Doc Fees)

**\$76,993.75**

---

*NOTE: No price, terms or descriptions in this proposal shall supersede any published terms and conditions of a fully executed Purchase Contract. Terms of sales are subject to credit approval and subject to prior sale.*

*Thank you for the opportunity to submit this proposal, which will remain valid for 30 days. Price is subject to availability and does not include applicable taxes. Should you have any questions, please feel free to contact us. We look forward to earning your business!*

Respectfully,

***Matt Bryan***

Sales Representative  
270-210-2397

2	REV	1	By	Date	Checked	Approved
1	REVISION					
1	ISSUED FOR PROPOSAL					
1	DATE					
1	BY					
1	CHECKED					
1	APPROVED					

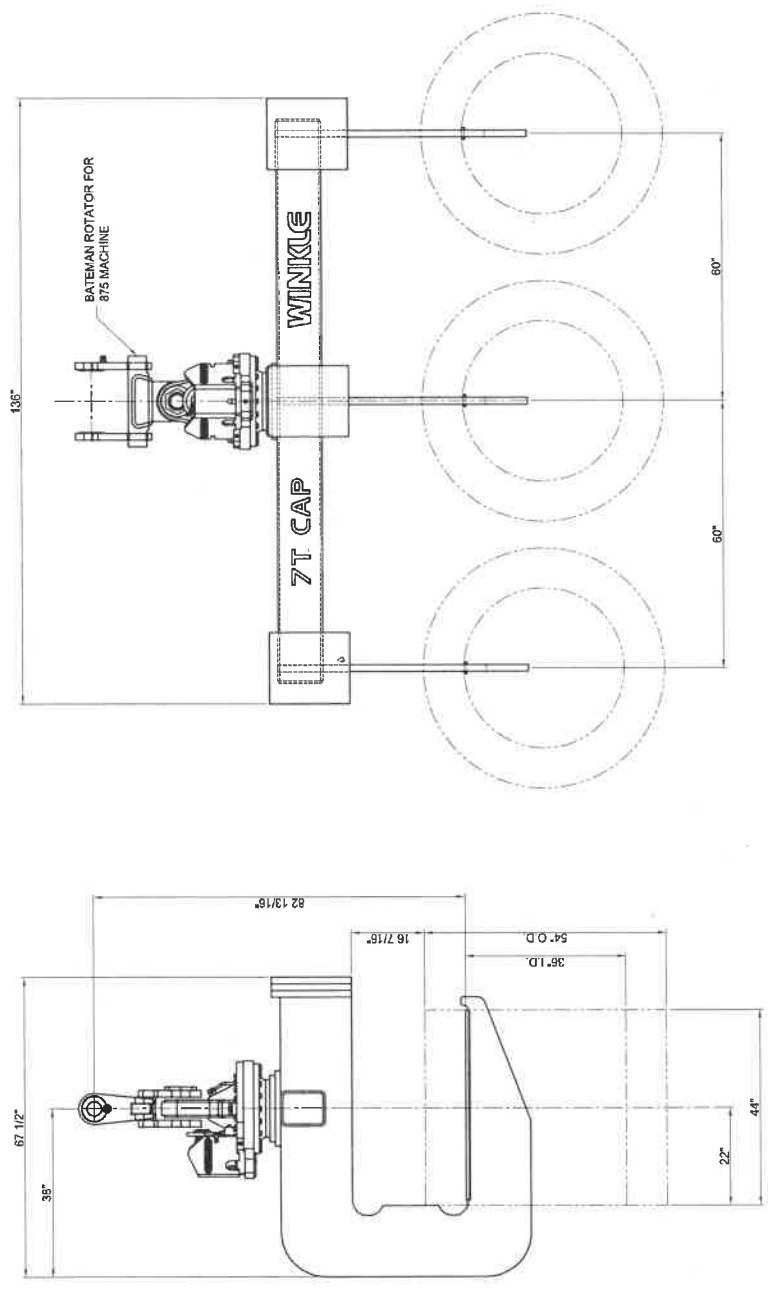

7 TON CAPACITY C-HOOK BEAM  
 EST. FIN. WT. = 5,350 LBS.  
 SPECIFICATIONS:  
 DESIGN CAPACITY: 14,000 LBS.  
 4,690 LBS. EACH HOOK  
 DESIGN CODE:  
 ASME BTH-12017, DESIGN CATEGORY B,  
 SERVICE CLASS 1

NOTE: DIMENSIONS ARE  
 REFERENCE ONLY AND MAY  
 CHANGE AT FINAL DESIGN.

<b>WINKLE</b> 7 TON CAPACITY C-HOOK BEAM PROPOSAL G.A.		PROJECT NO. PMD1566 DATE: 02/22/23	
BRAMCO 7 TON CAPACITY C-HOOK BEAM PROPOSAL G.A.		PROJECT NO. PMD1566 DATE: 02/22/23	
WINKLE JOB NO. PMD1566		PROJECT NO. PMD1566 DATE: 02/22/23	
DO NOT SCALE DRAWING		SCALE: 1" = 1'-0"	
THIS DRAWING IS THE PROPERTY OF WINKLE AND SHALL NOT BE REPRODUCED OR USED IN ANY MANNER WITHOUT THE WRITTEN AUTHORIZATION OF WINKLE AND PARTNERS		THIS DRAWING IS THE PROPERTY OF WINKLE AND SHALL NOT BE REPRODUCED OR USED IN ANY MANNER WITHOUT THE WRITTEN AUTHORIZATION OF WINKLE AND PARTNERS	

## 4.0 Assembly:

- 4.1 The C-Hook beam is completely shop assembled.
- 4.2 Blast to SSPC6 and one (1) coat of safety yellow finish paint provided.

## 5.0 Hydraulic Rotator

- 5.1 Rotation max flow – 8-10 gpm
- 5.2 Rotation at max flow – 15 rpm
- 5.3 Rotation max pressure – 1450 psi

## 6.0 Inspection:

- 6.1 All materials used in construction of the C-Hook beam are purchased by Winkle with material certifications.
- 6.2 All partial penetration welds will be magnetic particle inspected.

## 7.0 Work by Others:

- 7.1 Receive and unload at the job site.
- 7.2 Load test the lifter per ASME B30.20-2018, section 20-1.3.8.2 or per customer internal load test specifications.
- 7.3 Field start-up, minor adjustments, inspections, and preventative maintenance.

# Technical Specification



**Customer:** Bramco

**Job #:** PMD1566

**Description:** 7 Ton Capacity Rotating C-Hook Beam

**By:** Gregory Hagge

**Date:** February 22, 2023

## 1.0 General:

- 1.1 We propose to manufacture, shop assemble and ready for shipment, one (1) 7-Ton Capacity Rotating C-Hook Beam.
- 1.2 The proposed C-Hook will be per this Technical Specification and reference drawing PMD1566-PROPOSAL-S1-RA.
- 1.3 The live load is 14,000 lbs.
- 1.4 The approximate weight of the C-hook is 5,350 lbs.
- 1.5 Changes relative to this Technical Specification are subject for review.

## 2.0 Design Criteria:

- 2.1 ASME BTH-1-2017, Design Category B, Service Class 3 used as the design specification. Service class 3 is defined as 500,001-2,000,000 load cycles.
- 2.2 ASME B30.20-2018 used as the safety standard.
- 2.3 Temperature: 25 to 150 degrees Fahrenheit.
- 2.4 Estimated Coil product:
  - 1. 44" max. length
  - 2. 54" max O.D.
  - 3. 36" min I.D.

## 3.0 Features:

- 3.1 The C-Hook plate members consist of ASTM A572 steel plate, welded construction.
- 3.2 The single beam will contain three (3) C-hooks spaced at 60" apart to engage three coils at the same time.
- 3.3 The C-Hooks will be counterweighted to hang level while suspended without a load present.
- 3.4 The C-Hook saddles will possess a curved profile to engage with the I.D. of the coil.
- 3.5 The bail will be a Bateman hydraulic DR160 dangling rotator (37.1T capacity) with a 200 series quick coupler yoke and pin, or similar to match a Sennebogen 875 machine.
- 3.6 All welding will be performed in accordance with AWS D14.1 using AWS certified welders.
- 3.7 Capacity letters will be permanently welded to the lifter.
- 3.8 Stainless steel ID plate showing specifications will be mounted to the lifter.
- 3.9 Operation and maintenance manual included.

*Your end-to-end material handling solutions provider*

2080 West Main Street, Alliance, Ohio 44601  
Tel: 330-823-9730 Fax: 330-823-9788  
[www.winkleindustries.com](http://www.winkleindustries.com)



**Required Affidavit for Bidders, Offerors  
and Contractors**  
(KRS 45A.110 & 45A.115)

**Affidavit Effective for One (1) Year from Date of Execution**

**Instructions:** Pursuant to KRS 45A.110 and 45A.115, a bidder, offeror, or contractor ("Contractor") is required to submit a Required Affidavit for Bidders, Offerors, and Contractors to be awarded a contract, or for the renewal of a contract. An authorized representative of the contracting party must complete the attestation below, have the attestation notarized, and return the completed affidavit to the Commonwealth.

**Attestation**

As a duly authorized representative for the Contractor, I swear and affirm under penalty of perjury, that that the Contractor has not knowingly violated campaign finance laws of the Commonwealth of Kentucky and that the award of a contract will not violate any provision of the campaign finance laws of the Commonwealth. For purposes of this attestation, "Knowingly" means that the bidder or offeror is aware or should have been aware of the existence of a violation. The bidder or offer understands that the Commonwealth retains the right to request an updated affidavit at any time.

Brian Wright  
Signature

Brian Wright  
Printed Name

President / CEO  
Title

February 6, 2025  
Date

Bidder or Offeror Name:

Owensboro Riverport Authority

Address:

1771 River Road

Owensboro, KY 42301

Commonwealth of Kentucky Vendor Code (If known): \_\_\_\_\_

Subscribed and sworn to before me this 6 day of February, 2025.

State of: Kentucky

Notary: Carol Wright KYNP 70213

County of: Daviess

My Commission Expires: May 21, 2027