



KENTUCKY INDUSTRIAL ACCESS AND SAFETY IMPROVEMENT (KIASI) PROJECT APPLICATION

SECTION 1: PROJECT OVERVIEW

PROJECT TITLE

Stainless Steel Midwest Rail Turnout

APPLICANT LEGAL NAME

Stainless Steel Acquisition Co., LLC dba Stainless Steel Midwest, LLC

APPLICATION YEAR

2025

APPLICANT TYPE

Rail Served Industry

COUNTIES IMPACTED BY THE PROJECT

Oldham

PROJECT PHYSICAL ADDRESS

2615 E. Highway 146 La Grange, KY 40031

RAILROAD(S) SERVING THE SITE

CSX

ENTITY OWNING PROJECT SITE (if different from applicant)

Sabbae Holding, LLC

TOTAL PROJECT COST

\$ 2,000,000

KIASI FUNDING REQUESTED

\$ 1,000,000

APPLICANT MATCH

\$ 1,000,000

**APPLICANT MATCH %
(50% Minimum)**

50 %

Will the proposed project be matching awarded federal funds? NO YES

Does applicant plan to use their own manpower, equipment, or materials on the project (Force Account) or competitively bid out all work related to the project? Bid Out

DESCRIPTION OF PROPOSED PROJECT (Provide a brief project description and the proposed work to be completed. Text is limited to the space provided below.)

Stainless Steel Midwest turnout of rail to bring rail across State Highway 146 to maximize rail delivery onto Stainless Steel Midwest's property

DESCRIPTION OF HOW PROJECT WOULD PROVIDE KENTUCKY COMMUNITIES AND INDUSTRIES WITH TRANSPORTATION OPTIONS, CONNECTIVITY AND OPPORTUNITIES (Text is limited to the space provided below.)

The project will result in expansion of business, increased labor force, improvements to Highway 146, tree planting with improved aesthetics and updated rail to CSX standards.

DESCRIPTION OF HOW PROJECT WOULD ENHANCE RAIL LINE CORRIDORS TO INCREASE ON-TIME PERFORMANCE (Text is limited to the space provided below.)

The project would enhance the rail line corridor with new rail, ties and a crossing that meets CSX standards thereby increasing on-time performance for rail road service. Further, direct rail access for Stainless Steel Midwest will eliminate the need to truck material across HWY 146 and provide new service rail to eliminate storage at the CSX Obannon service yard.

DESCRIPTION OF HOW PROJECT WOULD IMPROVE RAIL SERVICES TO EXISTING INDUSTRIES AND ENCOURAGE INVESTMENT IN THE COMMONWEALTH (Text is limited to the space provided below.)

The new lines and rail turnout would improve rail access for existing businesses. Further, this project will encourage investment by allowing for future expansion of rail line access for undeveloped land north of HWY 146.



KENTUCKY INDUSTRIAL ACCESS AND SAFETY IMPROVEMENT (KIASI) PROJECT APPLICATION

SECTION 1: PROJECT OVERVIEW (CONTINUED)

DESCRIPTION OF PROPOSED PROJECT READINESS, OR HOW SOON AFTER AWARD CAN CONSTRUCTION BEGIN AND HOW LONG WILL THE PROJECT TAKE TO COMPLETE *(Text is limited to the space provided below.)*

The project is ready to move forward upon approval by the State. The project is expected to be completed within 6 - 7 months.

SECTION 2: CONTACT INFORMATION

APPLICATION PRIMARY CONTACT NAME & TITLE	PHONE	EMAIL		
Tim Cunagin, Project Manager	502-594-4890	ncunagin@ssmw.us		
MAILING ADDRESS	CITY		STATE	ZIP
2615 E. Highway 146	La Grange		KY	40031

If awarded, will signatory be different from the Primary Contact? NO YES *(Provide signatory information.)*

AGREEMENT SIGNATORY NAME & TITLE	PHONE	EMAIL		
Richard Jones, Chief Operating Officer	502-805-1120	rjones@ssmw.us		
MAILING ADDRESS	CITY		STATE	ZIP
2615 E. Highway 146	La Grange		KY	40031

If awarded, will Project Manager be different from the Primary Contact? NO YES *(Provide information.)*

PROJECT MANAGER NAME & TITLE	PHONE	EMAIL		
Tim Cunagin, Project Manager	502-594-4890	ncunagin@ssmw.us		

SECTION 3: PROPOSED PROJECT PERMITS/APPROVALS/READINESS

A. Have consultations with state or federal agencies (US Army Corps of Engineers, US Coast Guard, US Fish and Wildlife Service, Kentucky Division of Water, Kentucky Heritage Council, or others) determined the need for permits? Yes

B. Have all required permits been obtained? In Progress

C. Will the proposed project have ANY impacts on a public road (City, County, State, US)? NO YES

D. Have all necessary roadway authorities been notified about the proposed project? YES NO N/A

E. Has preliminary engineering been completed for the proposed project? YES NO N/A

What engineering still needs to be done and when will it be completed? All complete

SECTION 4: ECONOMIC DEVELOPMENT INFORMATION

A. If the project will provide new and/or increased service to an industrial park:

Total acres of the industrial park	Total amount of developable acres	Acres that may be served by project
27	700	20.9



KENTUCKY INDUSTRIAL ACCESS AND SAFETY IMPROVEMENT (KIASI) PROJECT APPLICATION

SECTION 4: ECONOMIC DEVELOPMENT INFORMATION (CONTINUED)

B. Utility infrastructure in place to the site to be served by the project:

- Electric Natural Gas Water Wastewater Fiber/telecom

C. Provide listing of the names of existing companies currently served/to be served by the project along with the number of existing full-time jobs, potential new full-time jobs to be created, and potential capital investment to be incurred for each company.

	COMPANY NAME	FULL TIME JOBS		CAPITAL
		CURRENT	POTENTIAL	INVESTMENT
1	Stainless Steel Acquisition Co., LLC dba Stainless Steel Midwest,	50	10	\$2,000,000
2				\$
3				\$
4				\$
5				\$
6				\$
7				\$
8				\$
9				\$
10				\$

D. Are there any companies considering location or expansion of a potential project on the site to be served?

- YES NO N/A

If YES, provide details of the potential project for each company (e.g., potential new full-time jobs to be created and potential capital investment to be incurred).

SECTION 5: SUBMISSION CHECKLIST (See KIASI Guidance Document, Section VI, for details.)

- Kentucky Industrial Access and Safety Improvement (KIASI) Project Application (TC 59-115)
- Statement of Work
- Scope of Work
- Project Schedule/Timeline
- Diagrams/maps depicting proposed project
- Rail Connectivity Letter (as applicable)
- Detailed engineering assessment report (as applicable)
- Aerial Photographs and photographic documentation of crossing location and condition
- Plans, schematics, details, drawings of the proposed project (as applicable)
- For equipment purchases, a price quote on letterhead from vendor OR for construction projects, a detailed estimate for the project
- * Road authority consultation letters (as applicable)
- * Public Interest Finding (as applicable)
- * Required Annual Affidavit for Bidders, Offerors and Contractors from applicant.

* In progress



KENTUCKY INDUSTRIAL ACCESS AND SAFETY IMPROVEMENT (KIASI) PROJECT APPLICATION

SECTION 6: KENTUCKY RAILROAD ANNUAL REPORT COMPLIANCE (Required **ONLY** if applicant is a railroad.)

I hereby certify that as an applicant defined as a railroad in 603 KAR 7:090(1), my company has completed and submitted TC 59-102, *Kentucky Railroad Annual Report*, in compliance with the provisions of 603 KAR 7:090 at the time of this application to be considered an eligible applicant. If it is determined I am not an eligible applicant at the time of this submission, I agree that this application shall be immediately rejected without consideration and returned to me without review.

PRINTED NAME AND TITLE	SIGNATURE	DATE

SECTION 7: BUSINESS STANDING CERTIFICATION

I hereby certify that the applicant is a business entity in good standing with the Office of the Kentucky Secretary of State or under the laws of the jurisdiction(s) in which the entity is organized or authorized to conduct business and is not delinquent in taxes owed to any taxing entity. Applicants not in good standing or delinquent in taxes are subject to this application immediately being rejected without consideration and returned to me without further review.

PRINTED NAME AND TITLE	SIGNATURE	DATE
Richard Jones, Chief Operating Officer		3/7/25

SECTION 8: APPLICANT CERTIFICATION

I have read the Kentucky Industrial Access and Safety Improvement (KIASI) Projects guidance document, and I understand and agree to abide by what is stated therein. I also hereby certify, subject to the provisions of KRS 523.100 (unsworn falsification to authorities), that the above information is true and correct to the best of my knowledge.

PRINTED NAME AND TITLE	SIGNATURE	DATE
Tim Cunagin, Project Manager		3-7-25

Submission Directions: Applicants must combine their completed application and all required attachments into a single PDF and submit it electronically via email to address provided in call for projects. It is the responsibility of the applicant to ensure delivery of the emailed submission.

Stainless Steel Midwest, LLC

Statement of Work for SSMW Rail Turnout

03/07/2025

The purpose of the Stainless Steel Midwest Rail Turnout project is to extend rail from one side of State Highway 146 to the other (north) side. Currently we use our neighbor's rail service line across the highway to unload railroad cars and then truck to Stainless Steel Midwest . It is far more effective and efficient to extend the rail service line onto Stainless Steel Midwest's property to directly manage the unloading of railcars.

A benefit of the project includes reducing the carbon footprint by substituting trucks on the road for railcars. Also, we will be refurbishing the rail on our neighbor's service line across the highway and bring it up to 2025 CSX specs. Finally, we will have the ability to branch off our rail on the north side of the highway for any expansion and development for other industries. Stainless Steel Midwest's adjacent property owner has requested that our plans include access for such an expansion.

Stainless Steel Midwest, LLC
Scope of Work for SSMW Rail Turnout
3/7/2025

Work to be performed	Estimated quantities of materials involved	Type of work
Clear property and excavate	4500 tons of rock, excavate 5300 cubic yards of dirt, cut and fill 2100 cubic yards of dirt, 3200 cubic yds for use on site	Clear trees and rock, use excavators to dig Install pipe and headwalls, erosion control Sub ballast installed
Install ties and rail	151 tons of rail (entirety of project) 227 tons of asphalt (entirety of project)	Installation of ties and rail. Contractor to install with CSX gauge standards
Install Highway 146 signal	2 - rail signal with gates	Railroad signal & gate to be installed per state standard
Excavate and place Hwy 146 crossing	1 - Concrete block crossing	Close highway 146, excavate roadway install concrete crossing, repave to state standard
Resurface and reconfigure Hwy 146	227 tons of new asphalt for highway 146	Resurfacing and reconfiguring highway 146
Reconfigure south side of track	1 - switch 151 tons of rail (entirety of project) 1900 ties (entirety of project)	Remove old track and ties, install new ties and rail to CSX standards



P.O. Box 391
 Scottsburg, IN 47170
 PH. 812-752-6884
 Fax 812-967-6341

Quotation

Date	Quote #
2/19/25	2025001

Bill To
Associated Railroad Contractors, Inc 4050 Tower Road Louisville, KY 40219

Description	Qty	Unit	P.O. No.	Terms
			Rate	Net 30 Amount
Stainless Steel Midwest				
Excavation: including topsoil, compacted fill, & stockpiling excess material	1.0	LS	\$222,395.00	\$222,395.00
Clearing	5.0	AC	\$9,000.00	\$45,000.00
Pipe & Headwalls- (42lf of 42" RCP & 40lf of 18" HDPE pipe)	1.0	LS	\$36,200.00	\$36,200.00
Erosion Control & revegetation	1.0	LS	\$24,500.00	\$24,500.00
Subballast	1,388.0	TN	\$45.00	\$62,460.00
Thank you, we appreciate your business!				\$390,555.00

#	Description	Qty	Unit	Material	Install	Unit Price	Total
5	Pipe - 42" RCP	42	LF	\$ 180.13	\$ 163.82	\$ 343.95	\$ 14,445.90
	Pipe - 42" RCP	48	LF	\$ 125.58		\$ 125.58	\$ 6,027.84
	Remove - 24" CMP	42	LF	\$ 24.00		\$ 24.00	\$ 1,008.00
	Spoil Removal	23	CY	\$ 10.00		\$ 10.00	\$ 230.00
	#8 Stone	36.8	TN	\$ 28.62		\$ 28.62	\$ 1,053.22
6	Pipe - 18" N-12	40	LS	\$ 35.48	\$ 55.00	\$ 90.48	\$ 3,619.00
	Pipe - 18" N-12	40	LF	\$ 19.04		\$ 19.04	\$ 761.60
	#8 Stone	23	TN	\$ 28.62		\$ 28.62	\$ 658.26
7	42" Staight Headwall	2	EA	\$2,209.72	\$ 3,471.21	\$ 5,680.93	\$ 11,361.86
	Headwall	2	ea	\$2,123.86		\$ 2,123.86	\$ 4,247.72
	Bedding	6	tn	\$ 28.62		\$ 28.62	\$ 171.72
8	18" Straight Headwall	4	EA	\$ 797.77	\$ 895.54	\$ 1,693.31	\$ 6,773.24
	Headwall	4	ea	\$ 754.84		\$ 754.84	\$ 3,019.36
	Bedding	6	tn	\$ 28.62		\$ 28.62	\$ 171.72

Pipe - 42" RCP	42 LF	\$ 180.13	\$ 163.82	\$ 343.95	\$ 14,445.90
Pipe - 18" N-12	40 LS	\$ 35.48	\$ 55.00	\$ 90.48	\$ 3,619.00
42" Staight Headwall	2 EA	\$2,209.72	\$ 3,471.21	\$ 5,680.93	\$ 11,361.86
18" Straight Headwall	4 EA	\$ 797.77	\$ 895.54	\$ 1,693.31	\$ 6,773.24
					\$ 36,200.00

PROPOSAL

**P
A
R
I
N
G**
RIVERSIDE and Contracting Company, Inc.
 263 EILER AVE. • LOUISVILLE, KENTUCKY 40214 • 502- 368-4484

JEFF DELANEY

PROPOSAL SUBMITTED ASSOCIATED RAILROAD CONTRACTORS INC.	PHONE/FAX 502-966-9781	DATE JULY 1 2024
STREET P.O. BOX 19246	JOB NAME RR CROSSING – STAINLESS STEEL MIDWEST	
CITY, STATE AND ZIP CODE LOUISVILLE, KENTUCKY 40259	JOB LOCATION KY 146 - OPTION 1.	

We propose to furnish all equipment, labor and materials necessary to perform the following scope of work:

ADDITIONAL PAVING PROJECT: 2,860 SFT / 318 SYD & 2,420 SFT / 269 SYD

ALL TRAFFIC CONTROL, TRACK PREP, TRACK PLACEMENT BY ASSOC. RR
 MILL 2.0" OF EXISTING PAVEMENTS TO DEPTH, HAUL OFF SITE ALL SPOILS
 CLEAN, MILL KEY EDGE AT ALL JOINTS AS NEEDED FOR PAVING
 TACK COAT SS-1H, AREA OF RE PAVING
 2.0" SURFACE ASPHALT ROLLED & COMPACTED OVER 318 SYD
 REMOVE PAVEMENTS FOR NEW GRADES PER PLANS OVER 269 SYD
 INSTALL D.G.A. STONE, BASE ASPHALT, SURFACE ASPHALT TO GRADE ON PLANS OVER 269 SYD
 JOINT SEAL ALL ASPHALT EDGES AFTER PAVING IS COMPLETED ALL MATERIALS USED ARE KDOT
 APPROVED.

OPTION 1. 65,210.00

Riverside Paving & Contracting Co., Inc. agrees to provide and furnish the necessary materials, equipment and labor, in the manner described above, and to perform such work in a workmanlike manner and as expeditiously as working schedule and weather permit. Out work is guaranteed for one year against workmanship and materials. Payment is due and payable upon completion of the work, unless otherwise herein provided:
 TERMS: NET 30 DAYS OF COMPLETION

Customer hereby agrees to make payment of the contract price and any additions that may be made thereto upon completion of the work by Riverside Paving & Contracting Co., Inc. unless otherwise specifically provided for at the time of the execution of this contract. **Riverside Paving & Contracting Co., Inc.** cannot guarantee against "reflective cracking" on overlays or resurfacing projects. Existing cracks cannot be guaranteed not to reappear at a later date, after overlaying or resurfacing. **Riverside Paving & Contracting Co., Inc.** must have 1" of fall per 10'-0" to achieve proper drainage on any project. The contractor and/or owner must accept responsibility if the grade is not equal to or better than that stated above. **The following quote is based on THE CURRENT PRICE OF LIQUID ASPHALT, PLUS sales tax. Due to the unstable market for PETROLEUM products RIVERSIDE PAVING reserve the right to ADJUST OUR PRICE TO REFLECT INCREASE IN THE COST OF LIQUID ASPHALT & FUEL, AT THE TIME ASPHALT MIX IS LAID.**

Acceptance of Proposal

It is agreed that the contract price for the above work to be performed by Riverside Paving & Contracting Co., Inc. is _____

This proposal shall become a contract, binding upon both parties, upon the signing of the same by the parties hereto.

Signed Riverside Paving & Contracting Co., Inc.

Signed _____
Customer

By DONNIE MANFORD, II SR. ESTIMATOR_

Date _____

Date: JULY 1 2024

PROPOSAL

P
A
I
N
G

RIVERSIDE and Contracting Company, Inc.

263 EILER AVE. • LOUISVILLE, KENTUCKY 40214 • 502- 368-4484

JEFF DELANEY

PROPOSAL SUBMITTED ASSOCIATED RAILROAD CONTRACTORS INC.	PHONE/FAX 502-966-9781	DATE JULY 1 2024
STREET P.O. BOX 19246	JOB NAME RR CROSSING – STAINLESS STEEL MIDWEST	
CITY, STATE AND ZIP CODE LOUISVILLE, KENTUCKY 40259	JOB LOCATION KY 146 - OPTION 2.	

We propose to furnish all equipment, labor and materials necessary to perform the following scope of work:

ADDITIONAL PAVING PROJECT: 1,320 SFT / 148 SYD & 4,620 SFT / 513 SYD

ALL TRAFFIC CONTROL, TRACK PREP, TRACK PLACEMENT BY ASSOC. RR
MILL 2.0" OF EXISTING PAVEMENTS TO DEPTH, HAUL OFF SITE ALL SPOILS
CLEAN, MILL KEY EDGE AT ALL JOINTS AS NEEDED FOR PAVING
TACK COAT SS-1H, AREA OF RE PAVING
2.0" SURFACE ASPHALT ROLLED & COMPACTED OVER 148 SYD
REMOVE PAVEMENTS FOR NEW GRADES PER PLANS OVER 513 SYD
INSTALL D.G.A. STONE, BASE ASPHALT, SURFACE ASPHALT TO GRADE ON PLANS OVER 513 SYD
JOINT SEAL ALL ASPHALT EDGES AFTER PAVING IS COMPLETED ALL MATERIALS USED ARE KDOT
APPROVED.

OPTION 2. 82,790.00

Riverside Paving & Contracting Co., Inc. agrees to provide and furnish the necessary materials, equipment and labor, in the manner described above, and to perform such work in a workmanlike manner and as expeditiously as working schedule and weather permit. Out work is guaranteed for one year against workmanship and materials. Payment is due and payable upon completion of the work, unless otherwise herein provided:
TERMS: NET 30 DAYS OF COMPLETION

Customer hereby agrees to make payment of the contract price and any additions that may be made thereto upon completion of the work by Riverside Paving & Contracting Co., Inc. unless otherwise specifically provided for at the time of the execution of this contract. Riverside Paving & Contracting Co., Inc. cannot guarantee against "reflective cracking" on overlays or resurfacing projects. Existing cracks cannot be guaranteed not to reappear at a later date, after overlaying or resurfacing. Riverside Paving & Contracting Co., Inc. must have 1" of fall per 10'-0" to achieve proper drainage on any project. The contractor and/or owner must accept responsibility if the grade is not equal to or better than that stated above. **The following quote is based on THE CURRENT PRICE OF LIQUID ASPHALT, PLUS sales tax. Due to the unstable market for PETROLEUM products RIVERSIDE PAVING reserve the right to ADJUST OUR PRICE TO REFLECT INCREASE IN THE COST OF LIQUID ASPHALT & FUEL, AT THE TIME ASPHALT MIX IS LAID.**

Acceptance of Proposal

It is agreed that the contract price for the above work to be performed by Riverside Paving & Contracting Co., Inc. is _____

This proposal shall become a contract, binding upon both parties, upon the signing of the same by the parties hereto.

Signed Riverside Paving & Contracting Co., Inc.

Signed _____
Customer

By DONNIE MANFORD, II SR. ESTIMATOR_

Date _____

Date: JULY 1 2024

CONSTRUCTION PLANS for STAINLESS STEEL MIDWEST RAIL SPURS

INDEX		
DRAWING	SHEET #	SHEET DESCRIPTION
CIVIL		
C-1	1	COVER SHEET / OVERALL LAYOUT
C-2	2	TRACK LAYOUT / GRADING PLAN
C-3	3	TRACK PROFILES
C-4	4	KY-146 CROSSING PLAN AND PROFILE

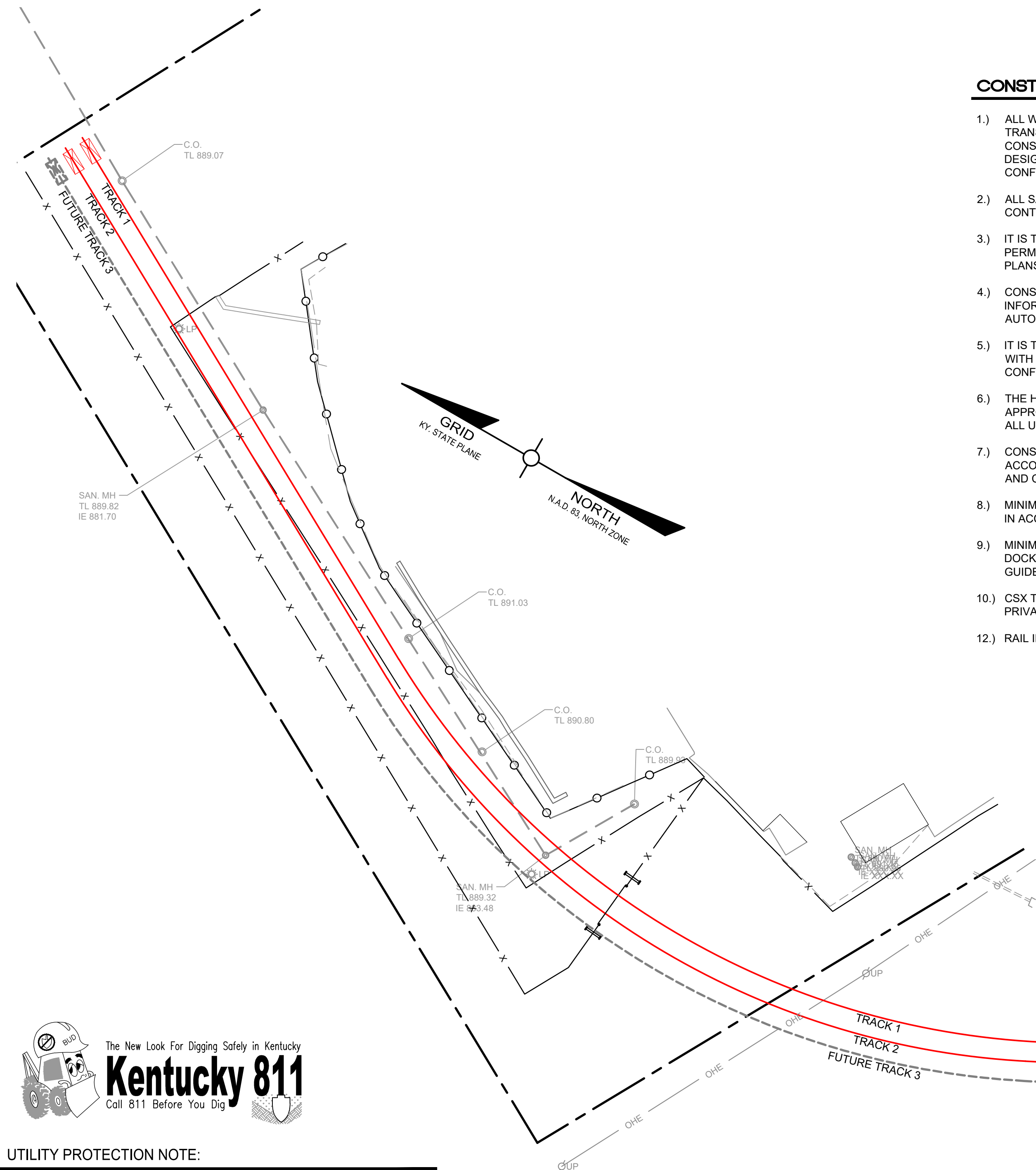
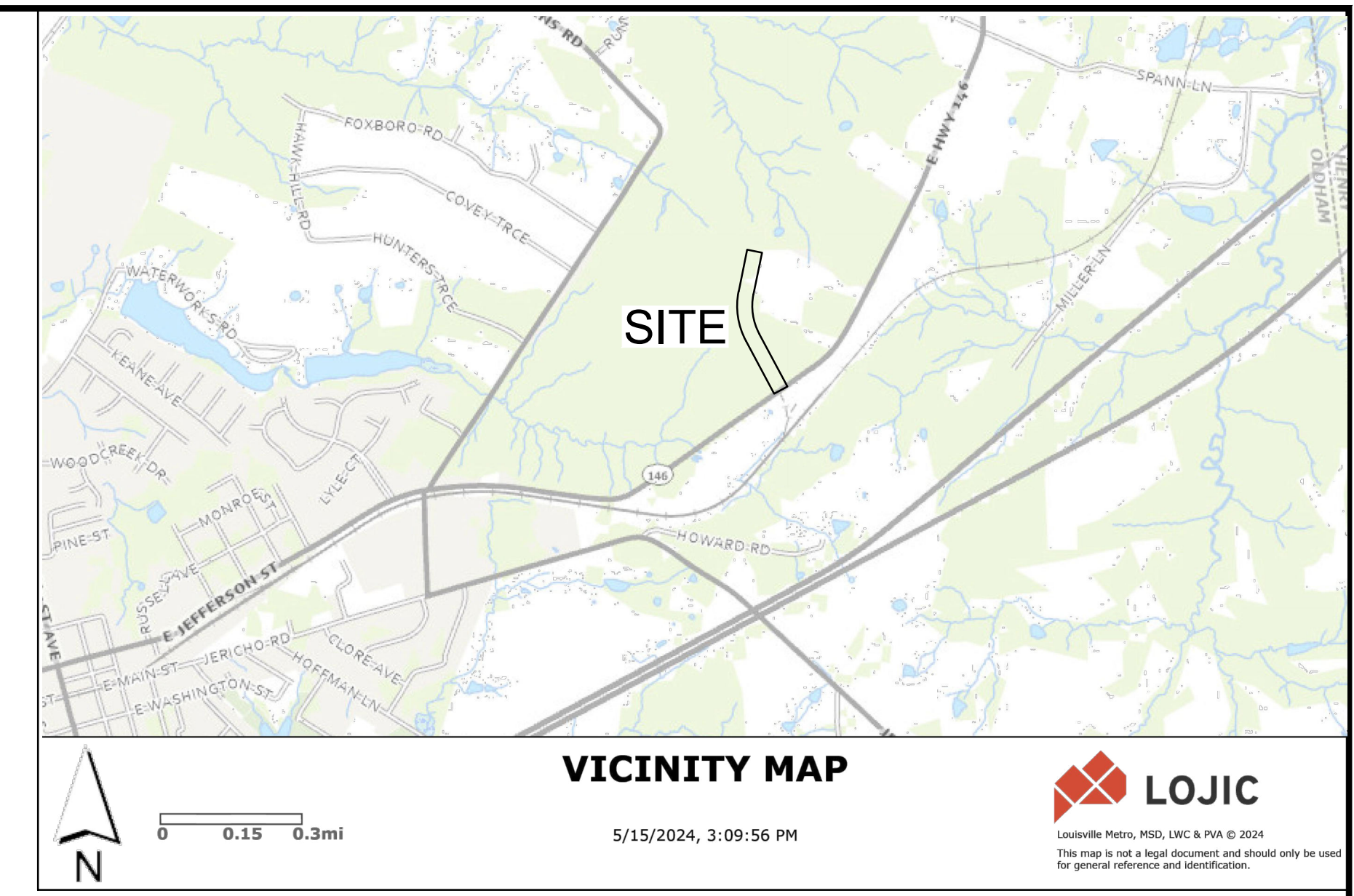

CONSTRUCTION NOTES:

- 1.) ALL WORK PERFORMED ON THIS PROJECT SHALL CONFORM TO THE KENTUCKY TRANSPORTATION CABINET'S "STANDARD SPECIFICATIONS FOR ROAD AND BRIDGE CONSTRUCTION" AND THE CSX TRANSPORTATION'S STANDARD SPECIFICATIONS FOR DESIGN AND CONSTRUCTION OF PRIVATE SIDETRACKS, LATEST EDITIONS. IN CASE OF CONFLICT, THE MOST STRINGENT STANDARD SHALL APPLY.
- 2.) ALL SAFETY STANDARDS AND REQUIREMENTS SHALL BE THE RESPONSIBILITY OF THE CONTRACTOR, AND COMPLIED WITH AS SET FORTH BY OSHA.
- 3.) IT IS THE CONTRACTOR'S RESPONSIBILITY TO OBTAIN ALL FEDERAL, STATE AND LOCAL PERMITS NECESSARY TO PERFORM AND COMPLETE THE PROJECT AS SHOWN ON THESE PLANS.
- 4.) CONSTRUCTION STAKING SHALL BE THE CONTRACTOR'S RESPONSIBILITY. ADDITIONAL INFORMATION FOR STAKING THE PROJECTS LINES AND GRADES WILL BE PROVIDED IN AUTOCAD DRAWING FILE FORMAT UPON REQUEST.
- 5.) IT IS THE CONTRACTOR'S RESPONSIBILITY TO COORDINATE ALL CONSTRUCTION ACTIVITIES WITH THE UTILITY COMPANIES SUCH THAT ACCESS TO WORK AREAS OR SCHEDULE CONFLICTS DO NOT INTERRUPT OR DELAY THE PROJECT SCHEDULE.
- 6.) THE HORIZONTAL AND VERTICAL LOCATIONS OF EXISTING UTILITIES SHOWN ARE APPROXIMATE. IT SHALL BE THE CONTRACTOR'S RESPONSIBILITY TO LOCATE AND VERIFY ALL UTILITIES PRIOR TO BEGINNING CONSTRUCTION ON THIS PROJECT.
- 7.) CONSTRUCTION OF THE INDUSTRIAL RAIL SPUR SHOWN SHALL BE WITH MATERIALS AND IN ACCORDANCE WITH THE CSX TRANSPORTATION'S "STANDARD SPECIFICATIONS FOR DESIGN AND CONSTRUCTION OF PRIVATE SIDETRACKS", LATEST EDITION.
- 8.) MINIMUM CLEARANCES FOR WIRELINE AND UNDERGROUND PIPELINE CROSSINGS SHALL BE IN ACCORDANCE WITH THE CSX TRANSPORTATION'S GUIDELINES.
- 9.) MINIMUM HORIZONTAL AND VERTICAL CLEARANCES FOR STRUCTURES (I.E. BRIDGES, DOCKS, DOORS, ETC.) SHALL BE IN ACCORDANCE WITH THE CSX TRANSPORTATION'S GUIDELINES.
- 10.) CSX TRANSPORTATION'S "STANDARD SPECIFICATIONS FOR DESIGN AND CONSTRUCTION OF PRIVATE SIDETRACKS" CAN BE DOWNLOADED FROM THE CSX.COM WEBSITE.
- 12.) RAIL INSTALLED ON THIS PROJECT SHALL BE A MINIMUM 115# RE SECTION.

UTILITY NOTES:

- A. CONTRACTOR IS SPECIFICALLY CAUTIONED THAT LOCATIONS AND/OR ELEVATIONS OF EXISTING UTILITIES SHOWN ON THESE PLANS ARE BASED ON RECORD DRAWINGS, AND WHERE POSSIBLE, MEASUREMENTS TAKEN IN THE FIELD. THE INFORMATION SHOWN IS NOT TO BE RELIED ON AS BEING EXACT OR ALL INCLUSIVE.
- B. CONTRACTOR SHALL UNCOVER AND VERIFY ALL LOCATIONS AND ELEVATIONS AT UTILITY CROSSING LOCATIONS PRIOR TO ANY GRADING OPERATIONS.
- C. CONTRACTOR SHALL UNCOVER AND VERIFY ALL LOCATIONS AND ELEVATIONS AT TIE IN LOCATIONS PRIOR TO ANY UNDERGROUND PIPE INSTALLATION.
- D. CONTRACTOR SHALL LOCATE ALL EXISTING ACTIVE UTILITIES IN THE PROJECT AREA, PROVIDE ADEQUATE MEANS OF SUPPORT AND PROTECTION DURING CONSTRUCTION ACTIVITIES AND COORDINATE ANY DISRUPTION OF SERVICE WITH THE UTILITY COMPANY, OWNER AND CONSTRUCTION MANAGER.

SITE GRADING NOTES:

- A. ALL STORM DRAIN CONSTRUCTION SHALL CONFORM TO THE KENTUCKY TRANSPORTATION CABINET'S "STANDARD SPECIFICATIONS FOR ROAD AND BRIDGE CONSTRUCTION".
- B. PROOFROLLING OF THE SITE WILL BE REQUIRED PRIOR TO PLACING ANY FILL MATERIAL. FINAL PROOFROLLING WILL BE REQUIRED OF THE SUBGRADE PRIOR TO PLACING SUBBALLAST.
- C. THE CONTRACTOR SHALL SUBMIT COMPACTION REPORTS PREPARED BY A QUALIFIED GEOTECHNICAL ENGINEER, REGISTERED IN THE STATE OF KENTUCKY, VERIFYING ALL SUBGRADES HAVE BEEN PROPERLY COMPACTED. THE CONTRACTOR SHALL NOTIFY THE OWNER'S REPRESENTATIVE IF ANY UNSUITABLE SOILS ARE ENCOUNTERED.
- D. THE CONTRACTOR SHALL SLOPE ALL FINISH GRADES TO PROVIDE POSITIVE DRAINAGE. FLAT AND/OR PONDING AREAS WILL NOT BE ACCEPTED IN THE FINISHED WORK.

UTILITY PROTECTION NOTE:

ALL UTILITIES ON THESE PLANS ARE APPROXIMATE. INDIVIDUAL SERVICE LINES ARE NOT SHOWN. THE CONTRACTOR OR SUBCONTRACTOR SHALL NOTIFY THE UTILITY PROTECTION CENTER KENTUCKY 811 (TOLL FREE PHONE NO. 1-800-752-6007 OR LOCAL NO. 502-266-5123) FORTY-EIGHT (48) HOURS IN ADVANCE OF ANY CONSTRUCTION ON THIS PROJECT. THIS NUMBER WAS ESTABLISHED TO PROVIDE ACCURATE LOCATIONS OF EXISTING BELOW GROUND UTILITIES (I.E. CABLES, ELECTRIC WIRES, GAS & WATER LINES). THE CONTRACTOR SHALL BE RESPONSIBLE FOR BECOMING FAMILIAR WITH ALL UTILITY REQUIREMENTS SET FORTH ON THE PLANS AND IN THE TECHNICAL SPECIFICATIONS & SPECIAL PROVISIONS.

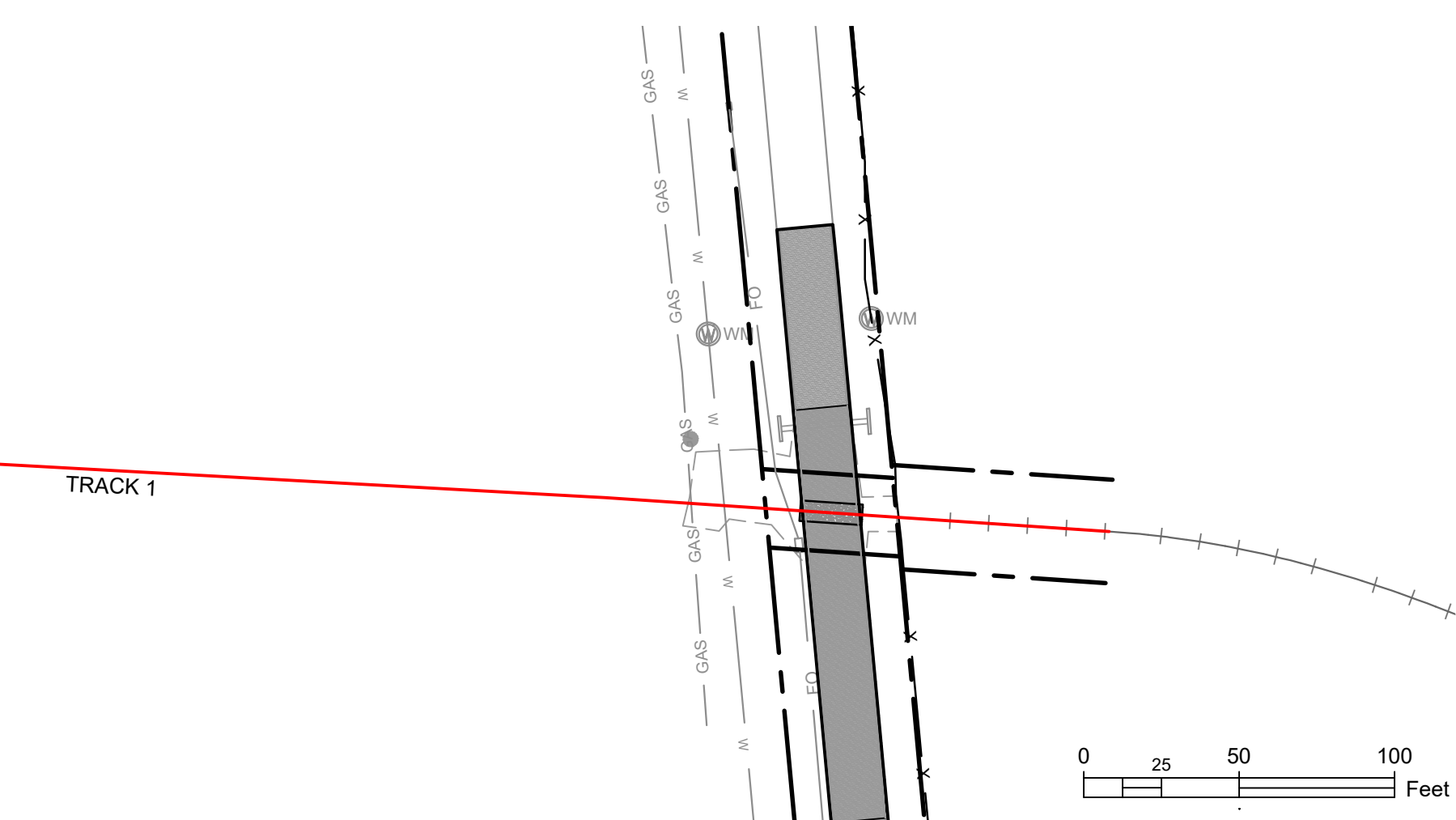

NO.	DATE	DESCRIPTION	BY	
			AD	AD
1	10-11-24	REVISIONS PER CSX REVIEW COMMENTS		

9400 Bursen Parkway, Suite 150
Louisville, KY 40220
502.671.0060

CDI
CIVIL DESIGN, INC.
WBE / DBE
Civil Engineering
www.civil-design.com

10/11/2024
DATE

STATE OF KENTUCKY
Alexander V. DeJongh
730309
LICENSED PROFESSIONAL ENGINEER
SIGNATURE

OVERALL LAYOUT

STAINLESS STEEL MIDWEST

2815 KY-146
LAGRANGE, KENTUCKY 40031

DRAWN BY: AD	CHKD BY: AD
DATE: OCT. 11, 2024	
DRAWING: C-1	
SCALE: 1" = 60'	
SHEET 1	OF 4

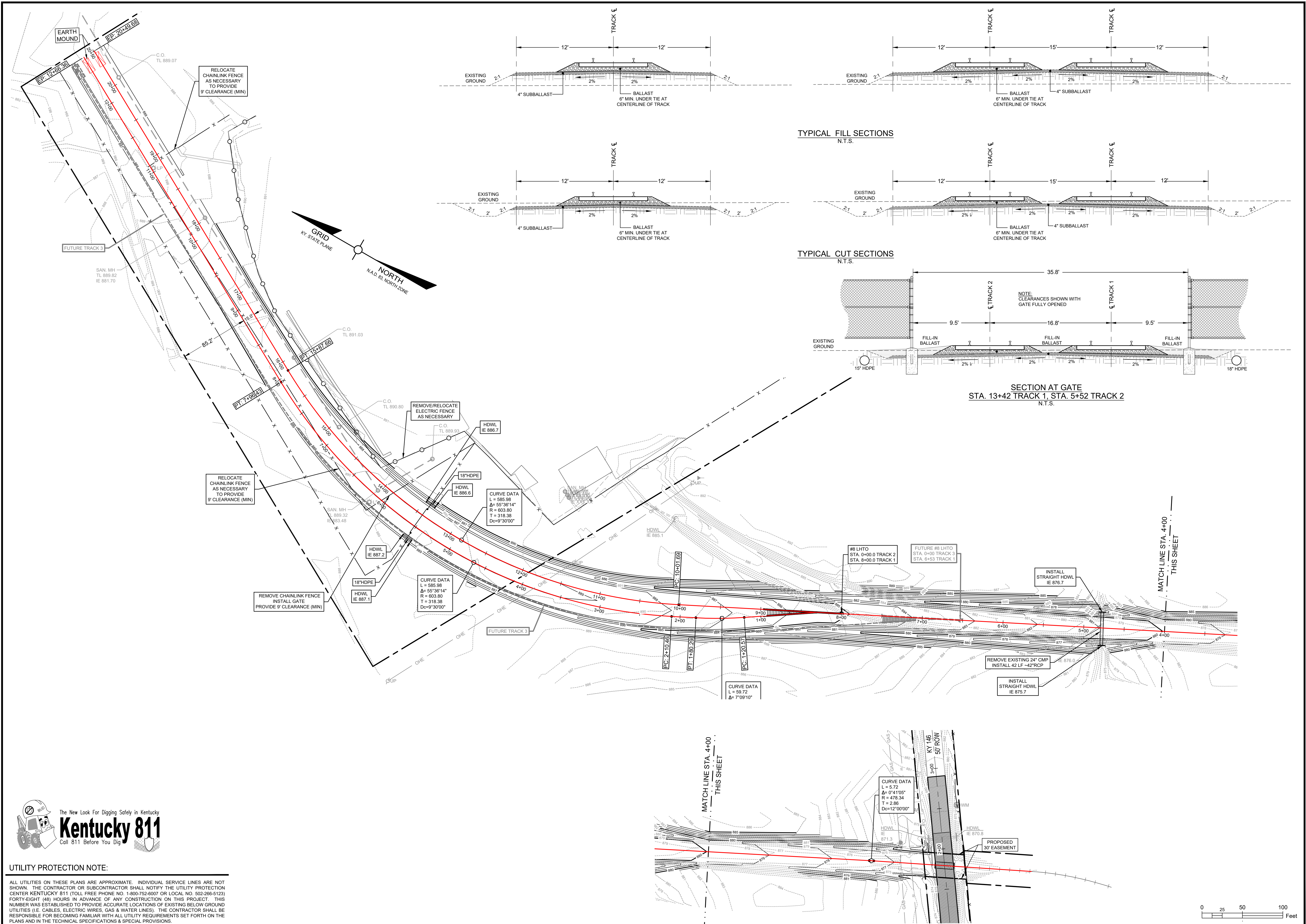

UTILITY PROTECTION NOTE:
 ALL UTILITIES ON THESE PLANS ARE APPROXIMATE. INDIVIDUAL SERVICE LINES ARE NOT SHOWN. THE CONTRACTOR OR SUBCONTRACTOR SHALL NOTIFY THE UTILITY PROTECTION CENTER KENTUCKY 811 (TOLL FREE PHONE NO. 1-800-752-6007 OR LOCAL NO. 502-266-5123) FORTY-EIGHT (48) HOURS IN ADVANCE OF ANY CONSTRUCTION ON THIS PROJECT. THIS NUMBER WAS ESTABLISHED TO PROVIDE ACCURATE LOCATIONS OF EXISTING BELOW GROUND UTILITIES (I.E. CABLES, ELECTRIC WIRES, GAS & WATER LINES). THE CONTRACTOR SHALL BE RESPONSIBLE FOR BECOMING FAMILIAR WITH ALL UTILITY REQUIREMENTS SET FORTH ON THE PLANS AND IN THE TECHNICAL SPECIFICATIONS & SPECIAL PROVISIONS.

NO.	DATE	REVISIONS DESCRIPTION

9400 Bursen Parkway, Suite 150
 Louisville, KY 40220
 502.671.0060

CPI
 CIVIL DESIGN, INC.
 WBE / DBE
 Civil Engineering
 www.cpidesigninc.com

10/11/2024
 DATE

STATE OF KENTUCKY
 Alexander V. DeJongh
 730309
 LICENSED PROFESSIONAL ENGINEER
 SIGNATURE

LAYOUT / GRADING PLAN

STAINLESS STEEL MIDWEST
 2615 KY-146
 LAGRANGE, KENTUCKY 40031

DRWN BY: AD	CHKD BY: AD
DATE: OCT. 11, 2024	
DRAWING: C-2	
SCALE: 1" = 50'	
SHEET 2	OF 4

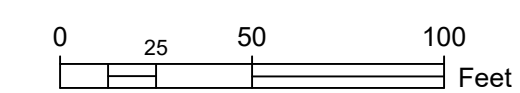

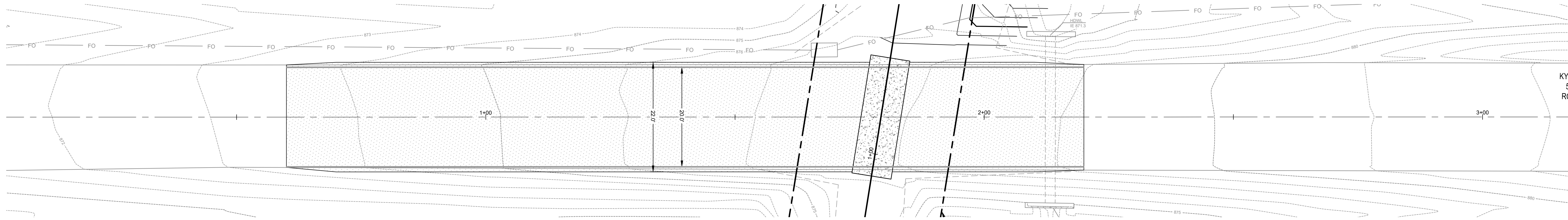

KY
5
RC

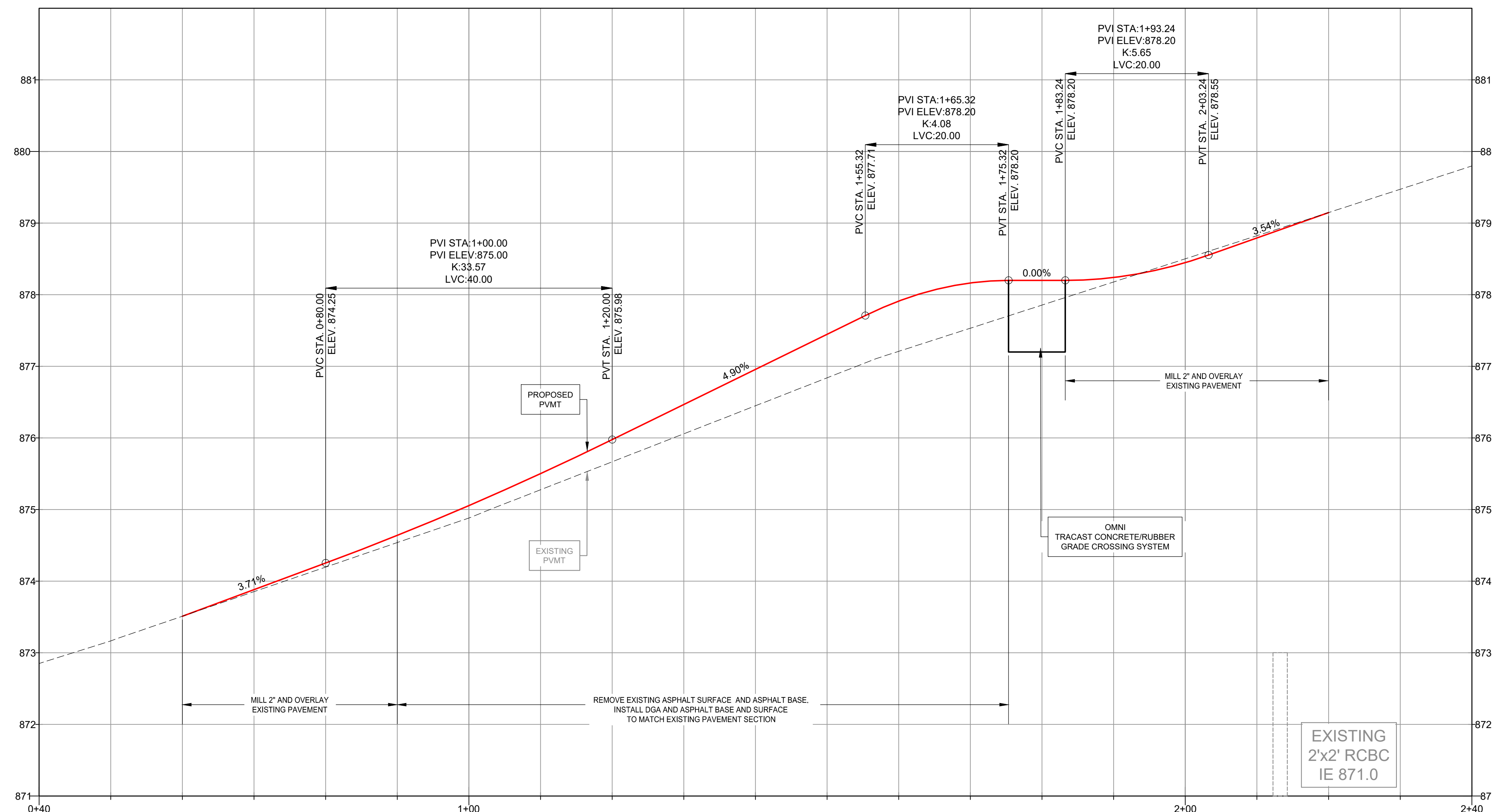

KY-146 PROFILE

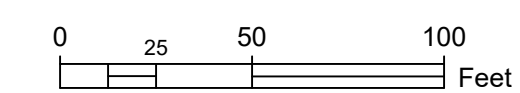

UTILITY PROTECTION NOTE:

ALL UTILITIES ON THESE PLANS ARE APPROXIMATE. INDIVIDUAL SERVICE LINES ARE NOT SHOWN. THE CONTRACTOR OR SUBCONTRACTOR SHALL NOTIFY THE UTILITY PROTECTION CENTER KENTUCKY 811 (TOLL FREE PHONE NO. 1-800-752-6007 OR LOCAL NO. 502-266-5123) FORTY-EIGHT (48) HOURS IN ADVANCE OF ANY CONSTRUCTION ON THIS PROJECT. THIS NUMBER WAS ESTABLISHED TO PROVIDE ACCURATE LOCATIONS OF EXISTING BELOW GROUND UTILITIES (I.E. CABLES, ELECTRIC WIRES, GAS & WATER LINES). THE CONTRACTOR SHALL BE RESPONSIBLE FOR BECOMING FAMILIAR WITH ALL UTILITY REQUIREMENTS SET FORTH ON THE PLANS AND IN THE TECHNICAL SPECIFICATIONS & SPECIAL PROVISIONS.



NO.	DATE	DESCRIPTION
1	10-11-24	REVISIONS PER CSX REVIEW COMMENTS

9400 Bunsen Parkway, Suite 150
Louisville, KY 40220
502.671.0060

CDI
CIVIL DESIGN, INC.
WBE / DBE
Civil Engineering
www.cdiengineering.com

10/11/2024
DATE

Alexander V. DeJongh
70309
LICENSED PROFESSIONAL ENGINEER

SIGNATURE

KY-146 RAILROAD CROSSING

STAINLESS STEEL MIDWEST

2815 KY-146
LAGRANGE, KENTUCKY 40031

DRWN BY: AD	CHKD BY: AD
DATE: OCT. 11, 2024	
DRAWING: C-4	
SCALE: 1" = 10'	
SHEET 4	OF 4

THIS RAILROAD VALUATION EXHIBIT IS A GRAPHICAL REPRESENTATION. IT MAY NOT REFLECT CURRENT "ON THE GROUND" CONDITIONS AND/OR ACTUAL LOCATIONS OF FEATURES. ALL DIMENSIONS, OFFSET DISTANCES AND MEASUREMENT NOTATIONS SHOWN ARE APPROXIMATE.

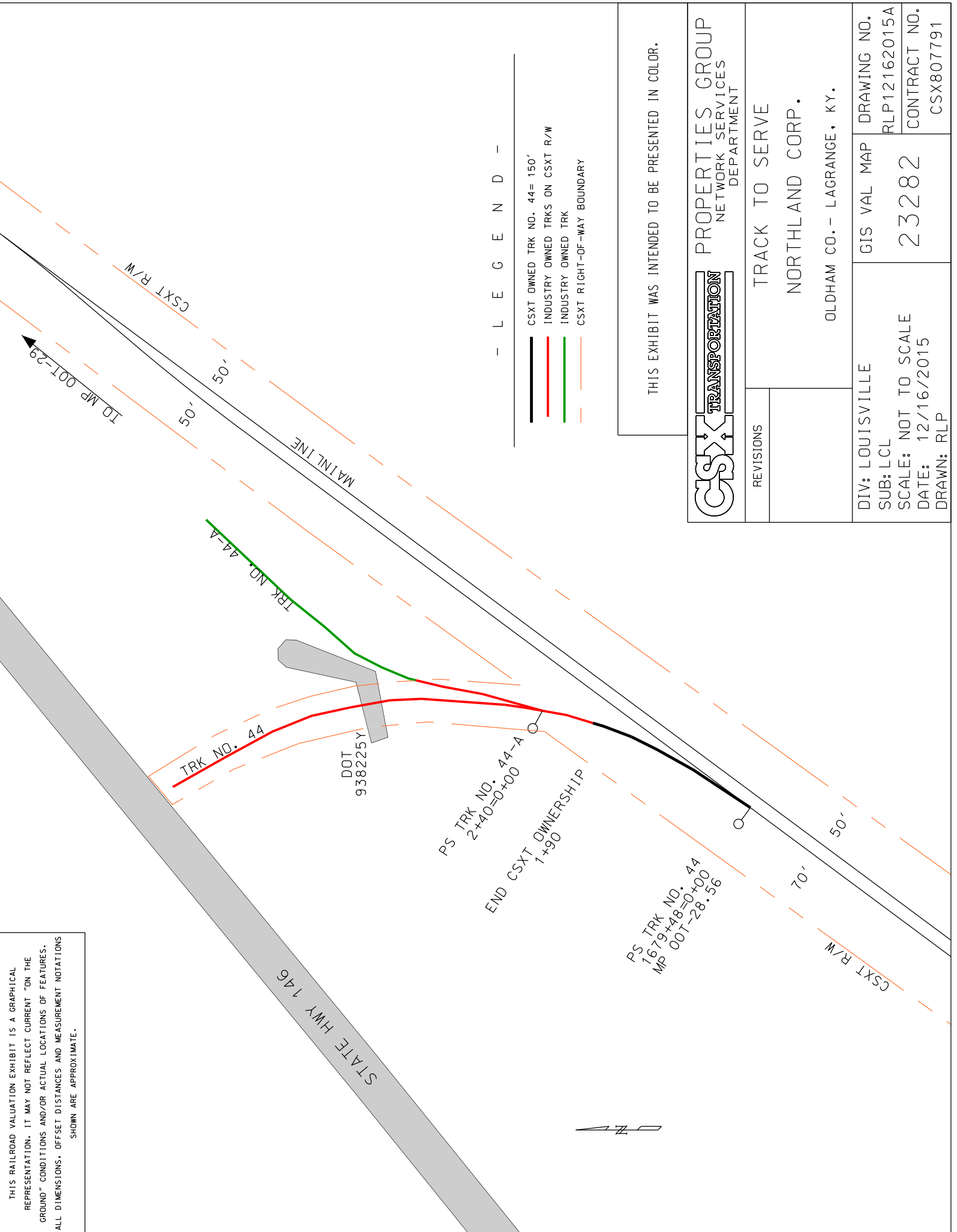

THIS EXHIBIT WAS INTENDED TO BE PRESENTED IN COLOR.



PROPERTIES GROUP
NETWORK SERVICES
DEPARTMENT

REVISIONS	TRACK TO SERVE		DRAWING NO.	
	NORTHLAND CORP.		RLP12162015A	
	OLDHAM CO. - LAGRANGE, KY.		CONTRACT NO.	
DIV: LOUISVILLE	GIS VAL MAP		CSX807791	
SUB: LCL	23282			
SCALE: NOT TO SCALE				
DATE: 12/16/2015				
DRAWN: RLP				



Robb Fritz
Sr. Manager
Industrial Development
Site Design

19 Depot St.
Walton, KY 41094
(419) 733-3126
Robb_Fritz@CSX.com

March 6, 2025

Mr. Tim Cunagin
2615 Hwy 146 E
La Grange, KY 40031

SUBJECT: Kentucky Industrial Access and Safety Improvement (KIASI) Program Grant Application

Tim:

Thank you for the opportunity to support Stainless Steel Midwest in its effort to add rail to your La Grange, KY yard through an application for grant funds from the KIASI Program.

On behalf of CSX Transportation, Inc. (CSX), I am pleased to confirm CSX's willingness and ability to provide rail service as a Class I common carrier to Stainless Steel Midwest at your La Grange, KY scrap yard if the rail design and construction plan fully complies with CSX's safety, engineering, and operations specifications.

CSX looks forward to continuing our partnership with Stainless Steel Midwest for this potential project!

Regards,

Robb A Fritz

Robb Fritz
Sr. Manager
Industrial Development – Site Design

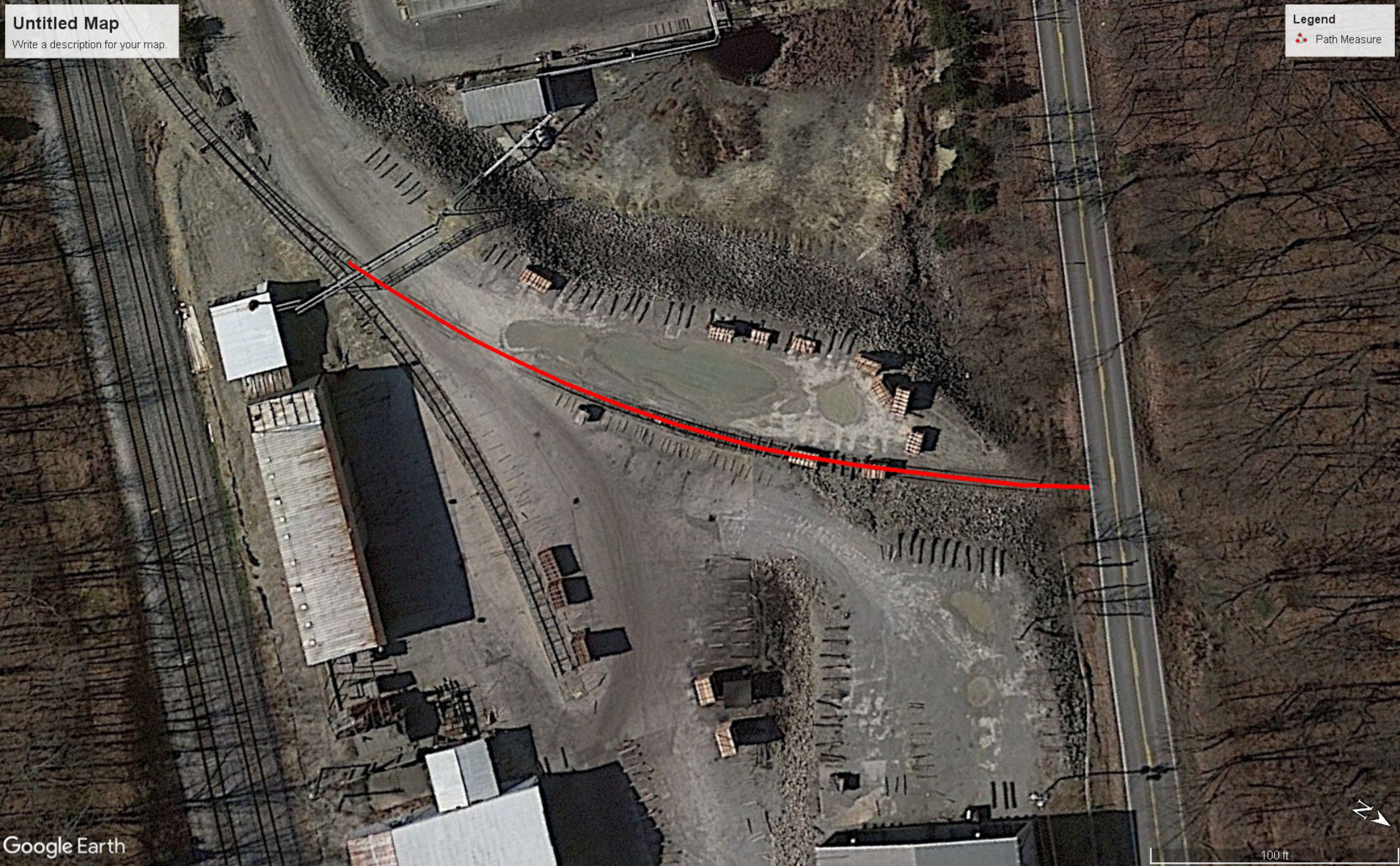



2615 KY-146

This is an aerial photograph of an industrial or manufacturing site. The facility consists of several large, rectangular buildings with light-colored roofs, arranged in a somewhat U-shape. There are numerous parking lots, paved areas, and some piles of debris or scrap material scattered throughout the site. A prominent feature is a long, narrow structure, possibly a conveyor belt or a long shed, running along the right side of the main building complex. The surrounding area is mostly undeveloped, with sparse vegetation and some trees. A road or highway is visible on the right side of the image. A red location pin is placed on the image, pointing to a specific area within the facility, with the text '2615 KY-146' overlaid next to it.















Stainless Steel Midwest Rail Turnout Project
Construction Project estimate
March 7, 2025

Mobilization site preparation costs	\$	391,655
Construction costs	\$	866,100
Light signals and signage	\$	226,100
Other miscellaneous constructions cost (move utilities, drainage)	\$	39,495
Road rehab and crossing	\$	83,890
Railroad scale	\$	45,160
Property purchase	\$	347,600
		<hr/>
		\$ 2,000,000