

STR. STEEL WTS.		
1 GRATE	TOTAL	FRAME
138.5 LBS	277 LBS	51 LBS

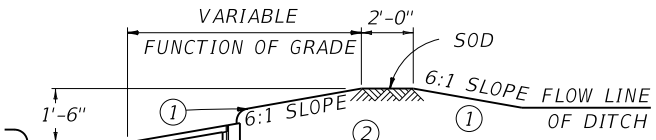
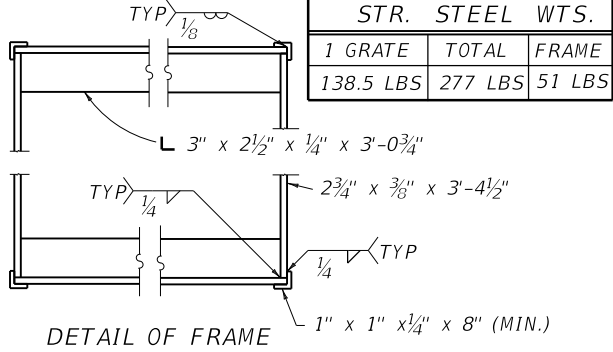

~ NOTES ~

- BID ITEM AND UNIT TO BID
DROP BOX INLET TYPE 3 EACH
- 6:1 SLOPES ARE WITH REFERENCE TO DITCH GRADE.
- WHEN A BOX INLET IS PLACED IN A SAG, OMIT THE EARTH DIKE AND LONGITUDINAL SLOPE OF THE GRATE, AND PROVIDE A CONCRETE APRON ON EACH SIDE OF THE INLET.
- RATE OF INCREASE OR DECREASE 0.36 CU. YD. PER FOOT IN HEIGHT.
- DEDUCT APPROX. 0.1 CU. YD. OF CONCRETE PER PIPE.
- RELIANCE STEEL (CAT. NO. H2-12D) AND GARY STEEL (CAT. NO. HW3-D-300) ARE ACCEPTABLE ALTERNATES PROVIDED MATCHED GRATES ARE SUPPLIED.
- THE 2 3/4" BAR SHALL BE NOTCHED TO RECEIVE THE 1" BAR.
- COMPACT THIS VOLUME WITH D.G.A. BASE OR GRAVEL BASE AND INCLUDE IN THE UNIT PRICE OF THE BOX.
- DOWNSTREAM DIKE COMPLETE AND IN PLACE IS INCLUDED IN THE CONTRACT UNIT PRICE OF THE INLET. SODDING IS NOT INCLUDED.

NOTE: PRIMARY USE (ROADSIDE DITCH LOCATION)

APPROX. QUANTITIES

TYPE	CONCRETE	REINF. STEEL
3'-9" BOX	3	3
SAG	4.4 CU. YD. ④	282 LBS
GRADE	3.4 CU. YD. ④	192 LBS

KENTUCKY
DEPARTMENT OF HIGHWAYS

**DROP BOX
INLET
TYPE 3**

STANDARD DRAWING NO. RDB-003-08

SUBMITTED *[Signature]* DATE 12-01-15

APPROVED *[Signature]* DATE 12-01-15

STATE HIGHWAY ENGINEER