

TYPICAL SHEETING SIGN BREAKAWAY SUPPORT INSTALLATION

NOTES

1. AUGER AN 18" DIA. HOLE BY 42" DEEP AT THE PREDETERMINED LOCATION.
2. TAP THE BOTTOM OF THE 48" BASE STUB INTO THE SOIL IN THE BOTTOM OF THE HOLE WITH THE BASE PLUMB AND SQUARED UP WITH THE ROADWAY, MAKING SURE THE POINT OF THE PLATE IS FACING ONCOMING TRAFFIC. (THIS SERVES TO STABILIZE THE BASE WHILE POURING THE CONCRETE AS WELL AS TO ALLOW FOR WATER DRAINAGE BELOW THE CONCRETE FOOTING.)
3. DEPTH OF IMBEDMENT TO LEAVE 2 1/2" FROM THE GRADE TO THE TOP OF THE BASE.
4. ALLOW CONCRETE TO CURE AT LEAST 5 DAYS BEFORE ERECTING SIGN.
5. PLACE 1 EACH TEFLON COATED WASHER SHIM ON EACH OF THE 3 NOTCHED POINTS, WITH THE OPEN SIDE FACING TOWARDS THE CENTER OF THE TRIANGLE.
6. PLACE TOP POST RECIEVER SO THAT THE SIGN POST IS IN CORRECT POSITION FOR SIGN VISIBILITY, ON TO THE BASE AND WASHER SHIMS.
7. PLACE 1 EACH 1/2" WASHER ONTO TORQUE FREE BOLT AND PLACE IN EACH NOTCHED POINT OF THE TRIANGLE. PUSH EACH TEFLON COATED WASHER SHIM AGAINST THE SHANK OF EACH BOLT AND FINGER TIGHTEN 1/2" FLANGED LOCK NUT.
8. FULLY TIGHTEN, THEN LOOSEN, ALL THREE TORQUE FREE BOLTS USING THE LARGER 3/4" HEX HEAD. COMPLETE BY TIGHTENING EACH BOLT USING THE SMALLER 1/16" HEX HEAD UNTIL IT TWIST OFF.
NOTE: SECONDARY HEAD WILL TWIST OFF AT DESIRED TORQUE LEVEL TO MEET FEDERAL COMPLIANCE.
9. INSERT SIGN SUPPORT INTO THE TUBULAR PORTION OF THE TOP POST RECIEVER AND SECURE WITH 3 EACH 3/8"-16 x 3/2" GRADE 8 FLANGED SHOULDER BOLTS AND FLANGED NUTS.
NOTE: WHERE HIGHER WINDLOAD IS DESIRED, INSERT THE NEXT SIZE SMALLER SQUARE POST INSIDE BOTTOM OF MAIN UPRIGHT POST.
NOTE: ON MULTI-LEG INSTALLATIONS, BE SURE THAT ALL ANCHORS ARE SQUARED AND LINED UP WITH EACH OTHER.
10. TYPE D BREAKAWAY SIGN SUPPORT SYSTEMS FOR THE TYPE I POSTS SHALL BE SELECTED FROM THE KENTUCKY DEPARTMENT OF HIGHWAYS APPROVED MATERIALS LIST, OR AN APPROVED EQUAL. ACCEPTABLE ALTERNATES SHALL BE APPROVED BY THE DIVISION OF HIGHWAY DESIGN AND FHWA, PRIOR TO INSTALLATION.

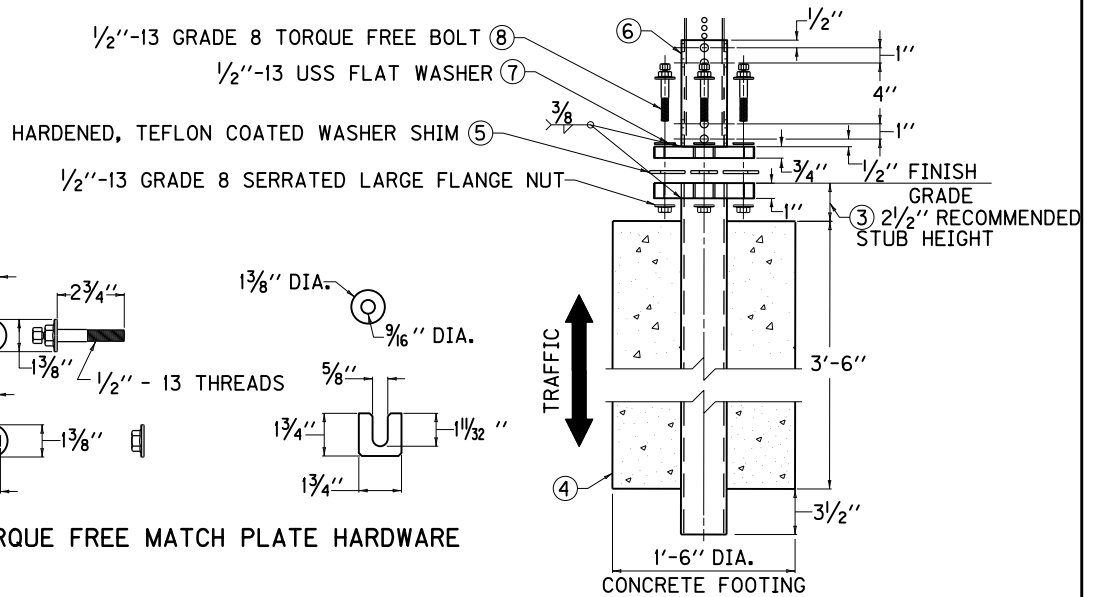

TORQUE FREE MATCH PLATE HARDWARE

TYPE "D" SUPPORT
FOR TYPE I POSTS

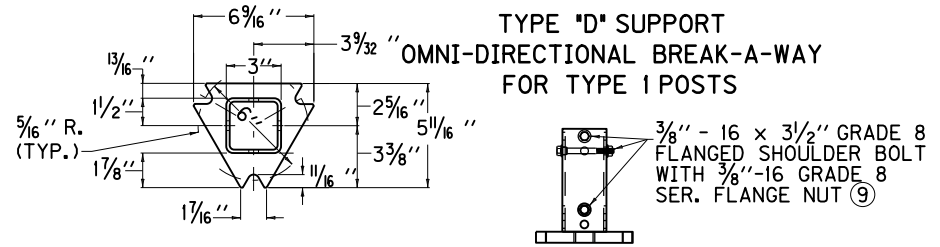

MATERIALS: TUBE RECEIVER - 3" x 3" x 7 GA. ASTM A500
ASTM A500 GRADE B TUBE PLATE - ASTM A572 GRADE 50

TOP POST RECEIVER / FOR 2 1/2" SQUARE POST

2 1/4" x 12 GA. MAYBE INSERTED INTO
2 1/2" x 12 GA. FOR ADDITIONAL WINDLOAD

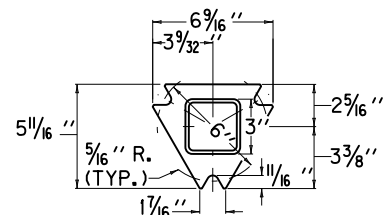

BOTTOM BASE CONCRETE STUB ②

MATERIALS: TUBE - 3" x 3" x 7 GA. ASTM A500
GRADE B TUBE PLATE - ASTM A572 GRADE 50

KENTUCKY DEPARTMENT OF HIGHWAYS	
TYPE D BREAKAWAY SIGN SUPPORT	
STANDARD DRAWING NO. RCX-065-01	
SUBMITTED: <i>[Signature]</i>	12-2-11
DIRECTOR, DIVISION OF DESIGN	DATE
APPROVED: <i>[Signature]</i>	12-2-11
STATE HIGHWAY ENGINEER	DATE