

TERMINAL SECTION NO. 1

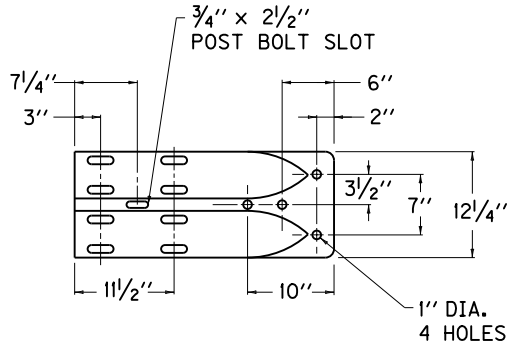

TERMINAL SECTION NO. 2

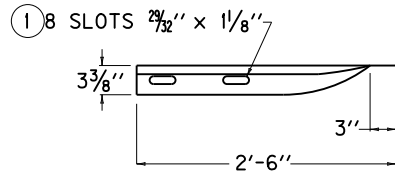
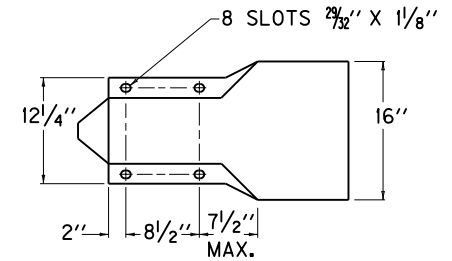
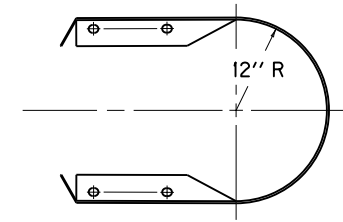

TERMINAL SECT. NO. 3

NOTES

TERMINAL SECTIONS SHALL BE PAID FOR AT THE CONTRACT UNIT PRICE BID EACH COMPLETE AND INSTALLED, EXCEPT WHEN INCIDENTAL TO OTHER BID ITEMS.

TERMINAL SECTIONS SHALL COMPLY WITH AASHTO M-180 AS FOLLOWS:

- a. TERMINAL SECTIONS NO. 1, 3, -CLASS A OR B, TYPE 2
- b. TERMINAL SECTION NO. 2-CLASS B, TYPE 2

- ① WHEN SLOTTED HOLES ARE EXPOSED (8) EIGHT RECTANGULAR FLAT WASHERS SHALL BE REQUIRED-2" SPLICE BOLTS ARE TO BE USED IF NEEDED.

KENTUCKY DEPARTMENT OF HIGHWAYS	
GUARDRAIL TERMINAL SECTIONS	
STANDARD DRAWING NO. RBR-010-05	
SUBMITTED <i>John B. Sackett</i> DIRECTOR DIVISION OF DESIGN	12-1-99 DATE
APPROVED <i>J. M. Powell</i> STATE HIGHWAY ENGINEER	12-1-99 DATE