

COUNTY OF	ITEM NO.	SHEET NO.
JEFFERSON	5-1070.00	R1

Commonwealth of Kentucky DEPARTMENT OF HIGHWAYS

PLANS OF PROPOSED PROJECT

JEFFERSON COUNTY E KENTUCKY STREET over SOUTH FORK BEARGRASS CREEK STP BRZ 0503 (227)



SHEET NO.	DESCRIPTION
R1	LAYOUT SHEET
R2-2b	TYPICAL SECTIONS-SUMMARY OF QUANTITIES
R3-R5	PLAN AND PROFILE SHEETS
	RIGHT OF WAY SUMMARY SHEETS
	RIGHT OF WAY STRIP MAP SHEETS
	DETAIL SHEETS
	TRAFFIC CONTROL SHEETS
	EROSION CONTROL SHEETS
	MITIGATION PLAN SHEETS
	COORDINATE CONTROL SHEETS
	SOIL PROFILE SHEETS
	PIPE DRAINAGE SHEETS
S	STRUCTURE PLANS
T	TRAFFIC PLANS
U	UTILITY RELOCATION PLANS
XI-XB	CROSS SECTION SHEETS

SHEETS NOT INCLUDED IN TOTAL SHEETS .
R2a

NUMBER	STANDARD DRAWINGS

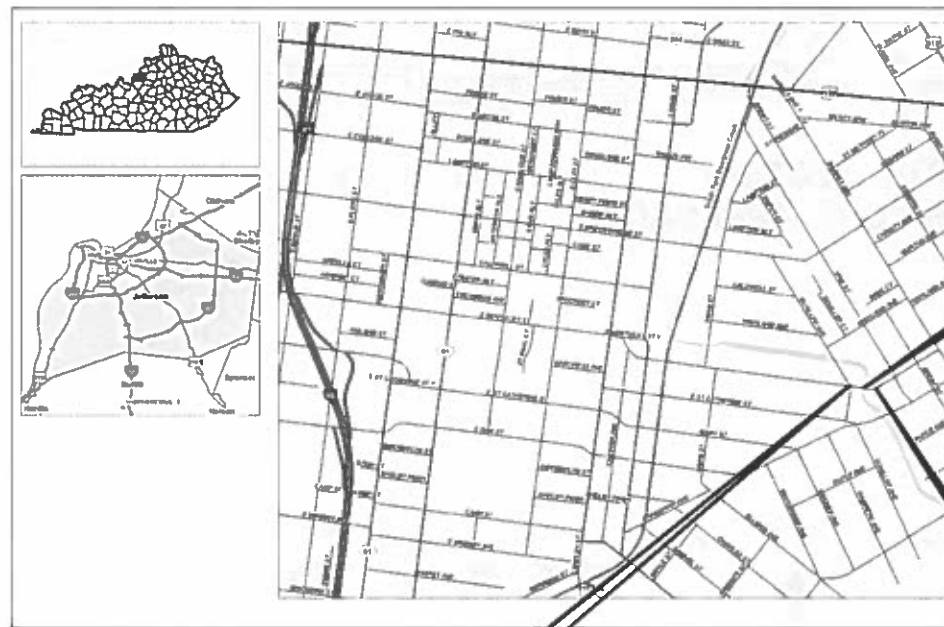

CENTER OF BRIDGE
STA. 22+50

THE CONTROL OF ACCESS ON THIS
PROJECT SHALL BE BY PERMIT

THIS PROJECT IS OFF THE NH SYSTEM

BEGIN PROJECT
STA. 21+20

END PROJECT
STA. 23+82.30

LAYOUT MAP NOT TO SCALE

USER: stephanie.stoops
 DATE PLOTTED: January 1, 2000
 E-SHEET NAME:
 MicroStation v8.11.9.032
 FILE NAME: C:\PWORK\AMANDA.DESMOND\0256632\LAYOUT SHEET.DGN

DESIGN CRITERIA

CLASS OF HIGHWAY	URBAN MAJOR COLLECTOR
TYPE OF TERRAIN	LEVEL
DESIGN SPEED	
REQUIRED NPSD	
REQUIRED PSD	
LEVEL OF SERVICE	
ADT PRESENT (2015)	2400
ADT FUTURE (2039)	2700
DIV (2015) 360	(2039) 400
D %	
T % (2015) 3.2%	(2039) 3.6%

GEOGRAPHIC COORDINATES

LATITUDE 38 DEGREES 14 MINUTES 07 SECONDS NORTH
 LONGITUDE 85 DEGREES 43 MINUTES 52 SECONDS WEST

DESIGNED

RESTRICTED SO
 LEVEL OF SERVICE
 MAX. DISTANCE W/O PASSING

LENGTH	LIN. FT.	MILES	LENGTH	LIN. FT.	MILES	LENGTH	LIN. FT.	MILES	LENGTH	LIN. FT.	MILES
262.30	0.050										
ADDED	FOR EQUALITIES	LIN. FT.	ADDED	FOR EQUALITIES	LIN. FT.	ADDED	FOR EQUALITIES	LIN. FT.	ADDED	FOR EQUALITIES	LIN. FT.
DEDUCTED	NOT INCLUDED		DEDUCTED	NOT INCLUDED		DEDUCTED	NOT INCLUDED		DEDUCTED	NOT INCLUDED	
RAILROAD CROSSINGS NO.	LIN. FT.		RAILROAD CROSSINGS NO.	LIN. FT.		RAILROAD CROSSINGS NO.	LIN. FT.		RAILROAD CROSSINGS NO.	LIN. FT.	
BRIDGES	LIN. FT.		BRIDGES	LIN. FT.		BRIDGES	LIN. FT.		BRIDGES	LIN. FT.	

Commonwealth of Kentucky
DEPARTMENT OF HIGHWAYS
COUNTY OF
JEFFERSON

ITEM NO. 5-1070.00
 PROJECT NUMBER: FD52 053 1017 001-002
 STP BRZ 0503 (227)
 LETTING DATE: _____
 RECOMMENDED BY: _____ PROJECT MANAGER DATE: _____
 PLAN APPROVED BY: _____ STATE HIGHWAY ENGINEER DATE: _____



COUNTY OF	ITEM NO.	SHEET NO.
JEFFERSON	5-1070.00	R2

TYPICAL SECTIONS E. KENTUCKY STREET

NEW CONSTRUCTION GRADE, DRAIN AND FLEXIBLE PAVEMENT USING

TRAFFIC LANES

APPROXIMATELY 13.50' BASE — 4.00" DGA
3.25" CLASS 2 ASPHALT BASE 0.75D PG64-22
3.25" CLASS 2 ASPHALT BASE 0.75D PG64-22
3.00" CLASS 2 ASPHALT BASE 0.75D PG64-22

APPROXIMATELY 1.25' SURFACE — 1.25" CLASS 2 ASPHALT SURFACE 0.38D PG64-22

ENTRANCES

APPROXIMATELY 7.00' BASE — 4.00" DGA
3.00" CLASS 2 ASPHALT BASE 0.75D PG64-22

APPROXIMATELY 1.25' SURFACE — 1.25" CLASS 2 ASPHALT SURFACE 0.38D PG64-22

NOTES:

-SEE CROSS SECTIONS FOR SLOPES OUTSIDE THE LIMITS OF THE SHOULDERS.

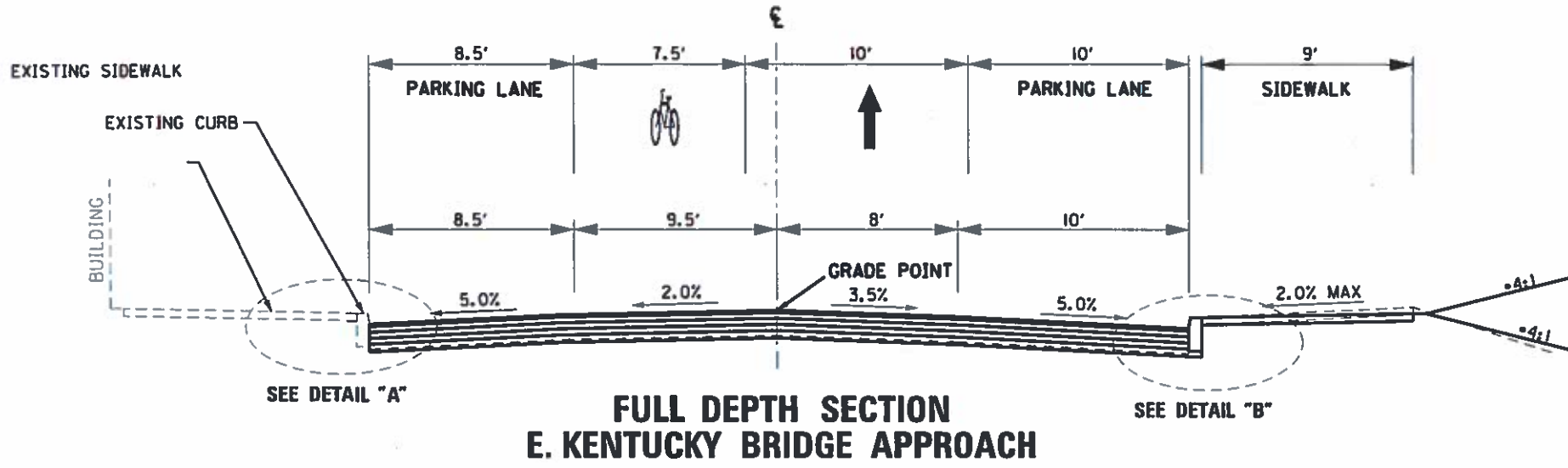

**FULL DEPTH SECTION
E. KENTUCKY BRIDGE APPROACH**

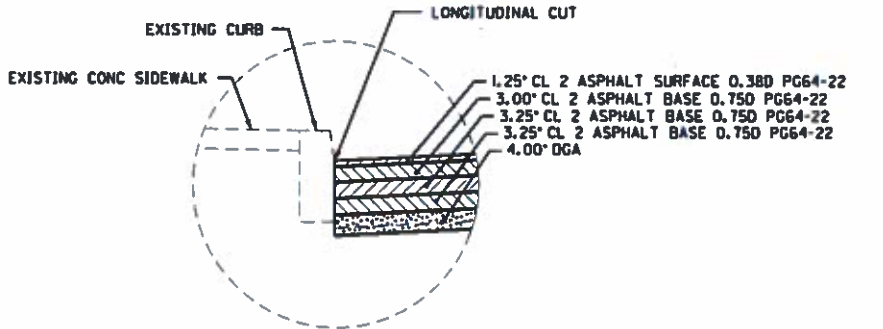

**DETAIL "A"
CURB AND GUTTER**

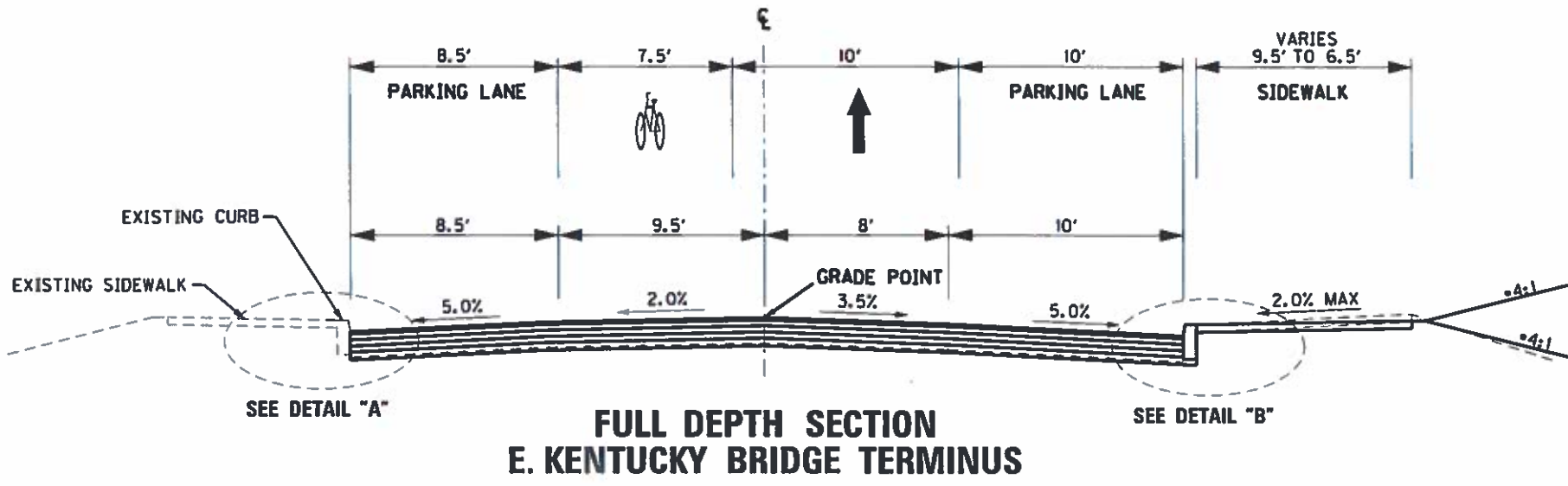

**FULL DEPTH SECTION
E. KENTUCKY BRIDGE TERMINUS**

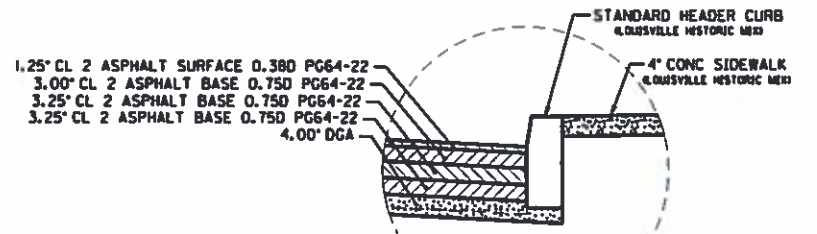

**DETAIL "B"
CURB AND GUTTER**

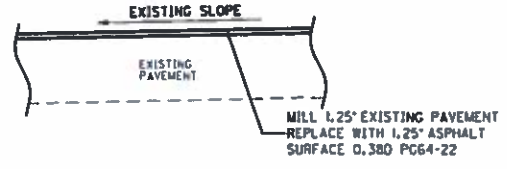

**OVERLAY DETAIL
NOT TO SCALE**

**E. KENTUCKY ST OVER BEARGRASS CREEK
TYPICAL SECTION
I-BEAM ALTERNATE**

SCALE: 1"= 10'

FILE NAME: C:\PWORK\AMANDA_DESMOND\1256832\TYPICAL SECTIONS.DGN

USER: amanda.desmond
DATE PLOTTED: January 1, 2001

E-SHEET NAME:

MicroStation v8.11.9.832

TYPICAL SECTIONS E. KENTUCKY STREET

NEW CONSTRUCTION GRADE, DRAIN AND FLEXIBLE PAVEMENT USING

TRAFFIC LANES

- APPROXIMATELY 13.50' BASE — 4.00" DGA
3.25" CLASS 2 ASPHALT BASE 0.75D PG64-22
3.25" CLASS 2 ASPHALT BASE 0.75D PG64-22
3.00" CLASS 2 ASPHALT BASE 0.75D PG64-22
- APPROXIMATELY 1.25' SURFACE — 1.25" CLASS 2 ASPHALT SURFACE 0.38D PG64-22

ENTRANCES

- APPROXIMATELY 7.00' BASE — 4.00" DGA
3.00" CLASS 2 ASPHALT BASE 0.75D PG64-22
- APPROXIMATELY 1.25' SURFACE — 1.25" CLASS 2 ASPHALT SURFACE 0.38D PG64-22

NOTES:

•SEE CROSS SECTIONS FOR SLOPES OUTSIDE THE LIMITS OF THE SHOULDERS.

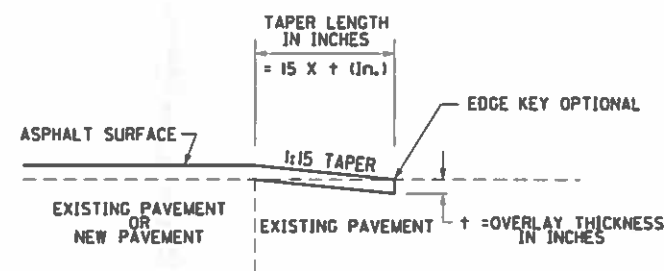

TAPER ENTRANCES

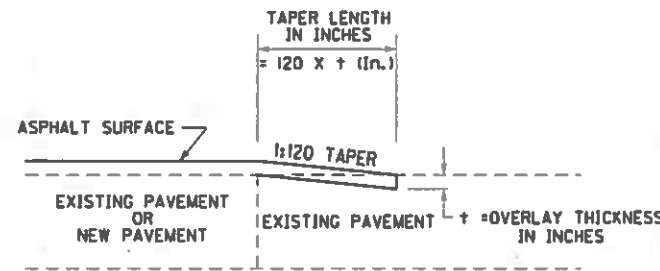

TAPERING OF OVERLAYS ON LOW SPEED FACILITIES (<45 MPH)

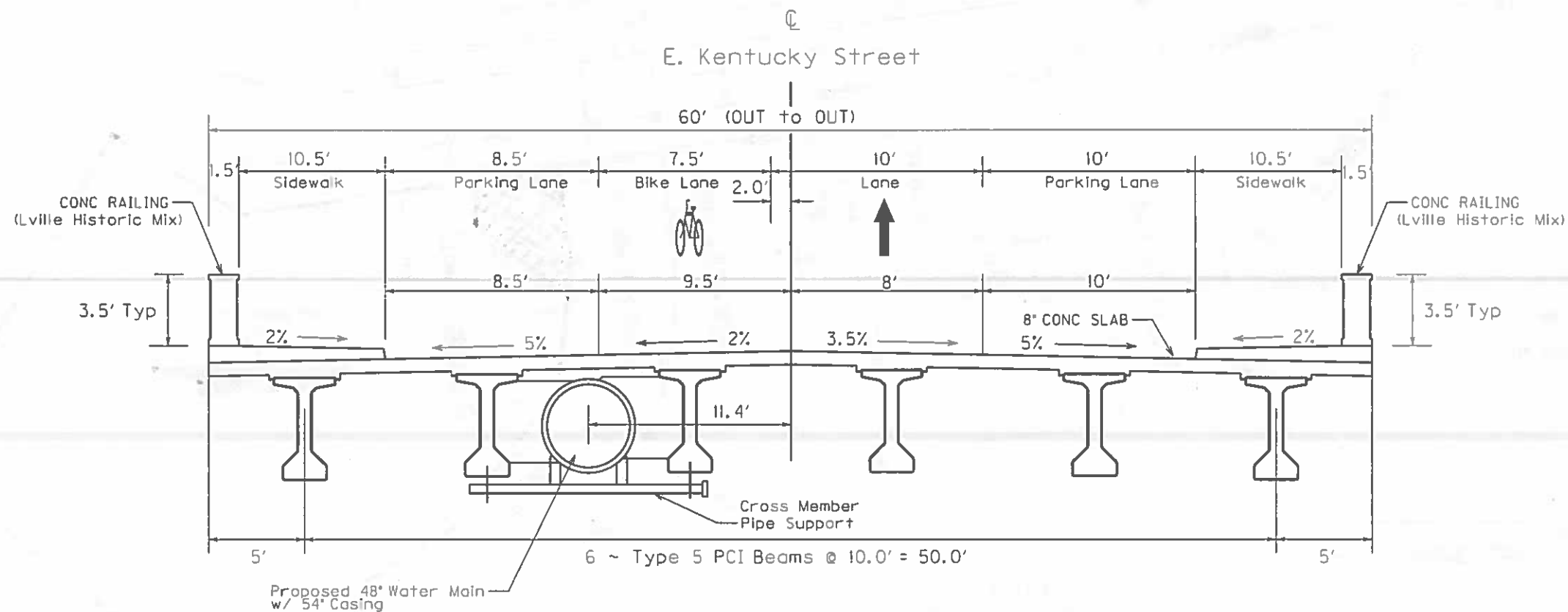

PROPOSED BRIDGE SECTION

NEW APPROACHES TO THE STRUCTURE ARE TO MATCH EXISTING ROADWAY CURBS AND SIDEWALKS ON EACH END OF PROJECT

E. KENTUCKY ST OVER BEARGRASS CREEK
TYPICAL SECTION
I-BEAM ALTERNATE

SCALE: 1" = NTS

FILE NAME: C:\PWORK\STEPHANIE.COFFEY\20256632\TYPICAL SECTIONS.DGN

USER: amanda.diamond
DATE PLOTTED: January 1, 2001

E-SHEET NAME:

MicroStation v8.11.9.032

FILE NAME: C:\PWORK\AMANDA.DESIGN\052973\HORIZONTAL ALIGNMENT PLAN SHEET - PL&G 2.DGN
 USER: Amanda.Desmond
 DATE PLOTTED: June 22, 2018
 E-SHEET NAME:
 MicroStation v8.11.3.032

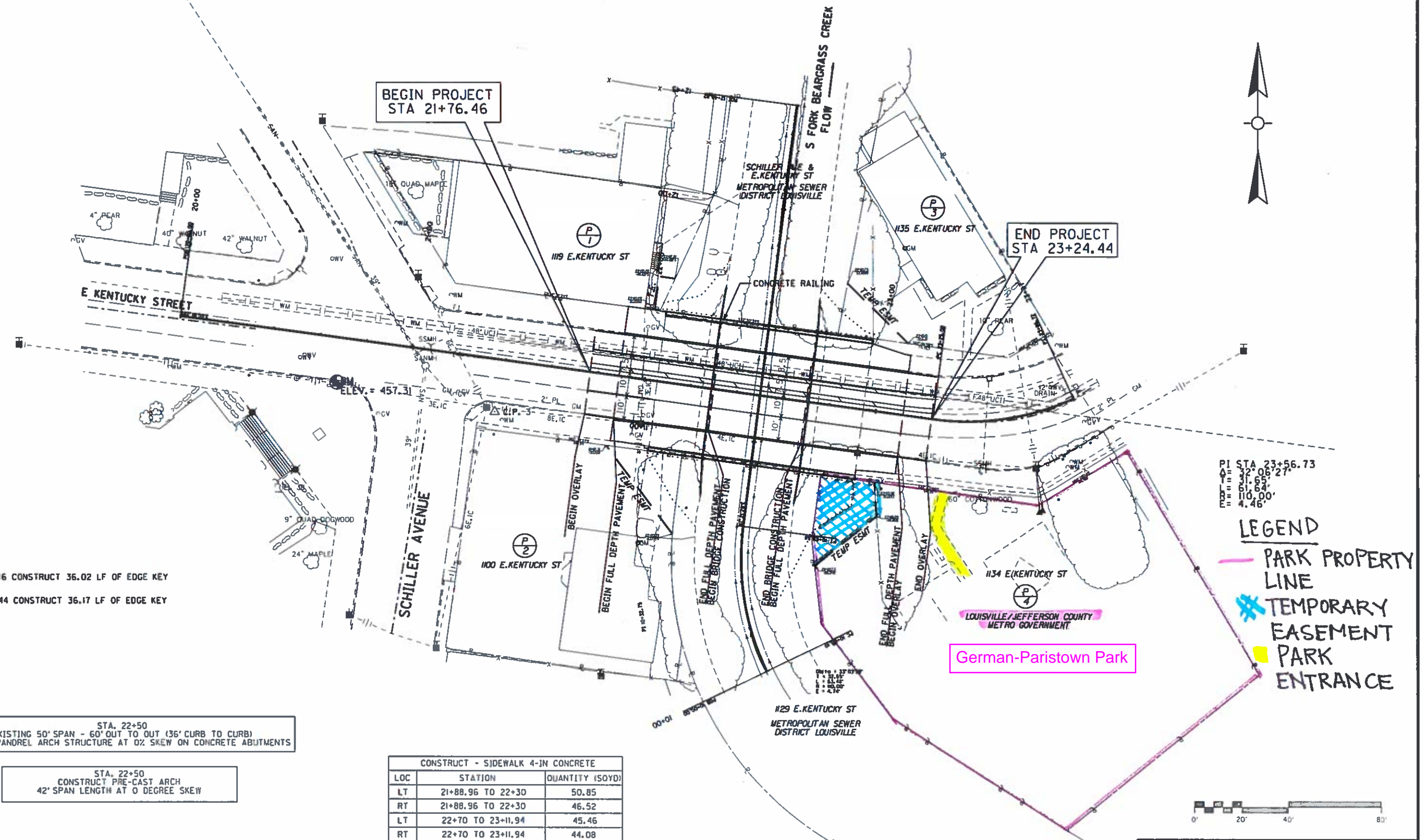

STA. 21+76.46 CONSTRUCT 36.02 LF OF EDGE KEY
 STA. 23+24.44 CONSTRUCT 36.17 LF OF EDGE KEY

PI STA 23+56.73
 $\Delta = 32^{\circ}08'27''$
 $L = 31.65'$
 $B = 61.64'$
 $E = 4.46'$

LEGEND

- PARK PROPERTY LINE
- TEMPORARY EASEMENT
- PARK ENTRANCE

STA. 22+50
 EXISTING 50' SPAN - 60' OUT TO OUT (36' CURB TO CURB)
 CLOSED SPANDREL ARCH STRUCTURE AT 0° SKEW ON CONCRETE ABUTMENTS

STA. 22+50
 CONSTRUCT PRE-CAST ARCH
 42' SPAN LENGTH AT 0 DEGREE SKEW

CONSTRUCT - SIDEWALK 4-IN CONCRETE		
LOC	STATION	QUANTITY (SOYD)
LT	21+88.96 TO 22+30	50.85
RT	21+88.96 TO 22+30	46.52
LT	22+70 TO 23+11.94	45.46
RT	22+70 TO 23+11.94	44.08



SCALE: 1"=20'
 E. KENTUCKY ST. OVER SOUTH FORK BEARGRASS CREEK BRIDGE REPLACEMENT
 STA. 21+76.46 TO STA 23+24.44

COUNTY OF	ITEM NO.	SHEET NO.
JEFFERSON	5-1070.00	R5

Note: Low Wire Elev. (OHE) 473.03
Sta. 21+99.29

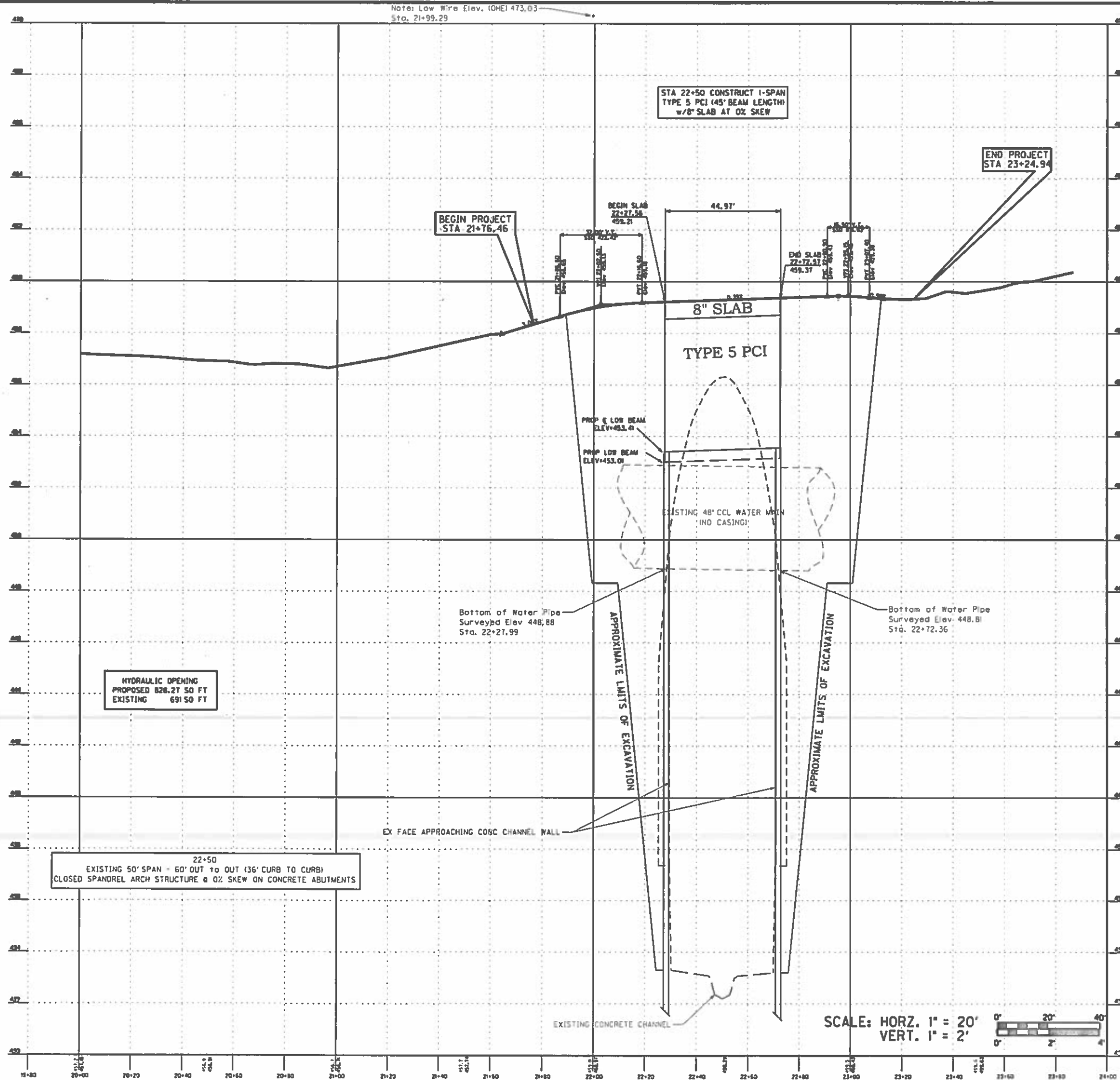

SCALE: HORZ. 1" = 20'
VERT. 1" = 2'



E. KENTUCKY ST OVER BEARGRASS CREEK
PROFILE
PCI

FILE NAME: C:\PWORK\AMANDA.DESMOND\052873\PROFILE ALT 1 - P.L&G 2.DGN
USER: Amanda.Desmond
DATE PLOTTED: June 22, 2018