



# Public Information Meeting

## KY 245 Widening Project from I-65 to Clermont

### Bullitt County

#### KYTC Item # 5-8509.00



July 26, 2011 - 5:00 p.m. to 7:00 p.m.  
Bernheim Middle School  
700 Audubon Drive, Shepherdsville, KY

### Purpose of Tonight's Meeting

The primary goal of tonight's meeting is to gather information and help define the most appropriate option for widening the roadway between I-65 and Clermont. Three alternatives are on display showing various widening options, typical section choices and access control scenarios. So far, the Project Team has used information collected over the course of the project to develop potential widening options. Tonight, we would like to hear what you think of these potential improvements. Your input is critical.

### General Alternatives under Consideration

KY 245 currently has two 12-foot wide lanes with 10-foot wide paved shoulders. Future traffic forecasts indicate KY 245 will likely need widened to four lanes (two lanes in each direction).

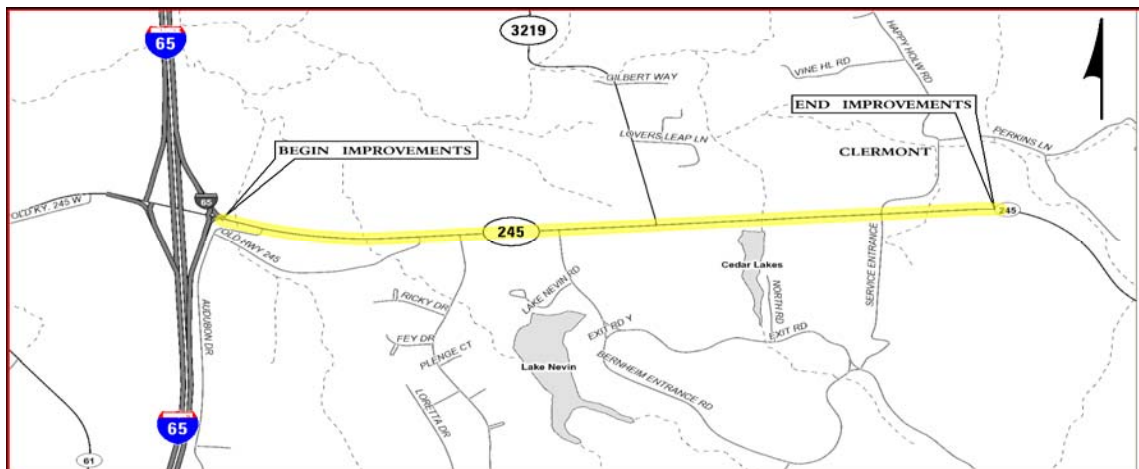

*Location of Proposed Widening*

In addition to being a regional corridor to the City of Bardstown from I-65, this section of KY 245 is considered the entrance to the west end of the Kentucky Bourbon Trail. The area has significant institutions and tourist destinations (the Bernheim Arboretum, Jim Beam Distillery, The Boy Scout Camp, Bernheim Middle School and the Bullitt County Fairgrounds) near the interchange that attract local traffic, visitors and travelers from I-65.

### What We Need from You

Please review the information presented in this handout and on the exhibits displayed around the room. If you have any questions, representatives from the Kentucky Transportation Cabinet are wearing name tags and are here to answer any questions and address any concerns you have. Once you have reviewed the information and asked any questions, please let us know what you think by filling out the project questionnaire.

**Your input is critical to the success of this project!**

**For more information, please visit us on the web:**  
**<http://www.transportation.ky.gov/D5/D5.asp>**

## Purpose of the Widening Project

***The purpose of the KY 245 Widening Project is to provide an improved transportation facility to meet the additional traffic demand forecasted to occur and accommodate any existing or future developments, and/or tourist destinations along the corridor. KY 245 leading southward from its interchange with I-65 is the major link between I-65 and the City of Bardstown, and the western entrance to the Kentucky Bourbon Trail.***

The purpose of this public information meeting is to identify community concerns and evaluate feasible alternatives to meet future traffic demands between I-65 and Clermont. The information gathered tonight is intended to help define the preferred alternative following Federal requirements as defined in the National Environmental Policy Act (NEPA).



Currently the roadway is a two lane minor rural arterial. Traffic volumes have increased from 9,520 vehicles per day in 1991 to 12,800 vehicles per day in 2007 and are expected to continue to grow to 22,505 vehicles per day by 2030.

There are several planned or potential developments that could affect the future travel demand in the KY 245 corridor. The Jim Beam Distillery, located on Happy Hollow Road, is currently a significant tourist attraction drawing approximately 80,000 tourists annually. The distillery is in the process of expanding its existing tourism venue and is planning to accommodate up to 200,000 annual visitors in the future. Additionally, the Kentucky Community & Technical College is exploring the possibility of the development of a Bullitt County campus west of I-65, and a proposed Hotel development is planned on the North side of KY 245 next to I-65 interchange, which is expected to increase current volumes. Local officials indicated the need to improve access to local institutions and accommodate anticipated tourism and economic development.

The proposed road is expected to provide a safe and efficient facility and address the traffic demand generated by future developments and the continued growth of the tourist center.

With commercial development expected along the corridor, accommodating access to this future development in a manner that maintains efficiency and safety along KY 245 is critical, and access management concepts have been explored to achieve these goals. Access management is the process of balancing the competing needs of traffic movement and land access. The goal is to provide necessary access for land development while preserving safe operation and mobility along the highway. Controlling access by the use of a raised or depressed median is intended to reduce the number of conflict points on KY 245 and subsequently improve mobility and safety.

Between I-65 and Clermont, various widening options are being considered: (1) a divided four lane section with two lanes in each direction and a raised 20' median, (2) a divided four lane section with two lanes in each direction and a depressed 40' median, and (3) a five lane section with a shared center left turn lane to be used in dense areas of access points.



**Five lanes with center left-turn lane**



**Four lanes with raised median**

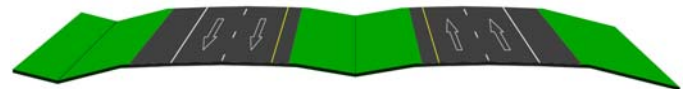

**Four lanes with depressed median**

### **Send comments or questions to:**

Patrick Matheny, P.E. Phone: (502) 210-5400  
Department of Highways Fax: (502) 210-5498  
8310 Westport Road Email: [patrick.matheny@ky.gov](mailto:patrick.matheny@ky.gov)  
Louisville, KY 40242

**Questionnaires will be received at the meeting or by mail through August 10, 2011.**