



CALL NO. 413

CONTRACT ID. 222901

WOLFE COUNTY

FED/STATE PROJECT NUMBER 119GR22M013-FE02

DESCRIPTION WOLFE COUNTY SUPERSTRUCTURE REPLACEMENTS.

WORK TYPE BRIDGE SUPERSTRUCTURE REPLACEMENT

PRIMARY COMPLETION DATE 11/15/2022

LETTING DATE: January 27,2022

Sealed Bids will be received electronically through the Bid Express bidding service until 10:00 am EASTERN STANDARD TIME January 27,2022. Bids will be publicly announced at 10:00 am EASTERN STANDARD TIME.

NO PLANS ASSOCIATED WITH THIS PROJECT.

REQUIRED BID PROPOSAL GUARANTY: Not less than 5% of the total bid.

TABLE OF CONTENTS

PART I	SCOPE OF WORK
	<ul style="list-style-type: none">• PROJECT(S), COMPLETION DATE(S), & LIQUIDATED DAMAGES• CONTRACT NOTES• STATE CONTRACT NOTES• SPECIAL NOTE(S) APPLICABLE TO PROJECT• LIQUIDATED DAMAGES• TRAFFIC CONTROL PLAN• MATERIAL SUMMARY• BRIDGE DRAWINGS
PART II	SPECIFICATIONS AND STANDARD DRAWINGS
	<ul style="list-style-type: none">• SPECIFICATIONS REFERENCE• SUPPLEMENTAL SPECIFICATION
PART III	EMPLOYMENT, WAGE AND RECORD REQUIREMENTS
	<ul style="list-style-type: none">• LABOR AND WAGE REQUIREMENTS• EXECUTIVE BRANCH CODE OF ETHICS• KENTUCKY EQUAL EMPLOYMENT OPPORTUNITY ACT OF 1978 LOCALITY / STATE• PROJECT WAGE RATES / STATE FUNDED
PART IV	INSURANCE
PART V	BID ITEMS

PART I
SCOPE OF WORK

ADMINISTRATIVE DISTRICT - 10

CONTRACT ID - 222901

119GR22M013-FE02

COUNTY - WOLFE

PCN - MB11912612201

FE02 119 1261 B00028N

KY 1261 (MP 3.955). BRIDGE OVER HOLLY CREEK.BRIDGE DECK RESTORATION & WATERPROOFING

GEOGRAPHIC COORDINATES LATITUDE 37:40:39.00 LONGITUDE 83:28:04.00

PCN - MB11912612202

FE02 119 1261 B00029N

KY 1261 (MP 2.970). BRIDGE OVER SPRING BRANCH.BRIDGE DECK RESTORATION & WATERPROOFING

GEOGRAPHIC COORDINATES LATITUDE 37:39:50.00 LONGITUDE 83:28:03.00

COMPLETION DATE(S):

COMPLETED BY 11/15/2022

APPLIES TO ENTIRE PROPOSAL

30 CALENDAR Days

APPLIES TO 119B00028N

30 CALENDAR Days

APPLIES TO 119B00029N

CONTRACT NOTES

PROPOSAL ADDENDA

All addenda to this proposal must be applied when calculating bid and certified in the bid packet submitted to the Kentucky Department of Highways. Failure to use the correct and most recent addenda may result in the bid being rejected.

BID SUBMITTAL

Bidder must use the Department's electronic bidding software. The Bidder must download the bid file located on the Bid Express website (www.bidx.com) to prepare a bid packet for submission to the Department. The bidder must submit electronically using Bid Express.

JOINT VENTURE BIDDING

Joint venture bidding is permissible. All companies in the joint venture must be prequalified in one of the work types in the Qualifications for Bidders for the project. The bidders must get a vendor ID for the joint venture from the Division of Construction Procurement and register the joint venture as a bidder on the project. Also, the joint venture must obtain a digital ID from Bid Express to submit a bid. A joint bid bond of 5% may be submitted for both companies or each company may submit a separate bond of 5%.

UNDERGROUND FACILITY DAMAGE PROTECTION

The contractor shall make every effort to protect underground facilities from damage as prescribed in the Underground Facility Damage Protection Act of 1994, Kentucky Revised Statute KRS 367.4901 to 367.4917. It is the contractor's responsibility to determine and take steps necessary to be in compliance with federal and state damage prevention directives. When prescribed in said directives, the contractor shall submit Excavation Locate Requests to the Kentucky Contact Center (KY811) via web ticket entry. The submission of this request does not relieve the contractor from the responsibility of contacting non-member facility owners, whom shall be contacted through their individual Protection Notification Center. Non-compliance with these directives can result in the enforcement of penalties.

REGISTRATION WITH THE SECRETARY OF STATE BY A FOREIGN ENTITY

Pursuant to KRS 176.085(1)(b), an agency, department, office, or political subdivision of the Commonwealth of Kentucky shall not award a state contract to a person that is a foreign entity required by [KRS 14A.9-010](#) to obtain a certificate of authority to transact business in the Commonwealth ("certificate") from the Secretary of State under [KRS 14A.9-030](#) unless the person produces the certificate within fourteen (14) days of the bid or proposal opening. If the foreign entity is not required to obtain a certificate as provided in [KRS 14A.9-010](#), the foreign entity should identify the applicable exception. Foreign entity is defined within [KRS 14A.1-070](#).

For all foreign entities required to obtain a certificate of authority to transact business in the Commonwealth, if a copy of the certificate is not received by the contracting agency within the time frame identified above, the foreign entity's solicitation response shall be deemed non-responsive or the awarded contract shall be cancelled.

Businesses can register with the Secretary of State at <https://secure.kentucky.gov/sos/ftbr/welcome.aspx>.

SPECIAL NOTE FOR PROJECT QUESTIONS DURING ADVERTISEMENT

Questions about projects during the advertisement should be submitted in writing to the Division of Construction Procurement. This may be done by fax (502) 564-7299 or email to kytc.projectquestions@ky.gov. The Department will attempt to answer all submitted questions. The Department reserves the right not to answer if the question is not pertinent or does not aid in clarifying the project intent.

The deadline for posting answers will be 3:00 pm Eastern Daylight Time, the day preceding the Letting. Questions may be submitted until this deadline with the understanding that the later a question is submitted, the less likely an answer will be able to be provided.

The questions and answers will be posted for each Letting under the heading "Questions & Answers" on the Construction Procurement website (www.transportation.ky.gov/contract). The answers provided shall be considered part of this Special Note and, in case of a discrepancy, will govern over all other bidding documents.

HARDWOOD REMOVAL RESTRICTIONS

The US Department of Agriculture has imposed a quarantine in Kentucky and several surrounding states, to prevent the spread of an invasive insect, the emerald ash borer. Hardwood cut in conjunction with the project may not be removed from the state. Chipping or burning on site is the preferred method of disposal.

INSTRUCTIONS FOR EXCESS MATERIAL SITES AND BORROW SITES

Identification of excess material sites and borrow sites shall be the responsibility of the Contractor. The Contractor shall be responsible for compliance with all applicable state and federal laws and may wish to consult with the US Fish and Wildlife Service to seek protection under Section 10 of the Endangered Species Act for these activities.

ACCESS TO RECORDS

The contractor, as defined in KRS 45A.030 (9) agrees that the contracting agency, the Finance and Administration Cabinet, the Auditor of Public Accounts, and the Legislative Research Commission, or their duly authorized representatives, shall have access to any books, documents, papers, records, or other evidence, which are directly pertinent to this contract for the purpose of financial audit or program review. Records and other prequalification information confidentially

disclosed as part of the bid process shall not be deemed as directly pertinent to the contract and shall be exempt from disclosure as provided in KRS 61.878(1)(c). The contractor also recognizes that any books, documents, papers, records, or other evidence, received during a financial audit or program review shall be subject to the Kentucky Open Records Act, KRS 61.870 to 61.884.

In the event of a dispute between the contractor and the contracting agency, Attorney General, or the Auditor of Public Accounts over documents that are eligible for production and review, the Finance and Administration Cabinet shall review the dispute and issue a determination, in accordance with Secretary's Order 11-004.

April 30, 2018

SPECIAL NOTE FOR RECIPROCAL PREFERENCE

RECIPROCAL PREFERENCE TO BE GIVEN BY PUBLIC AGENCIES TO RESIDENT BIDDERS

By reference, KRS 45A.490 to 45A.494 are incorporated herein and in compliance regarding the bidders residency. Bidders who want to claim resident bidder status should complete the Affidavit for Claiming Resident Bidder Status along with their bid in the electronic bidding software. Submittal of the Affidavit should be done along the bid in Bid Express.

April 30, 2018

**SPECIAL NOTE FOR BRIDGE OVERLAY APPROACH PAVMENT FOR BRIDGE
119B00029N (Drawing Number 28463)**

- I. DESCRIPTION.** Perform all work in accordance with the Kentucky Transportation Cabinet, Department of Highway's 2012 Standard Specifications for Road and Bridge Construction and applicable Supplemental Specifications, the Standard Drawings, this Note, and the attached detail drawings. Section references are to the Standard Specifications.

This work consists of the following: (1) Furnish all labor, materials, tools, and equipment; (2) Complete asphalt approach pavement; (3) Maintain and control traffic; and (4) Any other work specified as part of this contract.

All construction will be in accordance with Section 606 unless otherwise specified.

II. MATERIALS.

A. Bituminous Asphalt. Use CL2 ASPH SURF 0.38D PG 64-22 for surface and CL2 ASPH BASE .75D PG 64-22 for any base required at ends of bridge.

B. DGA and Structure Granular Backfill. DGA to conform to Section 805 and Structure Granular Backfill to conform to Section 805.11.

III. CONSTRUCTION.

A. Asphalt Approach Pavement. Mill each existing asphalt approach for a distance of 100' from the bridge end. Remove the bituminous material uniformly by making an edge key, so as to provide a smooth transition to the finished bridge when a new bituminous overlay of compacted depth of approximately 1½" is added to the approaches. The grinding depth may vary depending of the condition of the existing approach and final elevation of bridge end. Dispose of all removed material away from the site. Provide DGA, Base, and structure granular backfill as necessary to fill in excavation behind each end of the bridge required to install new superstructures. All costs incidental to unit price bid for Bridge Overlay Approach Pavement. Wrap structure granular backfill in Class 2 geotextile fabric. All costs incidental to unit price bid for Bridge Overlay Approach Pavement.

IV. MEASUREMENT. See Section 606 and the following:

A. Asphalt Approach Pavement. The Department will measure the quantity in square yards, which shall include all labor, equipment, and material needed to complete this work.

V. PAYMENT. See Section 606 and the following:

A. Asphalt Approach Pavement. The Department will make payment for the completed and accepted quantity of this work under the bid item #03304 "BRIDGE OVERLAY APPROACH PAVEMENT".

SPECIAL NOTE FOR CONCRETE SEALING

These Notes or designated portions thereof, apply where so indicated on the plans, proposals or bidding instruction.

- I. DESCRIPTION.** Perform all work in accordance with the Department's 2019 Standard Specifications, and applicable Supplemental Specifications, the attached sketches, and these Notes. Section references are to the Standard Specifications.

This work consists of: (1) Furnish all labor, materials, tools, and equipment; (2) Clean the bridge deck; (3) Seal the bridge deck; (4) Maintain & control traffic; and, (5) Any other work specified as part of this contract.

II. MATERIALS.

- A. Sealer.** Use one of the following:

Product	Supplier
Protectosil BHN	Evonik Industries
Protectosil 300S	Evonik Industries
TK-590-40 Tri-Silane 40%	TK Products
SW-244-100	Chemical Products Industries, Inc.
TK-590-1 MS Tri-Silane	TK Products
MasterProtect H1000	BASF
Aquanil Plus 40	ChemMasters
SIL-ACT ATS-100	Advanced Chemical Technologies
Certivex Penseal BTS 100%	Vexcon
Pentreat 244-40	W.R. Meadows
Aquanil Plus 40A	ChemMasters

- B. Coverage Rate:** Follow all manufacturers recommendations for coverage rates except the application rate must not exceed the square footage coverage rate per gallon of sealer as given in the chart below. If the manufacturer recommends a coverage rate greater than given in the table below, apply sealer at the rate given in the table below for the chosen sealers silane percentage.

% Silane	Coverage rate (ft ² /gallon)
100	300
40	120
20	60

III. CONSTRUCTION.

- A. Curing Compound.** Contrary to Section 609.03.12 of the specifications, curing compound is not to be used on this deck due to potentially causing issues with the concrete sealer. During the deck pour, finishing, and tining operations the Class AA concrete shall be kept continuously moist with the use of a mister until burlap or curing blankets are applied to the surface. At no point should water be pooling or running off the surface or the surface of the concrete be allowed to become dry. After the burlap or curing blankets are installed, cure in accordance with the specifications. Include all costs in the unit price bid for Class AA concrete. Failure to properly cure the concrete in accordance with this note and the specifications may result in weakened or cracked concrete. If the concrete is weakened or cracked due to improper curing, the contractor will be responsible for providing alternates to fix the issues to the Engineer for review and the contractor will be solely responsible for all costs to do so, up to complete replacement. Do not begin any construction on fixing any issues without approval of the Engineer.
- B. Cleaning the Deck.** Dry clean the deck to remove all loose debris. Remove all visible hydrocarbons from the surface with detergent approved by the manufacturer of the deck sealant. Pressure wash all surfaces to be sealed at 2000 to 3000 psi. Install pressure gauges at each wand to verify pressure. Use 30° fan tip or as recommended by the manufacturer of the deck sealant. Hold pressure washing wand a minimum of 45° from the deck with a maximum stand-off distance of 12 inches.
- C. Sealing the Deck.** Allow new concrete to cure a minimum 28 days prior to application of sealer. Monitor weather conditions prior to sealer application. Refer to manufacturer's recommendations for proper ambient conditions. Do not apply sealer if precipitation is anticipated within the time stated by the manufacturer. Allow the deck to dry 24 hours (after washing or rain event) before sealer application. The deck can be reopened to traffic while drying. Sealer must be applied within 48 hours of washing or the deck must be rewashed. Divide the deck into predefined areas of specific square footage to aid in determining usage. Comply with manufacturer's usage recommendation. Using a low

pressure pump, apply sealer and spread evenly with broom or squeegee; do not allow pooling to remain. When each predefined area is complete, measure the amount of sealer used to verify proper usage. After sealing, follow manufacturer's recommended cure time before opening to traffic. On vertical surfaces, apply the sealer in a flooding application from the bottom up, so the material runs down 6 to 8 inches below the spray pattern.

D. Inspection: Monitor all aspects of the project to assure compliance to this specification. Observe and document general conditions during the entirety of the project. Verify that each phase of work has been satisfactorily completed prior to beginning the next phase. Phases are described as follows:

1. Dry cleaning to remove loose debris, verify and document:
 - a. All debris has been removed and disposed of properly.
2. Removal of hydrocarbons, verify and document:
 - a. The manufacturer's recommended detergent is used for removal.
 - b. Hydrocarbons have been satisfactorily removed.
3. Pressure washing, verify and document:
 - a. Washing pressure at the wand.
 - b. Tip size used.
 - c. Wash angle and stand-off distance.
 - d. The deck is satisfactorily cleaned.
4. Sealer application, verify and document:
 - a. Proper cure time for new concrete.
 - b. Deck surface is dry.
 1. Document time since washed.
 2. Was deck opened to traffic after washing?
 - c. Ambient conditions.
 1. Document ambient temperature, surface temperature, relative humidity, and dew point.
 - d. Application and distribution method.
 - e. Coverage to be complete and even.
 - f. Material is not allowed to remain pooled.
 - g. Monitor material usage.
 - h. No traffic until proper cure time is allowed.

IV. MEASUREMENT

- A. Concrete Sealing.** The Department will measure the quantity per square feet of each area sealed.

V. PAYMENT

- A. Concrete Sealing.** Payment at the contract unit price per square feet is full compensation for the following: (1) Furnish all labor, materials, tools, and equipment; (2) Clean the bridge deck; (3) Seal the bridge deck; (4) Maintain & control traffic; and, (5) Any other work specified as part of this contract.

**SPECIAL NOTE FOR CONTRACT COMPLETION DATE AND
PENALTIES ON BRIDGE REPAIR CONTRACTS**

- I. COMPLETION DATE.** The Contractor has the option of selecting the starting date for this Contract. Once selected, notify the Department in writing of the date selected at least two weeks prior to beginning work. All work is to be completed by November 15, 2022. An allotted number of Calendar days are assigned to each structure in this contract as shown below.

<u>STRUCTURE</u>	<u>NO. OF CALENDAR DAYS</u>	<u>COMPLETION DATE</u>
119B00028N	30	November 15, 2022
119B00029N	30	November 15, 2022

Contrary to Section 108.07.03, the Engineer will begin charging calendar days for a structure on the day the Contractor starts work or sets up traffic control on that particular structure.

A penalty of \$500 will be assessed the Contractor for each day that work extends past the allotted number of calendar days for any given structure.

All construction must be completed in accordance with the weather limitations specified in Section 606 and/or Section 601 as applicable. No extension of Contract time will be granted due to inclement weather or temperature limitations that occur due to starting work on the Contract or a structure late in the construction season.

SPECIAL NOTE FOR TRAFFIC CONTROL ON BRIDGE REPAIR CONTRACTS

I. TRAFFIC CONTROL GENERAL

Except as provided herein, traffic shall be maintained in accordance with the 2019 Standard Specifications, Section 112. Except for the roadway and traffic control bid items listed, all items of work necessary to maintain and control traffic will be paid at the lump sum bid price to “Maintain and Control Traffic”.

Contrary to Section 106.01, traffic control devices used on this project may be new or used in new condition, at the beginning of the work and maintained in like new condition until completion of the work.

II. TRAFFIC COORDINATOR

Furnish a Traffic Coordinator as per Section 112. The Traffic Coordinator shall inspect the project maintenance of traffic, at least three times daily, or as directed by the Engineer, during the Contractor’s operations and at any time a lane closure is in place. The personnel shall have access on the project to a radio or telephone to be used in case of emergencies or accidents.

The Traffic Coordinator shall report all incidents throughout the work zone to the Engineer on the project. The Contractor shall furnish the name and telephone number where the Traffic Coordinator can be contacted at all times.

III. SIGNS

Contrary to Section 112.04.02, only long term signs (sign intended to be continuously in place for more than 3 days) will be measured for payment; short term signs (signs intended to be left in place for 3 days or less) will not be measured for payment but will be incidental to Maintain and Control Traffic.

The contractor is to install warning signs for wide loads in advance of the bridge under the direction of the Engineer. The Department will not measure installation, maintenance, or removal for payment, and will consider these incidentals to Maintain and Control Traffic.

IV. PROJECT PHASING & CONSTRUCTION PROCEDURES

Each bridge shall be closed in accordance with the following detour plan. Bridges shall not be closed at the same time, for any duration. All barricades, signage, and other costs associated with closing each bridge shall be paid under the bid item, MAINTAIN & CONTROL TRAFFIC.

**WOLFE COUNTY
KY 1261 BRIDGES
SUPER-STRUCTURE REPLACEMENT
MAINTENANCE OF TRAFFIC PLANS
DETOUR SIGNING DETAILS**

**SINGLE POST SIGNS- A-L
DOUBLE POST SIGNS- L-P**

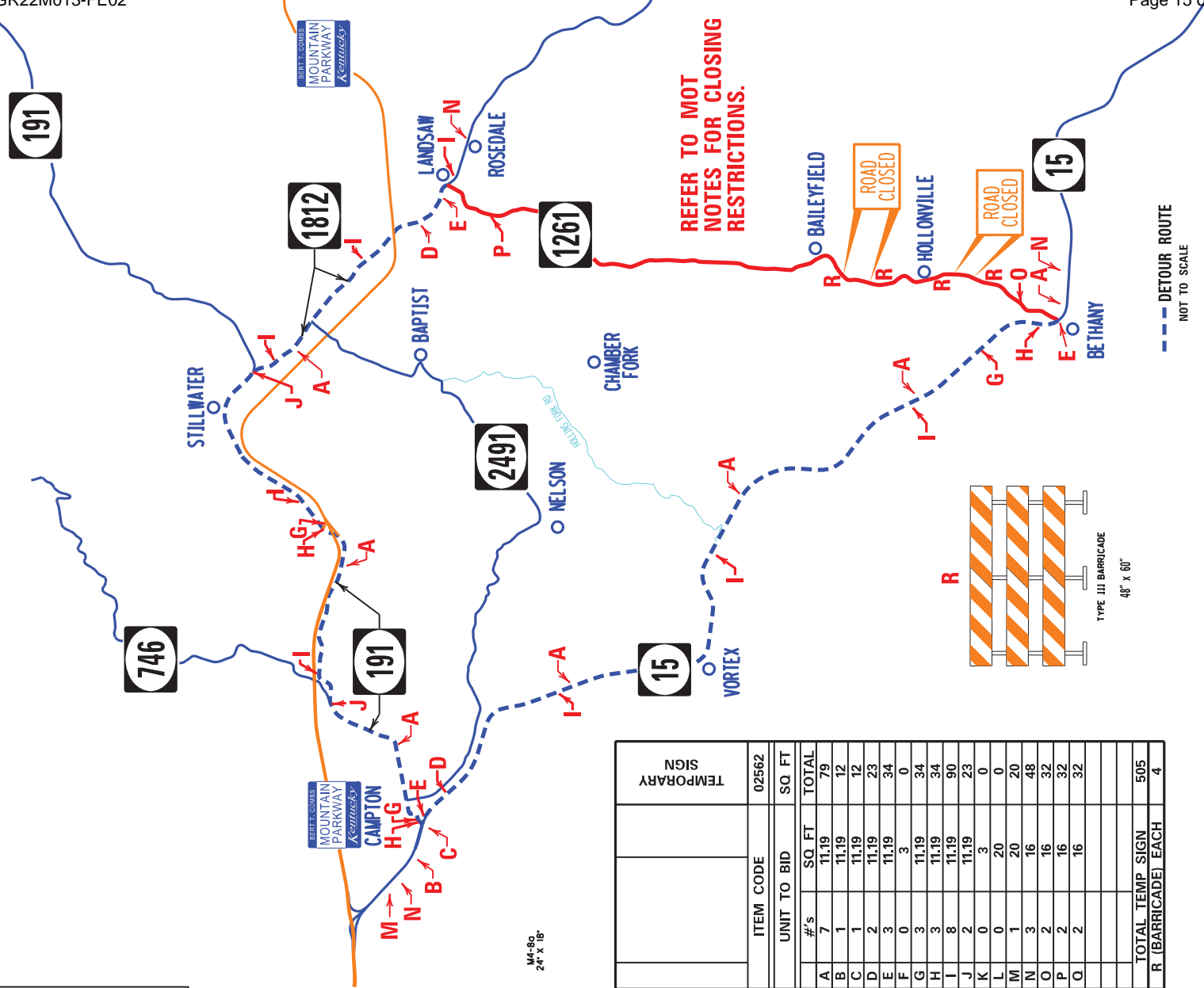
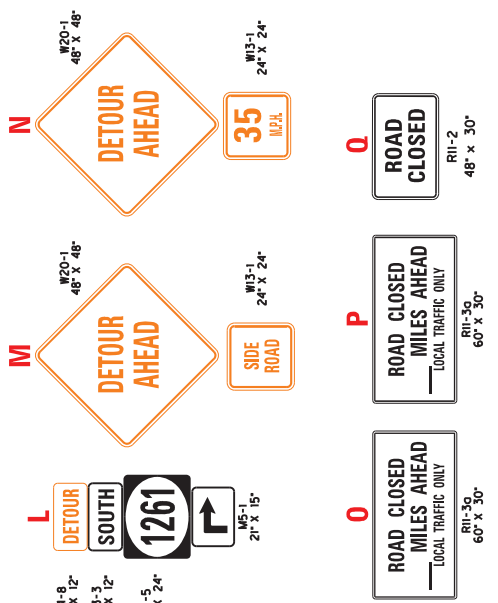
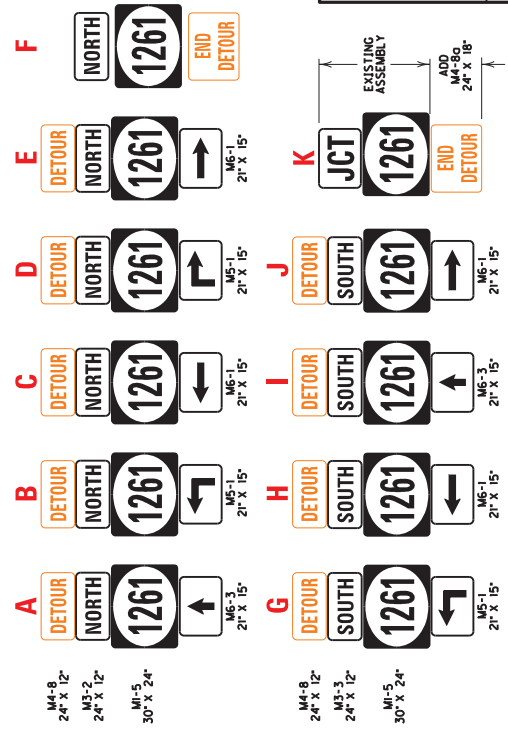

ITEM CODE	UNIT TO BID		SQ. FT.
	#/s	SQ. FT.	
A	7	11.19	79
B	1	11.19	12
C	1	11.19	12
D	2	11.19	23
E	3	11.19	34
F	0	3	0
G	3	11.19	34
H	3	11.19	34
I	8	11.19	90
J	2	11.19	23
K	0	3	0
L	0	20	0
M	1	20	20
N	3	16	48
O	2	16	32
P	2	16	32
Q	2	16	32
TOTAL TEMP SIGN			505
R (BARRICADE) EACH			4

MATERIAL SUMMARY

CONTRACT ID: 222901

119GR22M013-FE02

MB11912612201

KY 1261 (MP 3.955). BRIDGE OVER HOLLY CREEK. BRIDGE DECK RESTORATION & WATERPROOFING.

Project Line No	Bid Code	DESCRIPTION	Quantity	Unit
0005	00001	DGA BASE	11.00	TON
0010	00221	CL2 ASPH BASE 0.75D PG64-22	22.00	TON
0015	00301	CL2 ASPH SURF 0.38D PG64-22	47.80	TON
0020	02351	GUARDRAIL-STEEL W BEAM-S FACE	32.50	LF
0025	02355	GUARDRAIL-STEEL W BEAM-S FACE A	87.50	LF
0030	02360	GUARDRAIL TERMINAL SECTION NO 1	2.00	EACH
0035	02367	GUARDRAIL END TREATMENT TYPE 1	2.00	EACH
0040	02399	EXTRA LENGTH GUARDRAIL POST	52.00	EACH
0045	02650	MAINTAIN & CONTROL TRAFFIC - APPLIES TO 119B00028N	1.00	LS
0050	03299	ARMORED EDGE FOR CONCRETE	56.00	LF
0055	03304	BRIDGE OVERLAY APPROACH PAVEMENT	533.33	SQYD
0060	08100	CONCRETE-CLASS A	1.20	CUYD
0065	08104	CONCRETE-CLASS AA	15.00	CUYD
0070	08150	STEEL REINFORCEMENT	252.00	LB
0075	08151	STEEL REINFORCEMENT-EPOXY COATED	2,041.00	LB
0080	08301	REMOVE SUPERSTRUCTURE	1.00	LS
0085	08662	PRECAST PC BOX BEAM CB17-48	229.50	LF
0090	20191ED	OBJECT MARKER TY 3	2.00	EACH
0095	23378EC	CONCRETE SEALING	952.00	SQFT
0100	25099ED	DEEP BEAM BRIDGE GUARDRAIL	66.30	LF
0105	40067	PAVEMENT MILLING	66.60	TON
0110	02569	DEMOBILIZATION	1.00	LS

MATERIAL SUMMARY

CONTRACT ID: 222901

119GR22M013-FE02

MB11912612202

KY 1261 (MP 2.970). BRIDGE OVER SPRING BRANCH. BRIDGE DECK RESTORATION & WATERPROOFING.

Project Line No	Bid Code	DESCRIPTION	Quantity	Unit
0115	02351	GUARDRAIL-STEEL W BEAM-S FACE	24.40	LF
0120	02355	GUARDRAIL-STEEL W BEAM-S FACE A	83.20	LF
0125	02360	GUARDRAIL TERMINAL SECTION NO 1	2.00	EACH
0130	02367	GUARDRAIL END TREATMENT TYPE 1	2.00	EACH
0135	02650	MAINTAIN & CONTROL TRAFFIC - APPLIES TO 119B00029N	1.00	LS
0140	03299	ARMORED EDGE FOR CONCRETE	55.40	LF
0145	03304	BRIDGE OVERLAY APPROACH PAVEMENT	533.33	SQYD
0150	08019	CYCLOPEAN STONE RIP RAP	200.00	TON
0155	08100	CONCRETE-CLASS A	2.40	CUYD
0160	08104	CONCRETE-CLASS AA	12.40	CUYD
0165	08150	STEEL REINFORCEMENT	252.00	LB
0170	08151	STEEL REINFORCEMENT-EPOXY COATED	1,649.00	LB
0175	08301	REMOVE SUPERSTRUCTURE	1.00	LS
0180	08661	PRECAST PC BOX BEAM CB12-48	186.00	LF
0185	20191ED	OBJECT MARKER TY 3	2.00	EACH
0190	23378EC	CONCRETE SEALING	772.00	SQFT
0195	25099ED	DEEP BEAM BRIDGE GUARDRAIL	52.20	LF
0200	02569	DEMOBILIZATION	1.00	LS

119B00028N
KY 1261 over Holly Creek

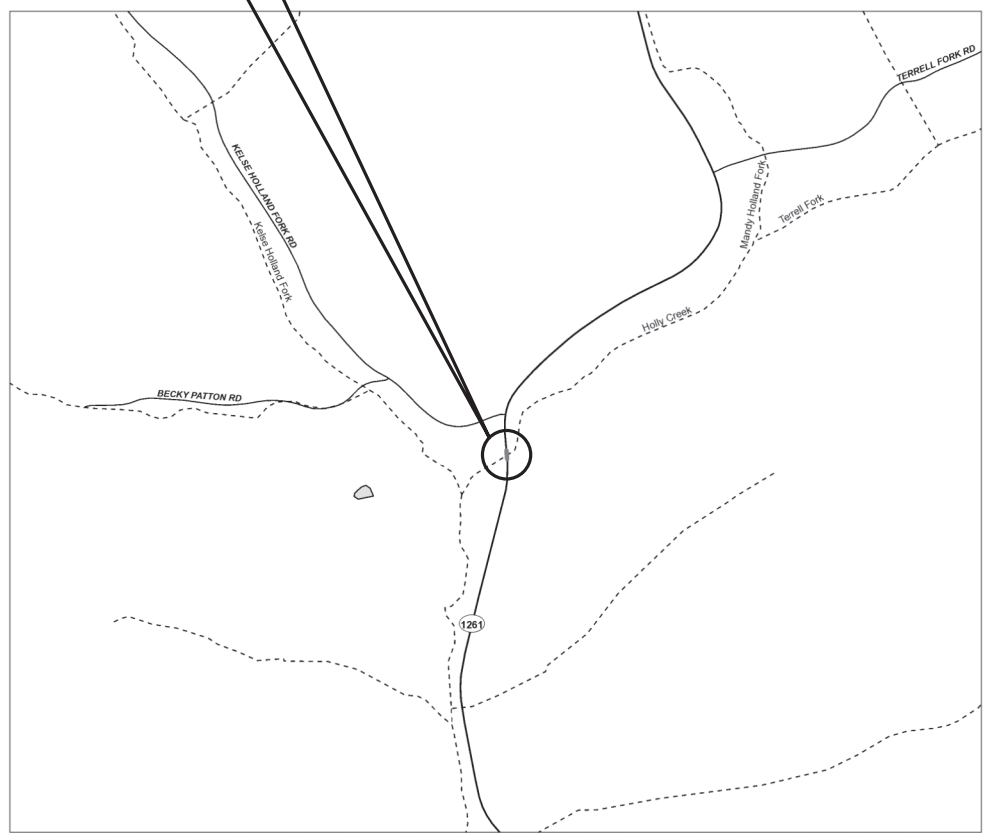
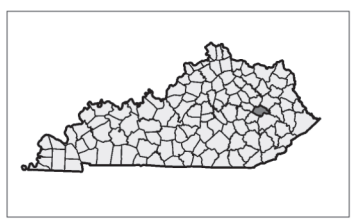

LOCATION MAP WOLFE COUNTY

Commonwealth of Kentucky	
DEPARTMENT OF HIGHWAYS	
COUNTY	
WOLFE	
LOCATION MAP	
PREPARED BY	SHEET NO.
Division of Structural Design	S1
	DRAWING NO.
	28456

GENERAL NOTES

SPECIFICATIONS: All references to the Specifications are to the current edition of the Kentucky Department of Highways Standard Specifications for Road and Bridge Construction with current Supplemental Specifications. All references to the AASHTO Specifications are to the current edition of the AASHTO LRFD Bridge Design Specs, with interims.

DESIGN LOAD: This bridge is designed for a KYHL-93 live load. The KYHL-93 live load is arrived at by increasing the standard HL-93 truck and lane loads as specified in the AASHTO Specifications by 25%.

FUTURE WEARING SURFACE: This Structure is designed for a 60 PSF future wearing surface load.

DESIGN STRESSES: Concrete Class "A" ~ f'c = 3500 psi
Concrete Class "AA" ~ f'c = 4000 psi
Steel Reinforcement ~ Fy = 60,000 psi
Structural Steel Yield Strength ~Fy = 50,000 psi

DESIGN METHOD: All reinforced concrete members are designed by the load and resistance factor method as specified in the current AASHTO Specifications.

WIND LOAD: This bridge is designed for a wind load based on a wind velocity of 100 mph.

REINFORCEMENT: Dimensions shown from the face of concrete to bars are to center of bars unless otherwise shown. Spacing of bars is from center to center of bars. Clear distance to face of concrete is 2", unless otherwise noted. Any reinforcing bars designated by suffix (e) in the plans shall be epoxy coated in accordance with section 811.10 of the Standard Specifications. Any reinforcing bars designated by suffix (s) in a bill of reinforcement shall be considered a stirrup for purposes of bend diameters.

BEVELED EDGES: Bevel all exposed edges $\frac{3}{4}$ ", unless otherwise noted.

COMPLETION OF THE STRUCTURE: The Contractor is required to complete the structure in accordance with the plans and specifications. Material, labor or construction operations, not otherwise specified, are to be included in the bid item most appropriate to the work involved. This may include cofferdams, shoring, excavations, backfilling, removal of all or parts of existing structures, phase construction, incidental materials, labor or anything else required to complete the structure.

DIMENSIONS: Dimensions are for a normal temperature of 60 degrees Fahrenheit. Layout dimensions are horizontal dimensions.

CONCRETE SEALER: Seal deck in accordance with the special note for concrete sealing.

JOINT WATERPROOFING: In addition to the standard drawing, all joints are to be sealed including those between beams.

SHOP DRAWINGS: Submit shop drawings that are required by the plans and specifications directly to the Division of Structural Design. If any changes in the design plans are proposed by a fabricator or supplier, submit those changes to the Department through the Contractor.

DIMENSIONS & ELEVATIONS: The existing bridge drawing number is 13892. All dimensions and elevations given in these plans are based on field surveyed data and dimensions from the old plans. Prior to beginning work or ordering any materials, the contractor shall field verify all dimensions and elevations. No claim will be honored by the Department of Highways regarding site conditions.

SITE INSPECTION: The contractor shall familiarize themselves with all conditions at the bridge site. Submission of a bid shall be considered evidence that the contractor has performed a site visit and is familiar with all aspects of the existing bridge and requirements in these plans. The cabinet will not consider any claims due to changed site conditions.

DAMAGE TO STRUCTURE: The contractor shall bear all responsibility and expense for any and all damage to the structure during repair work, even to the removal and replacement of the entire structure, should it be damaged by the contractors actions or inaction.

Applicable Standard Drawings

BDP-001-06	Box Beam General Notes and References
BDP-002-03	Box Beam Bearing Details
BDP-003-03	Box Beam Miscellaneous Details
BDP-004-04	Box Beam Tension Rod Details
BDP-007-05	Box Beam B17 and CB17 Details
BGX-006-10	Stencils for Structures
BGX-022	Joint Waterproofing
BJE-001-14	Neoprene Expansion Dams and Armored Edges
RBR-001-13	Steel Beam Guardrail (W Beam)
RBR-005-11	Guardrail Components
RBR-010-06	Guardrail Terminal Sections
RBR-015-06	Steel Guardrail Posts
RBR-020-07	Guardrail End Treatment Type I

Commonwealth of Kentucky	
DEPARTMENT OF HIGHWAYS	
COUNTY	
WOLFE	
GENERAL NOTES	
PREPARED BY	SHEET NO.
Division of	S2
Structural Design	DRAWING NO.
	28456



BRIDGE PLAN

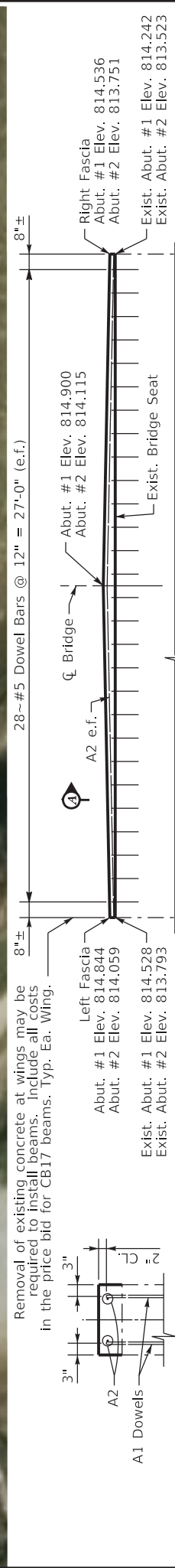

NOTE:
9 ft. guardrail posts required throughout guardrail installation. All costs included in the bid item for extra length posts.

NEW BRIDGE SEATS

SECTION A-A

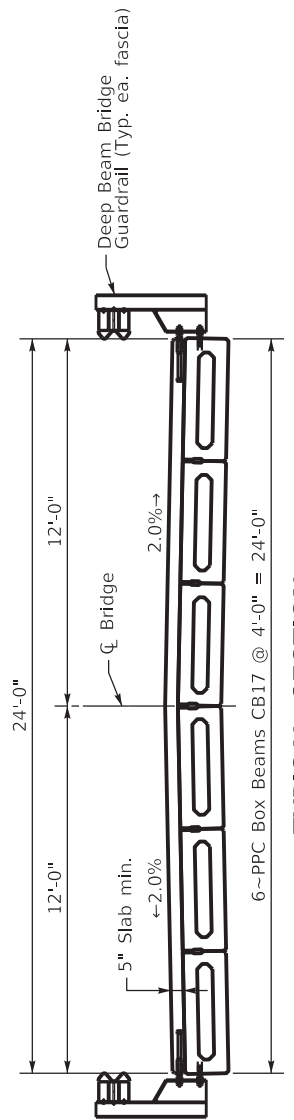

TYPICAL SECTION

BILL OF REINFORCEMENT					
MARK	TYPE	NO.	SIZE	LENGTH	LOCATION
A1	Str.	112	5	1- 2	Dowels
A2	Str.	4	5	27- 7	New Seat

BRIDGE NO.
119B00028N

Commonwealth of Kentucky DEPARTMENT OF HIGHWAYS	
COUNTY WOLFE	
LAYOUT	
PREPARED BY Division of Structural Design	SHEET NO. 28456

BILL OF REINFORCEMENT					
MARK	TYPE	NO.	SIZE	LENGTH	LOCATION
S1e	Str.	38	5	27'-7"	Slab
S2e	Str.	24	5	37'-10"	Slab

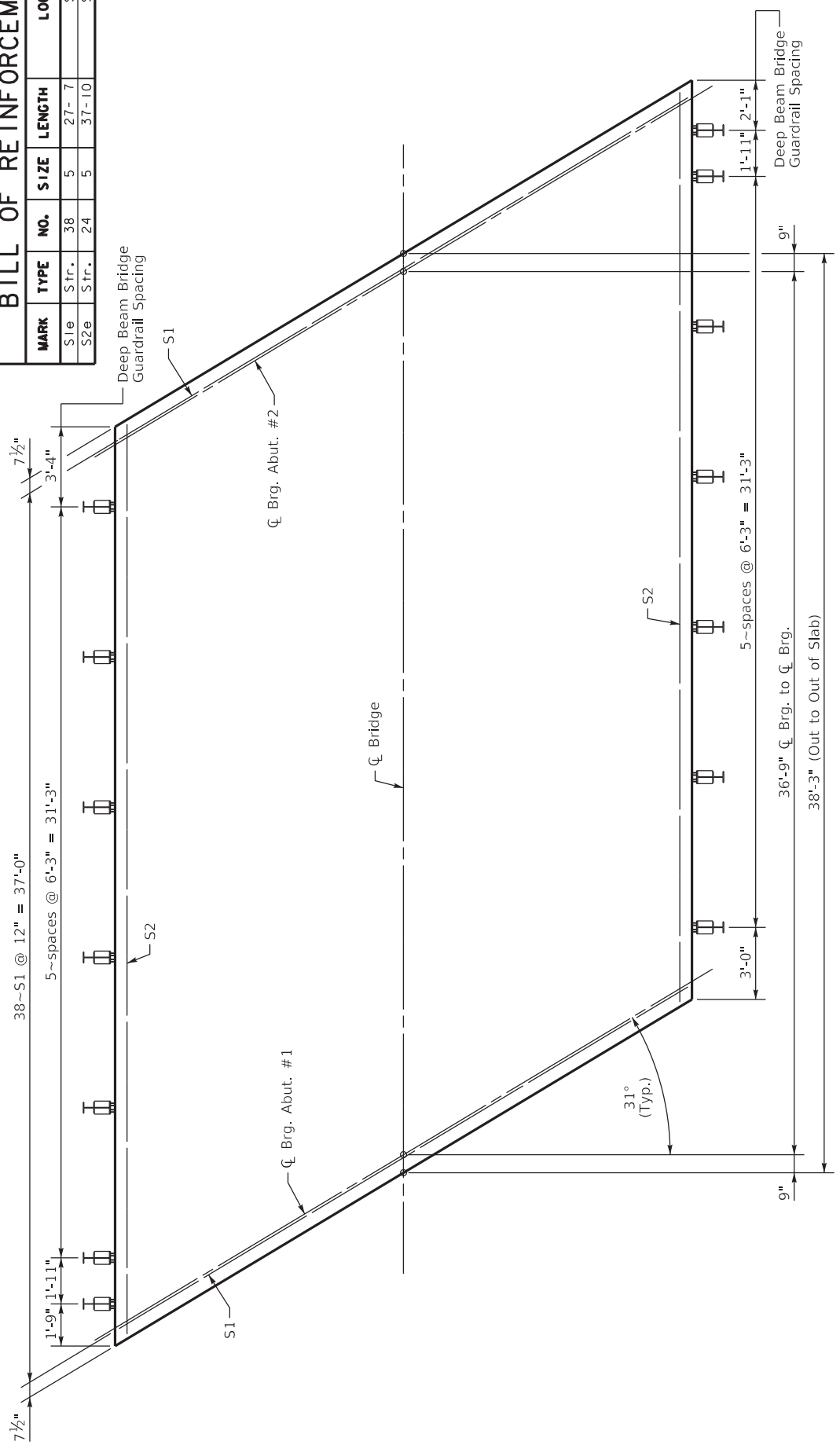

NOTE:
Slab thickness varies from 5.6" at ends to 5" in the center to account for beam camber and provide a smooth grade across bridge. All quantities included in estimate of quantities bid.

SLAB PLAN

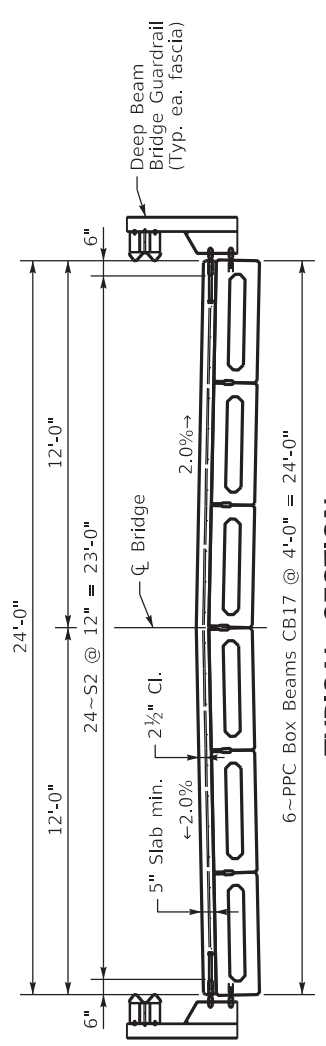

TYPICAL SECTION

Commonwealth of Kentucky DEPARTMENT OF HIGHWAYS	
COUNTY WOLFE	
SUPERSTRUCTURE	
PREPARED BY Division of Structural Design	
SHEET NO. 54	DRAWING NO. 28456

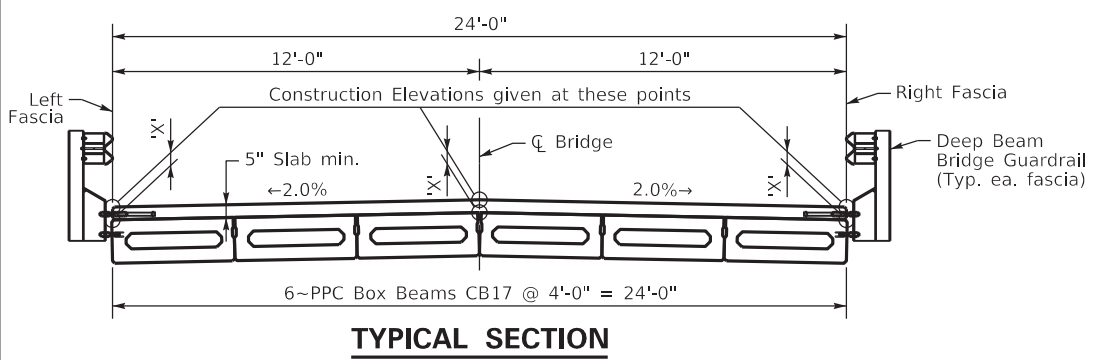

TYPICAL SECTION

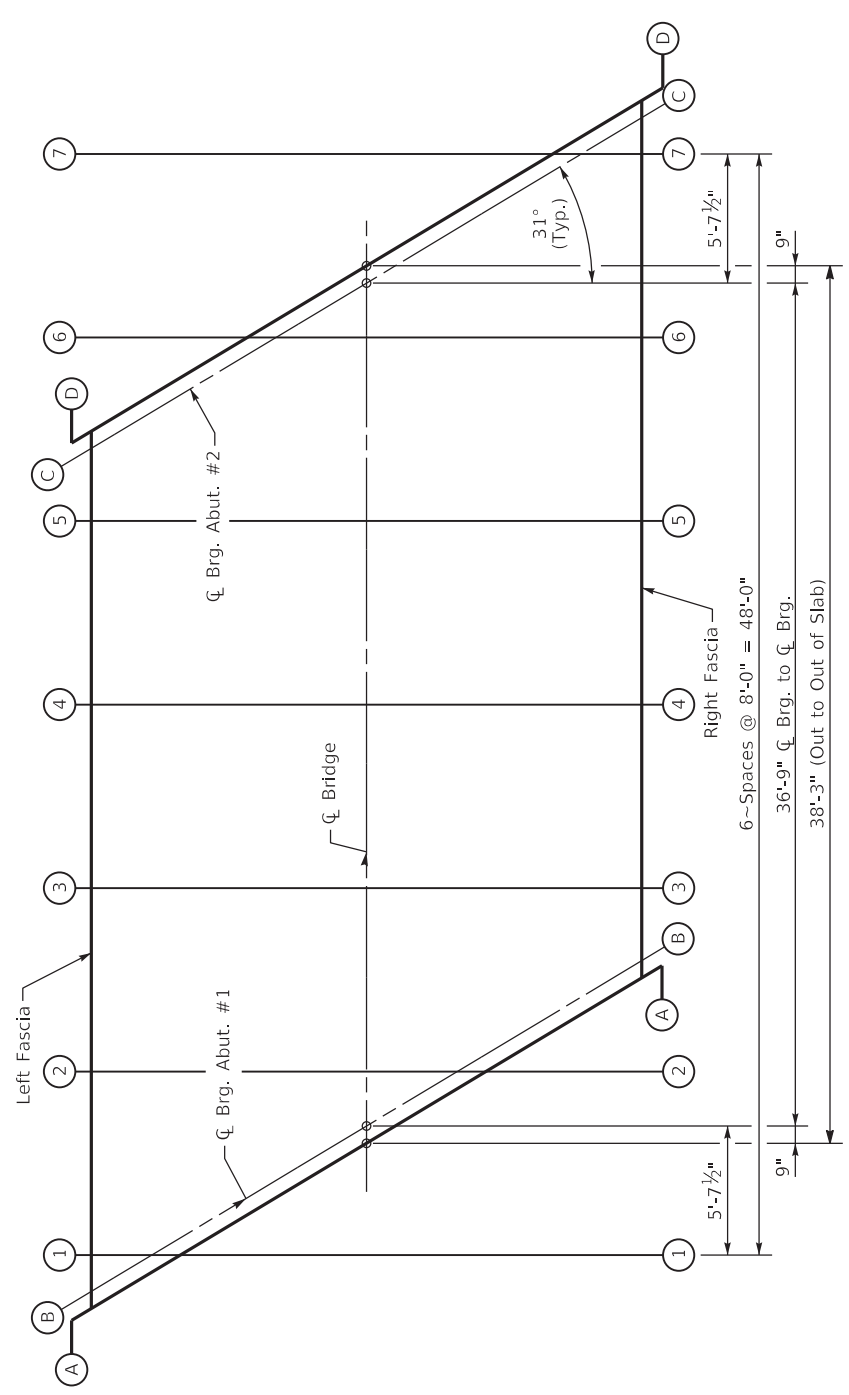

GRID LAYOUT

NOTES FOR ELEVATIONS TAKEN ON PRESTRESSED CONCRETE BOX BEAMS

Take elevations on top of beam at points indicated after the beams have been laterally tensioned and grouted. The beam elevations are to be read to three decimal places and entered in tables under "Top of Beam" elevations.

Compute dimension "X" as follows: "Construction Elevation" minus "Top of Beam" elevation equals dimension "X". Construction Elevations include camber due to weight of the concrete slab and barrier. Measuring of dimension "X" gives the final check on beam tolerances for camber, beam damage, and errors in erection that produce reverse cambers, sags, and unsightly fascia beams.

For setting templates, measure dimension "X" above top of beams for top of template. Do not set templates by elevations.

Temporary supports or shoring will not be permitted under the girders when pouring the concrete floor slab or when taking "Top of Beam" elevations.

Note to Resident: The "Maximum Allowable Camber" shown on the beam sheet is the amount of camber, measured prior to casting the deck, above which the beam will begin to encroach into the slab.

CONSTRUCTION ELEVATIONS

LOCATION	LEFT FASCIA		CL BRIDGE		RIGHT FASCIA	
	CONSTR. ELEV.	DIM. "X"	CONSTR. ELEV.	TOP OF BEAM	CONSTR. ELEV.	TOP OF BEAM
SKEW LN AA	816.785		816.841		816.477	
SKEW LN BB	816.769		816.825		816.461	
SKEW LN CC	815.984		816.040		815.676	
SKEW LN DD	815.968		816.024		815.660	
GRID LN 01	816.738					
GRID LN 02	816.577					
GRID LN 03	816.410					
GRID LN 04	816.236					
GRID LN 05	816.056					
GRID LN 06	816.094					
GRID LN 07						

Commonwealth of Kentucky
DEPARTMENT OF HIGHWAYS
COUNTY
WOLFE
CONSTRUCTION ELEVATIONS
PREPARED BY
Division of Structural Design
SHEET NO. 28456
DRAWING NO. 28456

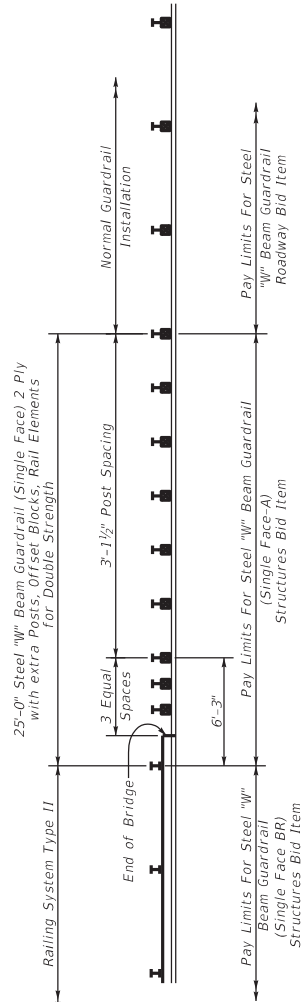

BID ITEM NOTES

GUARDRAIL-STEEL W BEAM (SINGLE FACE BR): The bid unit for this item is be linear feet. This item shall include the Railing System Type II that is to be installed on the bridge between the endmost posts attached to the bridge and all labor and incidentals necessary to properly install the railing system. For non-composite box beams, the railing system is attached to the beam prior to shipment.

GUARDRAIL-STEEL W BEAM (SINGLE FACE A): The bid unit for this item is be linear feet. This item includes the W-Beam guardrail (2 ply for extra strength), guardrail posts, offset blocks, hardware, and labor and incidentals necessary to properly install the approach guardrail within the 25'-0" limits at each corner of the structure. For RBR-005.c.e. and RBR-015.c.e.

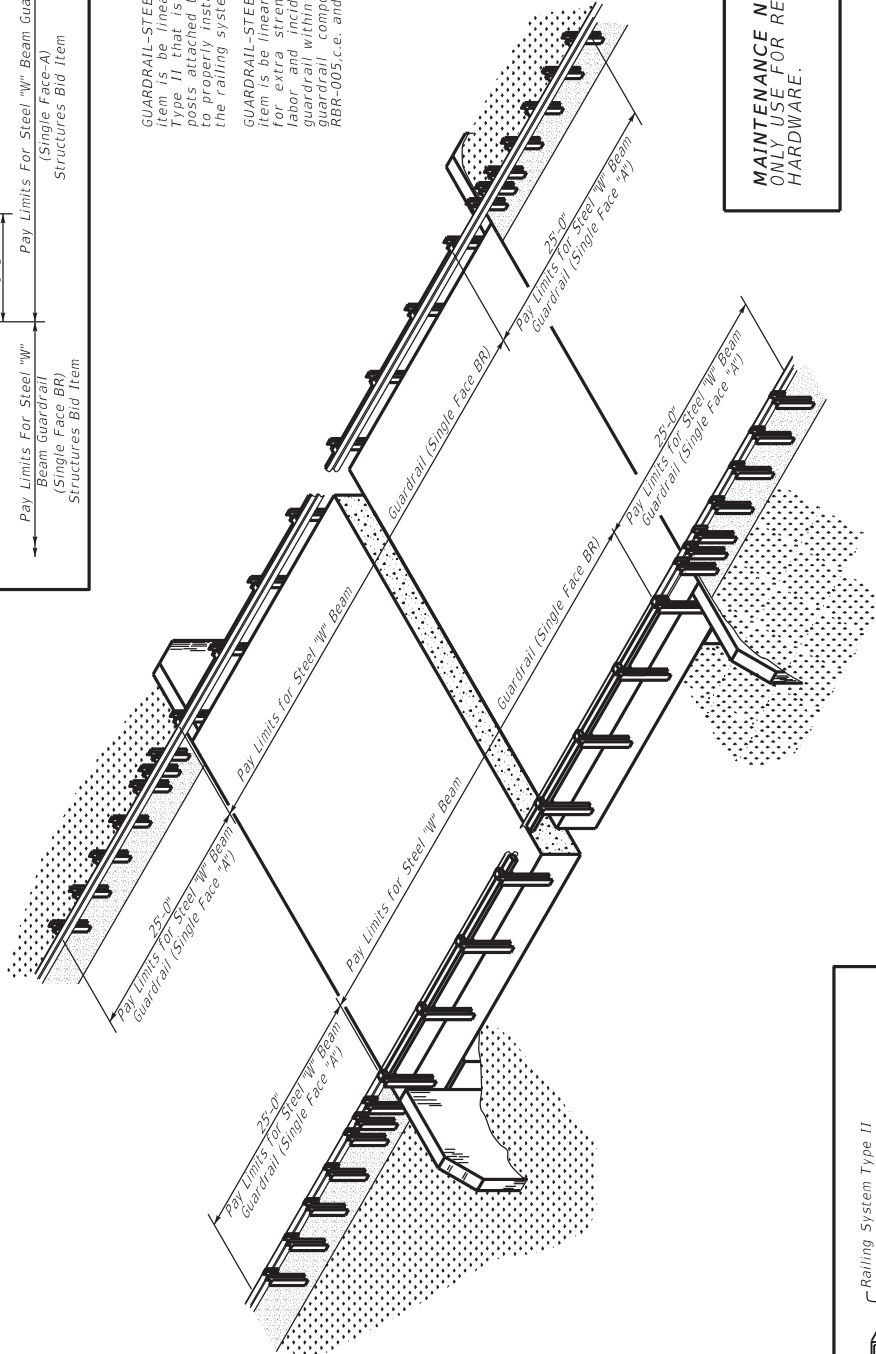

MAINTENANCE NOTES: NOT FOR NEW CONSTRUCTION. ONLY USE FOR REPAIRING OR RESTORING EXISTING HARDWARE.

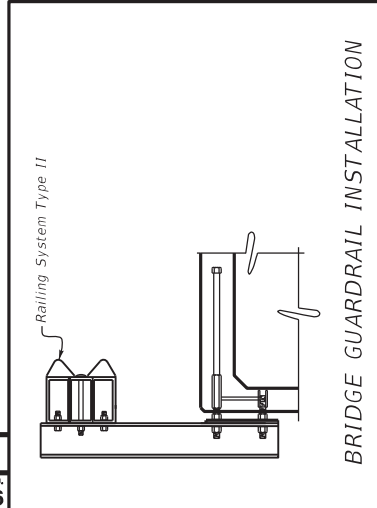
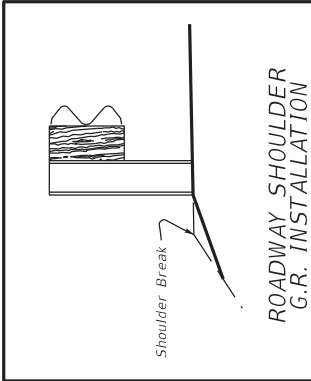

KENTUCKY DEPARTMENT OF HIGHWAYS
RAILING SYSTEM TYPE II
GUARDRAIL TREATMENT
SUBMITTED <i>Bob John</i> DIVISION DIRECTOR
DATE 06-23-20
001

PREPARED BY
Division of Structural Design

SHEET NO. 67
DRAWING NO. 28456

119B00029N
KY 1261 over Spring Branch

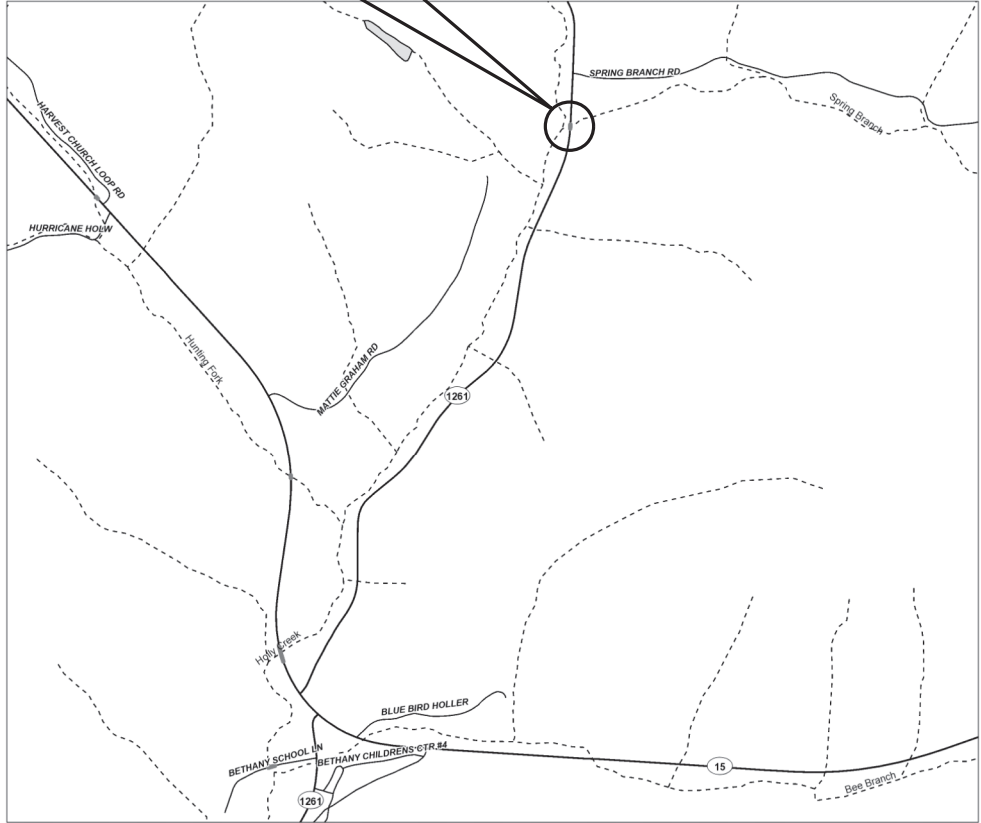
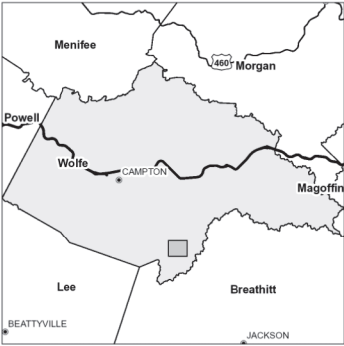
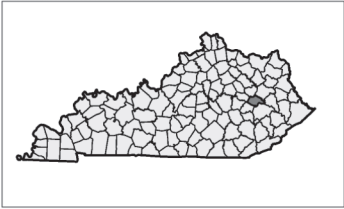

LOCATION MAP WOLFE COUNTY

Commonwealth of Kentucky	
DEPARTMENT OF HIGHWAYS	
COUNTY	
WOLFE	
LOCATION MAP	
PREPARED BY	SHEET NO.
Division of Structural Design	S1
DRAWING NO.	28463

GENERAL NOTES

SPECIFICATIONS: All references to the Specifications are to the current edition of the Kentucky Department of Highways Standard Specifications for Road and Bridge Construction with current Supplemental Specifications. All references to the AASHTO Specifications are to the current edition of the AASHTO LRFD Bridge Design Specs, with interims.

DESIGN LOAD: This bridge is designed for a KYHL-93 live load. The KYHL-93 live load is arrived at by increasing the standard HL-93 truck and lane loads as specified in the AASHTO Specifications by 25%.

FUTURE WEARING SURFACE: This Structure is designed for a 60 PSF future wearing surface load.

DESIGN STRESSES: Concrete Class "A" ~ f'c = 3500 psi
Concrete Class "AA" ~ f'c = 4000 psi
Steel Reinforcement ~ Fy = 60,000 psi
Structural Steel Yield Strength ~Fy = 50,000 psi

DESIGN METHOD: All reinforced concrete members are designed by the load and resistance factor method as specified in the current AASHTO Specifications.

WIND LOAD: This bridge is designed for a wind load based on a wind velocity of 100 mph.

REINFORCEMENT: Dimensions shown from the face of concrete to bars are to center of bars unless otherwise shown. Spacing of bars is from center to center of bars. Clear distance to face of concrete is 2", unless otherwise noted. Any reinforcing bars designated by suffix (e) in the plans shall be epoxy coated in accordance with section 811.10 of the Standard Specifications. Any reinforcing bars designated by suffix (s) in a bill of reinforcement shall be considered a stirrup for purposes of bend diameters.

BEVELED EDGES: Bevel all exposed edges $\frac{3}{4}$ ", unless otherwise noted.

COMPLETION OF THE STRUCTURE: The Contractor is required to complete the structure in accordance with the plans and specifications. Material, labor or construction operations, not otherwise specified, are to be included in the bid item most appropriate to the work involved. This may include cofferdams, shoring, excavations, backfilling, removal of all or parts of existing structures, phase construction, incidental materials, labor or anything else required to complete the structure.

DIMENSIONS: Dimensions are for a normal temperature of 60 degrees Fahrenheit. Layout dimensions are horizontal dimensions.

CONCRETE SEALER: Seal deck in accordance with the special note for concrete sealing.

JOINT WATERPROOFING: In addition to the standard drawing, all joints are to be sealed including those between beams.

SHOP DRAWINGS: Submit shop drawings that are required by the plans and specifications directly to the Division of Structural Design. If any changes in the design plans are proposed by a fabricator or supplier, submit those changes to the Department through the Contractor.

DIMENSIONS & ELEVATIONS: The existing bridge drawing number is 13893. All dimensions and elevations given in these plans are based on field surveyed data and dimensions from the old plans. Prior to beginning work or ordering any materials, the contractor shall field verify all dimensions and elevations. No claim will be honored by the Department of Highways regarding site conditions.

SITE INSPECTION: The contractor shall familiarize themselves with all conditions at the bridge site. Submission of a bid shall be considered evidence that the contractor has performed a site visit and is familiar with all aspects of the existing bridge and requirements in these plans. The cabinet will not consider any claims due to changed site conditions.

DAMAGE TO STRUCTURE: The contractor shall bear all responsibility and expense for any and all damage to the structure during repair work, even to the removal and replacement of the entire structure, should it be damaged by the contractors actions or inaction.

Applicable Standard Drawings

BDP-001-06	Box Beam General Notes and References
BDP-002-03	Box Beam Bearing Details
BDP-003-03	Box Beam Miscellaneous Details
BDP-004-04	Box Beam Tension Rod Details
BDP-006-05	Box Beam B12 and CB12 Details
BGX-006-10	Stencils for Structures
BGX-022	Joint Waterproofing
BJE-001-14	Neoprene Expansion Dams and Armored Edges
RBR-001-13	Steel Beam Guardrail (W Beam)
RBR-005-11	Guardrail Components
RBR-010-06	Guardrail Terminal Sections
RBR-015-06	Steel Guardrail Posts
RBR-020-07	Guardrail End Treatment Type I

Commonwealth of Kentucky	
DEPARTMENT OF HIGHWAYS	
COUNTY	
WOLFE	
GENERAL NOTES	
PREPARED BY	SHEET NO.
Division of	S2
Structural Design	DRAWING NO.
	28463



BRIDGE PLAN

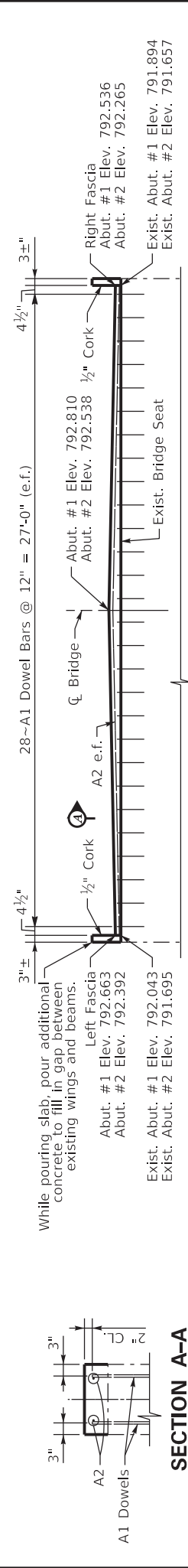

SECTION A-A

NEW BRIDGE SEATS

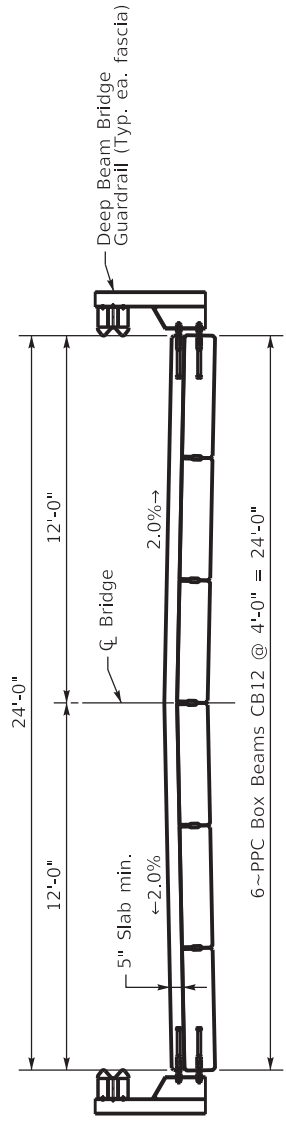

TYPICAL SECTION

BILL OF REINFORCEMENT					
MARK	TYPE	NO.	SIZE	LENGTH	LOCATION
A1	S tr.	112	5	1- 2	Dowe ls
A2	S tr.	4	5	27- 7	New Seat

BRIDGE NO.
119B00029N

Commonwealth of Kentucky
DEPARTMENT OF HIGHWAYS
COUNTY
WOLFE
LAYOUT
PREPARED BY
Division of
Structural Design
SHEET NO.
28463
DRAWING NO.

BILL OF REINFORCEMENT					
MARK	TYPE	NO.	SIZE	LENGTH	LOCATION
S1e	Str.	31	5	27'-3"	Slab
S2e	Str.	24	5	30'-8"	Slab

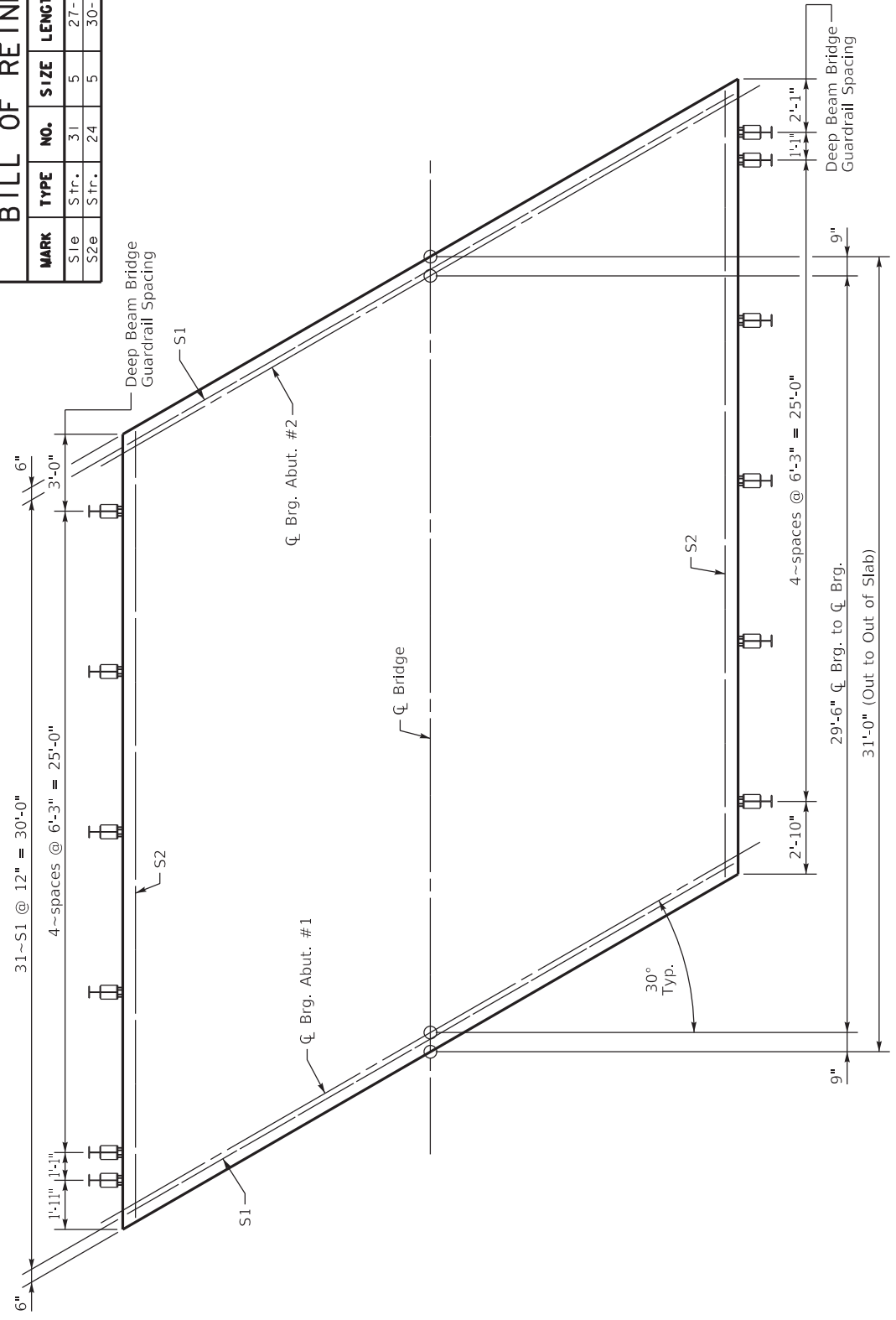

SLAB PLAN

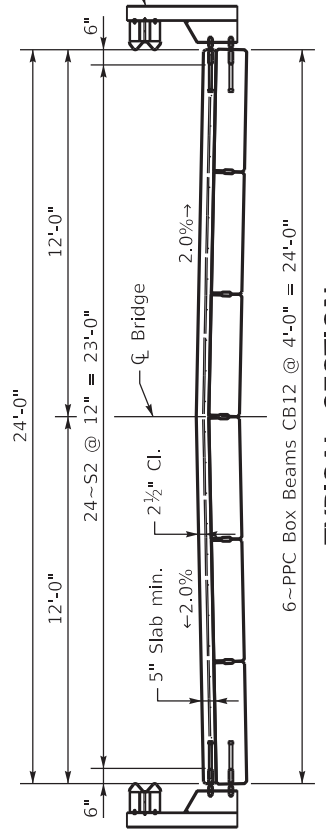

TYPICAL SECTION

NOTE:
Slab thickness varies from 5.8" at ends to 5" in the center to account for beam camber and provide a smooth grade across bridge. All quantities included in estimate of quantities bid.

BRIDGE NO.
119B00029N

Commonwealth of Kentucky DEPARTMENT OF HIGHWAYS	
COUNTY WOLFE	
SUPERSTRUCTURE	
PREPARED BY Division of Structural Design	SHEET NO. S4
DRAWING NO. 28463	

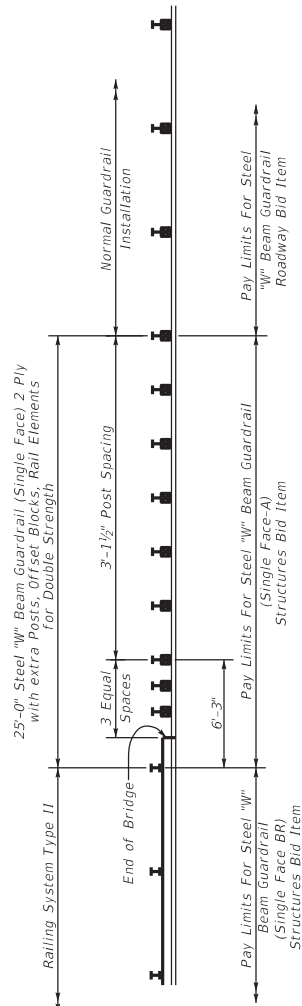

BID ITEM NOTES

GUARDRAIL-STEEL W BEAM (SINGLE FACE BR): The bid unit for this item is be linear feet. This item shall include the Railing System Type II that is to be installed on the bridge between the endmost posts attached to the bridge and all labor and incidentals necessary to properly install the railing system. For non-composite box beams, the railing system is attached to the beam prior to shipment.

GUARDRAIL-STEEL W BEAM (SINGLE FACE A): The bid unit for this item is be linear feet. This item includes the W-Beam guardrail (2 ply for extra strength), guardrail posts, offset blocks, hardware, and labor and incidentals necessary to properly install the approach guardrail within the 25'-0" limits at each corner of the structure. For RBR-005.c.e. and RBR-015.c.e.

MAINTENANCE NOTES: NOT FOR NEW CONSTRUCTION. ONLY USE FOR REPAIRING OR RESTORING EXISTING HARDWARE.

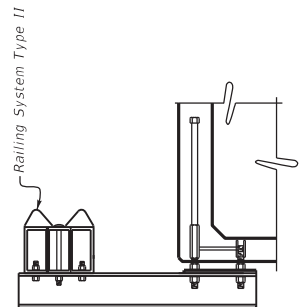
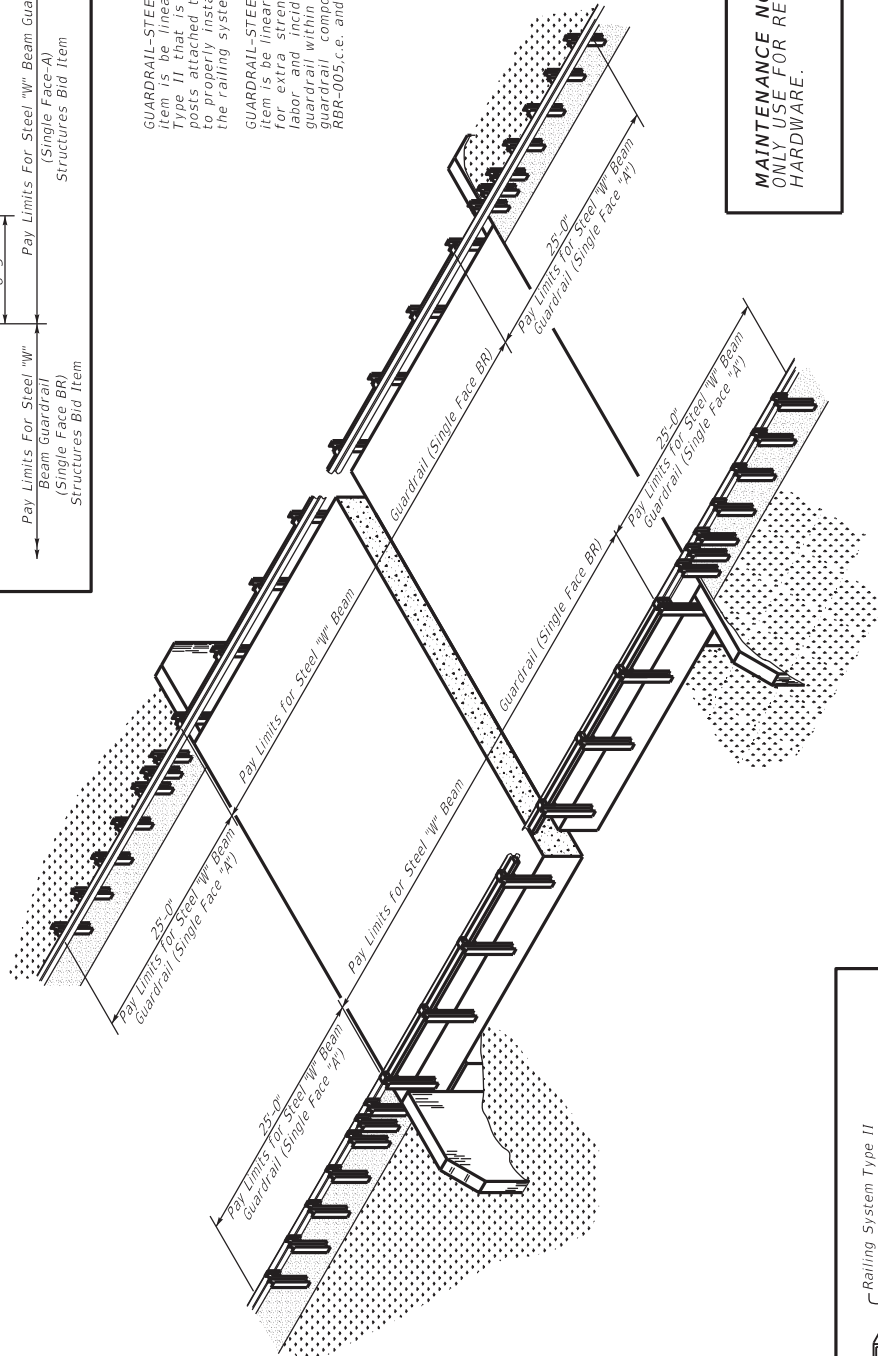

BRIDGE GUARDRAIL INSTALLATION

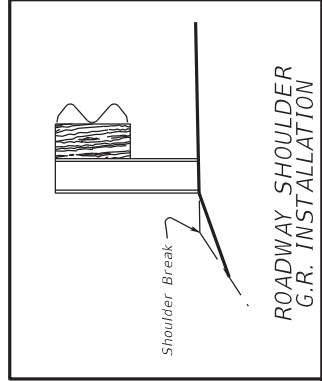

KENTUCKY
DEPARTMENT OF HIGHWAYS
RAILING SYSTEM
TYPE II
GUARDRAIL TREATMENT

SUBMITTED *Bob John* DIVISION DIRECTOR 06-23-20 DATE 001

PREPARED BY
Division of
Structural Design

SHEET NO. 67
DRAWING NO. 28463

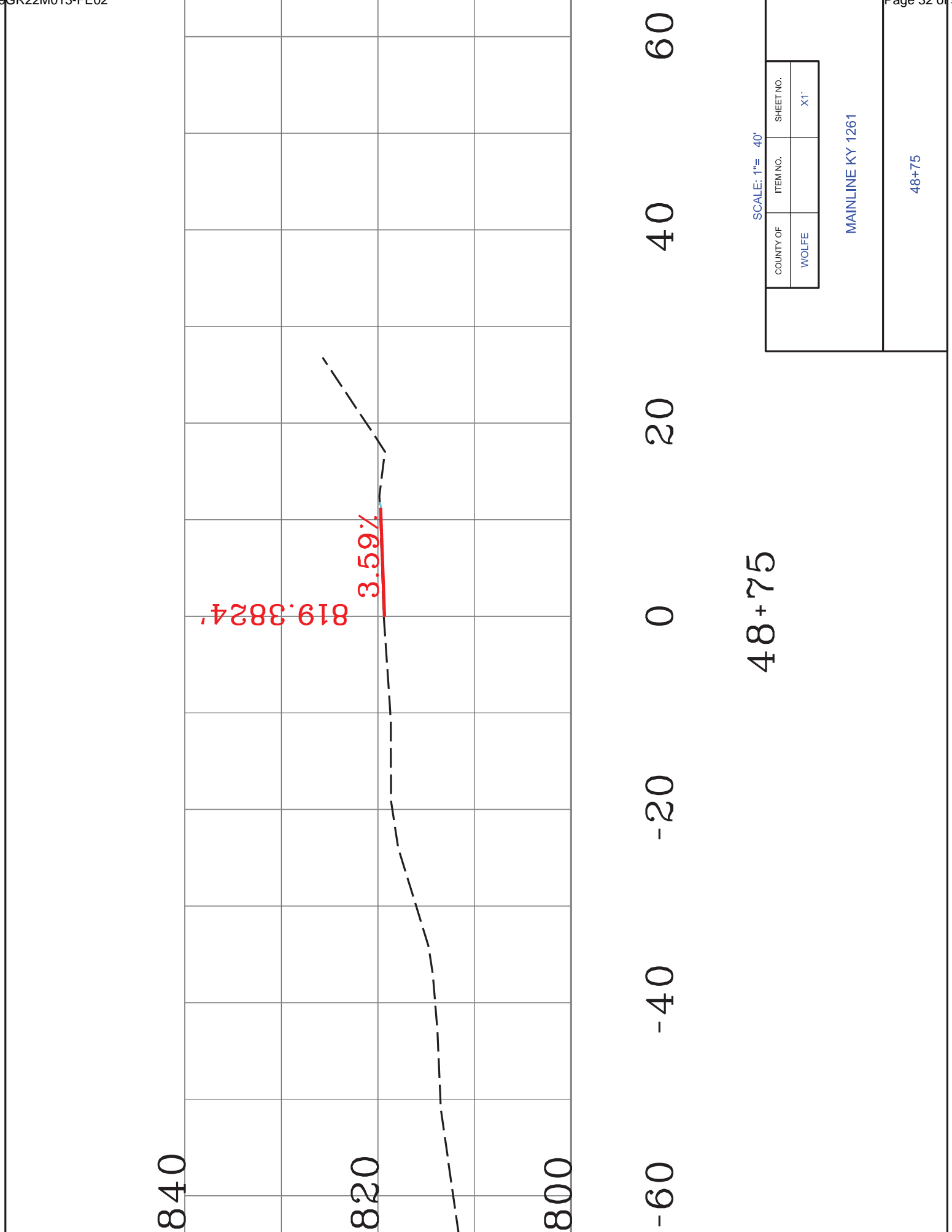

48+75

SCALE: 1"= 40'

COUNTY OF	ITEM NO.	SHEET NO.
WOLFE		X1

MAINLINE KY 1261

48+75

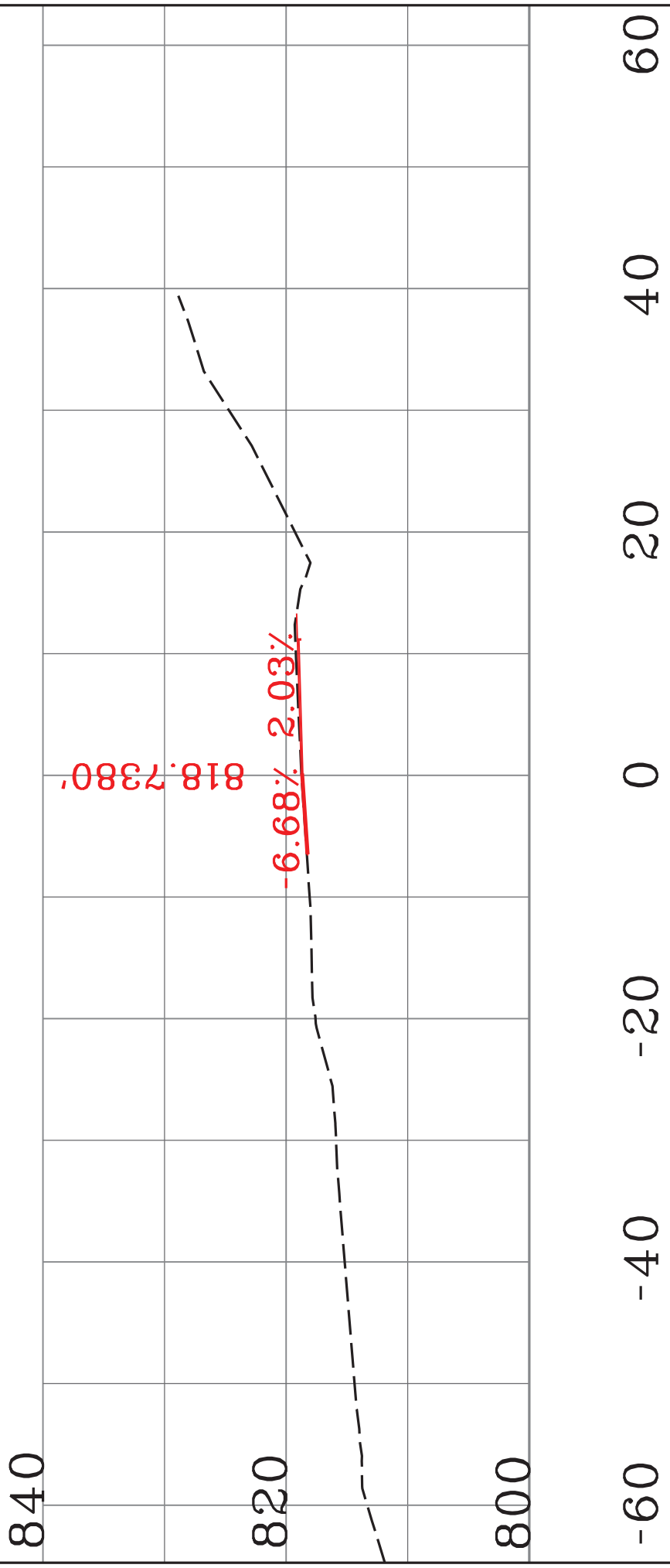

SCALE: 1"= 40'

COUNTY OF	ITEM NO.	SHEET NO.
WOLFE		X2

MAINLINE KY 1261

49+00

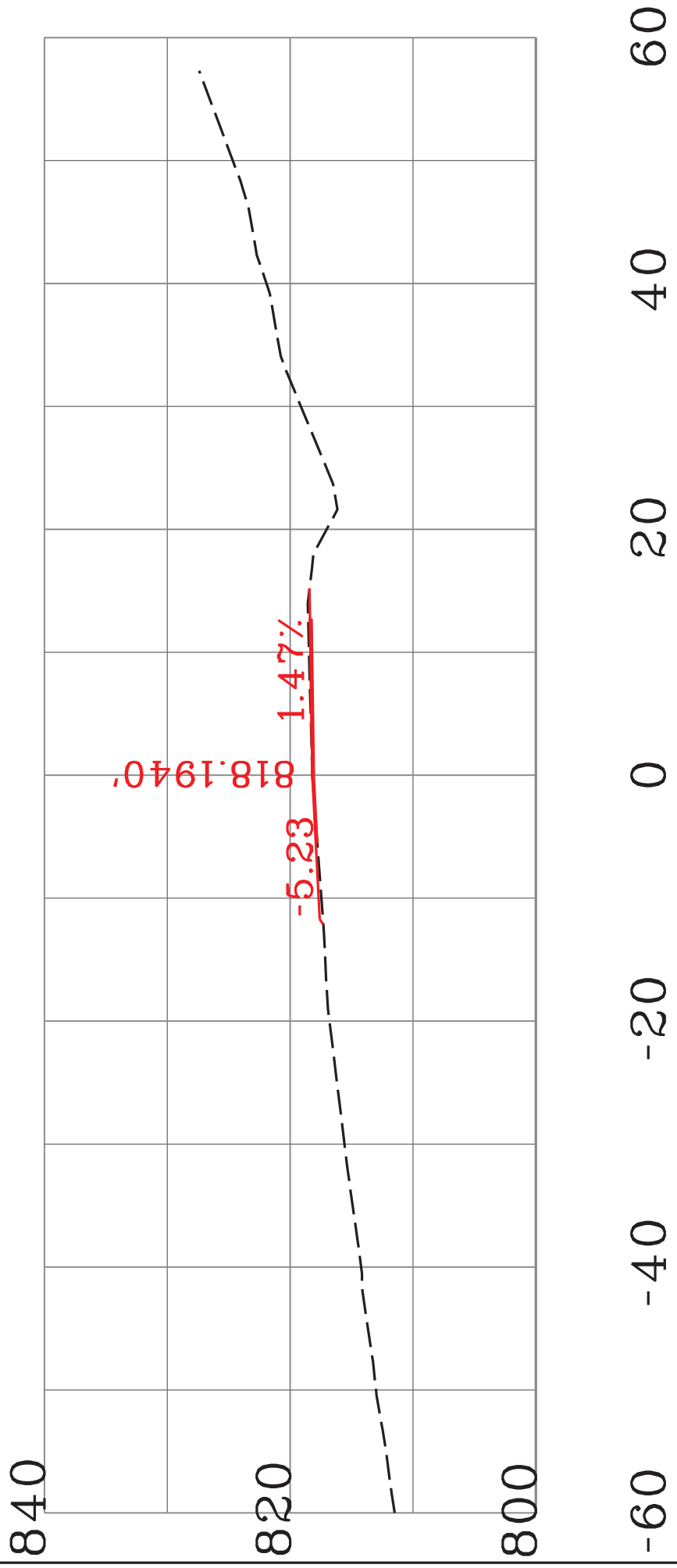

SCALE: 1"= 40'

COUNTY OF	ITEM NO.	SHEET NO.
WOLFE		X3

MAINLINE KY 1261

49+25

49+25

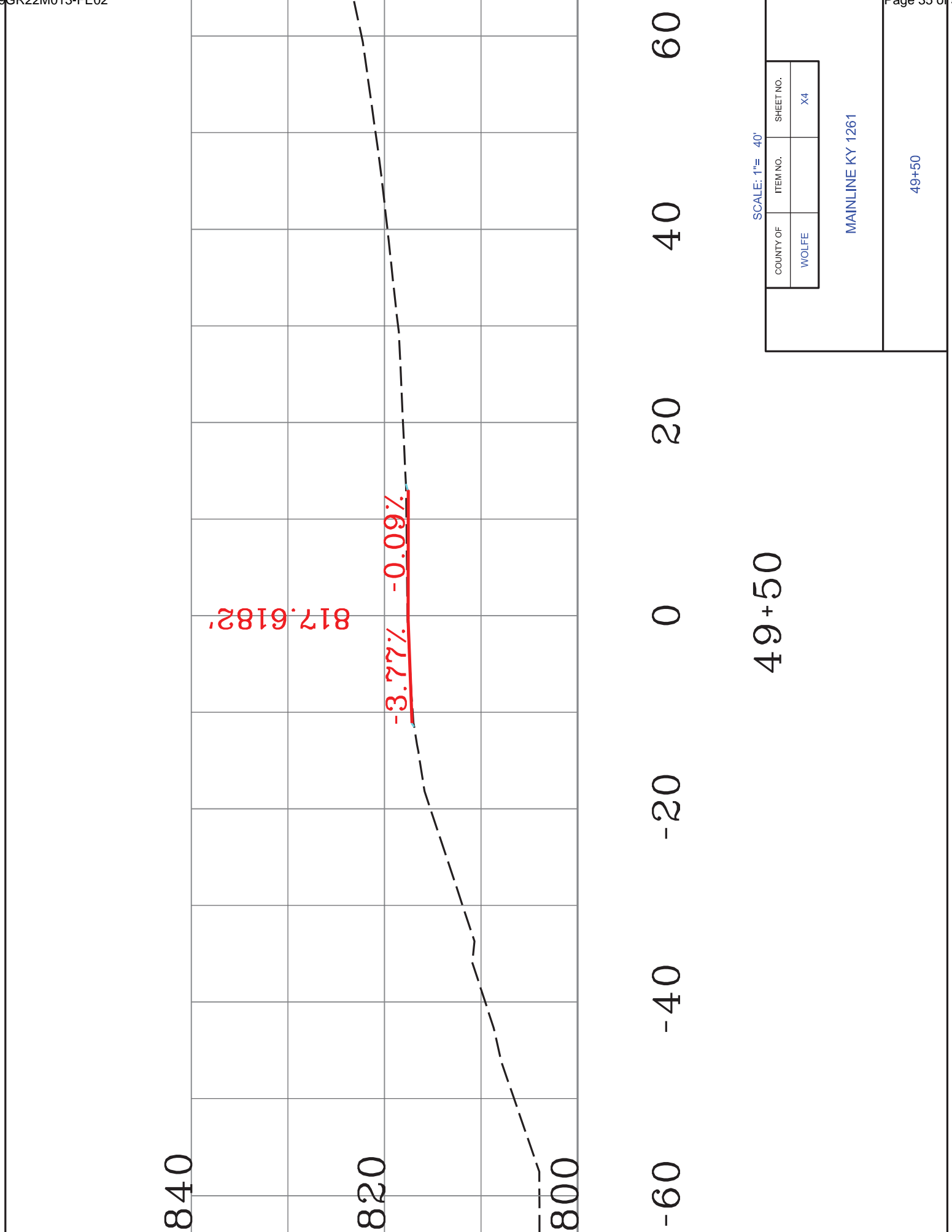

SCALE: 1"= 40'

49+50

COUNTY OF	ITEM NO.	SHEET NO.
WOLFE		X4

MAINLINE KY 1261

49+50

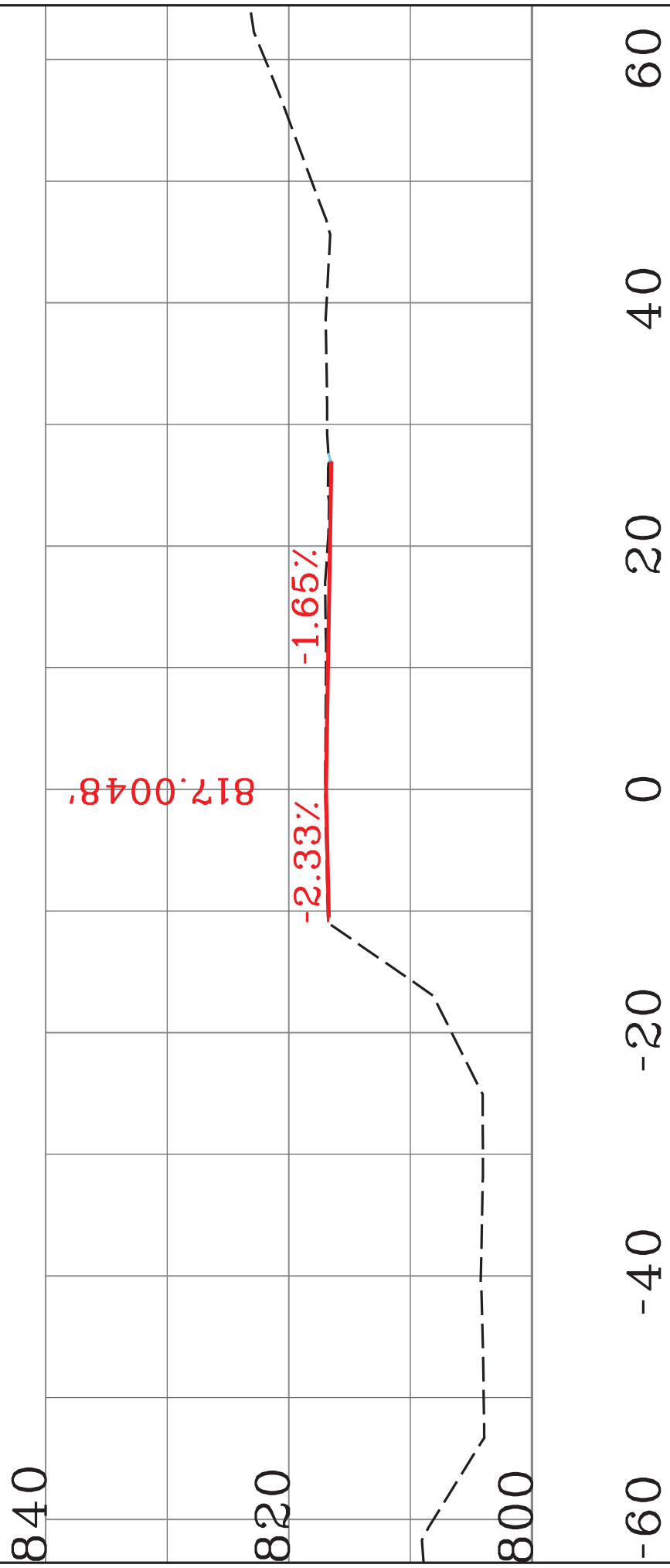

SCALE: 1"= 40'

COUNTY OF	ITEM NO.	SHEET NO.
WOLFE		X5

MAINLINE KY 1261

49+75

49+75

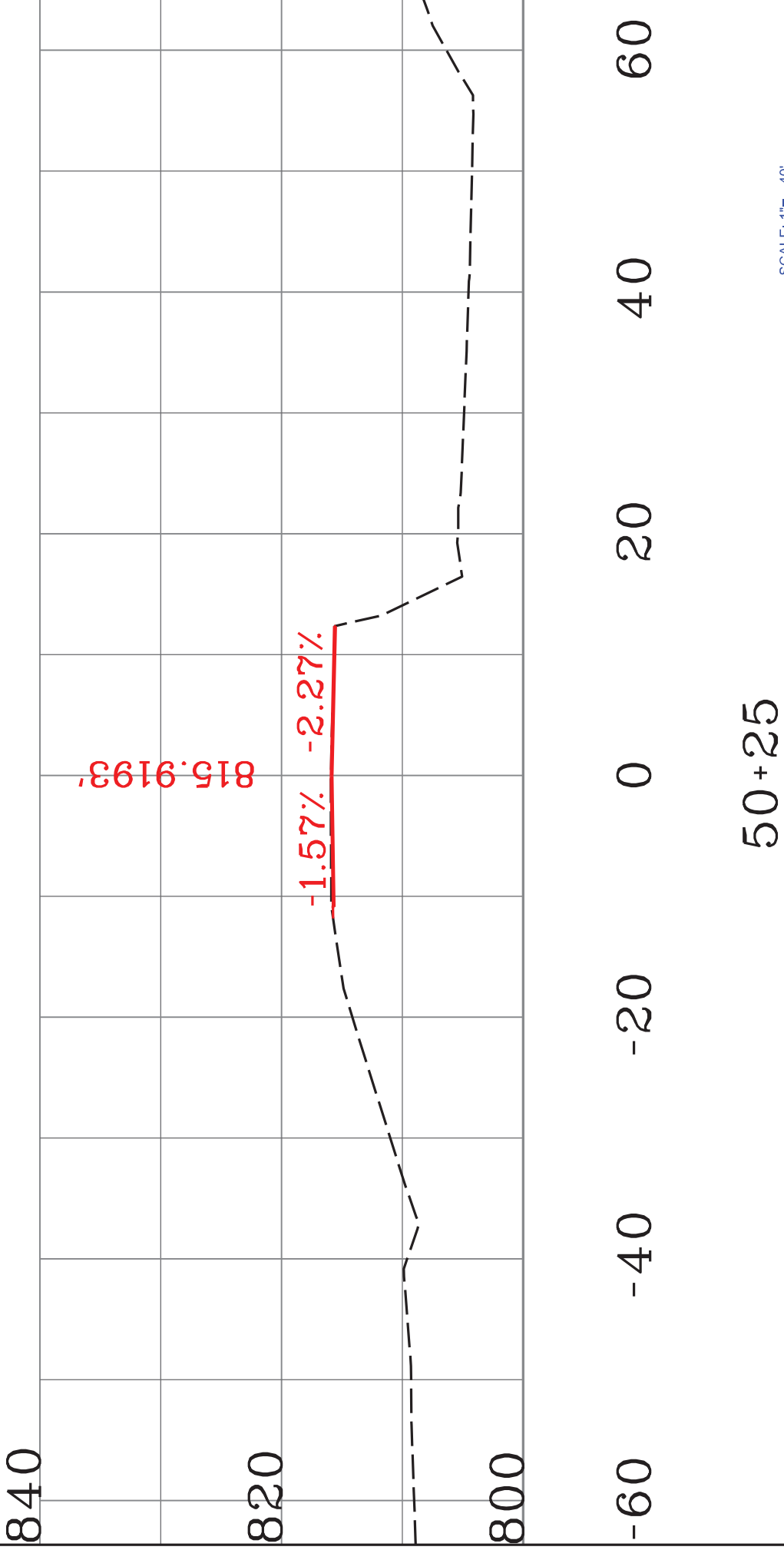

SCALE: 1"= 40'

COUNTY OF	ITEM NO.	SHEET NO.
WOLFE		X6

MAINLINE KY 1261

50+25

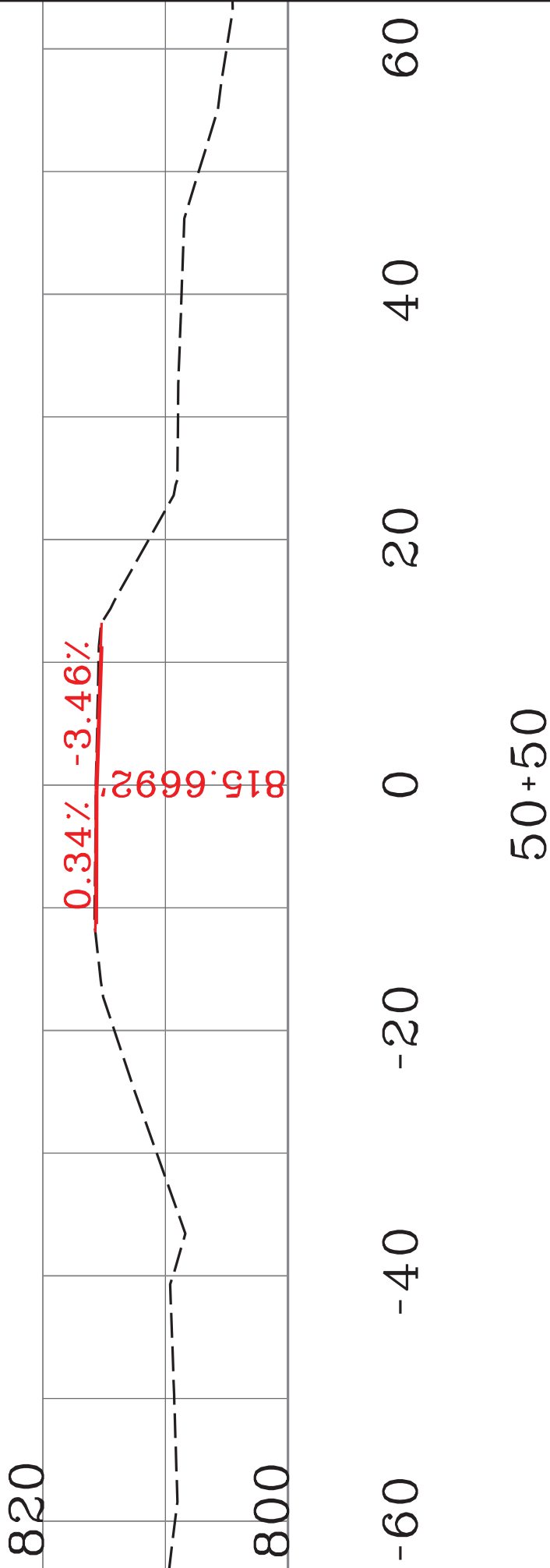

SCALE: 1"= 40'

COUNTY OF	ITEM NO.	SHEET NO.
WOLFE		X7

MAINLINE KY 1261

50+50

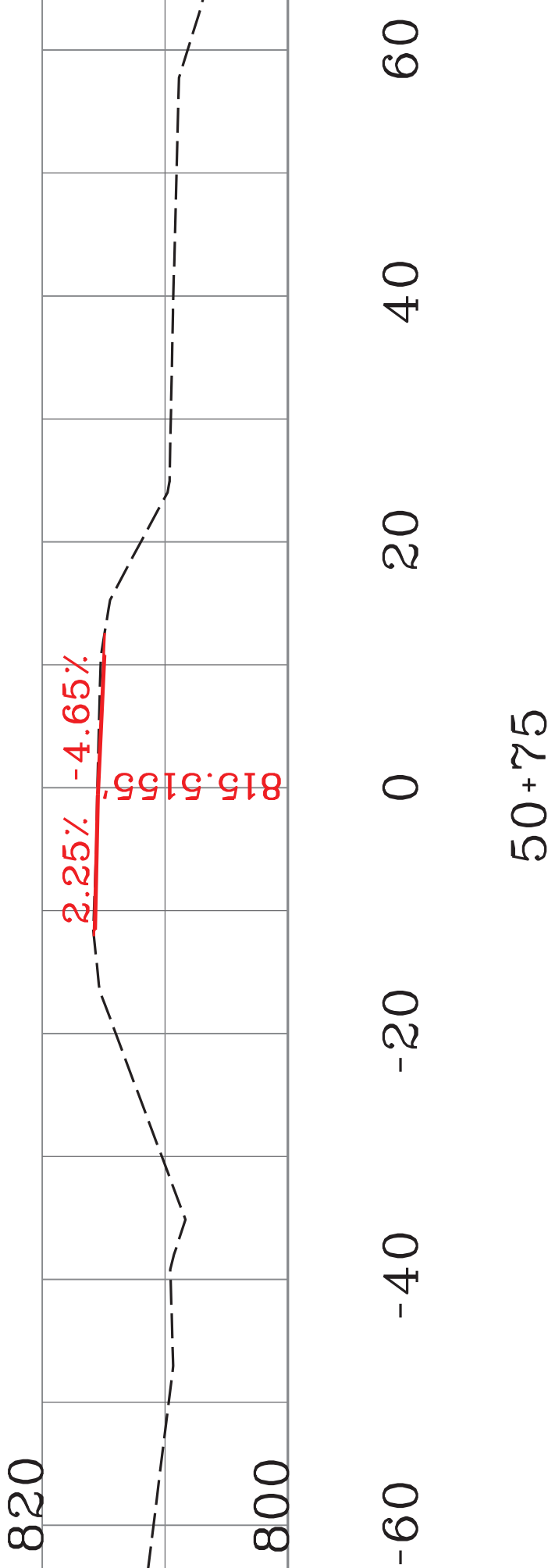

SCALE: 1"= 40'

COUNTY OF	ITEM NO.	SHEET NO.
WOLFE		X8

MAINLINE KY 1261

50+75

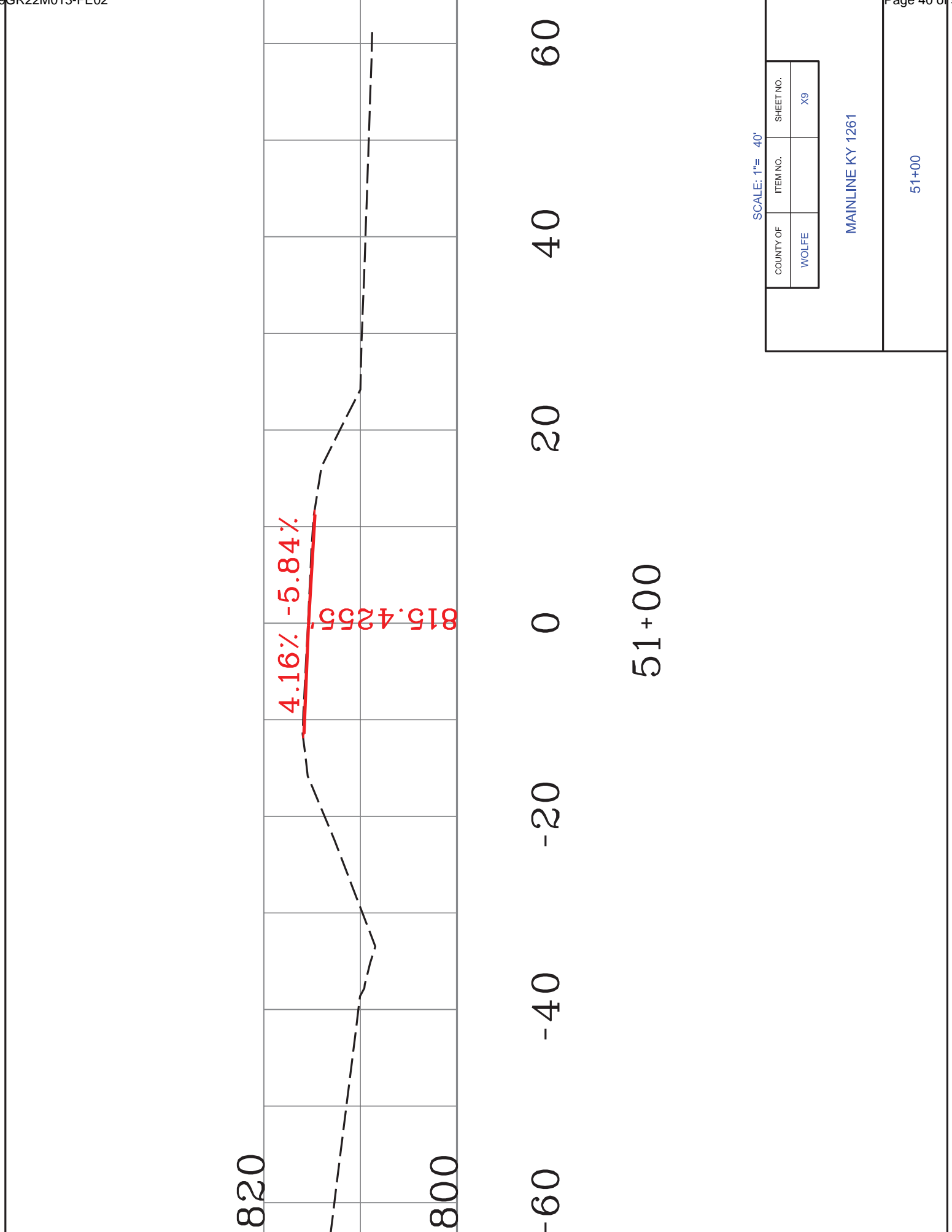

SCALE: 1"= 40'

COUNTY OF	ITEM NO.	SHEET NO.
WOLFE		X9

MAINLINE KY 1261

51+00

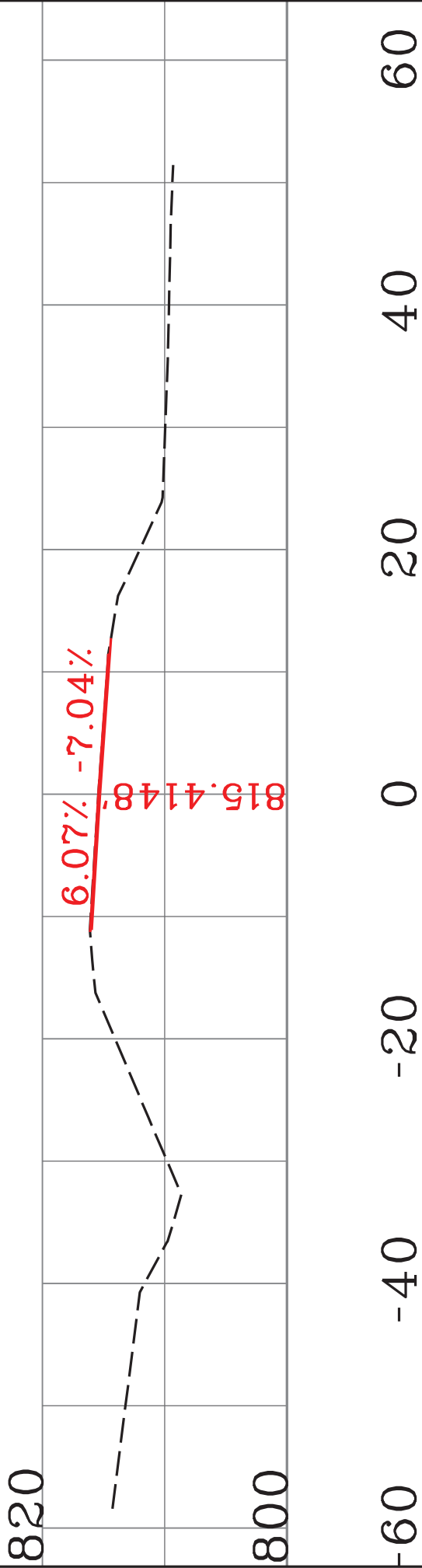

SCALE: 1"= 40'

COUNTY OF	ITEM NO.	SHEET NO.
WOLFE		X10

MAINLINE KY 1261

51+25

PART II
SPECIFICATIONS AND STANDARD DRAWINGS

SPECIFICATIONS REFERENCE

Any reference in the plans or proposal to previous editions of the *Standard Specifications for Road and Bridge Construction* and *Standard Drawings* are superseded by *Standard Specifications for Road and Bridge Construction, Edition of 2019* and *Standard Drawings, Edition of 2020*.

SUPPLEMENTAL SPECIFICATIONS

The contractor shall use the Supplemental Specifications that are effective at the time of letting.
The Supplemental Specifications can be found at the following link:

<http://transportation.ky.gov/Construction/Pages/Kentucky-Standard-Specifications.aspx>

PART III

EMPLOYMENT, WAGE AND RECORD REQUIREMENTS

**TRANSPORTATION CABINET
DEPARTMENT OF HIGHWAYS**

**LABOR AND WAGE REQUIREMENTS
APPLICABLE TO OTHER THAN FEDERAL-AID SYSTEM PROJECTS**

- I. Application
- II. Nondiscrimination of Employees (KRS 344)

I. APPLICATION

1. These contract provisions shall apply to all work performed on the contract by the contractor with his own organization and with the assistance of workmen under his immediate superintendence and to all work performed on the contract by piecework, station work or by subcontract. The contractor's organization shall be construed to include only workmen employed and paid directly by the contractor and equipment owned or rented by him, with or without operators.

2. The contractor shall insert in each of his subcontracts all of the stipulations contained in these Required Provisions and such other stipulations as may be required.

3. A breach of any of the stipulations contained in these Required Provisions may be grounds for termination of the contract.

3. If the contractor is in control of apprenticeship or other training or retraining, including on-the-job training programs, he shall not discriminate against an individual because of his race, color, religion, national origin, sex, disability or age forty (40) and over, in admission to, or employment in any program established to provide apprenticeship or other training.

4. The contractor will send to each labor union or representative of workers with which he has a collective bargaining agreement or other contract or understanding, a notice to be provided advising the said labor union or workers' representative of the contractor's commitments under this section, and shall post copies of the notice in conspicuous places available to employees and applicants for employment. The contractor will take such action with respect to any subcontract or purchase order as the administrating agency may direct as a means of enforcing such provisions, including sanctions for non-compliance.

Revised: January 25, 2017

II. NONDISCRIMINATION OF EMPLOYEES

**AN ACT OF THE KENTUCKY
GENERAL ASSEMBLY TO PREVENT
DISCRIMINATION IN EMPLOYMENT
KRS CHAPTER 344
EFFECTIVE JUNE 16, 1972**

The contract on this project, in accordance with KRS Chapter 344, provides that during the performance of this contract, the contractor agrees as follows:

1. The contractor shall not fail or refuse to hire, or shall not discharge any individual, or otherwise discriminate against an individual with respect to his compensation, terms, conditions, or privileges of employment, because of such individual's race, color, religion, national origin, sex, disability or age (forty and above); or limit, segregate, or classify his employees in any way which would deprive or tend to deprive an individual of employment opportunities or otherwise adversely affect his status as an employee, because of such individual's race, color, religion, national origin, sex, disability or age forty (40) and over. The contractor agrees to post in conspicuous places, available to employees and applicants for employment, notices to be provided setting forth the provisions of this nondiscrimination clause.

2. The contractor shall not print or publish or cause to be printed or published a notice or advertisement relating to employment by such an employer or membership in or any classification or referral for employment by the employment agency, indicating any preference, limitation, specification, or discrimination, based on race, color, religion, national origin, sex, or age forty (40) and over, or because the person is a qualified individual with a disability, except that such a notice or advertisement may indicate a preference, limitation, or specification based on religion, national origin, sex, or age forty (40) and over, or because the person is a qualified individual with a disability, when religion, national origin, sex, or age forty (40) and over, or because the person is a qualified individual with a disability, is a bona fide occupational qualification for employment.

EXECUTIVE BRANCH CODE OF ETHICS

In the 1992 regular legislative session, the General Assembly passed and Governor Brereton Jones signed Senate Bill 63 (codified as KRS 11A), the Executive Branch Code of Ethics, which states, in part:

KRS 11A.040 (7) provides:

No present or former public servant shall, within six (6) months following termination of his office or employment, accept employment, compensation, or other economic benefit from any person or business that contracts or does business with, or is regulated by, the state in matters in which he was directly involved during the last thirty-six (36) months of his tenure. This provision shall not prohibit an individual from returning to the same business, firm, occupation, or profession in which he was involved prior to taking office or beginning his term of employment, or for which he received, prior to his state employment, a professional degree or license, provided that, for a period of six (6) months, he personally refrains from working on any matter in which he was directly involved during the last thirty-six (36) months of his tenure in state government. This subsection shall not prohibit the performance of ministerial functions, including but not limited to filing tax returns, filing applications for permits or licenses, or filing incorporation papers, nor shall it prohibit the former officer or public servant from receiving public funds disbursed through entitlement programs.

KRS 11A.040 (9) states:

A former public servant shall not represent a person or business before a state agency in a matter in which the former public servant was directly involved during the last thirty-six (36) months of his tenure, for a period of one (1) year after the latter of:

- a) The date of leaving office or termination of employment; or
- b) The date the term of office expires to which the public servant was elected.

This law is intended to promote public confidence in the integrity of state government and to declare as public policy the idea that state employees should view their work as a public trust and not as a way to obtain private benefits.

If you have worked for the executive branch of state government within the past six months, you may be subject to the law's prohibitions. The law's applicability may be different if you hold elected office or are contemplating representation of another before a state agency.

Also, if you are affiliated with a firm which does business with the state and which employs former state executive-branch employees, you should be aware that the law may apply to them.

In case of doubt, the law permits you to request an advisory opinion from the Executive Branch Ethics Commission, 3 Fountain Place, Frankfort, Kentucky 40601; telephone (502) 564-7954.

Kentucky Equal Employment Opportunity Act of 1978

The requirements of the Kentucky Equal Employment Opportunity Act of 1978 (KRS 45.560-45.640) shall apply to this Contract. The apparent low Bidder will be required to submit EEO forms to the Division of Construction Procurement, which will then forward to the Finance and Administration Cabinet for review and approval. No award will become effective until all forms are submitted and EEO/CC has certified compliance. The required EEO forms are as follows:

- EEO-1: Employer Information Report
- Affidavit of Intent to Comply
- Employee Data Sheet
- Subcontractor Report

These forms are available on the Finance and Administration's web page under ***Vendor Information, Standard Attachments and General Terms*** at the following address:
<https://www.eProcurement.ky.gov>.

Bidders currently certified as being in compliance by the Finance and Administration Cabinet may submit a copy of their approval letter in lieu of the referenced EEO forms.

For questions or assistance please contact the Finance and Administration Cabinet by email at **finance.contractcompliance@ky.gov** or by phone at 502-564-2874.

EMPLOYEE RIGHTS UNDER THE FAIR LABOR STANDARDS ACT

THE UNITED STATES DEPARTMENT OF LABOR WAGE AND HOUR DIVISION

FEDERAL MINIMUM WAGE

\$7.25

 PER HOUR

BEGINNING JULY 24, 2009

OVERTIME PAY At least 1½ times your regular rate of pay for all hours worked over 40 in a workweek.

CHILD LABOR An employee must be at least **16** years old to work in most non-farm jobs and at least **18** to work in non-farm jobs declared hazardous by the Secretary of Labor.

Youths **14** and **15** years old may work outside school hours in various non-manufacturing, non-mining, non-hazardous jobs under the following conditions:

No more than

- **3** hours on a school day or **18** hours in a school week;
- **8** hours on a non-school day or **40** hours in a non-school week.

Also, work may not begin before **7 a.m.** or end after **7 p.m.**, except from June 1 through Labor Day, when evening hours are extended to **9 p.m.** Different rules apply in agricultural employment.

TIP CREDIT Employers of “tipped employees” must pay a cash wage of at least \$2.13 per hour if they claim a tip credit against their minimum wage obligation. If an employee’s tips combined with the employer’s cash wage of at least \$2.13 per hour do not equal the minimum hourly wage, the employer must make up the difference. Certain other conditions must also be met.

ENFORCEMENT The Department of Labor may recover back wages either administratively or through court action, for the employees that have been underpaid in violation of the law. Violations may result in civil or criminal action.

Employers may be assessed civil money penalties of up to \$1,100 for each willful or repeated violation of the minimum wage or overtime pay provisions of the law and up to \$11,000 for each employee who is the subject of a violation of the Act’s child labor provisions. In addition, a civil money penalty of up to \$50,000 may be assessed for each child labor violation that causes the death or serious injury of any minor employee, and such assessments may be doubled, up to \$100,000, when the violations are determined to be willful or repeated. The law also prohibits discriminating against or discharging workers who file a complaint or participate in any proceeding under the Act.

ADDITIONAL INFORMATION

- Certain occupations and establishments are exempt from the minimum wage and/or overtime pay provisions.
- Special provisions apply to workers in American Samoa and the Commonwealth of the Northern Mariana Islands.
- Some state laws provide greater employee protections; employers must comply with both.
- The law requires employers to display this poster where employees can readily see it.
- Employees under 20 years of age may be paid \$4.25 per hour during their first 90 consecutive calendar days of employment with an employer.
- Certain full-time students, student learners, apprentices, and workers with disabilities may be paid less than the minimum wage under special certificates issued by the Department of Labor.

For additional information:



1-866-4-USWAGE

(1-866-487-9243) TTY: 1-877-889-5627



WWW.WAGEHOUR.DOL.GOV

PART IV
INSURANCE

Refer to
Kentucky Standard Specifications for Road and Bridge Construction,
current edition

PART V
BID ITEMS

PROPOSAL BID ITEMS

222901

Page 1 of 1

Report Date 12/29/21

Section: 0001 - BRIDGE

LINE	BID CODE	ALT	DESCRIPTION	QUANTITY	UNIT	UNIT PRIC	FP	AMOUNT
0010	00001		DGA BASE	11.00	TON		\$	
0020	00221		CL2 ASPH BASE 0.75D PG64-22	22.00	TON		\$	
0030	00301		CL2 ASPH SURF 0.38D PG64-22	47.80	TON		\$	
0040	02351		GUARDRAIL-STEEL W BEAM-S FACE	56.90	LF		\$	
0050	02355		GUARDRAIL-STEEL W BEAM-S FACE A	170.70	LF		\$	
0060	02360		GUARDRAIL TERMINAL SECTION NO 1	4.00	EACH		\$	
0070	02367		GUARDRAIL END TREATMENT TYPE 1	4.00	EACH		\$	
0080	02399		EXTRA LENGTH GUARDRAIL POST	52.00	EACH		\$	
0090	02650		MAINTAIN & CONTROL TRAFFIC APPLIES TO 119B00028N	1.00	LS		\$	
0100	02650		MAINTAIN & CONTROL TRAFFIC APPLIES TO 119B00029N	1.00	LS		\$	
0110	03299		ARMORED EDGE FOR CONCRETE	111.40	LF		\$	
0120	03304		BRIDGE OVERLAY APPROACH PAVEMENT	1,066.66	SQYD		\$	
0130	08019		CYCLOPEAN STONE RIP RAP	200.00	TON		\$	
0140	08100		CONCRETE-CLASS A	3.60	CUYD		\$	
0150	08104		CONCRETE-CLASS AA	27.40	CUYD		\$	
0160	08150		STEEL REINFORCEMENT	504.00	LB		\$	
0170	08151		STEEL REINFORCEMENT-EPOXY COATED	3,690.00	LB		\$	
0180	08301		REMOVE SUPERSTRUCTURE (KY 1261 AT MP 2.97)	1.00	LS		\$	
0190	08301		REMOVE SUPERSTRUCTURE (KY 1261 AT MP 3.955)	1.00	LS		\$	
0200	08661		PRECAST PC BOX BEAM CB12-48	186.00	LF		\$	
0210	08662		PRECAST PC BOX BEAM CB17-48	229.50	LF		\$	
0220	20191ED		OBJECT MARKER TY 3	4.00	EACH		\$	
0230	23378EC		CONCRETE SEALING	1,724.00	SQFT		\$	
0240	25099ED		DEEP BEAM BRIDGE GUARDRAIL	118.50	LF		\$	
0250	40067		PAVEMENT MILLING	66.60	TON		\$	

Section: 0002 - DEMOBILIZATION

LINE	BID CODE	ALT	DESCRIPTION	QUANTITY	UNIT	UNIT PRIC	FP	AMOUNT
0260	02569		DEMOBILIZATION	1.00	LS		\$	