



CALL NO. 409

CONTRACT ID. 212903

GALLATIN COUNTY

FED/STATE PROJECT NUMBER 039GR21M036-FE02

DESCRIPTION INTERSTATE 71 BRIDGE OVERLAYS (MP 63.5, MP 65.5, & MP 67.2).

WORK TYPE BRIDGE DECK RESTORATION & WATERPROOFING

PRIMARY COMPLETION DATE 11/15/2021

LETTING DATE: April 23,2021

Sealed Bids will be received electronically through the Bid Express bidding service until 10:00 am EASTERN DAYLIGHT TIME April 23,2021. Bids will be publicly announced at 10:00 am EASTERN DAYLIGHT TIME.

NO PLANS ASSOCIATED WITH THIS PROJECT.

REQUIRED BID PROPOSAL GUARANTY: Not less than 5% of the total bid.

TABLE OF CONTENTS

PART I	SCOPE OF WORK
	<ul style="list-style-type: none">• PROJECT(S), COMPLETION DATE(S), & LIQUIDATED DAMAGES• CONTRACT NOTES• STATE CONTRACT NOTES• SPECIAL NOTE(S) APPLICABLE TO PROJECT• LIQUIDATED DAMAGES• TRAFFIC CONTROL PLAN• SKETCH MAP(S)• MATERIAL SUMMARY• BRIDGE DRAWINGS
PART II	SPECIFICATIONS AND STANDARD DRAWINGS
	<ul style="list-style-type: none">• SPECIFICATIONS REFERENCE• SUPPLEMENTAL SPECIFICATION• STANDARD DRAWINGS THAT APPLY
PART III	EMPLOYMENT, WAGE AND RECORD REQUIREMENTS
	<ul style="list-style-type: none">• LABOR AND WAGE REQUIREMENTS• EXECUTIVE BRANCH CODE OF ETHICS• KENTUCKY EQUAL EMPLOYMENT OPPORTUNITY ACT OF 1978 LOCALITY / STATE• PROJECT WAGE RATES / STATE FUNDED
PART IV	INSURANCE
PART V	BID ITEMS

PART I
SCOPE OF WORK

ADMINISTRATIVE DISTRICT - 06

CONTRACT ID - 212903

039GR21M036-FE02

COUNTY - GALLATIN

PCN - MB03900712101

FE02 039 0071 B00025L,R

INTERSTATE 71 (MP 63.519). BRIDGE OVER BIG SUGAR ROAD.BRIDGE DECK RESTORATION & WATERPROOFING

GEOGRAPHIC COORDINATES LATITUDE 38:45:18.00 LONGITUDE 84:48:28.00

PCN - MB03900712102

FE02 039 0071 B00026L,R

INTERSTATE 71 (MP 65.524). BRIDGE OVER LITTLE SUGAR ROAD.BRIDGE DECK RESTORATION & WATERPROOFING

GEOGRAPHIC COORDINATES LATITUDE 38:46:16.00 LONGITUDE 84:46:39.00

PCN - MB03900712103

FE02 039 0071 B00027L,R

INTERSTATE 71 (MP 67.166). BRIDGE OVER BIG SUGAR ROAD.BRIDGE DECK RESTORATION & WATERPROOFING

GEOGRAPHIC COORDINATES LATITUDE 38:47:00.00 LONGITUDE 84:45:08.00

COMPLETION DATE(S):

COMPLETED BY 11/15/2021	Applies to entire proposal
30 CALENDAR Days	Applies to 039B00025L
30 CALENDAR Days	Applies to 039B00025R
30 CALENDAR Days	Applies to 039B00026L
30 CALENDAR Days	Applies to 039B00026R
30 CALENDAR Days	Applies to 039B00027L
30 CALENDAR Days	Applies to 039B00027R

CONTRACT NOTES

PROPOSAL ADDENDA

All addenda to this proposal must be applied when calculating bid and certified in the bid packet submitted to the Kentucky Department of Highways. Failure to use the correct and most recent addenda may result in the bid being rejected.

BID SUBMITTAL

Bidder must use the Department's electronic bidding software. The Bidder must download the bid file located on the Bid Express website (www.bidx.com) to prepare a bid packet for submission to the Department. The bidder must submit electronically using Bid Express.

JOINT VENTURE BIDDING

Joint venture bidding is permissible. All companies in the joint venture must be prequalified in one of the work types in the Qualifications for Bidders for the project. The bidders must get a vendor ID for the joint venture from the Division of Construction Procurement and register the joint venture as a bidder on the project. Also, the joint venture must obtain a digital ID from Bid Express to submit a bid. A joint bid bond of 5% may be submitted for both companies or each company may submit a separate bond of 5%.

UNDERGROUND FACILITY DAMAGE PROTECTION

The contractor shall make every effort to protect underground facilities from damage as prescribed in the Underground Facility Damage Protection Act of 1994, Kentucky Revised Statute KRS 367.4901 to 367.4917. It is the contractor's responsibility to determine and take steps necessary to be in compliance with federal and state damage prevention directives. When prescribed in said directives, the contractor shall submit Excavation Locate Requests to the Kentucky Contact Center (KY811) via web ticket entry. The submission of this request does not relieve the contractor from the responsibility of contacting non-member facility owners, whom shall be contacted through their individual Protection Notification Center. Non-compliance with these directives can result in the enforcement of penalties.

REGISTRATION WITH THE SECRETARY OF STATE BY A FOREIGN ENTITY

Pursuant to KRS 176.085(1)(b), an agency, department, office, or political subdivision of the Commonwealth of Kentucky shall not award a state contract to a person that is a foreign entity required by [KRS 14A.9-010](#) to obtain a certificate of authority to transact business in the Commonwealth ("certificate") from the Secretary of State under [KRS 14A.9-030](#) unless the person produces the certificate within fourteen (14) days of the bid or proposal opening. If the foreign entity is not required to obtain a certificate as provided in [KRS 14A.9-010](#), the foreign entity should identify the applicable exception. Foreign entity is defined within [KRS 14A.1-070](#).

For all foreign entities required to obtain a certificate of authority to transact business in the Commonwealth, if a copy of the certificate is not received by the contracting agency within the time frame identified above, the foreign entity's solicitation response shall be deemed non-responsive or the awarded contract shall be cancelled.

Businesses can register with the Secretary of State at <https://secure.kentucky.gov/sos/ftbr/welcome.aspx>.

SPECIAL NOTE FOR PROJECT QUESTIONS DURING ADVERTISEMENT

Questions about projects during the advertisement should be submitted in writing to the Division of Construction Procurement. This may be done by fax (502) 564-7299 or email to kytc.projectquestions@ky.gov. The Department will attempt to answer all submitted questions. The Department reserves the right not to answer if the question is not pertinent or does not aid in clarifying the project intent.

The deadline for posting answers will be 3:00 pm Eastern Daylight Time, the day preceding the Letting. Questions may be submitted until this deadline with the understanding that the later a question is submitted, the less likely an answer will be able to be provided.

The questions and answers will be posted for each Letting under the heading "Questions & Answers" on the Construction Procurement website (www.transportation.ky.gov/contract). The answers provided shall be considered part of this Special Note and, in case of a discrepancy, will govern over all other bidding documents.

HARDWOOD REMOVAL RESTRICTIONS

The US Department of Agriculture has imposed a quarantine in Kentucky and several surrounding states, to prevent the spread of an invasive insect, the emerald ash borer. Hardwood cut in conjunction with the project may not be removed from the state. Chipping or burning on site is the preferred method of disposal.

INSTRUCTIONS FOR EXCESS MATERIAL SITES AND BORROW SITES

Identification of excess material sites and borrow sites shall be the responsibility of the Contractor. The Contractor shall be responsible for compliance with all applicable state and federal laws and may wish to consult with the US Fish and Wildlife Service to seek protection under Section 10 of the Endangered Species Act for these activities.

ACCESS TO RECORDS

The contractor, as defined in KRS 45A.030 (9) agrees that the contracting agency, the Finance and Administration Cabinet, the Auditor of Public Accounts, and the Legislative Research Commission, or their duly authorized representatives, shall have access to any books, documents, papers, records, or other evidence, which are directly pertinent to this contract for the purpose of financial audit or program review. Records and other prequalification information confidentially

disclosed as part of the bid process shall not be deemed as directly pertinent to the contract and shall be exempt from disclosure as provided in KRS 61.878(1)(c). The contractor also recognizes that any books, documents, papers, records, or other evidence, received during a financial audit or program review shall be subject to the Kentucky Open Records Act, KRS 61.870 to 61.884.

In the event of a dispute between the contractor and the contracting agency, Attorney General, or the Auditor of Public Accounts over documents that are eligible for production and review, the Finance and Administration Cabinet shall review the dispute and issue a determination, in accordance with Secretary's Order 11-004.

April 30, 2018

SPECIAL NOTE FOR RECIPROCAL PREFERENCE

RECIPROCAL PREFERENCE TO BE GIVEN BY PUBLIC AGENCIES TO RESIDENT BIDDERS

By reference, KRS 45A.490 to 45A.494 are incorporated herein and in compliance regarding the bidders residency. Bidders who want to claim resident bidder status should complete the Affidavit for Claiming Resident Bidder Status along with their bid in the electronic bidding software. Submittal of the Affidavit should be done along the bid in Bid Express.

April 30, 2018

SPECIAL NOTE FOR BRIDGE RESTORATION AND WATERPROOFING WITH CONCRETE OVERLAYS

- I. DESCRIPTION.** Perform all work in accordance with the Kentucky Transportation Cabinet, Department of Highway's 2019 Standard Specifications for Road and Bridge Construction and applicable Supplemental Specifications, the Standard Drawings, this Note, and the attached detail drawings. Section references are to the Standard Specifications.

This work consists of the following: (1) Furnish all labor, materials, tools, and equipment; (2) Remove the existing overlay; (3) Complete full-depth and partial depth repairs as directed by the Engineer; (4) Repair/replace damaged and corroded reinforcing bars; (5) Place new concrete overlay and epoxy-sand slurry in accordance with Section 606; (6) Complete asphalt approach pavement; (7) Maintain and control traffic; and (8) Any other work specified as part of this contract.

All construction will be in accordance with Section 606 unless otherwise specified.

II. MATERIALS.

- A. Latex Concrete.** See Section 606.03.17.
- B. Class "M" Concrete.** Use either "M1" or "M2". See Section 601.
- C. Bituminous Asphalt.** Use CL4 ASPH SURF 0.38A PG76-22.
- D. Epoxy-Sand Slurry.** See Section 606.03.10.

III. CONSTRUCTION.

- A. Remove Existing Overlay.** In addition to Section 606.03.03, totally remove the existing concrete overlay by milling.
- B. Partial Depth Slab Repair and Latex Overlay.** Remove areas determined to be unsound by the Engineer via hydrodemolition or via hand held jackhammers weighing less than 45lbs in accordance with Section 606.02.10 D. Repair/Replace all damaged or severely corroded reinforcing bars prior to partial depth repair operation. The Department will not measure material removal and will consider this work incidental to the bid item "PARTIAL DEPTH PATCHING". Mix and place Latex Modified Concrete Overlay in accordance with Sections 606.03.08 and 606.03.17.
- C. Asphalt Approach Pavement.** Mill each existing asphalt approach for a distance of 50' from the bridge end. Remove the bituminous material uniformly by making an edge key, so as to provide a smooth transition to the finished bridge when a new bituminous overlay of compacted depth of approximately 1½" is added to the approaches. The grinding depth may vary depending of the condition of the existing approach and final elevation of bridge end. Dispose of all removed material away from the site.
- D. Surface Texturing.** Texture the concrete surface of the overlay in accordance with Section 609.03.10.

IV. MEASUREMENT. See Section 606 and the following:

- A. Latex Modified Concrete for Overlay.** The Department will measure the quantity in cubic yards using the theoretical volume as follows for each bridge:

039B00025L,R	(127.5' x 38' x 2.0") = 29.9 cuyd
039B00026L,R	(154.5' x 38' x 2.0") = 36.2 cuyd
039B00027L,R	(127.5' x 38' x 2.0") = 29.9 cuyd

- B. Latex Modified Concrete for Partial Depth Patching and variable thickness of Overlay.** The Department will measure the quantity in cubic yards by deducting the theoretical volume of bridge deck overlay (LMC) from the total volume (as indicated by the batch quantity tickets) of Concrete required to obtain the finished grade shown on the Plans or established by the Engineer.
- C. Remove Existing Overlay.** The Department will measure the removal of the existing overlay in square yards, which shall include all labor, equipment, and material needed to complete this work.
- D. Steel Reinforcement.** The Department will measure any reinforcing steel necessary for the partial or full depth patch in pounds, which shall include all labor, equipment, and material needed to complete this work.
- E. Asphalt Approach Pavement.** The Department will measure the quantity in square yards, which shall include all labor, equipment, and material needed to complete this work.
- V. PAYMENT.** See Section 606 and the following:
- A. Latex Modified Concrete for Overlay.** The Department will make payment for the Latex Modified Concrete under bid item #08534 "CONCRETE OVERLAY – LATEX" for the theoretical quantity.
- B. Latex Modified Concrete for Partial Depth Patching and variable thickness of Overlay.** The Department will make payment for the Partial Depth Patching under bid item #24094EC "PARTIAL DEPTH PATCHING". Payment will be for the quantity per cubic yard complete in place.
- C. Remove Existing Overlay.** The Department will make payment for the removal of the existing overlay under the bid item #08510 "REM EPOXY BIT FOREIGN OVERLAY". Payment will be for the square yard complete.
- D. Steel Reinforcement.** The Department will make payment for steel reinforcement, if necessary, under bid item #08150 "STEEL REINFORCEMENT". Payment will be at the unit price per pound.
- E. Asphalt Approach Pavement.** The Department will make payment for the completed and accepted quantity of this work under the bid item #03304 "BRIDGE OVERLAY APPROACH PAVEMENT".

SPECIAL NOTE FOR REPLACING EXPANSION DAMS AND/OR INSTALLING ARMORED EDGES FOR CONCRETE ON BRIDGES

I. DESCRIPTION. Perform all work in accordance with the Kentucky Transportation Cabinet, Department of Highway's 2019 Standard Specifications for Road and Bridge Construction and applicable Supplemental Specifications, the Standard Drawings, this Note, and the attached detail drawings. Section references are to the Standard Specifications.

This work consists of the following: (1) Furnish all labor, materials, tools, and equipment; (2) Remove existing concrete and expansion device(s) and/or bridge ends; (3) Install armored edges and new concrete as specified and in accordance with the attached detail drawings; (4) Install new joint seals (where required); (5) Maintain and control traffic; and (6) Any other work specified as part of this contract.

II. MATERIALS.

A. Class "M" Concrete. Use either "M1" or "M2". See Section 601.

B. Structural Steel. Use new, commercial grade steel suitable for welding. The Engineer will base acceptance on visual inspection.

C. Stud Anchors. The armored edge stud anchors are $\frac{3}{4}$ " x 6" embedded stud shear connectors conforming to ASTM A108, Grade 1015 (Nelson Studs or equal).

D. Steel Reinforcement. Use Grade 60. See Section 602.

E. Epoxy Bond Coat. See Section 511.

III. EQUIPMENT.

A. Hammers. See Section 606.02.10 B.

B. Sawing Equipment. See Section 606.02.10 C.

C. Hydraulic Impact Equipment. See Section 606.02.10 D.

IV. CONSTRUCTION.

A. Remove Existing Materials. Remove existing Expansion Dam, Bridge End, Armored Edges and specified areas of concrete as shown on the attached sketches. Remove debris and/or expansion joint filler as directed by the Engineer. Clean and leave all existing steel reinforcement encountered in place. Damaged steel reinforcement will be repaired/replaced as directed by the Engineer at no additional cost to the Department.

Dispose of all removed material entirely away from the job site. This work is incidental to the contract unit price for "Expansion Joint Replacement" or "Armored Edge for Concrete".

B. Place New Concrete and Armored Edges. After all specified existing materials have been removed; place new armored edges to match the grade of the proposed overlay or to match the original grade (See attached detail drawings). Place the new Class "M" concrete to the scarified grade and finish to receive the new overlay or place the new Class "M" concrete to the original grade and finish with broom strokes drawn transversely from curb to curb.

All new structural steel shall be cleaned and painted in accordance with requirements of Section 607.03.23, except that surfaces to come in contact with concrete are not to be painted.

Blast clean all areas of existing concrete and structural steel to come in contact with new concrete until free of all laitance and deleterious substances immediately prior to the placement of the Class "M" Concrete. The surface areas of existing concrete to come in contact with the new Class "M" Concrete are to be coated with an epoxy bond coat immediately prior to placing new concrete in accordance with Section 511. The interfaces of the new and old concrete shall be as nearly vertical and horizontal as possible.

- C. Additional Steel Reinforcement.** Furnish for replacement, as directed by the Engineer, 7800 linear feet of #4 steel reinforcing bars in 20' lengths. Place these bars in areas deemed by the Engineer to require additional reinforcement. Field cutting and bending is permitted. Do not place any additional steel reinforcement above the height of the top row of Nelson Studs on the armored edges. Ensure that all exposed steel reinforcement is tied in accordance with Section 602.03.04 prior to pouring the new Class "M" concrete. Deliver unused bars to the Local County Maintenance Barn. Payment will be made in accordance with Section 602.
- D. Stage Construction.** Installation of concrete and armored edges in two (or more if specified) stages is necessary. Join the armored edges at or near the centerline of the roadway or lane line, field weld and grind smooth.
- E. Shop Plans.** Shop plans will not be required. The Contractor is responsible for obtaining field measurements and supplying properly sized materials to complete the work.

V. MEASUREMENT.

- A. Armored Edge for Concrete.** The Department will measure the quantity in linear feet from gutterline to gutterline along the face of the bridge end.
- B. Steel Reinforcement.** See Section 602.

VI. PAYMENT.

- A. Armored Edge for Concrete.** Payment at the contract unit price per linear foot is full compensation for removing specified existing materials, furnishing and installing the new armored edges, concrete and all incidental items necessary to complete the work (except the overlay material) within the specified pay limits as specified by this note and as shown on the attached detail drawings.
- B. Steel Reinforcement.** See Section 602.

SPECIAL NOTE FOR ELIMINATING TRANSVERSE JOINTS ON BRIDGES

- I. **DESCRIPTION.** Perform all work in accordance with the Kentucky Transportation Cabinet, Department of Highway's 2019 Standard Specifications for Road and Bridge Construction.

Remove existing concrete and existing joint material to eliminate the transverse joint. Install additional reinforcing steel and place concrete.
- II. **MATERIALS.**
 - A. **Class "M" Concrete.** Use either "M1" or "M2". See Section 601.
 - B. **Steel Reinforcement.** Use Grade 60. See Section 602.
 - C. **Epoxy Bond Coat.** See Section 511.
- III. **EQUIPMENT.**
 - A. **Hammers.** See Section 606.02.10 B.
 - B. **Sawing Equipment.** See Section 606.02.10 C.
 - C. **Hydraulic Impact Equipment.** See Section 606.02.10 D.
- IV. **CONSTRUCTION.**
 - A. **Remove Existing Materials.** Remove the existing transverse joints, joint filler, and specified areas of concrete as shown on the plans, in accordance with Section 606.02.10 and 606.03.03, and as directed by the Engineer. Clean and leave all existing steel reinforcement encountered in place. Damaged steel reinforcement will be repaired/replaced as directed by the Engineer at no additional cost to the Department. Dispose of all removed material entirely away from the job site. This work is incidental to the contract unit price for "Eliminate Transverse Joint".
 - B. **Additional Steel Reinforcement.** Furnish for this work steel reinforcing bars as shown on the plans. Splice these bars to the existing longitudinal reinforcement in the deck and curb/sidewalk in the areas of removed concrete to tie the slabs together as shown on the plans. Ensure that all exposed steel reinforcement is tied in accordance with Section 602.03.04 prior to pouring the new Class "M" concrete.
 - C. **Place New Concrete.** Blast clean all areas of existing concrete and structural steel to come in contact with new concrete until free of all laitance and deleterious substances immediately prior to the placement of the Class "M" Concrete. The surface areas of existing concrete to come in contact with the new Class "M" Concrete are to be coated with an epoxy bond coat immediately prior to placing new concrete in accordance with Section 511. The interfaces of the new and old concrete shall be as nearly vertical and horizontal as possible.

Place new Class "M" Concrete to the specified grade and finish to receive the new overlay or as shown on the plans. On the sidewalk and curb, place the new concrete to original grade and finish to match the existing curb/sidewalk.
- V. **MEASUREMENT.**
 - A. **Eliminate Transverse Joint.** The Department will measure the quantity in linear feet from plinth to plinth of the bridge.

B. Steel Reinforcement. See Section 602.

VI. PAYMENT.

A. Eliminate Transverse Joint. Payment at the contract unit price per linear foot is full compensation for furnishing equipment, labor, tools and materials needed to complete removal and disposal of the specified existing materials, cleaning and straighting of existing steel reinforcement, furnishing and installing the concrete, and all incidental items necessary to complete the work (except the overlay material if specified elsewhere in the contract) within the specified pay limits as indicated on the drawings.

B. Steel Reinforcement. See Section 602.

NOTES FOR BRIDGE PIER AND SOFFIT CONCRETE PATCHING

These Notes or designated portions thereof, apply where so indicated on the plans, proposals or bidding instruction.

- I. DESCRIPTION.** Perform all work in accordance with the Department's 2019 Standard Specifications, and applicable Supplemental Specifications, the attached sketches, and these Notes. Section references are to the Standard Specifications.

This work consists of: (1) Furnish all labor, materials, tools, and equipment; (2) Remove existing spalled/delaminated concrete; (3) Prepare the existing surface for concrete patching; (4) Place hook fasteners and welded wire fabric over surfaces to be repaired (where applicable); (5) Apply concrete patching as specified by this note and as shown on the attached detail drawings; (6) Finish and cure the new Concrete Patches; (7) Maintain & control traffic; and, (8) Any other work specified as part of this contract.

- II. MATERIALS.**

- A. Concrete.** Approved Concrete Product for Vertical and Overhead Repair Patch.
B. Steel Reinforcement. Use Grade 60. See Section 602
C. Welded Steel Wire Fabric (WWF). Conform to Section 811
D. Hook Fasteners. Use commercial grade galvanized hook fasteners. Minimum 3/16" diameter.

- III. CONSTRUCTION.**

- A. Concrete Removal and Preparation.** The Contractor, as directed by the Engineer shall locate and remove all loose, spalled, deteriorated and delaminated concrete. Sounding shall be used to locate delaminated areas. Care shall be exercised not to damage areas of sound concrete or reinforcing steel during concrete removal operations. Unless specifically *directed by the Engineer*, depth of removal shall not exceed 6 inches. Concrete removal shall be in accordance with a sequence approved by the Engineer.

Concrete removal shall be accomplished by chipping with hand picks, chisels or light duty pneumatic or electric chipping hammers (not to exceed 15 lbs.). If sound concrete is encountered before existing reinforcing steel is exposed, the surface shall be prepared and repaired without further removal of the concrete. When corroded reinforcing steel is exposed, concrete removal shall continue until there is a minimum 3/4 inch clearance around the exposed, corroded reinforcing bar. Care shall be taken to not damage bond to adjacent non-exposed reinforcing steel during concrete removal processes.

The perimeter of all areas where concrete is removed shall be tapered at an approximately 45° angle, except that the outer edges of all chipped areas shall be saw cut to minimum depth of 3/4 inch to prevent featheredging unless otherwise approved by the Engineer.

After all deteriorated concrete has been removed; the repair surface to receive concrete patching shall be prepared by abrasive blast cleaning. Abrasive blast

cleaning shall remove all fractured surface concrete and all traces of any unsound material or contaminants such as oil, grease, dirt, slurry, or any materials which could interfere with the bond of freshly placed concrete.

The Contractor shall dispose all removed material off State Right Of Way in an approved site.

- B. Steel Reinforcement.** All corroded reinforcing steel exposed during concrete removal shall have corrosion products removed by abrasive grit blasting or wire brush whichever is more appropriate. Furnish for replacement, as directed by the Engineer, additional linear feet of steel reinforcing bars ½” diameter by 20-foot lengths. Place these bars in areas deemed by the Engineer to require additional reinforcement. Field cutting and bending is permitted. Deliver unused bars to the nearest County Maintenance Barn. Payment will be made in accordance with Section 602.

Reinforcing steel displaying deep pitting or loss of more than 20 percent of cross-sectional area shall be removed and replaced. Such bars shall be placed in accordance with the recommendations of ACI 506R, Sections 5.4 and 5.5. In particular, bars shall not be bundled in lapped splices, but shall be placed such that the minimum spacing around each bar is three times the maximum aggregate size to allow for proper encapsulation with concrete patching.

Intersecting reinforcing bars shall be tightly secured to each other using tie wire and adequately supported to minimize movement during concrete placement.

Welded wire fabric (WWF) shall be provided as shown on the attached sketches and at each repair area larger than 1 square foot if the depth of the repair exceeds 3 inches from the original dimension of the repaired member. Sheets of adjoining WWF shall be lapped by at least one and one-half spaces at all intersections, in both directions, and be securely fastened. WWF fabric shall be supported no closer than ½ inch to the prepared concrete surface and shall have a minimum concrete cover of 1.5 inches.

WWF shall be fastened to preset anchors on a grid not more than 12 inches square. Large knots of tie wire which could result in sand pockets and voids during patching shall be avoided.

- C. Hook Fasteners.** Hook fasteners shall be positioned at the spacing as stated above or as directed by the Engineer. Any given area shall have a minimum of four anchors. The WWF shall not move or deform excessively during concrete patching. Maximum hook fastener spacing shall not exceed 2 feet on a grid pattern over the entire repair area.

Hook fasteners shall be of commercial grade galvanized steel with a minimum diameter of 3/16”. They may be mechanically set or grouted, as approved by the Engineer.

The Department will randomly select hook fasteners to be tested to verify pullout force is sufficient. If any anchors fail to meet the minimum acceptable pullout value, corrective measures shall be taken by the Contractor and further testing will be conducted.

- D. Concrete Patching.** Place and finish the new concrete for the patching area in accordance with the manufacturer's recommendations, as shown on the attached detail drawings, or as directed by the Engineer. The Engineer shall approve the Contractor's method of placing and consolidating the concrete prior to the beginning of this operation.
- E. Curing.** On completion of finishing operation, patching concrete shall immediately be prevented from drying out and cracking by fogging, wetting, and/or any appropriate method approved by the Engineer. Curing shall continue for duration recommended by the product manufacturer.

Each Contractor submitting a bid for this work shall make a thorough inspection of the site prior to submitting his bid and shall thoroughly familiarize himself with existing conditions so that the work can be expeditiously performed after a contract is awarded. Submission of a bid will be considered evidence of this inspection having been made. Any claims resulting from site conditions will not be honored by the Department. Quantities given are approximate. The quantity for "Concrete Patching Repair" shall be bid with the contingency that quantities may be increased, decreased, or eliminated by the Engineer. Dispose of all removed material entirely away from the job site as approved by the Engineer. This work is incidental to the contract unit price for "Concrete Patching Repair".

IV. MEASUREMENT

- A. Concrete Patching.** The Department will measure the quantity per square feet of each area restored.
- B. Steel Reinforcement.** See Section 602.
- C. Welded Wire Fabric & Hook Fasteners.** Welded Wire Fabric and Hook Fasteners will not be measured for payment, but shall be considered incidental to "Concrete Patching Repair".

V. PAYMENT

- A. Concrete Patching Repair.** Payment at the contract unit price per square feet is full compensation for the following: (1) Furnish all labor, materials, tools, equipment; (2) preparation of specified bents including removing and disposing of specified existing materials; (3) place, finish and cure new concrete patches; and (4) all incidentals necessary to complete the work as specified by this note and as shown on the attached detail drawings.
- B. Steel Reinforcement.** See Section 602.

The Department will consider payment as full compensation for all work required by these notes and detail drawings.

**SPECIAL NOTE FOR CONTRACT COMPLETION DATE AND
LIQUIDATED DAMAGES ON BRIDGE REPAIR CONTRACTS**

- I. COMPLETION DATE.** The Contractor has the option of selecting the starting date for this Contract. Once selected, notify the Department in writing of the date selected at least two weeks prior to beginning work. All work is to be completed by November 15, 2021. An allotted number of Calendar days are assigned to each structure in this contract as shown below.

<u>STRUCTURE</u>	<u>NO. OF CALENDAR DAYS</u>	<u>COMPLETION DATE</u>
039B00025L	30	November 15, 2021
039B00025R	30	November 15, 2021
039B00026L	30	November 15, 2021
039B00026R	30	November 15, 2021
039B00027L	30	November 15, 2021
039B00027R	30	November 15, 2021

Contrary to Section 108.07.02, the Engineer will begin charging calendar days for a structure on the day the Contractor starts work or sets up traffic control on that particular structure.

- II. LIQUIDATED DAMAGES.** Liquidated damages will be assessed the Contractor in accordance with the Transportation Cabinet, Department of Highway’s 2019 Standard Specifications for Road and Bridge Construction, Section 108.09, when either the allotted number of calendar days or the November 15, 2021 date is exceeded.

Contrary to the Standard Specifications, liquidated damages will be assessed the Contractor during the months of December, January, February and March when the contract time has expired on any individual bridge or bridges. Contract time will be charged during these months.

All construction must be completed in accordance with the weather limitations specified in Section 606 and/or Section 601 as applicable. No extension of Contract time will be granted due to inclement weather or temperature limitations that occur due to starting work on the Contract or a structure late in the construction season.

SPECIAL NOTE FOR TRAFFIC CONTROL ON BRIDGE REPAIR CONTRACTS

I. TRAFFIC CONTROL GENERAL

Except as provided herein, traffic shall be maintained in accordance with the 2019 Standard Specifications, Section 112. Except for the roadway and traffic control bid items listed, all items of work necessary to maintain and control traffic will be paid at the lump sum bid price to “Maintain and Control Traffic”.

Contrary to Section 106.01, traffic control devices used on this project may be new or used in new condition, at the beginning of the work and maintained in like new condition until completion of the work.

II. TRAFFIC COORDINATOR

Furnish a Traffic Coordinator as per Section 112. The Traffic Coordinator shall inspect the project maintenance of traffic, at least three times daily, or as directed by the Engineer, during the Contractor’s operations and at any time a lane closure is in place. The personnel shall have access on the project to a radio or telephone to be used in case of emergencies or accidents.

The Traffic Coordinator shall report all incidents throughout the work zone to the Engineer on the project. The Contractor shall furnish the name and telephone number where the Traffic Coordinator can be contacted at all times.

III. SIGNS

Contrary to Section 112.04.02, only long term signs (sign intended to be continuously in place for more than 3 days) will be measured for payment; short term signs (signs intended to be left in place for 3 days or less) will not be measured for payment but will be incidental to Maintain and Control Traffic.

The contractor is to install warning signs for wide loads in advance of the bridge under the direction of the Engineer. The Department will not measure installation, maintenance, or removal for payment, and will consider these incidentals to Maintain and Control Traffic.

IV. TEMPORARY PAVEMENT STRIPING

Skip lines and/or solid lines through the length of the tapers for lane closures and other striping as directed by the Engineer shall be temporarily covered with 6” black removable tape. Permanent removal of all other pavement striping for traffic control shall be considered incidental to Maintain and Control Traffic. Temporary pavement striping shall be paid only once per course in accordance with Section 112.04.07. The Contractor shall replace any temporary striping that becomes damaged or fails to adhere to the pavement before dark on the day of the notification. Liquidated damages shall be assessed to the Contractor at a rate of \$500 per day for failing to replace temporary striping within this time limit.

V. PROJECT PHASING & CONSTRUCTION PROCEDURES

The Contractor shall maintain one lane of traffic on the Interstate at all times in accordance with Standard Drawing No. TTC-120 and the attached detail drawings. The clear lane width required is:

<u>Structure</u>	<u>Clear Lane Width</u>
039B00025L	<u>13</u> feet
039B00025R	<u>13</u> feet
039B00026L	<u>13</u> feet
039B00026R	<u>13</u> feet
039B00027L	<u>13</u> feet
039B00027R	<u>13</u> feet

Interstate lane closures will not be permitted on these days:

Memorial Day Weekend (Friday-Monday)

Independence Day, when July 4th is on Tuesday, Wednesday, or Thursday; or

Independence Day Weekend, (Friday-Sunday)

Labor Day Weekend (Friday-Monday)

VI. BARRIER WALL

Payment of the contract unit price per linear foot for "CONCRETE BARRIER WALL TYPE 9T" shall be full compensation for furnishing, installing, maintaining, adjusting alignment as needed, removing the barrier when no longer needed, and all incidental items necessary to complete the work.

Provide one side mounted barrier wall delineator per each section of barrier. See Standard Drawing RBM-020 for types. No direct payment allowed for delineators.

VII. CRASH CUSHION / END TREATMENTS

To the satisfaction of the Engineer extend Barrier wall out of the clear zone. If Barrier wall is not extended out of the clear zone to the satisfaction of the engineer provide crash cushions / end treatments for the barrier wall.

Provide Barrier end treatments that comply with NCHRP 350 LEVEL 3.

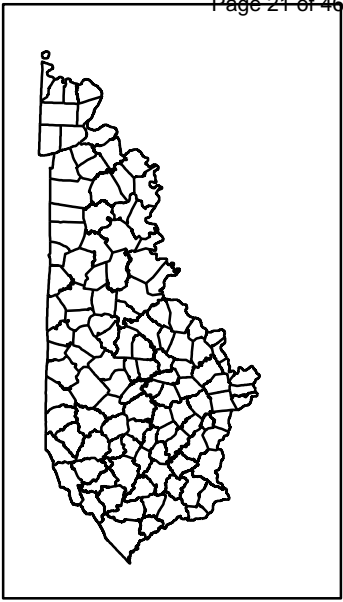

GALLATIN COUNTY

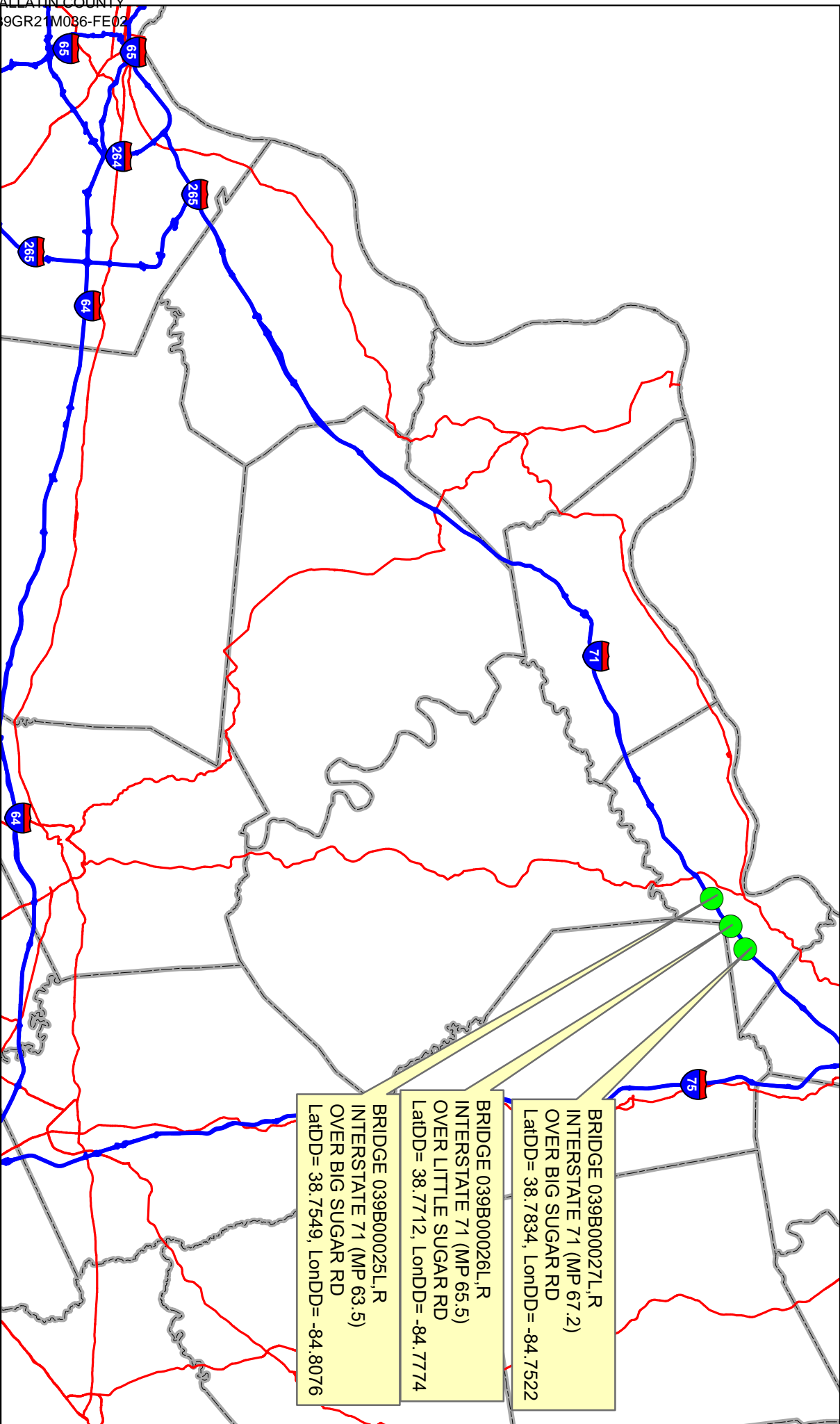

- BRIDGE 039B00027L,R
INTERSTATE 71 (MP 67.2)
OVER BIG SUGAR RD
LatDD= 38.7834, LonDD= -84.7522
- BRIDGE 039B00026L,R
INTERSTATE 71 (MP 65.5)
OVER LITTLE SUGAR RD
LatDD= 38.7712, LonDD= -84.7774
- BRIDGE 039B00025L,R
INTERSTATE 71 (MP 63.5)
OVER BIG SUGAR RD
LatDD= 38.7549, LonDD= -84.8076

MATERIAL SUMMARY

CONTRACT ID: 212903

039GR21M036-FE02

MB03900712101

INTERSTATE 71 (MP 63.519). BRIDGE OVER BIG SUGAR ROAD. BRIDGE DECK RESTORATION & WATERPROOFING.

Project Line No	Bid Code	DESCRIPTION	Quantity	Unit
0005	02003	RELOCATE TEMP CONC BARRIER	600.00	LF
0010	02562	TEMPORARY SIGNS	149.00	SQFT
0015	02650	MAINTAIN & CONTROL TRAFFIC - APPLIES TO 039B00025L	1.00	LS
0020	02653	LANE CLOSURE	2.00	EACH
0025	02671	PORTABLE CHANGEABLE MESSAGE SIGN	1.00	EACH
0030	02775	ARROW PANEL	1.00	EACH
0035	02898	RELOCATE CRASH CUSHION	1.00	EACH
0040	02900	INSTALL TEMP CRASH CUSHION	1.00	EACH
0045	03171	CONCRETE BARRIER WALL TYPE 9T	600.00	LF
0050	03299	ARMORED EDGE FOR CONCRETE	78.70	LF
0055	03300	ELIMINATE TRANSVERSE JOINT	82.20	LF
0060	03304	BRIDGE OVERLAY APPROACH PAVEMENT	422.00	SQYD
0065	06514	PAVE STRIPING-PERM PAINT-4 IN	531.00	LF
0070	06549	PAVE STRIPING-TEMP REM TAPE-B	1,000.00	LF
0075	06550	PAVE STRIPING-TEMP REM TAPE-W	2,000.00	LF
0080	06551	PAVE STRIPING-TEMP REM TAPE-Y	2,000.00	LF
0085	08150	STEEL REINFORCEMENT	868.40	LB
0090	08504	EPOXY SAND SLURRY	76.70	SQYD
0095	08510	REM EPOXY BIT FOREIGN OVERLAY	538.00	SQYD
0100	08534	CONCRETE OVERLAY-LATEX	29.90	CUYD
0105	08549	BLAST CLEANING	615.00	SQYD
0110	22146EN	CONCRETE PATCHING REPAIR	100.00	SQFT
0115	24094EC	PARTIAL DEPTH PATCHING	15.00	CUYD
0120	02003	RELOCATE TEMP CONC BARRIER	600.00	LF
0125	02562	TEMPORARY SIGNS	149.00	SQFT
0130	02650	MAINTAIN & CONTROL TRAFFIC - APPLIES TO 039B00025R	1.00	LS
0135	02653	LANE CLOSURE	2.00	EACH
0140	02671	PORTABLE CHANGEABLE MESSAGE SIGN	1.00	EACH
0145	02775	ARROW PANEL	1.00	EACH
0150	02898	RELOCATE CRASH CUSHION	1.00	EACH
0155	02900	INSTALL TEMP CRASH CUSHION	1.00	EACH
0160	03171	CONCRETE BARRIER WALL TYPE 9T	600.00	LF
0165	03299	ARMORED EDGE FOR CONCRETE	78.70	LF
0170	03300	ELIMINATE TRANSVERSE JOINT	82.20	LF
0175	03304	BRIDGE OVERLAY APPROACH PAVEMENT	422.00	SQYD
0180	06514	PAVE STRIPING-PERM PAINT-4 IN	531.00	LF
0185	06549	PAVE STRIPING-TEMP REM TAPE-B	1,000.00	LF
0190	06550	PAVE STRIPING-TEMP REM TAPE-W	2,000.00	LF
0195	06551	PAVE STRIPING-TEMP REM TAPE-Y	2,000.00	LF
0200	08150	STEEL REINFORCEMENT	868.40	LB
0205	08504	EPOXY SAND SLURRY	76.70	SQYD
0210	08510	REM EPOXY BIT FOREIGN OVERLAY	538.00	SQYD

MATERIAL SUMMARY

Project Line No	Bid Code	DESCRIPTION	Quantity	Unit
0215	08534	CONCRETE OVERLAY-LATEX	29.90	CUYD
0220	08549	BLAST CLEANING	615.00	SQYD
0225	22146EN	CONCRETE PATCHING REPAIR	200.00	SQFT
0230	24094EC	PARTIAL DEPTH PATCHING	15.00	CUYD
0235	02569	DEMOBILIZATION	1.00	LS

CONTRACT ID: 212903

039GR21M036-FE02

MB03900712102

INTERSTATE 71 (MP 65.524). BRIDGE OVER LITTLE SUGAR ROAD. BRIDGE DECK RESTORATION & WATERPROOFING.

Project Line No	Bid Code	DESCRIPTION	Quantity	Unit
0240	02003	RELOCATE TEMP CONC BARRIER	600.00	LF
0245	02562	TEMPORARY SIGNS	149.00	SQFT
0250	02650	MAINTAIN & CONTROL TRAFFIC - APPLIES TO 039B00026L	1.00	LS
0255	02653	LANE CLOSURE	2.00	EACH
0260	02671	PORTABLE CHANGEABLE MESSAGE SIGN	1.00	EACH
0265	02775	ARROW PANEL	1.00	EACH
0270	02898	RELOCATE CRASH CUSHION	1.00	EACH
0275	02900	INSTALL TEMP CRASH CUSHION	1.00	EACH
0280	03171	CONCRETE BARRIER WALL TYPE 9T	600.00	LF
0285	03299	ARMORED EDGE FOR CONCRETE	76.00	LF
0290	03300	ELIMINATE TRANSVERSE JOINT	79.60	LF
0295	03304	BRIDGE OVERLAY APPROACH PAVEMENT	422.00	SQYD
0300	06514	PAVE STRIPING-PERM PAINT-4 IN	594.00	LF
0305	06549	PAVE STRIPING-TEMP REM TAPE-B	1,000.00	LF
0310	06550	PAVE STRIPING-TEMP REM TAPE-W	2,000.00	LF
0315	06551	PAVE STRIPING-TEMP REM TAPE-Y	2,000.00	LF
0320	08150	STEEL REINFORCEMENT	868.40	LB
0325	08504	EPOXY SAND SLURRY	93.00	SQYD
0330	08510	REM EPOXY BIT FOREIGN OVERLAY	652.00	SQYD
0335	08534	CONCRETE OVERLAY-LATEX	36.20	CUYD
0340	08549	BLAST CLEANING	615.00	SQYD
0345	22146EN	CONCRETE PATCHING REPAIR	100.00	SQFT
0350	24094EC	PARTIAL DEPTH PATCHING	18.10	CUYD
0355	02003	RELOCATE TEMP CONC BARRIER	600.00	LF
0360	02562	TEMPORARY SIGNS	149.00	SQFT
0365	02650	MAINTAIN & CONTROL TRAFFIC - APPLIES TO 039B00026R	1.00	LS
0370	02653	LANE CLOSURE	2.00	EACH
0375	02671	PORTABLE CHANGEABLE MESSAGE SIGN	1.00	EACH
0380	02775	ARROW PANEL	1.00	EACH
0385	02898	RELOCATE CRASH CUSHION	1.00	EACH
0390	02900	INSTALL TEMP CRASH CUSHION	1.00	EACH
0395	03171	CONCRETE BARRIER WALL TYPE 9T	600.00	LF
0400	03299	ARMORED EDGE FOR CONCRETE	76.00	LF

MATERIAL SUMMARY

Project Line No	Bid Code	DESCRIPTION	Quantity	Unit
0405	03300	ELIMINATE TRANSVERSE JOINT	79.60	LF
0410	03304	BRIDGE OVERLAY APPROACH PAVEMENT	422.00	SQYD
0415	06514	PAVE STRIPING-PERM PAINT-4 IN	594.00	LF
0420	06549	PAVE STRIPING-TEMP REM TAPE-B	1,000.00	LF
0425	06550	PAVE STRIPING-TEMP REM TAPE-W	2,000.00	LF
0430	06551	PAVE STRIPING-TEMP REM TAPE-Y	2,000.00	LF
0435	08150	STEEL REINFORCEMENT	868.40	LB
0440	08504	EPOXY SAND SLURRY	93.00	SQYD
0445	08510	REM EPOXY BIT FOREIGN OVERLAY	652.00	SQYD
0450	08534	CONCRETE OVERLAY-LATEX	36.20	CUYD
0455	08549	BLAST CLEANING	615.00	SQYD
0460	22146EN	CONCRETE PATCHING REPAIR	100.00	SQFT
0465	24094EC	PARTIAL DEPTH PATCHING	18.10	CUYD
0470	02569	DEMOBILIZATION	1.00	LS

CONTRACT ID: 212903

039GR21M036-FE02

MB03900712103

INTERSTATE 71 (MP 67.166). BRIDGE OVER BIG SUGAR ROAD. BRIDGE DECK RESTORATION & WATERPROOFING.

Project Line No	Bid Code	DESCRIPTION	Quantity	Unit
0475	02003	RELOCATE TEMP CONC BARRIER	600.00	LF
0480	02562	TEMPORARY SIGNS	149.00	SQFT
0485	02650	MAINTAIN & CONTROL TRAFFIC - APPLIES TO 039B00027L	1.00	LS
0490	02653	LANE CLOSURE	2.00	EACH
0495	02671	PORTABLE CHANGEABLE MESSAGE SIGN	1.00	EACH
0500	02775	ARROW PANEL	1.00	EACH
0505	02898	RELOCATE CRASH CUSHION	1.00	EACH
0510	02900	INSTALL TEMP CRASH CUSHION	1.00	EACH
0515	03171	CONCRETE BARRIER WALL TYPE 9T	600.00	LF
0520	03299	ARMORED EDGE FOR CONCRETE	77.70	LF
0525	03300	ELIMINATE TRANSVERSE JOINT	81.20	LF
0530	03304	BRIDGE OVERLAY APPROACH PAVEMENT	422.00	SQYD
0535	06514	PAVE STRIPING-PERM PAINT-4 IN	531.00	LF
0540	06549	PAVE STRIPING-TEMP REM TAPE-B	1,000.00	LF
0545	06550	PAVE STRIPING-TEMP REM TAPE-W	2,000.00	LF
0550	06551	PAVE STRIPING-TEMP REM TAPE-Y	2,000.00	LF
0555	08150	STEEL REINFORCEMENT	868.40	LB
0560	08504	EPOXY SAND SLURRY	76.70	SQYD
0565	08510	REM EPOXY BIT FOREIGN OVERLAY	538.00	SQYD
0570	08534	CONCRETE OVERLAY-LATEX	29.90	CUYD
0575	08549	BLAST CLEANING	615.00	SQYD
0580	22146EN	CONCRETE PATCHING REPAIR	100.00	SQFT
0585	24094EC	PARTIAL DEPTH PATCHING	15.00	CUYD
0590	02003	RELOCATE TEMP CONC BARRIER	600.00	LF
0595	02562	TEMPORARY SIGNS	149.00	SQFT

MATERIAL SUMMARY

Project Line No	Bid Code	DESCRIPTION	Quantity	Unit
0600	02650	MAINTAIN & CONTROL TRAFFIC - APPLIES TO 039B00027R	1.00	LS
0605	02653	LANE CLOSURE	2.00	EACH
0610	02671	PORTABLE CHANGEABLE MESSAGE SIGN	1.00	EACH
0615	02775	ARROW PANEL	1.00	EACH
0620	02898	RELOCATE CRASH CUSHION	1.00	EACH
0625	02900	INSTALL TEMP CRASH CUSHION	1.00	EACH
0630	03171	CONCRETE BARRIER WALL TYPE 9T	600.00	LF
0635	03299	ARMORED EDGE FOR CONCRETE	77.70	LF
0640	03300	ELIMINATE TRANSVERSE JOINT	81.20	LF
0645	03304	BRIDGE OVERLAY APPROACH PAVEMENT	422.00	SQYD
0650	06514	PAVE STRIPING-PERM PAINT-4 IN	531.00	LF
0655	06549	PAVE STRIPING-TEMP REM TAPE-B	1,000.00	LF
0660	06550	PAVE STRIPING-TEMP REM TAPE-W	2,000.00	LF
0665	06551	PAVE STRIPING-TEMP REM TAPE-Y	2,000.00	LF
0670	08150	STEEL REINFORCEMENT	868.40	LB
0675	08504	EPOXY SAND SLURRY	76.70	SQYD
0680	08510	REM EPOXY BIT FOREIGN OVERLAY	538.00	SQYD
0685	08534	CONCRETE OVERLAY-LATEX	29.90	CUYD
0690	08549	BLAST CLEANING	615.00	SQYD
0695	22146EN	CONCRETE PATCHING REPAIR	100.00	SQFT
0700	24094EC	PARTIAL DEPTH PATCHING	15.00	CUYD
0705	02569	DEMOBILIZATION	1.00	LS

039B00025L, R

ELIMINATE TRANSVERSE JOINT

INSTALL ARMORED EDGE

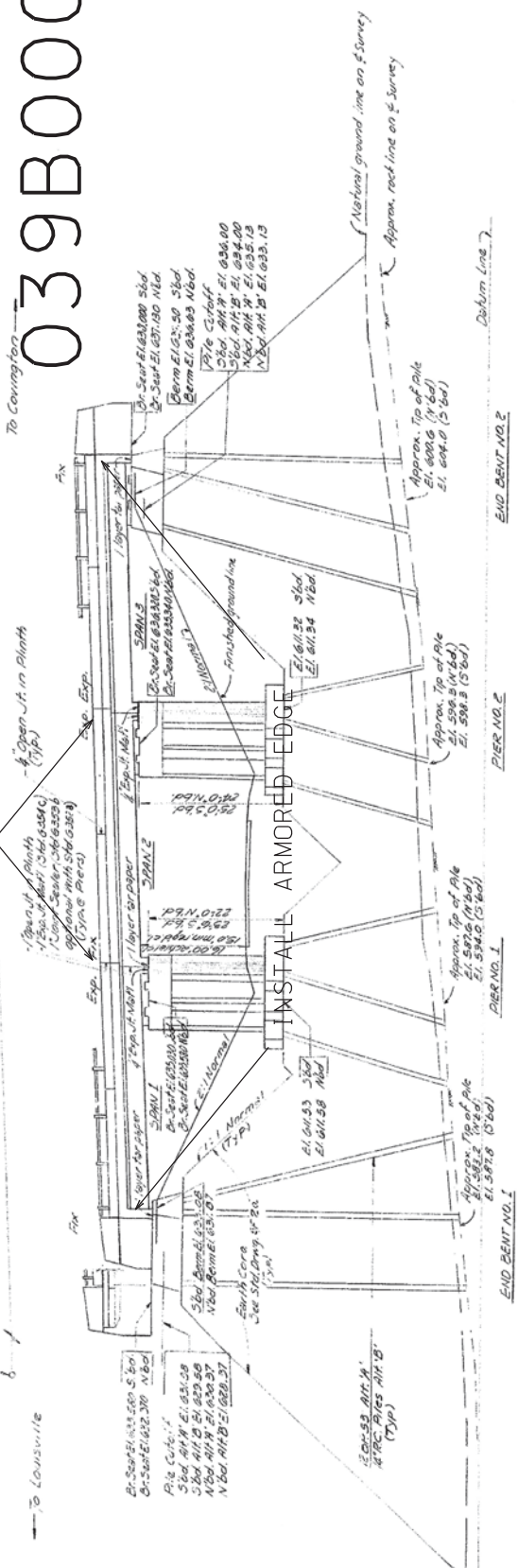

ELEVATION

4'-6" - 42'-6" - 42'-6" SIMPLE R.C.D.G SPANS - 1500 SKEW LT.
AS TO A LANDING - 30' ROADWAY - 2' - 0" 10% SAFETY CURBS
30'-0" SHOULDERS & BRIDGE

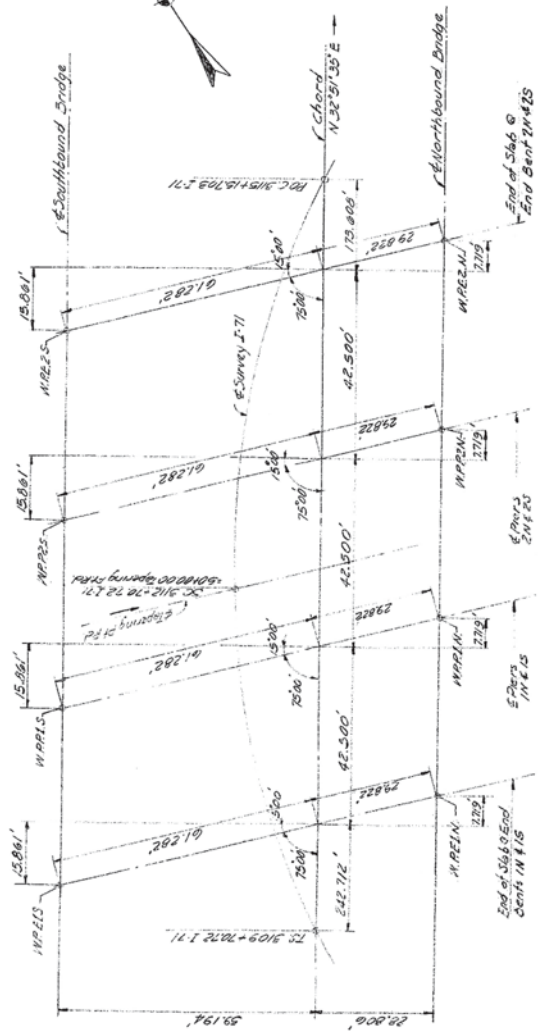

STAKE-OUT DIAGRAM

101 OVER TAPERING POINT RD. SHEET 3

COMMONWEALTH OF KENTUCKY
DEPARTMENT OF HIGHWAYS
FRANKFORT
COUNTY OF
GALLATIN
LOUISVILLE-COVINGTON
ROAD

STATION 5050.00 TAPERING PT. RD. PROJECT NO.
BRIDGE NUMBER 16130

LAYOUT

039B00027L,R

DATE	BY	CHKD	APP'D
7	RY		

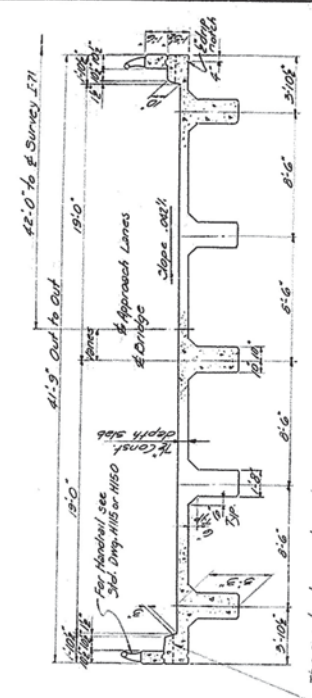

TYPICAL SECTION

CURVE DATA I-71

- A = 23°29'35" L.A.
- Dc = 7' 30"
- Ls = 600' 09"
- Lt = 7' 30"
- Lr = 103.334'
- Sr = 66.667'
- Er = 103.334'
- Lc = 2023.490'
- S.E. = 0.02 %
- Sta. 27+30.0 to 27+60.0
- Sta. 31+30.0 to 31+60.0

NOTE - FOR STAKE OUT DIAGRAM SEE SHEET 3.

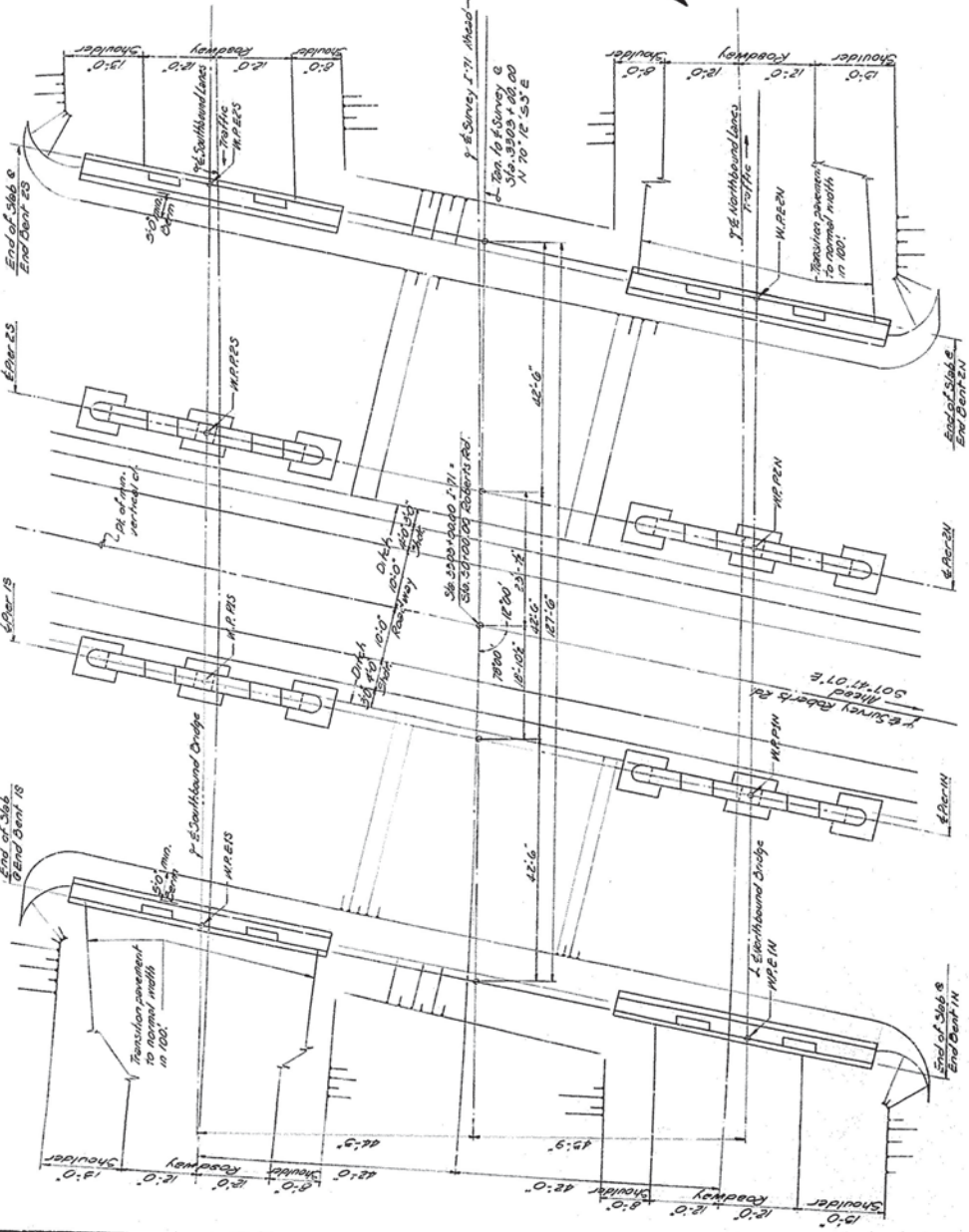

PLAN
(Deck Removed)

E-71 OVER ROBERTS RD. SHEET 2
COMMONWEALTH OF KENTUCKY
 DEPARTMENT OF HIGHWAYS
 FRANKFORT
 COUNTY OF
GALLATIN
 LOUISVILLE-COVINGTON
 ROAD
 STATION 30+00 TO 31+00
 BRIDGE NUMBER 16166

LAYOUT

DATE	BY	CHKD	APP'D
11-22	RY		

ARMORED EDGE DETAIL

Remove X-Hatched Areas of
Concrete & Expansion Device

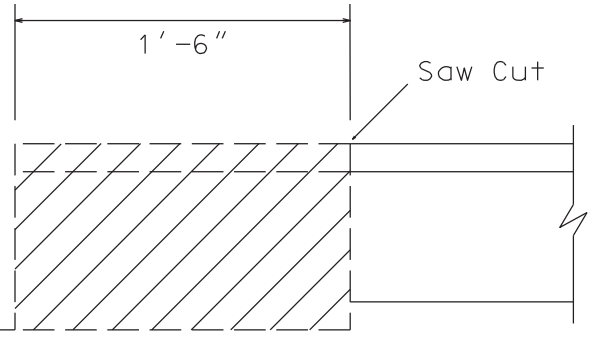

EXISTING SECTION

Pay Limits for "Armored
Edge Replacement"

See Standard
Drawing
BJE-001-11

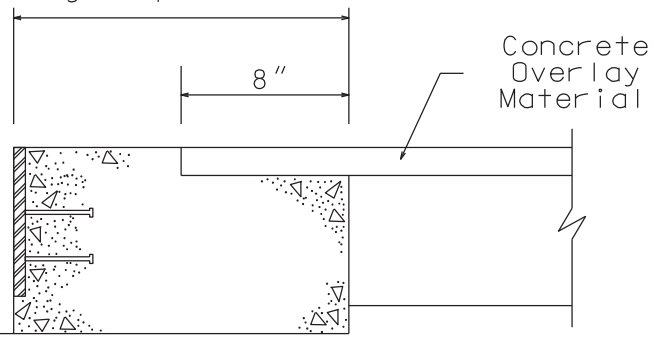

PROPOSED SECTION

ELIMINATE TRANSVERSE JOINT DETAIL

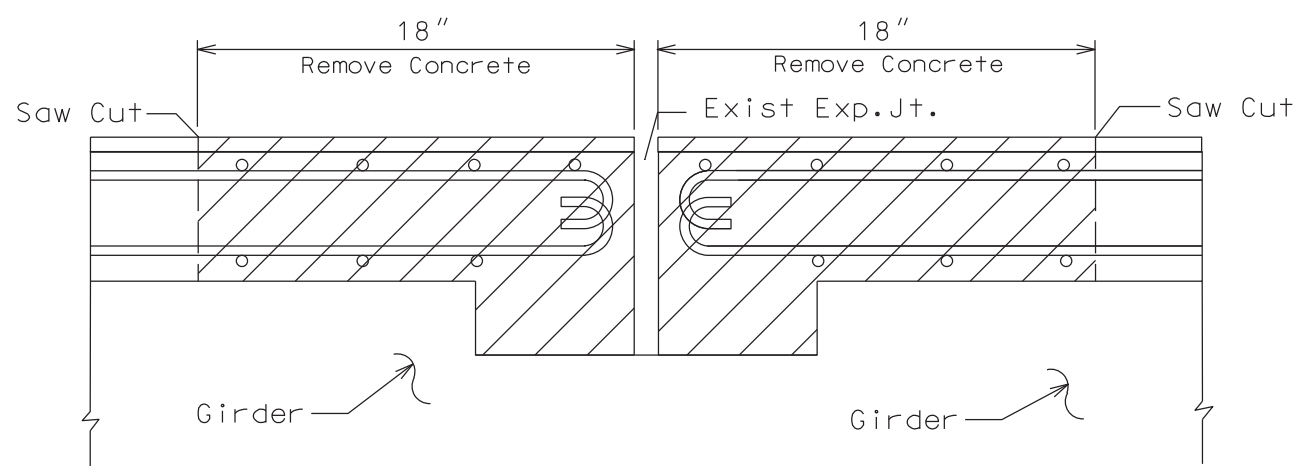

NOTE: Do not disturb existing Steel Reinforcement

EXISTING SECTION @ Transverse Joint

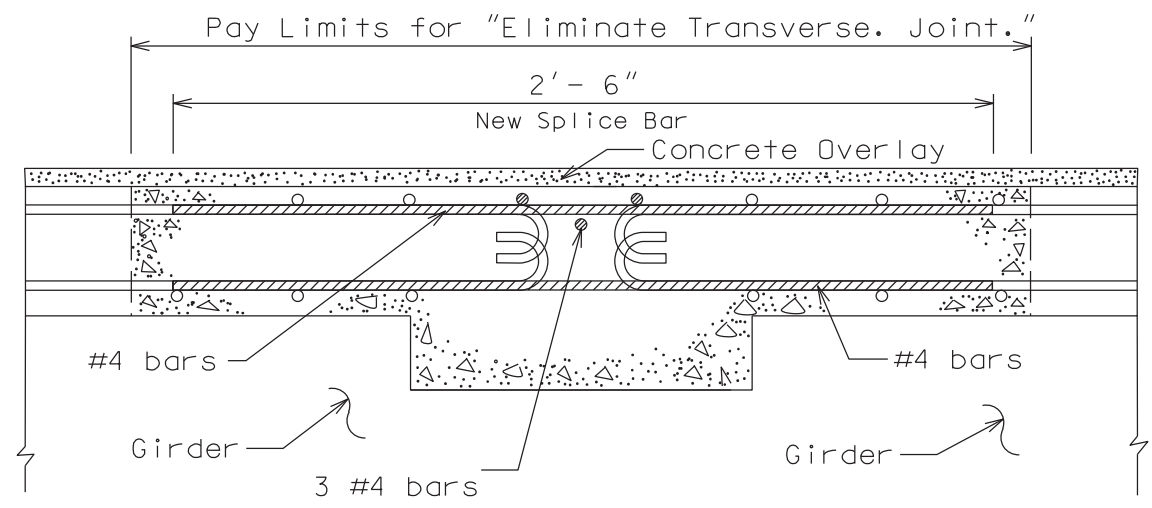

PROPOSED SECTION @ Transverse Joint

ELIMINATE TRANSVERSE JOINT DETAIL

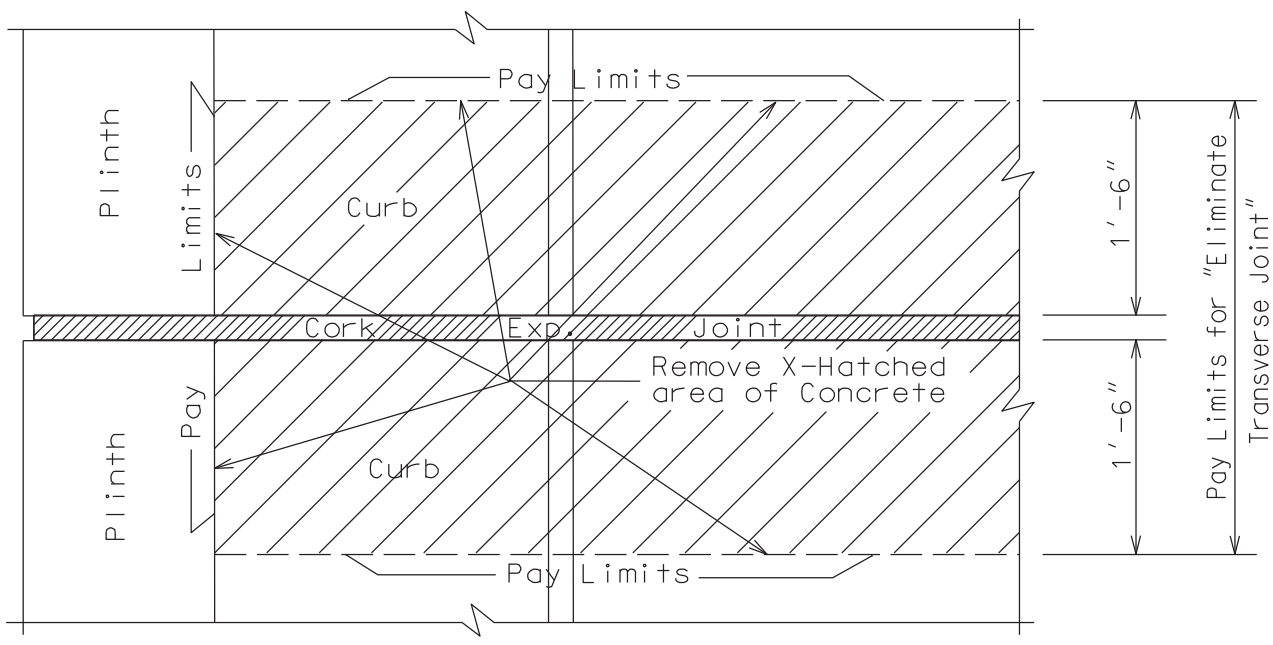

EXISTING PLAN VIEW @ CURB

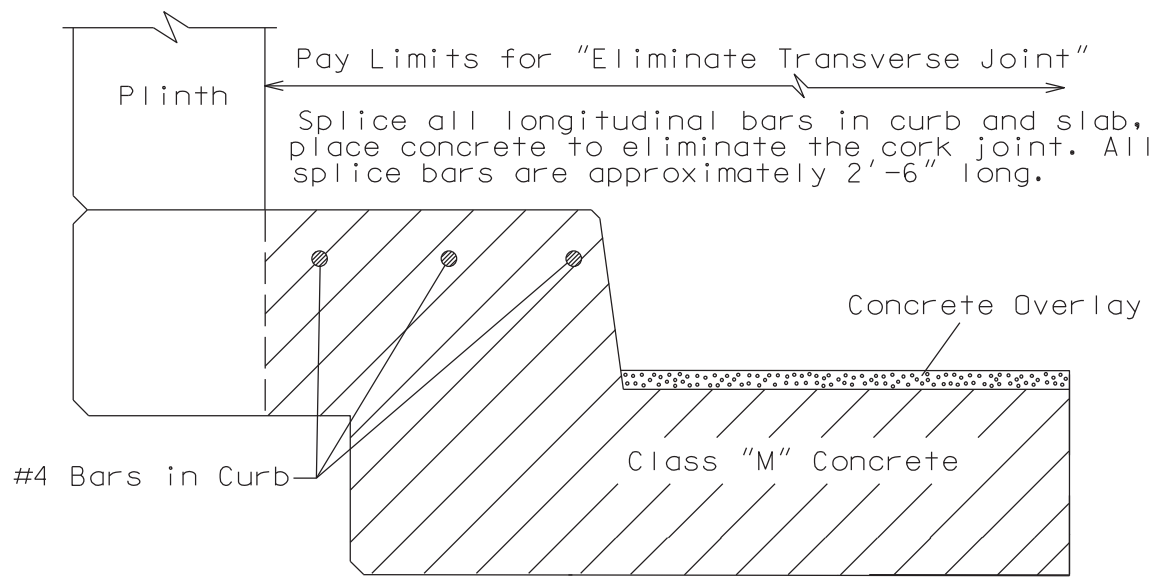

PROPOSED SECTION @ CURB

PART II
SPECIFICATIONS AND STANDARD DRAWINGS

SPECIFICATIONS REFERENCE

Any reference in the plans or proposal to previous editions of the *Standard Specifications for Road and Bridge Construction* and *Standard Drawings* are superseded by *Standard Specifications for Road and Bridge Construction, Edition of 2019* and *Standard Drawings, Edition of 2020*.

SUPPLEMENTAL SPECIFICATIONS

The contractor shall use the Supplemental Specifications that are effective at the time of letting.
The Supplemental Specifications can be found at the following link:

<http://transportation.ky.gov/Construction/Pages/Kentucky-Standard-Specifications.aspx>

STANDARD DRAWINGS THAT APPLY

ROADWAY

~ BARRIERS ~

CONCRETE MEDIAN BARRIERS

DELINEATORS FOR CONCRETE BARRIERS (Payment Incidental to Barrier Wall 9T)	RBM-020-CE
CONCRETE BARRIER WALL 9T	RBM-115-CE
CRASH CUSHION IX-T	RBE-070-CE

TRAFFIC

~ TEMPORARY ~

TRAFFIC CONTROL

LANE CLOSURE MULTI-LANE HIGHWAY CASE II	TTC-120-CE
---	------------

BRIDGES

MISCELLANEOUS STANDARDS

BRIDGE RESTORATION AND WATERPROOFING WITH CONCRETE OVERLAYS	BGX-009-CE
---	------------

JOINTS

NEOPRENE EXPANSION DAMS AND ARMORED EDGES	BJE-001-CE
EXPANSION JOINTS	BJE-002-CE
EXPANSION JOINT REPLACEMENT 1"-3"	BJE-003-CE
EXPANSION JOINT COVER PLATE DETAILS	BJE-004-CE
EXPANSION JOINT REPLACEMENT GENERAL NOTES	BJE-005-CE
EXPANSION JOINT REPLACEMENT 4" & 5"	BJE-006-CE

PART III

EMPLOYMENT, WAGE AND RECORD REQUIREMENTS

**TRANSPORTATION CABINET
DEPARTMENT OF HIGHWAYS**

**LABOR AND WAGE REQUIREMENTS
APPLICABLE TO OTHER THAN FEDERAL-AID SYSTEM PROJECTS**

- I. Application
- II. Nondiscrimination of Employees (KRS 344)

I. APPLICATION

1. These contract provisions shall apply to all work performed on the contract by the contractor with his own organization and with the assistance of workmen under his immediate superintendence and to all work performed on the contract by piecework, station work or by subcontract. The contractor's organization shall be construed to include only workmen employed and paid directly by the contractor and equipment owned or rented by him, with or without operators.

2. The contractor shall insert in each of his subcontracts all of the stipulations contained in these Required Provisions and such other stipulations as may be required.

3. A breach of any of the stipulations contained in these Required Provisions may be grounds for termination of the contract.

3. If the contractor is in control of apprenticeship or other training or retraining, including on-the-job training programs, he shall not discriminate against an individual because of his race, color, religion, national origin, sex, disability or age forty (40) and over, in admission to, or employment in any program established to provide apprenticeship or other training.

4. The contractor will send to each labor union or representative of workers with which he has a collective bargaining agreement or other contract or understanding, a notice to be provided advising the said labor union or workers' representative of the contractor's commitments under this section, and shall post copies of the notice in conspicuous places available to employees and applicants for employment. The contractor will take such action with respect to any subcontract or purchase order as the administrating agency may direct as a means of enforcing such provisions, including sanctions for non-compliance.

Revised: January 25, 2017

II. NONDISCRIMINATION OF EMPLOYEES

**AN ACT OF THE KENTUCKY
GENERAL ASSEMBLY TO PREVENT
DISCRIMINATION IN EMPLOYMENT
KRS CHAPTER 344
EFFECTIVE JUNE 16, 1972**

The contract on this project, in accordance with KRS Chapter 344, provides that during the performance of this contract, the contractor agrees as follows:

1. The contractor shall not fail or refuse to hire, or shall not discharge any individual, or otherwise discriminate against an individual with respect to his compensation, terms, conditions, or privileges of employment, because of such individual's race, color, religion, national origin, sex, disability or age (forty and above); or limit, segregate, or classify his employees in any way which would deprive or tend to deprive an individual of employment opportunities or otherwise adversely affect his status as an employee, because of such individual's race, color, religion, national origin, sex, disability or age forty (40) and over. The contractor agrees to post in conspicuous places, available to employees and applicants for employment, notices to be provided setting forth the provisions of this nondiscrimination clause.

2. The contractor shall not print or publish or cause to be printed or published a notice or advertisement relating to employment by such an employer or membership in or any classification or referral for employment by the employment agency, indicating any preference, limitation, specification, or discrimination, based on race, color, religion, national origin, sex, or age forty (40) and over, or because the person is a qualified individual with a disability, except that such a notice or advertisement may indicate a preference, limitation, or specification based on religion, national origin, sex, or age forty (40) and over, or because the person is a qualified individual with a disability, when religion, national origin, sex, or age forty (40) and over, or because the person is a qualified individual with a disability, is a bona fide occupational qualification for employment.

EXECUTIVE BRANCH CODE OF ETHICS

In the 1992 regular legislative session, the General Assembly passed and Governor Brereton Jones signed Senate Bill 63 (codified as KRS 11A), the Executive Branch Code of Ethics, which states, in part:

KRS 11A.040 (7) provides:

No present or former public servant shall, within six (6) months following termination of his office or employment, accept employment, compensation, or other economic benefit from any person or business that contracts or does business with, or is regulated by, the state in matters in which he was directly involved during the last thirty-six (36) months of his tenure. This provision shall not prohibit an individual from returning to the same business, firm, occupation, or profession in which he was involved prior to taking office or beginning his term of employment, or for which he received, prior to his state employment, a professional degree or license, provided that, for a period of six (6) months, he personally refrains from working on any matter in which he was directly involved during the last thirty-six (36) months of his tenure in state government. This subsection shall not prohibit the performance of ministerial functions, including but not limited to filing tax returns, filing applications for permits or licenses, or filing incorporation papers, nor shall it prohibit the former officer or public servant from receiving public funds disbursed through entitlement programs.

KRS 11A.040 (9) states:

A former public servant shall not represent a person or business before a state agency in a matter in which the former public servant was directly involved during the last thirty-six (36) months of his tenure, for a period of one (1) year after the latter of:

- a) The date of leaving office or termination of employment; or
- b) The date the term of office expires to which the public servant was elected.

This law is intended to promote public confidence in the integrity of state government and to declare as public policy the idea that state employees should view their work as a public trust and not as a way to obtain private benefits.

If you have worked for the executive branch of state government within the past six months, you may be subject to the law's prohibitions. The law's applicability may be different if you hold elected office or are contemplating representation of another before a state agency.

Also, if you are affiliated with a firm which does business with the state and which employs former state executive-branch employees, you should be aware that the law may apply to them.

In case of doubt, the law permits you to request an advisory opinion from the Executive Branch Ethics Commission, 3 Fountain Place, Frankfort, Kentucky 40601; telephone (502) 564-7954.

Revised: January 27, 2017

Kentucky Equal Employment Opportunity Act of 1978

The requirements of the Kentucky Equal Employment Opportunity Act of 1978 (KRS 45.560-45.640) shall apply to this Contract. The apparent low Bidder will be required to submit EEO forms to the Division of Construction Procurement, which will then forward to the Finance and Administration Cabinet for review and approval. No award will become effective until all forms are submitted and EEO/CC has certified compliance. The required EEO forms are as follows:

- EEO-1: Employer Information Report
- Affidavit of Intent to Comply
- Employee Data Sheet
- Subcontractor Report

These forms are available on the Finance and Administration's web page under ***Vendor Information, Standard Attachments and General Terms*** at the following address:
<https://www.eProcurement.ky.gov>.

Bidders currently certified as being in compliance by the Finance and Administration Cabinet may submit a copy of their approval letter in lieu of the referenced EEO forms.

For questions or assistance please contact the Finance and Administration Cabinet by email at **finance.contractcompliance@ky.gov** or by phone at 502-564-2874.

EMPLOYEE RIGHTS UNDER THE FAIR LABOR STANDARDS ACT

THE UNITED STATES DEPARTMENT OF LABOR WAGE AND HOUR DIVISION

FEDERAL MINIMUM WAGE

\$7.25 PER HOUR

BEGINNING JULY 24, 2009

OVERTIME PAY At least 1½ times your regular rate of pay for all hours worked over 40 in a workweek.

CHILD LABOR An employee must be at least **16** years old to work in most non-farm jobs and at least **18** to work in non-farm jobs declared hazardous by the Secretary of Labor.

Youths **14** and **15** years old may work outside school hours in various non-manufacturing, non-mining, non-hazardous jobs under the following conditions:

No more than

- **3** hours on a school day or **18** hours in a school week;
- **8** hours on a non-school day or **40** hours in a non-school week.

Also, work may not begin before **7 a.m.** or end after **7 p.m.**, except from June 1 through Labor Day, when evening hours are extended to **9 p.m.** Different rules apply in agricultural employment.

TIP CREDIT Employers of “tipped employees” must pay a cash wage of at least \$2.13 per hour if they claim a tip credit against their minimum wage obligation. If an employee’s tips combined with the employer’s cash wage of at least \$2.13 per hour do not equal the minimum hourly wage, the employer must make up the difference. Certain other conditions must also be met.

ENFORCEMENT The Department of Labor may recover back wages either administratively or through court action, for the employees that have been underpaid in violation of the law. Violations may result in civil or criminal action.

Employers may be assessed civil money penalties of up to \$1,100 for each willful or repeated violation of the minimum wage or overtime pay provisions of the law and up to \$11,000 for each employee who is the subject of a violation of the Act’s child labor provisions. In addition, a civil money penalty of up to \$50,000 may be assessed for each child labor violation that causes the death or serious injury of any minor employee, and such assessments may be doubled, up to \$100,000, when the violations are determined to be willful or repeated. The law also prohibits discriminating against or discharging workers who file a complaint or participate in any proceeding under the Act.

ADDITIONAL INFORMATION

- Certain occupations and establishments are exempt from the minimum wage and/or overtime pay provisions.
- Special provisions apply to workers in American Samoa and the Commonwealth of the Northern Mariana Islands.
- Some state laws provide greater employee protections; employers must comply with both.
- The law requires employers to display this poster where employees can readily see it.
- Employees under 20 years of age may be paid \$4.25 per hour during their first 90 consecutive calendar days of employment with an employer.
- Certain full-time students, student learners, apprentices, and workers with disabilities may be paid less than the minimum wage under special certificates issued by the Department of Labor.

For additional information:



1-866-4-USWAGE

(1-866-487-9243)

TTY: 1-877-889-5627



WWW.WAGEHOUR.DOL.GOV

PART IV
INSURANCE

Refer to
Kentucky Standard Specifications for Road and Bridge Construction,
current edition

PART V
BID ITEMS

PROPOSAL BID ITEMS

212903

Page 1 of 1

Report Date 3/23/21

Section: 0001 - BRIDGE

LINE	BID CODE	ALT	DESCRIPTION	QUANTITY	UNIT	UNIT PRIC	FP	AMOUNT
0010	02003		RELOCATE TEMP CONC BARRIER	3,600.00	LF		\$	
0020	02562		TEMPORARY SIGNS	894.00	SQFT		\$	
0030	02650		MAINTAIN & CONTROL TRAFFIC APPLIES TO 039B00025L	1.00	LS		\$	
0040	02650		MAINTAIN & CONTROL TRAFFIC APPLIES TO 039B00025R	1.00	LS		\$	
0050	02650		MAINTAIN & CONTROL TRAFFIC APPLIES TO 039B00026L	1.00	LS		\$	
0060	02650		MAINTAIN & CONTROL TRAFFIC APPLIES TO 039B00026R	1.00	LS		\$	
0070	02650		MAINTAIN & CONTROL TRAFFIC APPLIES TO 039B00027L	1.00	LS		\$	
0080	02650		MAINTAIN & CONTROL TRAFFIC APPLIES TO 039B00027R	1.00	LS		\$	
0090	02653		LANE CLOSURE	12.00	EACH		\$	
0100	02671		PORTABLE CHANGEABLE MESSAGE SIGN	6.00	EACH		\$	
0110	02775		ARROW PANEL	6.00	EACH		\$	
0120	02898		RELOCATE CRASH CUSHION	6.00	EACH		\$	
0130	02900		INSTALL TEMP CRASH CUSHION	6.00	EACH		\$	
0140	03171		CONCRETE BARRIER WALL TYPE 9T	3,600.00	LF		\$	
0150	03299		ARMORED EDGE FOR CONCRETE	464.80	LF		\$	
0160	03300		ELIMINATE TRANSVERSE JOINT	486.00	LF		\$	
0170	03304		BRIDGE OVERLAY APPROACH PAVEMENT	2,532.00	SQYD		\$	
0180	06514		PAVE STRIPING-PERM PAINT-4 IN	3,312.00	LF		\$	
0190	06549		PAVE STRIPING-TEMP REM TAPE-B	6,000.00	LF		\$	
0200	06550		PAVE STRIPING-TEMP REM TAPE-W	12,000.00	LF		\$	
0210	06551		PAVE STRIPING-TEMP REM TAPE-Y	12,000.00	LF		\$	
0220	08150		STEEL REINFORCEMENT	5,210.40	LB		\$	
0230	08504		EPOXY SAND SLURRY	492.80	SQYD		\$	
0240	08510		REM EPOXY BIT FOREIGN OVERLAY	3,456.00	SQYD		\$	
0250	08534		CONCRETE OVERLAY-LATEX	192.00	CUYD		\$	
0260	08549		BLAST CLEANING	3,690.00	SQYD		\$	
0270	22146EN		CONCRETE PATCHING REPAIR	700.00	SQFT		\$	
0280	24094EC		PARTIAL DEPTH PATCHING	96.20	CUYD		\$	

Section: 0002 - DEMOBILIZATION

LINE	BID CODE	ALT	DESCRIPTION	QUANTITY	UNIT	UNIT PRIC	FP	AMOUNT
0290	02569		DEMOBILIZATION	1.00	LS		\$	