



**CALL NO. 310**

**CONTRACT ID. 222976**

**CHRISTIAN COUNTY**

**FED/STATE PROJECT NUMBER FE02 024 0432 B00096N 00.92**

**DESCRIPTION CAVANAUGH LANE (KY 431)**

**WORK TYPE BRIDGE REPAIRS**

**PRIMARY COMPLETION DATE 11/15/2022**

**LETTING DATE: August 18,2022**

Sealed Bids will be received electronically through the Bid Express bidding service until 10:00 AM EASTERN DAYLIGHT TIME August 18,2022. Bids will be publicly announced at 10:00 AM EASTERN DAYLIGHT TIME.

**NO PLANS ASSOCIATED WITH THIS PROJECT.**

**REQUIRED BID PROPOSAL GUARANTY:** Not less than 5% of the total bid.

**TABLE OF CONTENTS**

PART I	SCOPE OF WORK <ul style="list-style-type: none"><li>PROJECT(S), COMPLETION DATE(S), &amp; LIQUIDATED DAMAGES</li><li>CONTRACT NOTES</li><li>STATE CONTRACT NOTES</li><li>SPECIAL NOTE(S) APPLICABLE TO PROJECT</li><li>ASBESTOS ABATEMENT REPORT</li><li>BRIDGE DRAWINGS</li></ul>
PART II	SPECIFICATIONS AND STANDARD DRAWINGS <ul style="list-style-type: none"><li>SPECIFICATIONS REFERENCE</li><li>SUPPLEMENTAL SPECIFICATION</li><li>STANDARD DRAWINGS THAT APPLY</li></ul>
PART III	EMPLOYMENT, WAGE AND RECORD REQUIREMENTS <ul style="list-style-type: none"><li>LABOR AND WAGE REQUIREMENTS</li><li>EXECUTIVE BRANCH CODE OF ETHICS</li><li>KENTUCKY EQUAL EMPLOYMENT OPPORTUNITY ACT OF 1978 LOCALITY / STATE</li><li>PROJECT WAGE RATES / STATE FUNDED</li></ul>
PART IV	INSURANCE
PART V	BID ITEMS

# **PART I**

## **SCOPE OF WORK**

**ADMINISTRATIVE DISTRICT - 02**

**CONTRACT ID - 222976**

**FE02 024 0432 B00096N 00.92**

**COUNTY - CHRISTIAN**

**PCN - MB04204312201**

**FE02 024 0432 B00096N 00.92**

CAVANAUGH LANE (KY 431) BRIDGE 024B00096N OVER I-169 AT MP 00.92BRIDGE DECK RESTORATION &  
WATERPROOFING  
GEOGRAPHIC COORDINATES LATITUDE 36:59:30.00 LONGITUDE 87:28:01.00  
ADT

**COMPLETION DATE(S):**

COMPLETED BY 11/15/2022	APPLIES TO ENTIRE CONCTRACT
30 CALENDAR Days	APPLIES TO 024B00096N

## **CONTRACT NOTES**

### **PROPOSAL ADDENDA**

All addenda to this proposal must be applied when calculating bid and certified in the bid packet submitted to the Kentucky Department of Highways. Failure to use the correct and most recent addenda may result in the bid being rejected.

### **BID SUBMITTAL**

Bidder must use the Department's electronic bidding software. The Bidder must download the bid file located on the Bid Express website ([www.bidx.com](http://www.bidx.com)) to prepare a bid packet for submission to the Department. The bidder must submit electronically using Bid Express.

### **JOINT VENTURE BIDDING**

Joint venture bidding is permissible. All companies in the joint venture must be prequalified in one of the work types in the Qualifications for Bidders for the project. The bidders must get a vendor ID for the joint venture from the Division of Construction Procurement and register the joint venture as a bidder on the project. Also, the joint venture must obtain a digital ID from Bid Express to submit a bid. A joint bid bond of 5% may be submitted for both companies or each company may submit a separate bond of 5%.

### **UNDERGROUND FACILITY DAMAGE PROTECTION**

The contractor shall make every effort to protect underground facilities from damage as prescribed in the Underground Facility Damage Protection Act of 1994, Kentucky Revised Statute KRS 367.4901 to 367.4917. It is the contractor's responsibility to determine and take steps necessary to be in compliance with federal and state damage prevention directives. When prescribed in said directives, the contractor shall submit Excavation Locate Requests to the Kentucky Contact Center (KY811) via web ticket entry. The submission of this request does not relieve the contractor from the responsibility of contacting non-member facility owners, whom shall be contacted through their individual Protection Notification Center. Non-compliance with these directives can result in the enforcement of penalties.

### **REGISTRATION WITH THE SECRETARY OF STATE BY A FOREIGN ENTITY**

Pursuant to KRS 176.085(1)(b), an agency, department, office, or political subdivision of the Commonwealth of Kentucky shall not award a state contract to a person that is a foreign entity required by [KRS 14A.9-010](#) to obtain a certificate of authority to transact business in the Commonwealth ("certificate") from the Secretary of State under [KRS 14A.9-030](#) unless the person produces the certificate within fourteen (14) days of the bid or proposal opening. If the foreign entity is not required to obtain a certificate as provided in [KRS 14A.9-010](#), the foreign entity should identify the applicable exception. Foreign entity is defined within [KRS 14A.1-070](#).

**For all foreign entities required to obtain a certificate of authority to transact business in the Commonwealth, if a copy of the certificate is not received by the contracting agency within the time frame identified above, the foreign entity's solicitation response shall be deemed non-responsive or the awarded contract shall be cancelled.**

Businesses can register with the Secretary of State at <https://secure.kentucky.gov/sos/ftbr/welcome.aspx>.

### **SPECIAL NOTE FOR PROJECT QUESTIONS DURING ADVERTISEMENT**

Questions about projects during the advertisement should be submitted in writing to the Division of Construction Procurement. This may be done by fax (502) 564-7299 or email to [kytc.projectquestions@ky.gov](mailto:kytc.projectquestions@ky.gov). The Department will attempt to answer all submitted questions. The Department reserves the right not to answer if the question is not pertinent or does not aid in clarifying the project intent.

The deadline for posting answers will be 3:00 pm Eastern Daylight Time, the day preceding the Letting. Questions may be submitted until this deadline with the understanding that the later a question is submitted, the less likely an answer will be able to be provided.

The questions and answers will be posted for each Letting under the heading "Questions & Answers" on the Construction Procurement website ([www.transportation.ky.gov/contract](http://www.transportation.ky.gov/contract)). The answers provided shall be considered part of this Special Note and, in case of a discrepancy, will govern over all other bidding documents.

### **HARDWOOD REMOVAL RESTRICTIONS**

The US Department of Agriculture has imposed a quarantine in Kentucky and several surrounding states, to prevent the spread of an invasive insect, the emerald ash borer. Hardwood cut in conjunction with the project may not be removed from the state. Chipping or burning on site is the preferred method of disposal.

### **INSTRUCTIONS FOR EXCESS MATERIAL SITES AND BORROW SITES**

Identification of excess material sites and borrow sites shall be the responsibility of the Contractor. The Contractor shall be responsible for compliance with all applicable state and federal laws and may wish to consult with the US Fish and Wildlife Service to seek protection under Section 10 of the Endangered Species Act for these activities.

### **ACCESS TO RECORDS**

The contractor, as defined in KRS 45A.030 (9) agrees that the contracting agency, the Finance and Administration Cabinet, the Auditor of Public Accounts, and the Legislative Research Commission, or their duly authorized representatives, shall have access to any books, documents, papers, records, or other evidence, which are directly pertinent to this contract for the purpose of financial audit or program review. Records and other prequalification information confidentially

disclosed as part of the bid process shall not be deemed as directly pertinent to the contract and shall be exempt from disclosure as provided in KRS 61.878(1)(c). The contractor also recognizes that any books, documents, papers, records, or other evidence, received during a financial audit or program review shall be subject to the Kentucky Open Records Act, KRS 61.870 to 61.884.

In the event of a dispute between the contractor and the contracting agency, Attorney General, or the Auditor of Public Accounts over documents that are eligible for production and review, the Finance and Administration Cabinet shall review the dispute and issue a determination, in accordance with Secretary's Order 11-004.

April 30, 2018

## **SPECIAL NOTE FOR RECIPROCAL PREFERENCE**

### **RECIPROCAL PREFERENCE TO BE GIVEN BY PUBLIC AGENCIES TO RESIDENT BIDDERS**

By reference, KRS 45A.490 to 45A.494 are incorporated herein and in compliance regarding the bidders residency. Bidders who want to claim resident bidder status should complete the Affidavit for Claiming Resident Bidder Status along with their bid in the electronic bidding software. Submittal of the Affidavit should be done along the bid in Bid Express.

April 30, 2018



**SPECIAL NOTES**  
**DISTRICT NO. 2**  
**BRIDGE DECK RESTORATION AND WATERPROOFING WITH REPAIRS**  
**CHRISTIAN COUNTY**  
**CID 222976**

**FE02 024 0431 B00096N 00.92**

Christian County ~ KY 2636 (Cavanaugh Lane) over I-169

***Geographic Coordinates***

Latitude: 36° 59' 30.00'' (36.9917)

Longitude: -087° 28' 01.00'' (-87.4669)

**Description**

2~92' Box Girder Spans, Drawing No. 16680

**SPECIAL NOTES FOR BRIDGE DECK  
RESTORATION AND WATERPROOFING**

SPECIAL NOTE WEB BEARING REPAIR

SPECIAL NOTE FOR BRIDGE DECK RESTORATION AND WATERPROOFING  
WITH CONCRETE OVERLAYS

SPECIAL NOTE FOR BEARING LUBRICATION

SPECIAL NOTE FOR CONTRACT COMPLETION DATE AND PENALTIES ON  
BRIDGE REPAIR CONTRACTS

SPECIAL NOTE FOR MAINTAINING AND CONTROLLING TRAFFIC

## SPECIAL NOTE WEB BEARING REPAIR

**1. DESCRIPTION.** Perform all work in accordance with the Kentucky Transportation Cabinet, Department of Highway's Standard Specifications for Road and Bridge Construction and applicable Supplemental Specifications, the Standard Drawings (Current Editions), this Note, and the attached detailed drawings for Steel Repairs. Section references are to the Standard Specifications. This work consists of the following: (1) Furnish all labor, materials, tools, and equipment, (2) Web Bearing Repair (3) Any other work specified as part of this contract.

**2. MATERIALS.**

**A. Concrete.** Use Class AA Concrete. See Section 601.

**B. Steel Reinforcement.** Use Grade 60. See Section 602.

**C. Stud Anchors.** The stud anchors are  $\frac{3}{4}$ " x 6" embedded stud shear connectors conforming to ASTM A108, Grade 1015.

**D. Epoxy Bond Coat.** See Section 511.

**3. CONSTRUCTION.**

**A. Jacking Plan.** The Contractor must submit a Jacking Plan, stamped by a professional engineer licensed in the State of Kentucky, for review by the Engineer, prior to starting work. No jacking will be allowed until all comments on the Jacking Plan from the Engineer are resolved. The bridge shall be jacked and supported to allow for removal of the unsound concrete. It is suggested to jack just enough to make full contact with the bridge and not raise the bridge. At no time shall differential movement between adjacent webs exceed  $\frac{1}{16}$ " while jacking. The center of the temporary support should be located directly in line with the centerline of the web and within 2'-0" of the face of the abutment. The total estimated design loads to support per web are:

Dead Load	82 kips
Live Load	107 kips
Total	189 kips

The jacking system shall be designed to support a minimum of 200% of the loads. The temporary support should not be removed until the concrete has an average compressive stress of 3500 psi.

**B. Remove Existing Materials.** Remove portions of the existing web until sound concrete is encountered as shown on the detailed drawings. The Engineer will sound the bearing areas with a hammer and mark the areas of concrete to be removed and patched. The removal of unsound material shall be accomplished with hand tools or pneumatic hammers that do not exceed twenty (20) pounds. Precautions shall be exercised to protect the underlying sound material. Saw route or, otherwise manipulate the sides of the patch so that the interface between the old concrete and new concrete are perpendicular. Ensure the concrete removal in the patch area extends less than three-quarters ( $\frac{3}{4}$ ) inch beyond any steel reinforcement more than 50 percent exposed. Care shall be taken not to damage the existing steel reinforcement, bearing anchor bars and not to penetrate the girder voids. Clean the existing abutment seats of debris. Dispose of all removed material away from the job site as directed by the Engineer.

- C. Stud Anchors:** Stud anchors may used if the existing C channel anchor bars are damage and unsuitable for reuse. See attached detail drawings. All cost to remove the damaged anchor bars, furnish and install the new anchor studs shall be considered incidental to Class AA concrete.
- D. Preparing Existing Surfaces.** Clean and straighten all existing steel reinforcement. Repair or replace any damaged reinforcement as directed by the Engineer at no addition cost to the Department. Blast clean all areas of existing concrete and structural steel to come in contact with new concrete until free of all laitance and deleterious substances within 12 hours to the placement of new concrete. Apply an epoxy bond coat immediately prior to the placement of the new concrete.
- E. Placing New Concrete, Steel Reinforcement and Armored Edges.** Form and rebuilt web to match the dimensions shown on the attached drawings. Install new steel reinforcement as shown on the attached details drawings. Drill and epoxy inject steel reinforcement as show in the attached detailed drawings. All cost to drill and epoxy inject shall be considered incidental steel reinforcement. Armored edges for replace expansion joint 4" are to be installed with the web bearing repair see Standard Drawings BJE-001, BJE-005 and BJE-006. Contrary to these Standard Drawings, Class AA Concrete will be use throughout the entire web bearing repair.
- F. Sequence of Construction.** The web bearing repair shall be completed prior to placing the joint seals and the overlay.
- G. Shop Plans.** Shop plans will not be required.
- H. Verifying Field Conditions.** The Contractor shall field verify all dimensions before ordering any material. New material that is unsuitable due to variation in existing structure shall be replaced at the Contractors expense.
- I. Damage to the structure.** The Contractor shall bear all responsibility and expense for any and all damage to the structure during the repair work, even to the removal and replacement of a fallen span, should the fallen span result from the Contractors actions.
- H. Residual Lead.** Residual lead paint may still be on bridge. The Contractor is advised to take all necessary protective measures including worker safety and environmental regulations when performing surface preparation. The Department will not consider any claims based on residual lead paint.

**4. MEASUREMENT.**

- A. Jack and Support Beam Ends.** Measurement will for "Each" for temporary web support.
- B. Remove Reinforced Concrete.** The Department will measure the quantity as "Lump Sum" for Remove Reinforce Concrete.
- C. Concrete Class AA.** See Section 601.
- D. Steel Reinforcement.** See Section 602.

**5. PAYMENT.**

- A. Jack and Support Beam Ends (20544NC).** Measurement will for “Each” for temporary web support.
- B. Remove Reinforced Concrete (08305).** The Department will measure the quantity as “Lump Sum” for Remove Reinforce Concrete.
- C. Concrete Class AA (08104).** See Section 601.
- D. Steel Reinforcement (08105).** See Section 602.

## **SPECIAL NOTE FOR BRIDGE DECK RESTORATION AND WATERPROOFING WITH CONCRETE OVERLAYS**

**1. DESCRIPTION.** Perform all work in accordance with the Kentucky Transportation Cabinet, Department of Highway's Standard Specifications for Road and Bridge Construction and applicable Supplemental Specifications, the Standard Drawings (current editions), this Note, and the attached detail drawings. Section references are to the Standard Specifications. This work consists of the following: (1) Furnish all labor, materials, tools, and equipment, (2) Machine prep the existing slab, (3) Complete full-depth and partial depth repairs as directed by the Engineer, (4) Repair/replace damaged and corroded reinforcing bars, (5) Place new concrete overlay and epoxy-sand slurry in accordance with Section 606, (6) Complete asphalt approach pavement, and (7) Any other work specified as part of this contract. All construction will be in accordance with Section 606 unless otherwise specified.

**2. MATERIALS.**

**A. Latex Concrete.** See Section 606.03.17.

**B. Bituminous Asphalt.** Use CL2 ASPH SURF 0.38D PG64-22.

**C. Epoxy-Sand Slurry.** See Section 606.03.10.

**3. CONSTRUCTION.**

**A. Machine Preparation of Existing Slab.** Remove concrete from existing slab to a depth of at least 1/4" below the existing surface, and remove all patches completely, in accordance with the requirements of Section 606.03.03.

**B. Partial Depth Slab Repair and Latex Overlay.** Remove areas determined to be unsound by the Engineer via hydro-demolition or via hand held jackhammers weighing less than 45lbs in accordance with Section 606.02.10 D. Repair/Replace all damaged or severely corroded reinforcing bars prior to partial depth repair operation. The Department will not measure material removal and will consider this work incidental to the bid item "PARTIAL DEPTH PATCHING". Mix and place Latex Modified Concrete Overlay in accordance with Sections 606.03.08 and 606.03.17.

**C. Asphalt Approach Pavement.** Mill each existing asphalt approach to the distance indicated in the attached detailed drawings. Remove the bituminous material uniformly by making an edge key, so as to provide a smooth transition to the finished bridge when a new bituminous overlay of compacted depth of approximately 1 1/2" is added to the approaches. The grinding depth may vary depending on the condition of the existing approach and final elevation of bridge end. Dispose of all removed material away from the site.

**D. Approach Pavement Repair (117B00118).** The Contractor shall repair any and all damage to the approach pavement due to this construction. A new asphalt surface wedge up to three feet for all approaches to each structure in this project shall be placed and compacted to the satisfaction of the Engineer prior to allowing traffic back onto the structure after each section of the armored edge for concrete is replaced. No additional payment will be allowed for this work, as it will be considered incidental to the pay item "Armored Edge for Concrete".

**E. Surface Texturing.** Texture the concrete surface of the overlay in accordance with Section 609.03.10.

- F. Verifying Field Conditions.** The Contractor shall field verify all dimensions before ordering any material. New material that is unsuitable due to variation in existing structure shall be replaced at the Contractors expense.
- H. Damage to the Structure.** The Contractor shall bear all responsibility and expense for all damage to the structure during the repair work even to removal and replacement of a fallen span, should the fallen span result from the Contractor's actions.
4. **MEASUREMENT.** See Section 606 and the following:
- A. Machine Preparation of Slab, Blast Cleaning, Epoxy Sand Slurry and Bridge Overlay Approach Pavement.** The Department will measure these items in square yards.
- B. Latex Modified Concrete for Overlay.** The Department will measure the quantity in cubic yards using the theoretical volume as follows for each bridge:
- 024B00096N (188'9"x26'0"x1.50") = 22.8 CY**
- C. Partial Depth Patching.** The Department will measure the quantity in cubic yards by deducting the theoretical volume of bridge deck overlay (LMC) from the total volume (as indicated by the batch quantity tickets) of Concrete required to obtain the finished grade shown on the plans or established by the Engineer.
- D. Steel Reinforcement.** The Department will measure any reinforcing steel necessary for the partial patch in pounds.
5. **PAYMENT.** See Section 606 and the following:
- A. Machine Preparation of Slab (08551).** The Department will make payment for the machine preparation of the existing slab.
- B. Partial Depth Patching (24094EC).** The Department will make payment for removing exiting materials, furnishing and placing all new materials completed and accepted.
- C. Blast Cleaning (08549).** The Department will make payment for blast cleaning all surfaces specified.
- D. Epoxy Sand Slurry (08504).** The Department will make payment for furnishing and placing all new materials as specified.
- E. Concrete Latex Overlay (08534).** The Department will make payment for furnishing and placing all new material as specified.
- F. Steel Reinforcement (08150).** The Department will make payment for steel reinforcement, if necessary.
- G. Asphalt Approach Pavement (03304).** The Department will make payment for removing existing materials, furnishing and placing all new materials as specified.

**SPECIAL NOTE FOR BEARING LUBRICATION**

**1. DESCRIPTION.**

Perform all work in accordance with the Kentucky Transportation Cabinet, Department of Highway’s Standard Specifications for Road and Bridge Construction and applicable Supplemental Specifications, the Standard Drawings, (current editions), this Note and Attached Detailed Drawings. Section references are to the Standard Specifications. This work consists of the following: (1) Furnish all labor, materials, tools, and equipment, (2) Bearing Lubrication (3) Any other work specified as part of this contract.

**2. MATERIALS.**

**A. Wash Water**

Use clean potable water for all pressure washing.

**B. Bearing Lubricant**

Use one of the lubricants from the following manufactures:

<b>Manufacture</b>	<b>Lubricant</b>
Bostik Inc.,	Never Seez - Mariner’s Choice
Mobil Oil	Mobil Centaur Moly NLGI Grades 1 or 2
Certified Labs	Premalube #1 WG

**3. CONSTRUCTION.**

**A. Stratified and Pact Rust Removal.**

Stratified and pack rust shall be removed from all bearing devices and specified limits of beams. All existing bearing lubrication shall be removed. See attached detailed drawings for each bridge showing location and quantity of the bearing devices. Hand tools including wire brushes, scrapers or impact devices (hand hammers or power chisels) are to be used for removing stratified and pack rust. All surfaces to have stratified and pack rust removed shall be cleaned to an SSPC SP-2 level. All debris collected shall be disposed of in a suitable off-site disposal facility. **All cost to complete Stratified, Pack Rust Removal shall be considered incidental to the unit price bid for “Bearing Lubrication”.**

**B. Pressure Washing.**

Bearings shall be pressure washed. All equipment for pressure washing shall be operated at a minimum pressure of up 4,000 psi with 0-degree spinner tip and/or fan tips as determined by the engineer at the working location with a minimum flow rate of 3.5 gal/minute provided that these pressures do not damage any components of the structure. Pressure and flow rates shall be reduced to a level satisfactory to the Engineer should any damage occur due to power washing procedures. Pressure washing shall be operated at distance of approximately six inches from and perpendicular to the surface. All pressure washing wands shall be equipped with a gauge to accurately determine the amount pressure used. Pressure washing of any bridge element will proceed from top of wash area to bottom of wash area. Wash water will not be released to a bridge element previously washed. Preform all pressure washing at temperatures above 40 degrees Fahrenheit. **All cost to complete Pressure Washing as specified shall be included in the Lump Sum price for Lump Sum price for “Bearing Lubrication”.**



**C. Bearing Lubrication Application.**

Bearing devices shall be lubricated as specified after all stratified rust and pack rust is removed and power washing is complete, bearing devices shall have lubricant applied to all surfaces of the bearing including bearing plates and points of movement. See attached detailed drawings for each bridge showing location and quantity of the bearing devices. Allow bearing devices to dry before lubricant is applied. Perform all bearing lubrication application at temperatures above 40 degrees Fahrenheit or in accordance with manufactures specifications. **All cost to complete Bearing Lubrication Application as specified shall be included in the unit price Each for “Bearing Lubrication”.**

**D. Sequence of Work.**

Complete all work specified before bearing lubrication is commenced.

**E. Inspection.**

The Cabinet will provide inspection for all items required in this contract. Visual inspection will be required upon completion of each work item for each structure component or at the discretion of the Engineer at any time. All visual inspection shall be performed within arm’s length distance. Bearing will have Visual Inspection.

**F. Verifying Field Conditions.**

The Contractor shall be familiar with all conditions at each bridge site. The Cabinet will not consider any claims due to the Contractor having not familiarized themselves with requirements of this work.

**G. Residual Lead.**

Residual lead paint may still be on bridge. The Contractor is advised to take all necessary protective measures including worker safety and environmental regulations when performing surface preparation. The Department will not consider any claims based on residual lead paint.

**H. Damage to the structure.**

The Contractor shall bear all responsibility and expense for any and all damage to the structure during the repair work, even to the removal and replacement of a fallen span, should the fallen span result from the Contractors actions.

**4. MEASUREMENT.**

**A. Bearing Lubrication:** The Cabinet will measure this item by Each, completed and accepted.

**5. PAYMENT.**

**A. Bearing Lubrication (24983EC):** Payment at the contract unit price “Each” is full compensation for applying bearing lubrication and all incidental items required to complete this work as specified in this note and attached detailed drawings.

**SPECIAL NOTE FOR CONTRACT COMPLETION DATE AND  
PENALTIES ON BRIDGE REPAIR CONTRACTS**

- 1. COMPLETION DATE.** The Contractor has the option of selecting the starting date for this Contract. Once selected, notify the Department in writing of the date selected at least two weeks prior to beginning work. All work is to be completed by the date listed below. An allotted number of Calendar days are assigned to each structure in this contract as shown below.

<u>STRUCTURE</u>	<u>NO. OF CALENDAR DAYS</u>	<u>COMPLETION DATE</u>
024B00096N	45	November 15, 2022

Contrary to Section 108.07.03, the Engineer will begin charging calendar days for a structure on the day the Contractor starts work or sets up traffic control on that particular structure. A **penalty of \$500.00 per day** will be assessed when the allotted number of calendar days is exceeded for each structure.

All construction must be completed in accordance with the weather limitations specified in Section 606 and/or Section 601 as applicable. No extension of Contract time will be granted due to inclement weather or temperature limitations that occur due to starting work on the Contract or a structure late in the construction season.

## **SPECIAL NOTE FOR TRAFFIC CONTROL ON BRIDGE REPAIR CONTRACTS**

### **1. TRAFFIC CONTROL GENERAL**

Except as provided herein, traffic shall be maintained in accordance with the Standard Specifications (current edition), Section 112. Except for the roadway and traffic control bid items listed, all items of work necessary to maintain and control traffic will be paid at the lump sum bid price to "Maintain and Control Traffic". Contrary to Section 106.01, traffic control devices used on this project may be new or used in new condition, at the beginning of the work and maintained in like new condition until completion of the work.

### **2. TRAFFIC COORDINATOR.**

Furnish a Traffic Coordinator as per Section 112. The Traffic Coordinator shall inspect the project maintenance of traffic, at least three times daily, or as directed by the Engineer, during the Contractor's operations and at any time a lane closure is in place. The personnel shall have access on the project to a radio or telephone to be used in case of emergencies or accidents. The Traffic Coordinator shall report all incidents throughout the work zone to the Engineer on the project. The Contractor shall furnish the name and telephone number where the Traffic Coordinator can be contacted at all times.

### **3. DIVERSIONS (BYPASS DETOURS).**

The Contractor shall close the bridge to traffic and construct a detour to maintain traffic. See attached detailed drawing for the suggested detour plan. Once work on the structure begins that impacts traffic, ensure work progresses to minimize the effected time to the public. All materials that must be made specific for the project should be ordered and made prior to closure of the bridge so that delivery does not delay progress of the work until all materials that must be made specific for the project are ordered and made so that use of the detour is minimized. The diversion plan and project schedule shall be submitted as part of the traffic control plan. All cost to close the bridge and provide all detour items shall be included in the bid item for Diversion (Bypass Detours).

### **4. ADDITIONAL LANE CLOSURES.**

Shoulder and single lane will be permitted on I-169 for any necessary work below the structure. These shoulder and lane closures will be determined by the Engineer. All shoulder and lane closures shall be removed when not working. All cost shall be considered incidental to the lump sum bid for Maintain and Control Traffic.

### **5. MEASUREMENT.**

**Maintain and Control Traffic and Diversion (Bypass Detours):**

The Cabinet will measure this item by "Lump Sum".

### **6. PAYMENT.**

**Maintain and Control Traffic (02650) and Diversions (Bypass Detours)  
(02671):**

Payment at the contract unit price for "Lump Sum" is full compensation for all items to complete this work as specified.



COMMONWEALTH OF KENTUCKY  
TRANSPORTATION CABINET  
transportation.ky.gov

Andy Beshear  
GOVERNOR

Jim Gray  
SECRETARY

# Asbestos Inspection Report

To: Tom Mathews  
District: Central Office  
Date: July 11, 2022  
Conducted By: O'Dail Lawson  
Report Prepared By: O'Dail Lawson

---

## Project and Structure Identification

Project Number: CID 222976  
Structure ID: Christian 024B00096N  
Structure Location: KY 2626 (Cavanaugh Lane) over I-169  
Sample Description: Any suspect materials collected were negative for asbestos.  
Inspection Date: July 11, 2022

## Results and Recommendations

The results of the samples collected were negative for the presence of asbestos above 1%.  
No abatement is required at this time.

It is recommended that this report accompany the 10-Day Notice of Intent for Demolition ([Notification Form DEP 7036](#)) which is to be submitted to the Kentucky Division of Air Quality prior to abatement, demolition, or renovation of any building or structure in the Commonwealth.

## BULK SAMPLE ASBESTOS ANALYSIS

[illegible]

Reviewed By: Winters Menzies  
Signature

AJHA #1 02459

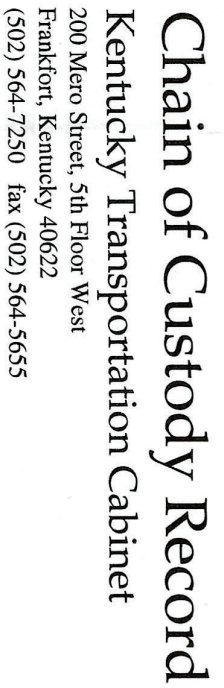

# Chain of Custody Record

# Kentucky Transportation Cabinet

200 Mero Street, 5th Floor West

Frankfort, Kentucky 40622

(502) 564-7250 fax (502) 564-5655

KYTC COC



**ENVIRONMENTAL TRAINING CONCEPTS, INC**  
P.O. Box 99603 Louisville, KY 40269  
(502)640-2951

Certification Number: ETC-AIR-031522-00137

# O'Dail Lawson

has on 03-15-2022, attended and successfully completed the requirements and passed the examination with a score of 70% of better on the entitled course.

## ASBESTOS INSPECTOR REFRESHER

Training was in accordance with 40 CFR Part 763 (AHERA) approved by the Commonwealth of Kentucky, the Indiana Department of Environmental Management, Tennessee Department of Environment & Conservation and The Arkansas Department of Environmental Quality. The above student received requisite training for Asbestos Accreditation under Title II of the Toxic Substance Act (TSCA).

Conducted at: 1220 KY Mills Drive, Louisville, KY

  
Name - Training Manager

  
Name - Instructor

Expiration Date: 03-15-2023







**Note: See Special Notes**

Commonwealth of Kentucky  
DEPARTMENT OF HIGHWAYS  
COUNTY  
**CHRISTIAN**  
*WEB BEARING REPAIR*  
PREPARED BY  
Division of Maintenance  
*Bridge Preservation Branch*



BILL OF REINFORCEMENT						
MARK	TYPE	NO.	SIZE	LENGTH	LOCATION	
A1	8	9	5	3- 5	Web Bearing Repair	A B C D
A2	25	9	5	3- 6	Web Bearing Repair	
A3	4	32	5	3- 0	Web Bearing Repair	
A4	4	8	6	3- 4	Web Bearing Repair	

TYPE 4

TYPE 25

TYPE 8

BRIDGE NO.  
024B00096N

Note: See Special Notes

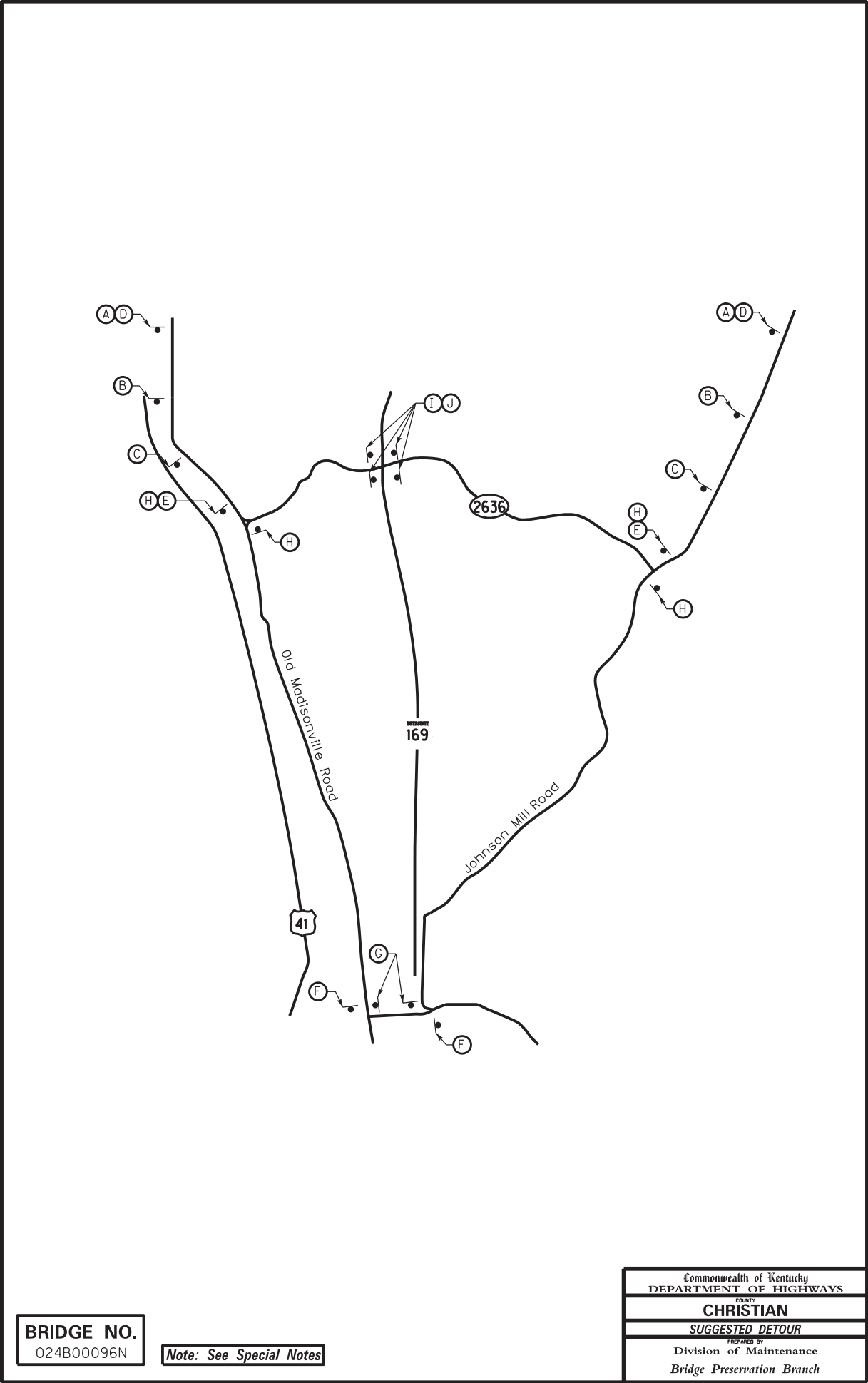

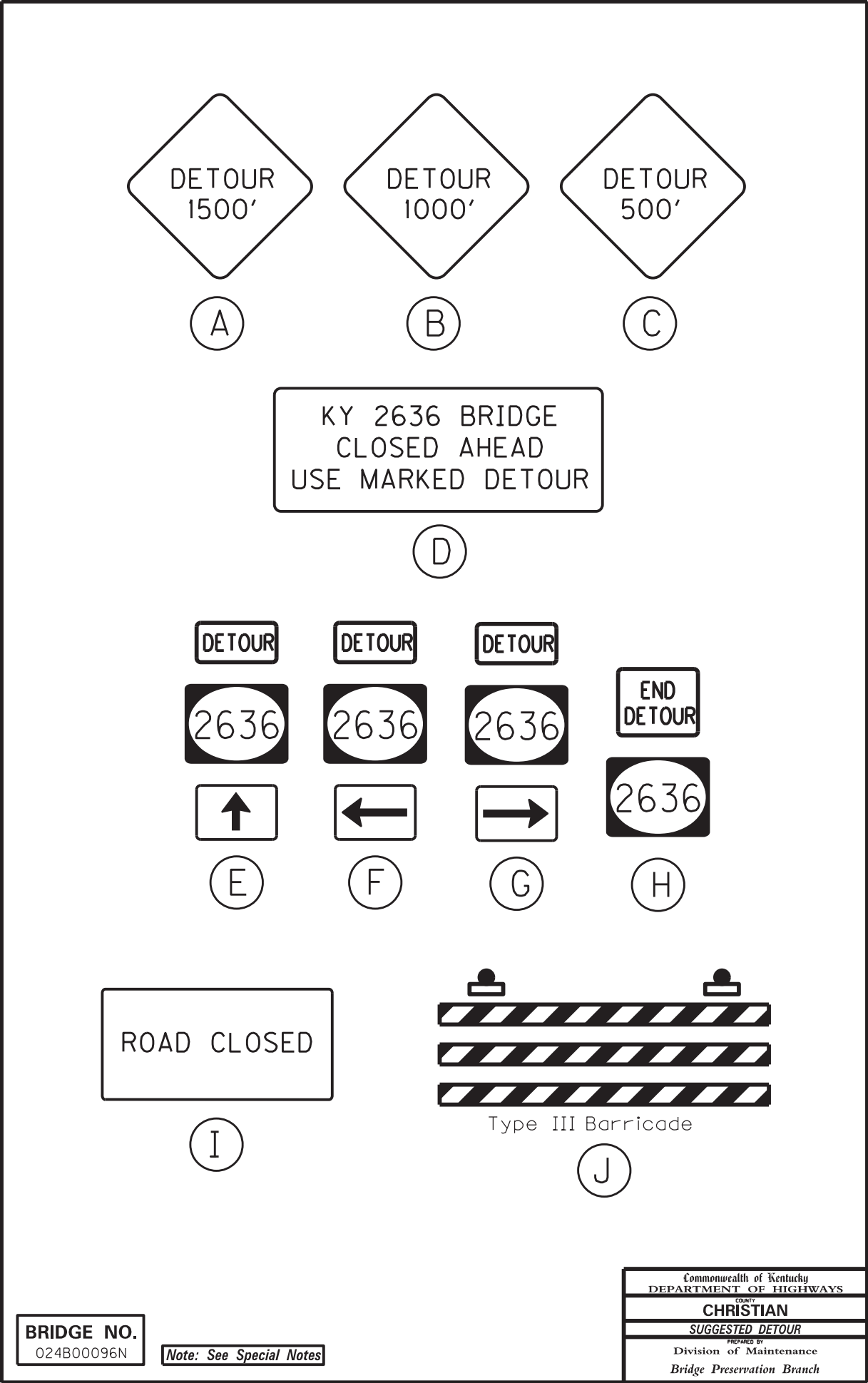

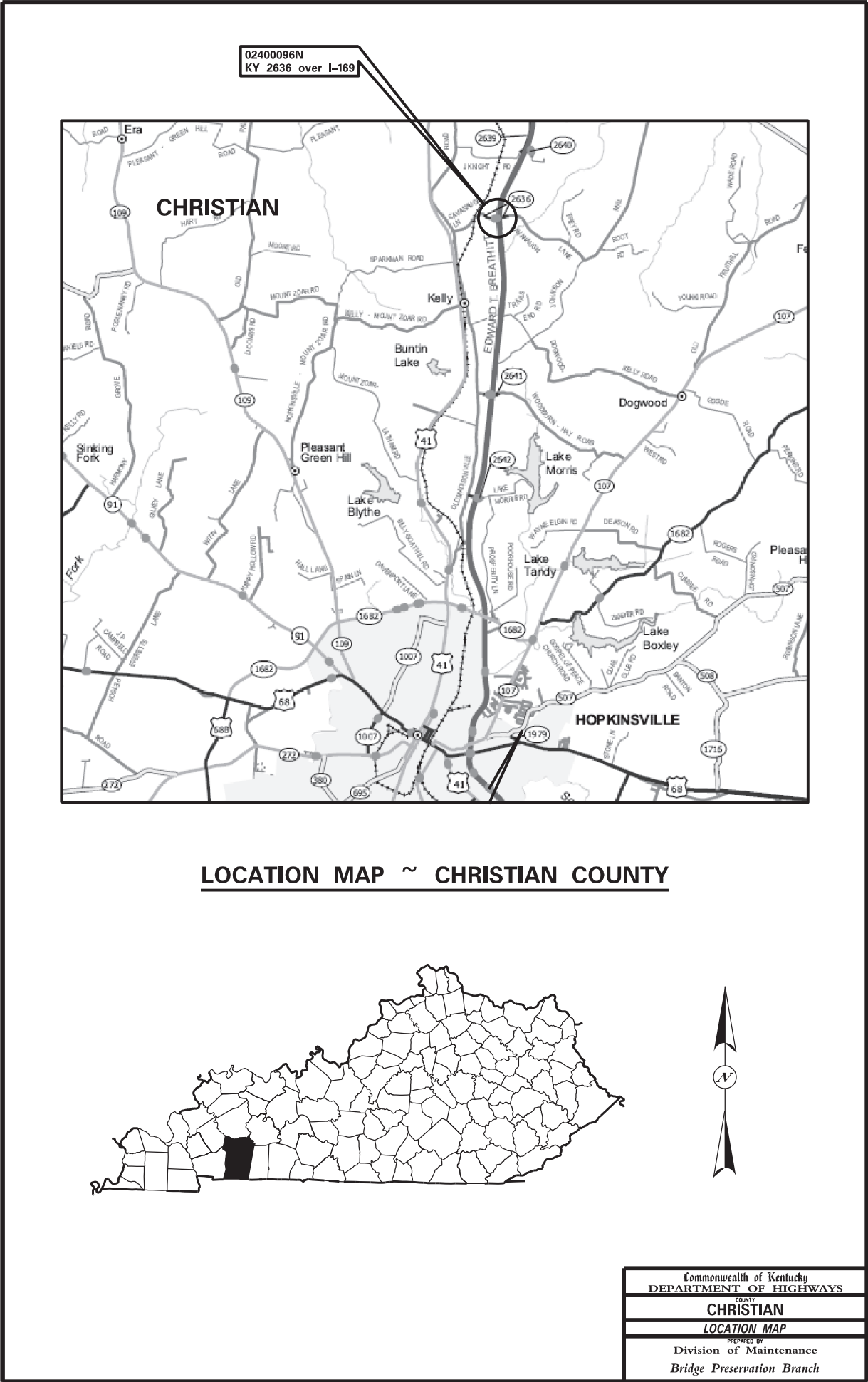

**PART II**

**SPECIFICATIONS AND STANDARD DRAWINGS**

### **SPECIFICATIONS REFERENCE**

Any reference in the plans or proposal to previous editions of the *Standard Specifications for Road and Bridge Construction* and *Standard Drawings* are superseded by *Standard Specifications for Road and Bridge Construction, Edition of 2019* and *Standard Drawings, Edition of 2020*.



## **SUPPLEMENTAL SPECIFICATIONS**

The contractor shall use the Supplemental Specifications that are effective at the time of letting.  
The Supplemental Specifications can be found at the following link:

<http://transportation.ky.gov/Construction/Pages/Kentucky-Standard-Specifications.aspx>

2020 STANDARD DRAWINGS THAT APPLY

ROADWAY  
~ *BARRIERS* ~

ENERGY ABSORPTION DEVICES

CRASH CUSHION TYPE VI-BT .....RBE-100-10

CONCRETE MEDIAN BARRIERS

DELINEATORS FOR CONCRETE BARRIERS .....RBM-020-09

CONCRETE BARRIER WALL TYPE 9T (TEMPORARY) .....RBM-115-10

TRAFFIC  
~ **TEMPORARY** ~  
TRAFFIC CONTROL

LANE CLOSURE TWO-LANE HIGHWAY .....TTC-100-04

LANE CLOSURE USING TRAFFIC SIGNALS.....TTC-110-03

LANE CLOSURE MULTI-LANE HIGHWAY CASE I.....TTC-115-03

LANE CLOSURE MULTI-LANE HIGHWAY CASE II .....TTC-120-03

DEVICES

DOUBLE FINES ZONES SIGNS.....TTD-120-02

PAVEMENT CONDITION WARNING SIGNS.....TTD-125-02

BRIDGES  
MISCELLANEOUS STANDARDS

BRIDGE RESTORATION AND WATERPROOFING WITH CONCRETE OVERLAYS .....BGX-009-04

JOINTS

NEOPRENE EXPANSION DAMS AND ARMORED EDGES .....BJE-001-13

## **PART III**

### **EMPLOYMENT, WAGE AND RECORD REQUIREMENTS**

**TRANSPORTATION CABINET  
DEPARTMENT OF HIGHWAYS**

**LABOR AND WAGE REQUIREMENTS  
APPLICABLE TO OTHER THAN FEDERAL-AID SYSTEM PROJECTS**

- I. Application
- II. Nondiscrimination of Employees (KRS 344)

**I. APPLICATION**

1. These contract provisions shall apply to all work performed on the contract by the contractor with his own organization and with the assistance of workmen under his immediate superintendence and to all work performed on the contract by piecework, station work or by subcontract. The contractor's organization shall be construed to include only workmen employed and paid directly by the contractor and equipment owned or rented by him, with or without operators.

2. The contractor shall insert in each of his subcontracts all of the stipulations contained in these Required Provisions and such other stipulations as may be required.

3. A breach of any of the stipulations contained in these Required Provisions may be grounds for termination of the contract.

3. If the contractor is in control of apprenticeship or other training or retraining, including on-the-job training programs, he shall not discriminate against an individual because of his race, color, religion, national origin, sex, disability or age forty (40) and over, in admission to, or employment in any program established to provide apprenticeship or other training.

4. The contractor will send to each labor union or representative of workers with which he has a collective bargaining agreement or other contract or understanding, a notice to be provided advising the said labor union or workers' representative of the contractor's commitments under this section, and shall post copies of the notice in conspicuous places available to employees and applicants for employment. The contractor will take such action with respect to any subcontract or purchase order as the administering agency may direct as a means of enforcing such provisions, including sanctions for non-compliance.

Revised: January 25, 2017

**II. NONDISCRIMINATION OF EMPLOYEES**

**AN ACT OF THE KENTUCKY  
GENERAL ASSEMBLY TO PREVENT  
DISCRIMINATION IN EMPLOYMENT  
KRS CHAPTER 344  
EFFECTIVE JUNE 16, 1972**

The contract on this project, in accordance with KRS Chapter 344, provides that during the performance of this contract, the contractor agrees as follows:

1. The contractor shall not fail or refuse to hire, or shall not discharge any individual, or otherwise discriminate against an individual with respect to his compensation, terms, conditions, or privileges of employment, because of such individual's race, color, religion, national origin, sex, disability or age (forty and above); or limit, segregate, or classify his employees in any way which would deprive or tend to deprive an individual of employment opportunities or otherwise adversely affect his status as an employee, because of such individual's race, color, religion, national origin, sex, disability or age forty (40) and over. The contractor agrees to post in conspicuous places, available to employees and applicants for employment, notices to be provided setting forth the provisions of this nondiscrimination clause.

2. The contractor shall not print or publish or cause to be printed or published a notice or advertisement relating to employment by such an employer or membership in or any classification or referral for employment by the employment agency, indicating any preference, limitation, specification, or discrimination, based on race, color, religion, national origin, sex, or age forty (40) and over, or because the person is a qualified individual with a disability, except that such a notice or advertisement may indicate a preference, limitation, or specification based on religion, national origin, sex, or age forty (40) and over, or because the person is a qualified individual with a disability, when religion, national origin, sex, or age forty (40) and over, or because the person is a qualified individual with a disability, is a bona fide occupational qualification for employment.

## EXECUTIVE BRANCH CODE OF ETHICS

In the 1992 regular legislative session, the General Assembly passed and Governor Brereton Jones signed Senate Bill 63 (codified as KRS 11A), the Executive Branch Code of Ethics, which states, in part:

KRS 11A.040 (7) provides:

No present or former public servant shall, within six (6) months following termination of his office or employment, accept employment, compensation, or other economic benefit from any person or business that contracts or does business with, or is regulated by, the state in matters in which he was directly involved during the last thirty-six (36) months of his tenure. This provision shall not prohibit an individual from returning to the same business, firm, occupation, or profession in which he was involved prior to taking office or beginning his term of employment, or for which he received, prior to his state employment, a professional degree or license, provided that, for a period of six (6) months, he personally refrains from working on any matter in which he was directly involved during the last thirty-six (36) months of his tenure in state government. This subsection shall not prohibit the performance of ministerial functions, including but not limited to filing tax returns, filing applications for permits or licenses, or filing incorporation papers, nor shall it prohibit the former officer or public servant from receiving public funds disbursed through entitlement programs.

KRS 11A.040 (9) states:

A former public servant shall not represent a person or business before a state agency in a matter in which the former public servant was directly involved during the last thirty-six (36) months of his tenure, for a period of one (1) year after the latter of:

- a) The date of leaving office or termination of employment; or
- b) The date the term of office expires to which the public servant was elected.

This law is intended to promote public confidence in the integrity of state government and to declare as public policy the idea that state employees should view their work as a public trust and not as a way to obtain private benefits.

If you have worked for the executive branch of state government within the past six months, you may be subject to the law's prohibitions. The law's applicability may be different if you hold elected office or are contemplating representation of another before a state agency.

Also, if you are affiliated with a firm which does business with the state and which employs former state executive-branch employees, you should be aware that the law may apply to them.

In case of doubt, the law permits you to request an advisory opinion from the Executive Branch Ethics Commission, 1025 Capital Center Drive, Suite 104, Frankfort, Kentucky 40601; telephone (502) 564-7954.

Revised: May 23, 2022

### **Kentucky Equal Employment Opportunity Act of 1978**

The requirements of the Kentucky Equal Employment Opportunity Act of 1978 (KRS 45.560-45.640) shall apply to this Contract. The apparent low Bidder will be required to submit EEO forms to the Division of Construction Procurement, which will then forward to the Finance and Administration Cabinet for review and approval. No award will become effective until all forms are submitted and EEO/CC has certified compliance. The required EEO forms are as follows:

- EEO-1: Employer Information Report
- Affidavit of Intent to Comply
- Employee Data Sheet
- Subcontractor Report

These forms are available on the Finance and Administration's web page under ***Vendor Information, Standard Attachments and General Terms*** at the following address:  
**<https://www.eProcurement.ky.gov>**.

Bidders currently certified as being in compliance by the Finance and Administration Cabinet may submit a copy of their approval letter in lieu of the referenced EEO forms.

For questions or assistance please contact the Finance and Administration Cabinet by email at **[finance.contractcompliance@ky.gov](mailto:finance.contractcompliance@ky.gov)** or by phone at 502-564-2874.

# EMPLOYEE RIGHTS

## UNDER THE FAIR LABOR STANDARDS ACT

THE UNITED STATES DEPARTMENT OF LABOR WAGE AND HOUR DIVISION

### FEDERAL MINIMUM WAGE

**\$7.25** PER HOUR

BEGINNING JULY 24, 2009

- OVERTIME PAY**

At least 1½ times your regular rate of pay for all hours worked over 40 in a workweek.
- CHILD LABOR**

An employee must be at least **16** years old to work in most non-farm jobs and at least **18** to work in non-farm jobs declared hazardous by the Secretary of Labor.

Youths **14** and **15** years old may work outside school hours in various non-manufacturing, non-mining, non-hazardous jobs under the following conditions:

*No more than*

  - **3** hours on a school day or **18** hours in a school week;
  - **8** hours on a non-school day or **40** hours in a non-school week.

Also, work may not begin before **7 a.m.** or end after **7 p.m.**, except from June 1 through Labor Day, when evening hours are extended to **9 p.m.** Different rules apply in agricultural employment.
- TIP CREDIT**

Employers of “tipped employees” must pay a cash wage of at least \$2.13 per hour if they claim a tip credit against their minimum wage obligation. If an employee’s tips combined with the employer’s cash wage of at least \$2.13 per hour do not equal the minimum hourly wage, the employer must make up the difference. Certain other conditions must also be met.
- ENFORCEMENT**

The Department of Labor may recover back wages either administratively or through court action, for the employees that have been underpaid in violation of the law. Violations may result in civil or criminal action.

Employers may be assessed civil money penalties of up to \$1,100 for each willful or repeated violation of the minimum wage or overtime pay provisions of the law and up to \$11,000 for each employee who is the subject of a violation of the Act’s child labor provisions. In addition, a civil money penalty of up to \$50,000 may be assessed for each child labor violation that causes the death or serious injury of any minor employee, and such assessments may be doubled, up to \$100,000, when the violations are determined to be willful or repeated. The law also prohibits discriminating against or discharging workers who file a complaint or participate in any proceeding under the Act.
- ADDITIONAL INFORMATION**
  - Certain occupations and establishments are exempt from the minimum wage and/or overtime pay provisions.
  - Special provisions apply to workers in American Samoa and the Commonwealth of the Northern Mariana Islands.
  - Some state laws provide greater employee protections; employers must comply with both.
  - The law requires employers to display this poster where employees can readily see it.
  - Employees under 20 years of age may be paid \$4.25 per hour during their first 90 consecutive calendar days of employment with an employer.
  - Certain full-time students, student learners, apprentices, and workers with disabilities may be paid less than the minimum wage under special certificates issued by the Department of Labor.



For additional information:

**1-866-4-USWAGE**  
(1-866-487-9243) TTY: 1-877-889-5627

**WWW.WAGEHOUR.DOL.GOV**



U.S. Wage and Hour Division

## **PART IV**

## **INSURANCE**

Refer to  
*Kentucky Standard Specifications for Road and Bridge Construction,*  
current edition



**PART V**

**BID ITEMS**

Section: 0001 - BRIDGES

LINE	BID CODE	ALT	DESCRIPTION	QUANTITY	UNIT	UNIT PRIC	FP	AMOUNT
0010	02650		MAINTAIN & CONTROL TRAFFIC - 024B00096N	1.00	LS		\$	
0020	02651		DIVERSIONS (BY-PASS DETOURS) - 024B00096N	1.00	LS		\$	
0030	03298		EXPAN JOINT REPLACE 4 IN - 024B00096N	52.80	LF		\$	
0040	03299		ARMORED EDGE FOR CONCRETE - 024B00096N	52.80	LF		\$	
0050	03304		BRIDGE OVERLAY APPROACH PAVEMENT - 024B00096N	578.00	SQYD		\$	
0060	08104		CONCRETE-CLASS AA - 024B00096N	1.00	CUYD		\$	
0070	08150		STEEL REINFORCEMENT - 024B00096N	420.00	LB		\$	
0080	08305		REMOVE REINF CONCRETE - 024B00096N	1.00	LS		\$	
0090	08504		EPOXY SAND SLURRY - 024B00096N	136.00	SQYD		\$	
0100	08534		CONCRETE OVERLAY-LATEX - 024B00096N	22.70	CUYD		\$	
0110	08549		BLAST CLEANING - 024B00096N	681.00	SQYD		\$	
0120	08551		MACHINE PREP OF SLAB - 024B00096N	546.00	SQYD		\$	
0130	20544NC		JACK AND SUPPORT BEAM ENDS - 024B00096N	1.00	EACH		\$	
0140	24094EC		PARTIAL DEPTH PATCHING - 024B00096N	11.40	CUYD		\$	
0150	24983EC		BEARING LUBRICATION - 024B00096N	8.00	EACH		\$	

Section: 0002 - DEMOB

LINE	BID CODE	ALT	DESCRIPTION	QUANTITY	UNIT	UNIT PRIC	FP	AMOUNT
0160	02569		DEMOBILIZATION	1.00	LS		\$	