

Andy Beshear
GOVERNOR

TRANSPORTATION CABINET

200 Mero Street
Frankfort, Kentucky 40601

Jim Gray
SECRETARY

March 17, 2023

CALL NO. 112
CONTRACT ID NO. 234200
ADDENDUM # 1

Subject: Hardin County, HSIP 5038 (125)
Letting March 23, 2023

- (1) Revised - Proposal Pages 74-76, 115-116, 147 & 165 of 237
- (2) Revised - Proposal Bid Items - Pages 235-237 of 237

Proposal revisions are available at <http://transportation.ky.gov/Construction-Procurement/>.

If you have any questions, please contact us at 502-564-3500.

Sincerely,

Rachel Mills,

A handwritten signature in black ink that reads "Rachel Mills".

Rachel Mills, P.E.
Director
Division of Construction Procurement

RM:mr
Enclosures

UTILITIES AND RAIL CERTIFICATION NOTE

Hardin County - HSIP 5038 (125)
FD52 047 0062 007-011
Safety Improvements along US 62 from MP 7.844 to MP 10.900
Item No. 4-9015.00

GENERAL PROJECT NOTES ON UTILITIES

For all projects over 2000 linear feet, which are defined as a “Large Project” in KRS 367.4903(18), the awarded contractor shall initially mark the first 2000 linear feet minimally of proposed excavation or construction boundaries of the project to be worked using the procedure set forth in KRS 367.4909(9)(k). This temporary field locating of the project excavation boundary shall take place prior to submitting an excavation location request to the underground utility protection Kentucky Contact Center. For large projects, the awarded contractor shall work with the impacted utilities to determine when additional white lining of the remainder of the project site will take place. This provision shall not alter or relieve the awarded contractor from complying with requirements of KRS 367.4905 to 367.4917 in their entirety.

NOTE: The information presented in this Utility Note is informational in nature and the information contained herein is not guaranteed.

The contractor will be responsible for contacting all utility facility owners on the subject project to coordinate his/her activities. The contractor will coordinate his/her activities to minimize and, where possible, avoid conflicts with utility facilities. Due to the nature of the work proposed, it is unlikely to conflict with the existing utilities beyond minor facility adjustments. Where conflicts with utility facilities are unavoidable, the contractor will coordinate any necessary relocation work with the facility owner and Resident Engineer. The Kentucky Transportation Cabinet maintains the right to remove or alter portions of this contract if a utility conflict occurs. The utility facilities as noted in the previous section(s) have been determined using data garnered by varied means and with varying degrees of accuracy: from the facility owners, a result of S.U.E., field inspections, and/or reviews of record drawings. The facilities defined may not be inclusive of all utilities in the project scope and are not Level A quality, unless specified as such. It is the contractor’s responsibility to verify all utilities and their respective locations before excavating.

The contractor shall make every effort to protect underground facilities from damage as prescribed in the Underground Facility Damage Protection Act of 1994, Kentucky Revised Statute KRS 367.4901 to 367.4917. It is the contractor’s responsibility to determine and take steps necessary to be in compliance with federal and state damage prevention directives. The contractor is instructed to contact KY 811 for the location of existing underground utilities. Contact shall be made a minimum of two (2) and no more than ten (10) business days prior to excavation. The contractor shall submit Excavation Locate Requests to the Kentucky Contact Center (KY 811) via web ticket entry. The submission of this request does not relieve the contractor from the responsibility of contacting non-member facility owners, whom are to be contacted through their individual Protection Notification Center. It may be necessary for the contractor to contact the County Court Clerk to determine what utility companies have facilities in the area. Non-compliance with these directives can result in the enforcement of penalties.

UTILITIES AND RAIL CERTIFICATION NOTE

Hardin County - HSIP 5038 (125)
FD52 047 0062 007-011
Safety Improvements along US 62 from MP 7.844 to MP 10.900
Item No. 4-9015.00

NOTE: DO NOT DISTURB THE FOLLOWING UTILITIES LOCATED WITHIN THE PROJECT DISTURB LIMITS

- Waterlines LT and RT along US 62
- Utility poles LT and RT along US 62
- Underground telecommunications LT and RT along US 62

If an unknown utility is encountered, the contractor will be responsible for arranging an on-site meeting with utility representatives and the Engineer to discuss possible impacts and solutions to either avoid the utility or relocate the utility.

The Contractor is fully responsible for protection of all utilities listed above

THE FOLLOWING COMPANIES ARE RELOCATING/ADJUSTING THEIR UTILITIES WITHIN THE PROJECT LIMITS AND WILL BE COMPLETE PRIOR TO CONSTRUCTION

- Hardin County Water District #2 – approx. RT Sta. 433+75 – 434+50 at English Station Road.
Anticipated completion date April 1, 2023.

THE FOLLOWING COMPANIES HAVE FACILITIES TO BE RELOCATED/ADJUSTED BY THE COMPANY OR THE COMPANY’S SUBCONTRACTOR AND IS TO BE COORDINATED WITH THE ROAD CONTRACT

N/A

THE FOLLOWING COMPANIES HAVE FACILITIES TO BE RELOCATED/ADJUSTED BY THE ROAD CONTRACTOR AS INCLUDED IN THIS CONTRACT

N/A

RAIL COMPANIES HAVE FACILITIES IN CONJUNCTION WITH THIS PROJECT AS NOTED

- No Rail Involvement** **Rail Involved** **Rail Adjacent**

UTILITIES AND RAIL CERTIFICATION NOTE

Hardin County - HSIP 5038 (125)
FD52 047 0062 007-011
Safety Improvements along US 62 from MP 7.844 to MP 10.900
Item No. 4-9015.00

AREA UTILITIES CONTACT LIST

<u>Utility Company/Agency</u>	<u>Contact Name</u>	<u>Contact Information</u>
1. Brandenburg Telephone	Kyle Dalton	270-766-7531 Kdalton@bbtel.com
2. Comcast	Steve Gaddie	270-401-1543 Steve_gaddie@cable.comcast.com
3. Hardin County Water District #2	Shawn Youravich	270-268-1255 youravich@hardincountywater2.org
4. Windstream	Steve Johnson	853-357-6209 Steve.johnson@windstream.net
5. Nolin Rural Electric Coop	Paul Baker	270-268-0505 pbaker@nolinrecc.com
6. KU	Brad Keown	270-735-6716 Brad.keown@lge-ku.com

NOTE: The Utilities Contact List is provided as informational only, and may not be a complete list of all Utility Companies with facilities in the project area.

US 62 - HARDIN COUNTY ITEM NO. 4-9015.00 GENERAL SUMMARY			
ITEM	DESCRIPTION	UNIT	QUANTITY
3	CRUSHED STONE BASE (7) (1)	TON	846
20	TRAFFIC BOUND BASE (7)	TON	62
78	CRUSHED AGGREGATE SIZE NO 2 (1)	TON	250
190	LEVELING & WEDGING PG64-22 (2) (1)	TON	102
212	CL2 ASPH BASE 1.00D PG64-22 (2) (7) (1)	TON	837
307	CL2 ASPH SURF 0.38B PG64-22 (2) (7) (1)	TON	1013
356	ASPHALT MATERIAL FOR TACK (1)	TON	6.4
440	ENTRANCE PIPE-15 IN (7)	LF	192
441	ENTRANCE PIPE-18 IN (7)	LF	253
462	CULVERT PIPE-18 IN (2)	LF	65
464	CULVERT PIPE-24 IN (2)	LF	118
1310	REMOVE PIPE (7) (2)	LF	292
1434	SLOPED BOX OUTLET TYPE 1-24 IN (2)	EACH	1
1727	SAFETY BOX INLET-24 IN SDB-1 (2)	EACH	1
2159	TEMP DITCH	LF	8068
2160	CLEAN TEMP DITCH	LF	4034
2230	EMBANKMENT IN PLACE	CUYD	506
2429	RIGHT-OF-WAY MONUMENT TYPE 1	EACH	6
2432	WITNESS POST	EACH	6
2460	REMOVE TREES OR STUMPS (STA. 433+55)	EACH	1
2460	REMOVE TREES OR STUMPS (STA. 434+30)	EACH	1
2460	REMOVE TREES OR STUMPS (STA. 435+01)	EACH	1
2460	REMOVE TREES OR STUMPS (STA. 435+16)	EACH	1
2483	CHANNEL LINING CLASS II (10) (11)	TON	215
2562	TEMPORARY SIGNS	SQFT	300
2569	DEMOBILIZATION	LS	1
2585	EDGE KEY (1)	LF	331
2602	GEOTEXTILE FABRIC CLASS 1 (11)	SQYD	200
2625	REMOVE HEADWALL (CULVERT PIPES) (2)	EACH	13
2625	REMOVE HEADWALL (STA. 419+54, 6'x2' RCBC) (10)	EACH	2
2650	MAINTAIN & CONTROL TRAFFIC	LS	1
2671	PORTABLE CHANGEABLE MESSAGE SIGN	EACH	2
2690	SAFEOLOADING (2)	CUYD	3
2697	EDGE LINE RUMBLE STRIPS (4)	LF	7979
2701	TEMP SILT FENCE	LF	8068
2703	SILT TRAP TYPE A	EACH	3
2704	SILT TRAP TYPE B	EACH	3
2705	SILT TRAP TYPE C	EACH	3
2706	CLEAN SILT TRAP TYPE A	EACH	3
2707	CLEAN SILT TRAP TYPE B	EACH	3
2708	CLEAN SILT TRAP TYPE C	EACH	3
2726	STAKING	LS	1
4934	TEMP SIGNAL MULTI PHASE	EACH	1
5950	EROSION CONTROL BLANKET (11)	SQYD	500
5952	TEMP MULCH	SQYD	7385
5953	TEMP SEEDING AND PROTECTION	SQYD	5535
5963	INITIAL FERTILIZER	TON	0.2
5964	MAINTENANCE FERTILIZER	TON	0.1

- ① QUANTITY CARRIED OVER FROM PAVING SUMMARY
- ② QUANTITY CARRIED OVER FROM CULVERT PIPE EXTENSION SUMMARY
- ③ QUANTITY CARRIED OVER FROM ROADSIDE REGRADING SUMMARY
- ④ QUANTITY CARRIED OVER FROM RUMBLE STRIP SUMMARY
- ⑤ QUANTITY CARRIED OVER FROM STRIPING SUMMARY
- ⑥ QUANTITY CARRIED OVER FROM PAVEMENT MARKING SUMMARY
- ⑦ QUANTITY CARRIED OVER FROM ENTRANCE SUMMARY
- ⑧ QUANTITY CARRIED OVER FROM SIGNING SUMMARY
- ⑨ QUANTITY CARRIED OVER FROM REMOVE SIGN SUMMARY
- ⑩ QUANTITY CARRIED OVER FROM BOX CULVERT EXTENSION SUMMARY
- ⑪ FOR USE AS DIRECTED BY ENGINEER

US 62 - HARDIN COUNTY ITEM NO. 4-9015.00 GENERAL SUMMARY			
ITEM	DESCRIPTION	UNIT	QUANTITY
5985	SEEDING AND PROTECTION	SQYD	3380
5992	AGRICULTURAL LIMESTONE	TON	2.1
6406	SBM ALUM SHEET SIGNS .080 IN	(8) SQFT	181.20
6407	SBM ALUM SHEET SIGNS .125 IN	(8) SQFT	27.14
6410	STEEL POST TYPE 1	(8) LF	304
6510	PAVE STRIPING-TEMP PAINT-4 IN	(11) LF	50000
6542	PAVE STRIPING-THERMO-6 IN W	(5) LF	32182
6543	PAVE STRIPING-THERMO-6 IN Y	(5) LF	21362
6568	PAVE MARKING-THERMO STOP BAR-24 IN	(6) LF	32
6569	PAVE MARKING-THERMO CROSS-HATCH	(6) SQFT	981
6574	PAVE MARKING-THERMO CURV ARROW	(6) EACH	5
8003	FOUNDATION PREPARATION (STA. 419+54, 6'x2' RCBC)	(10) EACH	1
8100	CONCRETE-CLASS A	(10) (2) CUYD	19.46
8150	STEEL REINFORCEMENT (STA. 419+54, 6'x2' RCBC)	(10) LB	1833
20748ED	SHOULDER MILLING/TRENCHING	(1) SQYD	1927
21134ND	REMOVE-STORE AND REINSTALL SIGN	(11) EACH	5
21289ED	LONGITUDINAL EDGE KEY	(1) LF	3697
21373ND	REMOVE SIGN	(9) EACH	17
21417ES717	PAVE MARK-THERMO CONE CAP-SOLID YELLOW	(6) SQFT	171
23274EN11F	TURF REINFORCEMENT MAT 1	(2) SQYD	15
24361EC	BARCODE SIGN INVENTORY	(8) EACH	49
26131ED	SLOPED AND MITERED HEADWALL-18 IN	(2) EACH	5
26132ED	SLOPED AND MITERED HEADWALL-24 IN	(2) EACH	6
26175EC	ROADSIDE REGRADING	(3) LF	2001

- ① QUANTITY CARRIED OVER FROM PAVING SUMMARY
- ② QUANTITY CARRIED OVER FROM CULVERT PIPE EXTENSION SUMMARY
- ③ QUANTITY CARRIED OVER FROM ROADSIDE REGRADING SUMMARY
- ④ QUANTITY CARRIED OVER FROM RUMBLE STRIP SUMMARY
- ⑤ QUANTITY CARRIED OVER FROM STRIPING SUMMARY
- ⑥ QUANTITY CARRIED OVER FROM PAVEMENT MARKING SUMMARY
- ⑦ QUANTITY CARRIED OVER FROM ENTRANCE SUMMARY
- ⑧ QUANTITY CARRIED OVER FROM SIGNING SUMMARY
- ⑨ QUANTITY CARRIED OVER FROM REMOVE SIGN SUMMARY
- ⑩ QUANTITY CARRIED OVER FROM BOX CULVERT EXTENSION SUMMARY
- ⑪ FOR USE AS DIRECTED BY ENGINEER

COUNTY OF	HARDIN	ITEM NO.	4-9015.00
-----------	--------	----------	-----------

ID	OFFSET	STA.	DESCRIPTION
1	RT	430+50	INTERSECTION WARNING
2	RT	434+22	STOP
3	LT	436+62	STOP
4	LT	440+25	INTERSECTION WARNING

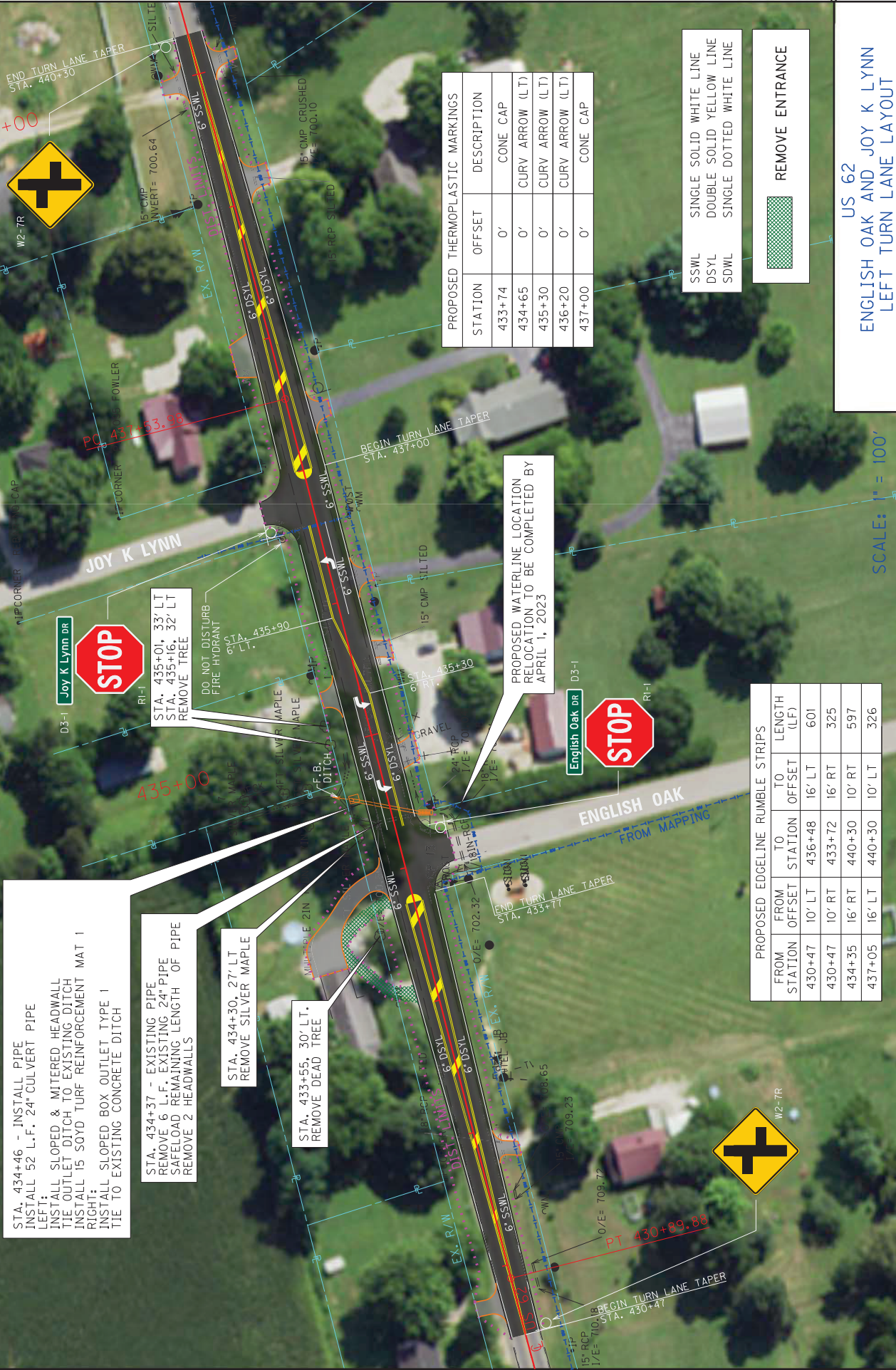

STATION	OFFSET	DESCRIPTION
433+74	0'	CONE CAP
434+65	0'	CURV ARROW (LT)
435+30	0'	CURV ARROW (LT)
436+20	0'	CURV ARROW (LT)
437+00	0'	CONE CAP

SSWL	SINGLE SOLID WHITE LINE
DSYL	DOUBLE SOLID YELLOW LINE
DSWL	SINGLE DOTTED WHITE LINE

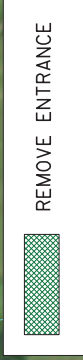

US 62
 ENGLISH OAK AND JOY K LYNN
 LEFT TURN LANE LAYOUT

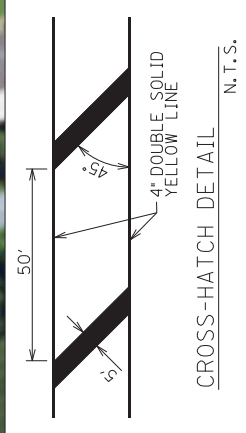

STA. 434+46 - INSTALL PIPE
 INSTALL 52 L.F. 24" CULVERT PIPE
 LEFT:
 INSTALL SLOPED & MITERED HEADWALL
 TIE OUTLET DITCH TO EXISTING DITCH
 RIGHT:
 INSTALL 15 SOYD TURF REINFORCEMENT MAT 1
 INSTALL SLOPED BOX OUTLET TYPE 1
 TIE TO EXISTING CONCRETE DITCH

STA. 434+37 - EXISTING PIPE
 REMOVE 6 L.F. EXISTING 24" PIPE
 SAFELOAD REMAINING LENGTH OF PIPE
 REMOVE 2 HEADWALLS

STA. 434+30, 27' LT
 REMOVE SILVER MAPLE

STA. 433+55, 30' LT.
 REMOVE DEAD TREE

PROPOSED WATERLINE LOCATION
 RELOCATION TO BE COMPLETED BY
 APRIL 1, 2023

FROM STATION	FROM OFFSET	TO STATION	TO OFFSET	LENGTH (LF)
430+47	10' LT	436+48	16' LT	601
430+47	10' RT	433+72	16' RT	325
434+35	16' RT	440+30	10' RT	597
437+05	16' LT	440+30	10' LT	326

SCALE: 1" = 100'

COUNTY OF	ITEM NO.
HARDIN	4-9015.00

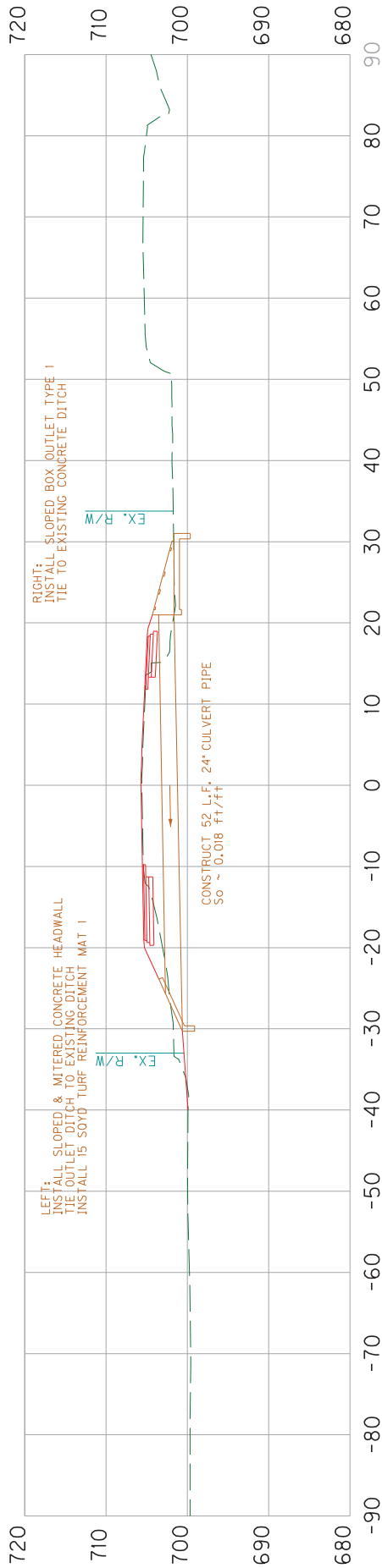

434+46
 25° 23' SK.

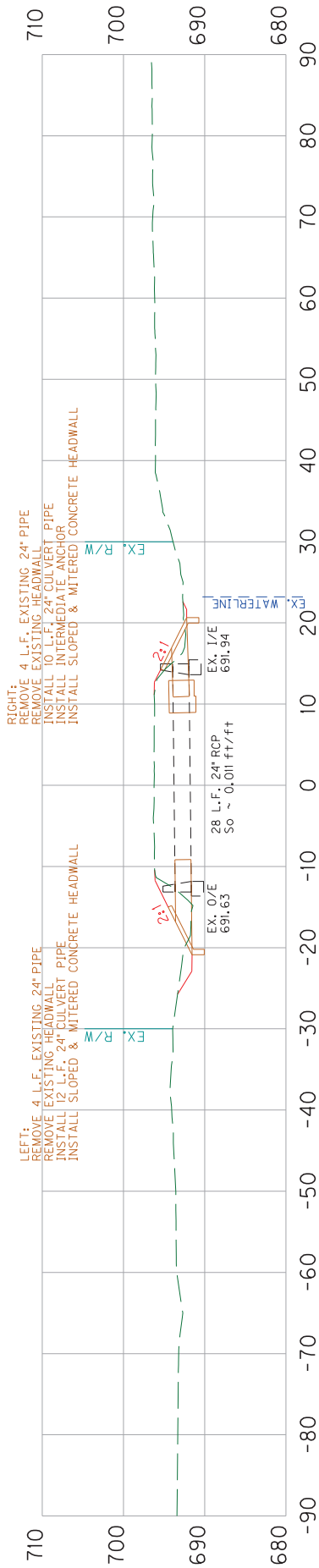

419+39

US 62
 PIPE SECTIONS SHEET 1

SCALE: 1" = 20'

PROPOSAL BID ITEMS

Report Date 3/17/23

Section: 0001 - PAVING

LINE	BID CODE	ALT	DESCRIPTION	QUANTITY	UNIT	UNIT PRIC	FP	AMOUNT
0010	00003		CRUSHED STONE BASE	846.00	TON		\$	
0020	00020		TRAFFIC BOUND BASE	62.00	TON		\$	
0030	00078		CRUSHED AGGREGATE SIZE NO 2	250.00	TON		\$	
0040	00190		LEVELING & WEDGING PG64-22	102.00	TON		\$	
0050	00212		CL2 ASPH BASE 1.00D PG64-22	837.00	TON		\$	
0060	00307		CL2 ASPH SURF 0.38B PG64-22	1,013.00	TON		\$	
0070	00356		ASPHALT MATERIAL FOR TACK	6.40	TON		\$	

Section: 0002 - ROADWAY

LINE	BID CODE	ALT	DESCRIPTION	QUANTITY	UNIT	UNIT PRIC	FP	AMOUNT
0080	02159		TEMP DITCH	8,068.00	LF		\$	
0090	02160		CLEAN TEMP DITCH	4,034.00	LF		\$	
0100	02230		EMBANKMENT IN PLACE	506.00	CUYD		\$	
0110	02429		RIGHT-OF-WAY MONUMENT TYPE 1	6.00	EACH		\$	
0120	02432		WITNESS POST	6.00	EACH		\$	
0130	02460		REMOVE TREES OR STUMPS (STA. 433+55)	1.00	EACH		\$	
0140	02460		REMOVE TREES OR STUMPS (STA. 434+30)	1.00	EACH		\$	
0150	02460		REMOVE TREES OR STUMPS (STA. 435+01)	1.00	EACH		\$	
0160	02460		REMOVE TREES OR STUMPS (STA. 435+16)	1.00	EACH		\$	
0170	02483		CHANNEL LINING CLASS II	215.00	TON		\$	
0180	02562		TEMPORARY SIGNS	300.00	SQFT		\$	
0190	02585		EDGE KEY	331.00	LF		\$	
0200	02602		FABRIC-GEOTEXTILE CLASS 1	200.00	SQYD		\$	
0210	02650		MAINTAIN & CONTROL TRAFFIC (HARDIN US 62 HSIP)	1.00	LS		\$	
0220	02671		PORTABLE CHANGEABLE MESSAGE SIGN	2.00	EACH		\$	
0230	02697		EDGELINE RUMBLE STRIPS	7,979.00	LF		\$	
0240	02701		TEMP SILT FENCE	8,068.00	LF		\$	
0250	02703		SILT TRAP TYPE A	3.00	EACH		\$	
0260	02704		SILT TRAP TYPE B	3.00	EACH		\$	
0270	02705		SILT TRAP TYPE C	3.00	EACH		\$	
0280	02706		CLEAN SILT TRAP TYPE A	3.00	EACH		\$	
0290	02707		CLEAN SILT TRAP TYPE B	3.00	EACH		\$	
0300	02708		CLEAN SILT TRAP TYPE C	3.00	EACH		\$	
0310	02726		STAKING (HARDIN US 62 HSIP)	1.00	LS		\$	
0320	04934		TEMP SIGNAL MULTI PHASE	1.00	EACH		\$	
0330	05950		EROSION CONTROL BLANKET	500.00	SQYD		\$	
0340	05952		TEMP MULCH	7,385.00	SQYD		\$	
0350	05953		TEMP SEEDING AND PROTECTION	5,535.00	SQYD		\$	
0360	05963		INITIAL FERTILIZER	.20	TON		\$	
0370	05964		MAINTENANCE FERTILIZER	.10	TON		\$	

PROPOSAL BID ITEMS

Report Date 3/17/23

LINE	BID CODE	ALT	DESCRIPTION	QUANTITY	UNIT	UNIT PRIC	FP	AMOUNT
0380	05985		SEEDING AND PROTECTION	3,380.00	SQYD		\$	
0390	05992		AGRICULTURAL LIMESTONE	2.10	TON		\$	
0400	06510		PAVE STRIPING-TEMP PAINT-4 IN	50,000.00	LF		\$	
0410	06542		PAVE STRIPING-THERMO-6 IN W	32,182.00	LF		\$	
0420	06543		PAVE STRIPING-THERMO-6 IN Y	21,362.00	LF		\$	
0430	06568		PAVE MARKING-THERMO STOP BAR-24IN	32.00	LF		\$	
0440	06569		PAVE MARKING-THERMO CROSS-HATCH	981.00	SQFT		\$	
0450	06574		PAVE MARKING-THERMO CURV ARROW	5.00	EACH		\$	
0460	20748ED		SHOULDER MILLING/TRENCHING	1,927.00	SQYD		\$	
0470	21289ED		LONGITUDINAL EDGE KEY	3,697.00	LF		\$	
0480	21417ES717		PAVE MARK THERMO CONE CAP-SOLID YELLOW	171.00	SQFT		\$	
0490	26175EC		ROADSIDE REGRADING	2,001.00	LF		\$	

Section: 0003 - DRAINAGE

LINE	BID CODE	ALT	DESCRIPTION	QUANTITY	UNIT	UNIT PRIC	FP	AMOUNT
0500	00440		ENTRANCE PIPE-15 IN	192.00	LF		\$	
0510	00441		ENTRANCE PIPE-18 IN	253.00	LF		\$	
0520	00462		CULVERT PIPE-18 IN	65.00	LF		\$	
0530	00464		CULVERT PIPE-24 IN	118.00	LF		\$	
0540	01310		REMOVE PIPE	292.00	LF		\$	
0550	01434		SLOPED BOX OUTLET TYPE 1-24 IN	1.00	EACH		\$	
0560	01727		SAFETY BOX INLET-24 IN SDB-1	1.00	EACH		\$	
0570	02625		REMOVE HEADWALL (CULVERT PIPES)	13.00	EACH		\$	
0580	02625		REMOVE HEADWALL (STA. 419+54, 6'X2' RCBC)	2.00	EACH		\$	
0590	02690		SAFELOADING	3.00	CUYD		\$	
0600	08003		FOUNDATION PREPARATION (STA. 419+54, 6'X2' RCBC)	1.00	LS		\$	
0610	08100		CONCRETE-CLASS A (REVISED 3-17-2023)	19.46	CUYD		\$	
0620	08150		STEEL REINFORCEMENT (STA. 419+54, 6'X2' RCBC)	1,833.00	LB		\$	
0630	23274EN11F		TURF REINFORCEMENT MAT 1	15.00	SQYD		\$	
0640	26131ED		SLOPED AND MITERED HEADWALL-18 IN	5.00	EACH		\$	
0650	26132ED		SLOPED AND MITERED HEADWALL-24 IN	6.00	EACH		\$	

Section: 0004 - SIGNING

LINE	BID CODE	ALT	DESCRIPTION	QUANTITY	UNIT	UNIT PRIC	FP	AMOUNT
0660	06406		SBM ALUM SHEET SIGNS .080 IN	181.20	SQFT		\$	
0670	06407		SBM ALUM SHEET SIGNS .125 IN	27.14	SQFT		\$	
0680	06410		STEEL POST TYPE 1	304.00	LF		\$	
0690	21134ND		REMOVE-STORE AND REINSTALL SIGN	5.00	EACH		\$	
0700	21373ND		REMOVE SIGN	17.00	EACH		\$	
0710	24631EC		BARCODE SIGN INVENTORY	49.00	EACH		\$	

HARDIN COUNTY
 HSIP 5038(125)
 234200

PROPOSAL BID ITEMS

Page 3 of 3

Report Date 3/17/23

Section: 0005 - DEMOBILIZATION

LINE	BID CODE	ALT	DESCRIPTION	QUANTITY	UNIT	UNIT PRIC	FP	AMOUNT
0720	02569		DEMOBILIZATION	1.00	LS		\$	