

Proposed Phase II ESA 'Step B' Boring Locations  
 M. Levy/Barr & Prevost, Inc. (Preliminary 5/29/10)

PREPARED BY \_\_\_\_\_ DATE \_\_\_\_\_  
 CHECKED BY \_\_\_\_\_ DATE \_\_\_\_\_  
 APPROVED BY \_\_\_\_\_ DATE \_\_\_\_\_

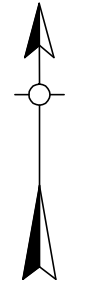
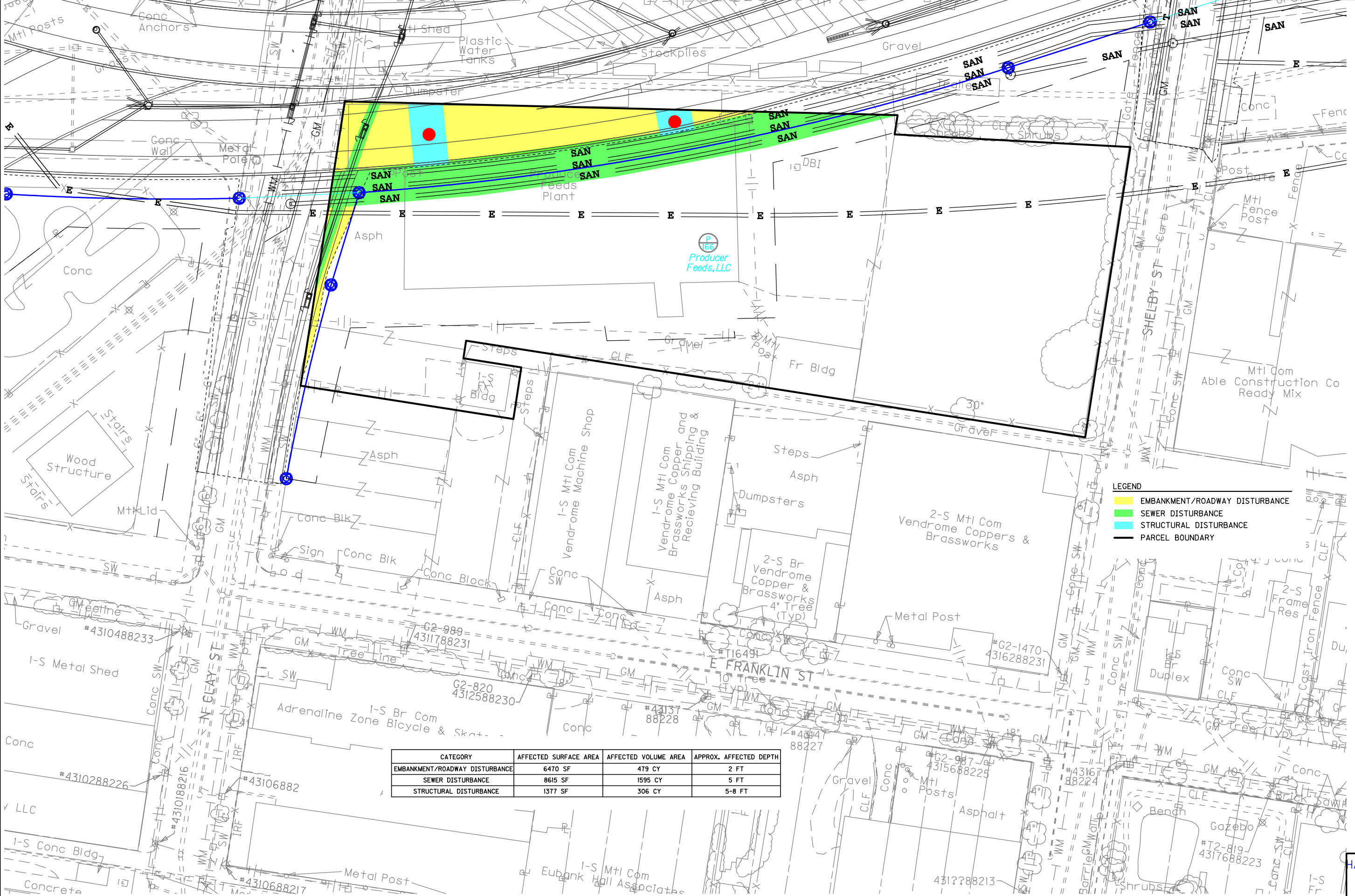

- LEGEND**
- EMBANKMENT/ROADWAY DISTURBANCE
  - SEWER DISTURBANCE
  - STRUCTURAL DISTURBANCE
  - PARCEL BOUNDARY

CATEGORY	AFFECTED SURFACE AREA	AFFECTED VOLUME AREA	APPROX. AFFECTED DEPTH
EMBANKMENT/ROADWAY DISTURBANCE	6470 SF	479 CY	2 FT
SEWER DISTURBANCE	8615 SF	1595 CY	5 FT
STRUCTURAL DISTURBANCE	1377 SF	306 CY	5-8 FT



USER: \$\$\$USER\$\$\$  
 25-MAY-2010 10:10:55  
 FILE NAME: \$\$\$design\$filespecifications\$\$\$  
 E-SHEET NAME: