

- Eating.
- Looking for things inside of your vehicle.
- Reading.
- Talking on your cell phone.

Distractions cause drivers to react more slowly to traffic conditions. They fail to recognize potential hazards such as debris in the roadway, or they fail to see the car in front of them stopping.

While you are driving, your full attention is required. By not paying attention to the traffic conditions ahead, you are a collision waiting to happen. You should be continuously scanning the roadway ahead of you, preparing to take evasive action if necessary.

PROTECTING YOUR DRIVER'S LICENSE

SUSPENSION AND REVOCATION OF LICENSE

Your license may be Suspended or Revoked for any of the following reasons:

- Driving under the influence of alcohol or other substances (DUI).
- Manslaughter resulting from the operation of a motor vehicle.
- Perjury or false affidavit to the Transportation Cabinet.
- Felony involving use of a motor vehicle.
- Reckless driving — three convictions within twelve months.
- Leaving the scene of a collision, failure to stop and disclose identity or render aid.
- Theft of a motor vehicle or any part thereof.
- Failure to maintain liability insurance.
- Failure to satisfy a citation or Court Summons.
- Failure to enroll in or complete State Traffic School upon sentence by the Court.
- Failure to complete a Graduated Licensing course for newly-licensed drivers, 16 and 17 years of age.
- Fraudulent use of a driver's license to purchase or attempt to purchase alcoholic beverages.
- Theft of gasoline.
- Operating a motor vehicle, motorcycle, or moped without a license.
- Refusing to take a chemical test when asked to do so by a law-enforcement officer.
- Failing to pay child support.
- Fleeing or Evading Police.
- Operating a motor vehicle in violation of restrictions imposed by the Transportation Cabinet.

CANCELLATION OF YOUR DRIVING PRIVILEGE

If you are under 18 years of age, the parent or legal guardian who signed your driver license application can withdraw responsibility, possibly resulting in the cancellation of your license. If the parent or legal guardian withdraws responsibility, you will have to wait until you are 18 years of age to obtain a permit and license. To withdraw responsibility, the appropriate forms and your permit/license must be turned in to the Circuit Clerk.

LICENSE VOLUNTARILY SURRENDERED

A driver may voluntarily surrender his Kentucky Driver License by completing an appropriate form in the Circuit Court Clerk's office. To surrender your license, submit the completed form and your driver's license to the Clerk.

INSURANCE LAW

All motor vehicles registered or operated in Kentucky must be covered by liability insurance and basic no-fault personal injury insurance. Failure to carry insurance is a criminal offense. The penalties include fines, loss of license plates, and loss of operator's license.

Motor vehicle liability insurance policies must provide \$25,000/\$50,000 limits of liability for bodily injuries and \$10,000 for property damage liability. Liability coverage provides protection for damage to persons or property. No-fault coverage pays up to \$10,000 for medical expenses, lost wages, and replacement services if one is injured in an automobile collision regardless of who may have been at fault. Higher limits of coverage may be purchased.

If you decide to reject no-fault personal injury coverage and limitations on your right to sue or be sued, your rejection must be in writing on a special form established by the Kentucky Department of Insurance and filed with the Department of Insurance. You may obtain this form from your insurance agent, insurance company, or the Kentucky Department of Insurance.

Under no-fault personal injury coverage, your right to sue will be limited in case of a minor injury. The rights of other persons to sue you will be limited in a similar manner. However, if you do not want these limitations on your right to sue or be sued, you have the option to reject the no-fault act and the limitations on your right to sue or be sued.

Persons injured in traffic collisions who are entitled to no-fault personal injury benefits will receive payments for their out-of-pocket losses up to \$10,000. Benefits will be paid by the company insuring the motor vehicle in which they were riding, regardless of who was to blame for the collision. It

will no longer be necessary to await the results of a lengthy investigation to determine liability before payment can begin.

The no-fault law is also a compulsory insurance law. Owners of motor vehicles must have liability insurance. Motor vehicle liability insurance policies must provide \$25,000/\$50,000 limits of liability for bodily injuries and \$10,000 for property damage liability. An alternative to this “split limit” arrangement is to purchase a “single limit” policy which has a limit of liability of at least \$60,000. All motor vehicle liability insurance policies must provide a minimum of \$10,000 no-fault personal-injury coverage.

Each company providing automobile liability insurance is required each time it issues, renews or amends a policy to issue written proof that the insured has in effect an insurance contract providing coverage in conformity with Kentucky law. One (1) copy of the written proof of motor vehicle insurance must be given to the County Clerk for registration renewal, and the other copy must be kept in the vehicle it relates to and shown to peace officers on request.

Driving safely affects your car insurance rates substantially. Every time you have a collision, you risk having your premium raised. If you have collisions, or convictions of certain violations, you may also be charged more for insurance or risk cancellation of your insurance.

UNSATISFIED JUDGMENT

Any person failing to satisfy a judgment rendered against him for damages resulting from the operation of a motor vehicle, within 60 days from the date of said judgment shall have his driving privilege suspended by the Transportation Cabinet. The suspension will remain in effect until 15 years have elapsed, or until the judgment has been satisfied. Upon satisfaction, a court-attested copy of the satisfaction is to be sent to the Cabinet, and the necessary reinstatement procedures must be followed.

For more detailed information on amounts and types of insurance coverage, it is recommended that the motorist contact an insurance company.

THE KENTUCKY POINT SYSTEM

The purpose of the point system is to identify and assist those drivers who need improvement before it becomes necessary to suspend their driving privilege. It serves to protect the safe and sensible drivers and correct those who are reckless and irresponsible.

Under the point system, the Transportation Cabinet’s, Division of Driver Licensing keeps a record of all moving traffic violations on each driver

licensed in Kentucky. These records are based on reports of traffic convictions, forfeiture of bail, or payment of fine, with or without court appearances, which are forwarded to the Division of Driver Licensing by the courts throughout the United States. Assignment of point value to various offenses is made to impress upon drivers that their driving records are being monitored, and unless they comply with traffic laws, they may develop a bad driving record, which could lead to the suspension of their driver's license.

Any driver accumulating as many as six (6) points may receive a form letter from the Division of Driver Licensing advising him that immediate action should be taken to improve his driving. The driver may be required to appear for an interview with a representative of the Cabinet to determine his real driving problems.

At this interview, the Transportation Cabinet representative attempts to determine if participation in a State Traffic School program would benefit the driver. If he fails to appear for the interview, his driving privilege shall be suspended for a period of six (6) months.

TRAFFIC VIOLATIONS AND THEIR POINT VALUES

| Violation Type | Points |
|-----------------------|---------------|
|-----------------------|---------------|

Conviction for one of the following serious violations of the motor vehicle laws may result in suspension of the driving privilege for the period of time indicated:

| | |
|------------------------------------------|---------|
| Racing | 90 Days |
| Speeding 26 MPH or more over speed limit | 90 Days |
| Fleeing or Evading Police | 90 Days |

Conviction for any one of the following motor traffic offenses shall be cause for assessment of the points indicated:

| | |
|-------------------------------------------------------------------------------------------|---------------------|
| Speeding 15 MPH or less over the limit | 3 |
| Speeding 1-10 MPH over the limit on limited access highway | 0/Fine if Convicted |
| Speeding 11-15 MPH over the limit on limited access highway | 3 |
| Speeding 15 MPH or over the limit on limited access highway in a commercial motor vehicle | 3 |
| Speeding 16 MPH or more, but less than 26 MPH, over the limit | 6 |
| Failure to stop for church or school bus | 6 |
| Improper passing | 5 |
| Reckless driving | 4 |

| | |
|-------------------------------------------------------------------------------------|---|
| Driving on wrong side of roadway | 4 |
| Following too closely | 4 |
| Failure to yield to emergency vehicle | 4 |
| Changing drivers in a moving vehicle | 4 |
| Stop violation (electrical signal, railroad crossing, stop sign) | 3 |
| Failure to yield | 3 |
| Failure to yield right of way to pedestrian | 3 |
| Failure to obey a traffic control device | 3 |
| Wrong way on one-way street | 3 |
| Too fast for conditions | 3 |
| Too slow for conditions | 3 |
| Improper start | 3 |
| Improper driving | 3 |
| Careless driving | 3 |
| Improper lane usage | 3 |
| Improper use of left lane on limited access highway | 3 |
| Failure to illuminate headlights | 3 |
| Failure to dim headlights | 3 |
| Any other moving hazardous violations | 3 |
| Commission of a moving hazardous violation which involves a collision | 6 |
| Combination of two or more hazardous violations in any one continuous occurrence | 6 |

Points assessed under the Kentucky Point System expire two (2) years from the date of conviction. However, the conviction remains part of the driver's record for a period of five (5) years for an operator's license and ten (10) years for a commercial driver's license.

If a person of eighteen or more years accumulates six or more points within a two-year period, the Transportation Cabinet may send a letter that shall advise him of the number of penalty points on his driving history record, and shall inform him of the penalties which may be imposed if he were to accumulate twelve points within two years.

If a person under the age of eighteen accumulates four or more points within a two-year period, the Transportation Cabinet may send a letter that shall advise him of the number of penalty points on his driving history record, and shall inform him of the penalties which may be imposed if he were to accumulate more than six prior to his eighteenth birthday.

If a person of eighteen or more years accumulates twelve points within a

period of two years, or a person less than eighteen accumulates more than six points in a period of two years, the Cabinet may suspend the driving privilege for a period of six months for the first accumulation of points, one year for the second accumulation of points, and two years for any subsequent accumulation of points within a two-year period. For any offense for which the suspension of the driving privilege is six months or less for the first offense, the second conviction of a similar offense shall result in a suspension period of not less than one year, and any subsequent conviction for any similar offense not less than two years. If the Cabinet suspends the driving privilege of a person more than one (1) time, the suspension times shall run consecutively.

After a hearing, the department may require the driver to be placed on “probation” in lieu of suspension and attend a driver improvement clinic (State Traffic School) approved by the Transportation Cabinet.

Once a driver has been placed on “probation” by the Cabinet, he shall not be considered for probation again until a lapse of two (2) years from the ending date of any previous probation period granted, whether served or not.

THE KENTUCKY STATE TRAFFIC SCHOOL PROGRAM

The Kentucky State Traffic School Program began in 1980. It is used as a tool to educate the driving public and promote safe driving behavior. A licensee may attend this program one of two ways:

- 1) Be referred by the court system as a result of any moving traffic violation other than one that requires a mandatory suspension, or
- 2) as a stipulation of being placed on probation.

The theme of these clinics is:

- Know the rules of the road.
- Have the proper driving attitude.
- Practice defensive driving habits.

Once you attend the State Traffic School Program for either reason, attendance is not permitted again for one year from the date you were referred. State Traffic School Clinics are conducted in over 50 locations throughout the state. Voluntary enrollment is not permitted.

Advantages to attending are:

- No points are assessed for the violation.
- Insurance companies are not permitted to obtain the information if normal enrollment and completion occur.
- The driving public is better informed of safe driving habits and attitudes thereby making the highways safer for everyone.

DRIVER SUBSTANCE ABUSE EDUCATION PROGRAM

Kentucky's DUI law went into effect on October 1, 2000. The law requires every first and multiple offender(s) convicted of DUI to receive an assessment in a program licensed and certified by the Cabinet for Human Resources (CHR). On the basis of the assessment, every individual must attend an alcohol education or treatment program approved by CHR. An individual must satisfactorily complete the alcohol education or treatment program before reinstatement of his driving privilege. Participants in these programs will be given comprehensive information about alcohol and other drugs to increase awareness and knowledge, and to change an individual's attitude and behavior in relation to substance abuse. The individual must pay all mandatory alcohol assessment, education, or treatment fees to the program.

With payment of the required fee for license reinstatement, a notice of completion from an approved DUI program, and after expiration of the period of license suspension, an individual convicted of DUI is eligible to get his license reissued by the Circuit Clerk's office.

THE MEDICAL REVIEW BOARD

The Kentucky State Police does not discriminate on the basis of race, color, national origin, sex, religion, age or disability.

Upon request, the Kentucky State Police will provide reasonable accommodations necessary to afford an individual with a disability an equal opportunity to participate in all testing phases.

The Medical Review Board is administered through the Kentucky Transportation Cabinet. Its purpose is to provide the administrator with sound medical advice concerning the licensing of individuals with physical or mental impairments.

Any driver with a medically-diagnosable impairment who does not possess the minimum physical or mental abilities to safely operate a vehicle under all conditions will have his driving activities curtailed accordingly.

Physically or mentally impaired drivers are brought to the attention of the division by reports received from law enforcement agencies, courts, or interested individuals having personal, detailed knowledge of the impairment. In the event a report is accepted under the above criterion, the licensee will be required to forward a completed medical questionnaire to the Division of Driver Licensing. The medical report will be submitted to a review board consisting of medical specialists appointed by the

Commissioner of the Department of Vehicle Regulation. The board will study the report and, based on their medical expertise, recommend restrictions limiting the impaired drivers to operating within their capabilities.

Drivers with a seizure condition must be seizure free for a period of at least ninety (90) days prior to an original application or renewal of a driver's license. KRS 186.411 states a person with an epileptic condition shall present to the Division of Driver Licensing certification by a physician that his condition is controlled by drugs, details of the drugs, dosage of same which the person takes, his own statement that he has been free of seizures for at least 90 days before date of the application, and that he is taking the medication prescribed by his physician. When the Division receives such certification, the condition is monitored by the Medical Review Board through periodic medical questionnaires.

TRAFFIC SIGNALS

STANDARD COLORS



RED
Stop or forbidden.



GREEN
Indicates movements permitted, directional guidance.



YELLOW
General warning.

STANDARD SHAPES

Shapes are also helpful to identify particular signs. Among the standard shapes are:

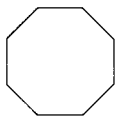

OCTAGON
(eight-sided) — used
only for stop signs.

PENNANT
(tapers to a point) —
advance warning of
no-passing zones.

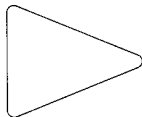

**HORIZONTAL
RECTANGLE**
(rectangle parallel or
across) — generally
for guide signs.

DIAMOND
(a square standing
on a point — shape
of a baseball field) —
used only for warning
of existing or possible
hazards on roadway
or adjacent area.

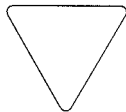
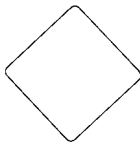

**EQUILATERAL
TRIANGLE**
(triangle standing on
its point) — used
only for yield signs.

PENTAGON
(five-sided)—
school advance and
school warning signs.



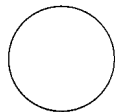

**VERTICAL
RECTANGLE**
(upright) —
generally for
regulating signs.

ROUND
(circle) — railroad
advance warning
signs.



NO TRUCKS

REGULATORY SIGNS

| | | | | |
|-------------------------------------------------------------------------------------|-------------------------------------------------------------------------------------|-------------------------------------------------------------------------------------|-------------------------------------------------------------------------------------|-------------------------------------------------------------------------------------|
|  |  |  |  |  |
| STOP | YIELD | SPEED LIMIT 55 | NO LEFT TURN | NO RIGHT TURN |
|  |  |  |  |  |
| NO BICYCLES | LEFT TURN ONLY | THRU & LEFT | LEFT LANE MUST TURN LEFT | DOUBLE LEFT TURNS |
|  |  |  |  |  |
| ONE WAY | ONE WAY | KEEP LEFT | KEEP RIGHT | WALK ON LEFT FACING TRAFFIC |
|  |  |  |  |  |
| NO TURNS | NO U TURN | KEEP OFF MEDIAN | DO NOT ENTER | WRONG WAY |
|  |  |  |  |  |
| DO NOT PASS | PASS WITH CARE | SLOWER TRAFFIC KEEP RIGHT | EMERGENCY PARKING ONLY | TRUCKS USE RIGHT LANE |
|  |  |  |  |  |
| NO PARKING ANY TIME | NO TURN ON RED | ONE HOUR PARKING 9AM-7PM | NO PARKING BUS STOP | 2 HR PARKING 8:30 AM TO 5:30 PM |

WARNING SIGNS

| | | | | |
|-------------------------------------------------------------------------------------|-------------------------------------------------------------------------------------|-------------------------------------------------------------------------------------|-------------------------------------------------------------------------------------|-------------------------------------------------------------------------------------|
|  |  |  |  |  |
| SIGNAL AHEAD | MERGING TRAFFIC | LANE ENDS | DIVIDED HIGHWAY | DIVIDED HIGHWAY ENDS |
|  |  |  |  |  |
| CATTLE CROSSING | TRAFFIC PASS ON BOTH SIDES | LOW CLEARANCE | NO PASSING ZONE | SCHOOL |
|  |  |  |  |  |
| RIGHT TURN | CURVE RIGHT | REVERSE TURN | REVERSE CURVE | WINDING ROAD |
|  |  |  |  |  |
| TWO WAY TRAFFIC | HILL | SLIPPERY WHEN WET | BIKE CROSSING | PEDESTRIAN CROSSING |
|  |  |  |  |  |
| SCHOOL CROSSING | RAILROAD CROSSING | CROSS ROAD | SIDE ROAD | SIDE ROAD |
|  |  |  |  |  |
| STOP AHEAD | YIELD AHEAD | PAVEMENT ENDS | SOFT SHOULDER | NARROW BRIDGE |

ADDITIONAL SIGNS

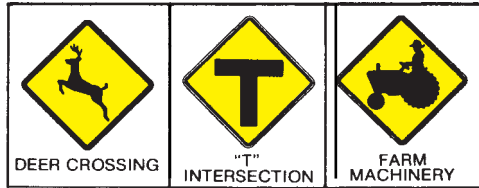

DIRECTIONAL SIGNS

SERVICE SIGNS



CONSTRUCTION SIGNS

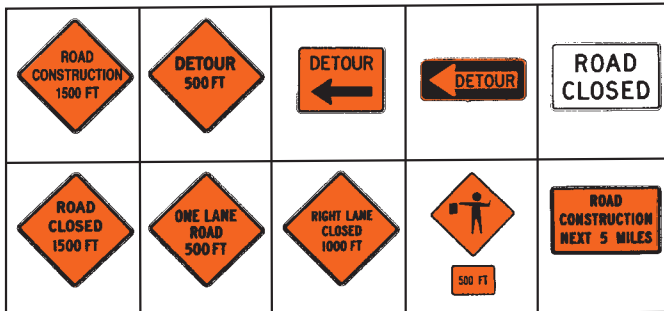

GENERAL INFORMATION

MOTOR VEHICLE REGISTRATION

Proof of Vehicle Ownership is Required. A Certificate of Title is proof of ownership. Upon transfer of ownership, the title and application for a new title must be delivered to the appropriate County Clerk. The fee for obtaining a title is \$6. A title may be obtained without registering the vehicle for highway use. Titles are mailed to the owners. Lien information must be recorded on the owner's copy. An out-of-state vehicle subject to a

security interest in another state may not be registered in Kentucky until the lien is recorded.

Passenger vehicles are registered on a staggered system by birth month. There is no grace period.

Application for registration must be made to the County Clerk in the county where the car is principally operated.

Registration Fees are staggered by birth month. The State fee is \$1 per month, and the Clerk's fee is \$3 per twelve-months period. The license plate remains with the vehicle upon transfer of ownership and expires on the previous owner's birth date.

A car purchased in another state may not be registered in Kentucky prior to entry. Exception is made for cars owned by Kentucky resident military personnel. Vehicles are subject to a 6% usage tax. Credit may be allowed for similar tax paid in other states. A nonresident must register his vehicle in Kentucky at expiration of the time granted by reciprocity agreement with his home state. Immediately upon residence being established, a Kentucky license plate must be purchased.

A special license plate for a person with a disability is available upon application, with a medical certificate, to the County Clerk.

Personal Liability and Property Damage insurance is required. Proof is required upon renewal of registration, and proof of insurance must be in the vehicle at all times.

DRIVERS LICENSE

Your license is valid from the date issued through the expiration date shown on the license. You may renew your license up to six months before your expiration date by applying in person to your local Circuit Court Clerk.

When a person under 21 years old is issued a driver's license, it will be valid until 30 days after his twenty-first birthday.

A Kentucky driver's license must be obtained immediately when residence has been established.

A nonresident is permitted to use his home state operator's license on a reciprocal basis. A visitor's permit is not required.

The minimum age to operate a vehicle in Kentucky is 16. A parent's or guardian's signature is required of those under 18.

NOTE: AN OUT-OF-STATE LICENSE ISSUED TO A PERSON UNDER SIXTEEN (16) IS NOT VALID ON KENTUCKY STREETS AND HIGHWAYS.

YOUR ORGAN DONOR CARD

On the back of the operator's license you will find an organ-donor card. It provides the Kentucky motorist an opportunity to express his or her wishes regarding organ donations.

If you or a family member needed a kidney or other vital organs to live, would you be able to get one? Probably not without a long wait due to the critical shortage. There are a number of questions which must be answered in order to make an educated decision on becoming an organ donor.

1. Can anyone sign a donor card?

Yes. However, individuals under 18 years of age may become a donor if either parent or legal guardian give consent.

2. What organs and tissues are needed?

Recent advances have made it possible to transplant 25 different tissues and organs such as kidneys, heart, pancreas, lungs, liver, corneas, bone marrow, heart valves, and skin. Success rates are better now than ever before. In fact, the first and still most successful transplant is a blood transfusion.

3. Will my estate have to pay for the donation?

No. All expenses incurred in the donation are paid by the Transplant Program.

4. What about religious and ethical considerations regarding transplantation?

Moral leaders the world over favor such donations as expressions of the highest humanitarian ideals. If you have any questions, please consult your clergyman.

5. What about funeral or burial arrangements?

Removal of organs or tissues authorized by a donor will not interfere with customary funeral or burial services.

6. How are organs distributed?

Organs are distributed based upon compatibility of donor and recipient tissues. Social or financial position is never a factor in selecting a recipient.

Transplantation has had a more dramatic effect on the course of terminal illness than any other form of therapy. However, the future depends upon increasing the number of organs donated. Organ donation is truly the Gift of Life. The donor card on your license may be signed and witnessed over the plastic surface. Although not required (unless under 18), it is a good idea for the two witnesses to include family members.

TRUST FOR LIFE

The Kentucky General Assembly has made it possible for you to donate \$1 for the TRUST FOR LIFE fund when you renew your license through your Circuit Court Clerk. The money will be used to increase public awareness and education regarding the need for organ donation.

SMART DRIVING HELPS CONSERVE ENERGY AND IMPROVES AIR QUALITY

Smart driving pays dividends not only in avoiding the inconvenience, pain, and expense of traffic collisions, but also in reducing *air pollution* and gasoline costs.

Safety and conservation both depend on:

- Keeping your vehicle in good running condition.
- Using good driving habits.
- Driving only when necessary.

KEEP YOUR VEHICLE IN GOOD CONDITION

A vehicle in good mechanical condition is safer, easier to drive, more dependable, and uses less fuel.

Regular mechanical maintenance will *also* assure that your vehicle will be better able to move safely in traffic, avoid road breakdowns, save gasoline, and *pollute less*. For example, regular tune-ups will give more dependable engine performance and improve fuel economy as much as 15 percent. Check tire pressure regularly. Under-inflated tires increase gas consumption and can make your vehicle more difficult to handle. Also, under-inflated tires will wear faster and are more prone to “blowout.”

Motor vehicles are major contributors to ground level ozone. Ozone pollution contributes to health problems such as chronic lung and heart diseases, allergies, and asthma. Young children, older adults, and people who work or play outside are at the highest risk for health problems related to ground-level ozone. Although today’s new vehicles emit fewer pollutants than older vehicles, their emission levels will increase unless they are carefully maintained. As a vehicle ages, its performance and fuel economy diminishes. Vehicle emissions testing programs in major population centers of the state identify vehicles with increased emission levels, alerting the owner to needed maintenance. As vehicles are repaired, vehicle emissions are reduced, and the vehicle owner will usually see improvements in performance and fuel economy.

USE GOOD DRIVING TECHNIQUES

Plan your driving. Allow enough driving time to get to your destination safely. Avoid rush hours and congested areas when possible. Avoid quick starts and stops. Drive smoothly and at moderate speeds. Pace your driving to the traffic and signal timing, so that you can keep braking and acceleration to a minimum.

Smooth operation of your vehicle will result in better gas mileage, which means less cost to you. Also, your vehicle will not be put in as much strain; this too will result in less maintenance and repair costs.

DRIVE LESS – CONSIDER OTHER MODES OF TRAVEL

Drive only when necessary. Combine as many trips as you can.

Your vehicle is really safest and most economical when it is parked. Consider carpooling, taking the bus, using a bicycle, or walking.

For more information about air pollution, vehicle emissions testing programs, and alternative transportation options, please visit these websites:

KY Transportation Cabinet – www.transportation.ky.gov

KY Division For Air Quality – <http://www.eppc.ky.gov>

Jefferson County Air Pollution Control District –
<http://www.apcd.org>

AGING DRIVERS

We all want to keep our ability to drive and go wherever and whenever we want. However, we should be aware of the **warning** signs that our driving may not be as safe as it once was. Please find warning signs listed below. If more than one of these signs has happened to you or to someone you care about, you may wish to have his driving reevaluated. You may contact the Division of Driver Licensing, Medical Review Board, at 502-564-6800 for more information.

- **A friend or family member has expressed concern about your driving.**
- **You sometimes get lost while driving on routes that were once familiar.**
- **You have been pulled over by a police officer and warned about poor driving behavior, regardless of whether you received a ticket.**
- **You have had several moving violations, near misses, or actual collisions in the past one to three years.**
- **Your doctor or other health caregiver has advised you to restrict or stop driving.**

APPOINTMENTS FOR DRIVING TESTS

If you live in one of the following counties, you will be required to make an appointment for the skills (driving) test. You may do so by phone or in person.

| | | | |
|-----------|----------------|------------|----------------|
| Adair | (270) 384-2626 | Kenton | (859) 727-8100 |
| Ballard | (270) 335-5123 | Knott | (606) 785-5021 |
| Barren | (270) 651-3763 | Larue | (270) 358-3421 |
| Boone | (859) 334-3904 | Letcher | (606) 633-9979 |
| Boyle | (859) 239-7940 | Lincoln | (606) 365-2535 |
| Bullitt | (502) 543-2511 | Logan | (270) 726-2424 |
| Butler | (270) 526-5631 | McCracken | (270) 444-4745 |
| Calloway | (270) 753-2714 | Marshall | (270) 527-3883 |
| Campbell | (859) 292-6311 | Meade | (270) 422-4961 |
| Christian | (270) 889-6560 | Mercer | (859) 734-6308 |
| Daviess | (270) 683-9932 | Nelson | (502) 348-3648 |
| Fayette | (859) 246-2156 | Ohio | (270) 298-3671 |
| Franklin | (502) 564-4576 | Oldham | (502) 222-1979 |
| Fulton | (270) 236-3944 | Perry | (606) 435-6093 |
| Graves | (270) 247-7131 | Pike | (606) 433-7533 |
| Grayson | (270) 259-3040 | Simpson | (270) 586-4241 |
| Hardin | (270) 766-5002 | Taylor | (270) 465-6686 |
| Harlan | (606) 573-6718 | Todd | (270) 265-2343 |
| Henderson | (270) 826-2405 | Trigg | (270) 522-6270 |
| Hickman | (270) 653-3901 | Union | (270) 389-2264 |
| Hopkins | (270) 824-7503 | Warren | (270) 746-7419 |
| Jefferson | (502) 454-3327 | Washington | (859) 336-3761 |
| | (502) 454-4497 | Woodford | (859) 873-3711 |
| Jessamine | (859) 887-1713 | | |

WEBSITES

Federal Motor Carrier Safety Administration

www.fmcsa.dot.gov

Kentucky Transportation Cabinet

www.kytc.state.ky.us/DRLIC/

Kentucky State Police

www.kentuckystatepolice.org

STATE POLICE POSTS AND NUMBERS

| | | | |
|---------------|----------------|--------------|----------------|
| Ashland | (606) 928-6421 | Hazard | (606) 436-6069 |
| Bowling Green | (270) 782-2010 | Henderson | (270) 826-3312 |
| Campbellsburg | (502) 532-6363 | London | (606) 878-6622 |
| Columbia | (270) 384-4796 | Madisonville | (270) 676-3313 |
| Dry Ridge | (859) 428-1212 | Mayfield | (270) 856-3721 |
| Elizabethtown | (270) 766-5078 | Morehead | (606) 784-4127 |
| Frankfort | (502) 227-2221 | Pikeville | (606) 433-7711 |
| Harlan | (606) 573-3131 | Richmond | (859) 623-2404 |



- Kentucky law requires motorist to approach cautiously when an emergency vehicle is stopped ahead with its lights flashing.
- Motorists must change lanes away from the emergency vehicle if they are on a multi-lane highway and can do so safely.
- If drivers can't change lanes safely, or they are on a two-lane highway, they must slow down while maintaining a safe speed so as not to impede other traffic.
- Violations can result in fines.



Be Alert.
Slow Down.
Move Over!
Buckle Up!



www.kentuckystatepolice.org

KENTUCKY STATE POLICE
DRIVER TESTING BRANCH
919 Versailles Road
Frankfort, Kentucky 40601
502-226-7404

COST OF PRINTING PROVIDED BY STATE FUNDS

****PLEASE RETURN MANUAL TO TEST SITE WHEN FINISHED****